

## Riva Studio Heat Shield



For use with: RVFS-1AU/ RVFS-2AU/ RVFS-3AU

(Only when installed on a Stovax Bench option)

## Instructions for Servicing & Maintenance

For use in AU & NZ (Australia and New Zealand)

These products are tested in accordance with AS/NZ 4012:2014, AS/NZ 4013:2014 and AS/NZ 2918:2001.

All installations must be carried out by an S.F.A.I.T (Solid Fuel Authorised Technician).

The Vision must be bolted through to the hebel or base to comply with the seismic restraint provisions of AS/NZ 2918:2001

### IMPORTANT

These instructions are designed to complement the appliance installation and user guide in order to install a Stovax Studio Freestanding.

This supplement should be read in conjunction with the supplied manuals, in particular PM452 and PM205, to ensure all the correct installation procedures are followed in order to safely operate the appliance with a Heat Shield.

# Installation Instructions

Covering the following models:

Model	Studio 1 RVFS-1AU	Studio 2 RVFS-2AU	Studio 3 RVFS-3AU
Heat shield kit	RVFS-1HSK	RVFS-2HSK	RVFS-3HSK
Bench option	RVACB100HT RVACB120HT RVACB140HT RVACB180BHT RVACLB100BHT RVACLB120BHT RVACLB140BHT RVACLB180BHT	RVACB120HT RVACB140HT RVACB180BHT RVACLB120BHT RVACLB140BHT RVACLB180BHT	RVACB140HT RVACB180BHT RVACLB140BHT RVACLB180BHT

Packaging conforms to ISPM15 requirements.

## Dimensions & Clearances

### Heat Shield Dimensions

Product Code	Description	Width (W) mm	Height (H) mm
RVFS-1HSK	Riva Studio 1 Freestanding – Heat shield kit	780	439
RVFS-2HSK	Riva Studio 2 Freestanding – Heat shield kit	976	462
RVFS-3HSK	Riva Studio 3 Freestanding – Heat shield kit	1364	473

Fitting this heat shield allows a reduction in the clearance to Heat Sensitive material dimensions to the values as listed, when the product is fitted to a Stovax Riva bench:-

### Clearances (Parallel Installations Only)

Product	Side	Back*
Studio 1 RVFS-1AU	800mm	150mm
Studio 2 RVFS-2AU	800mm	150mm
Studio 3 RVFS-13AU	800mm	150mm

\* This Dimension is measured from the back of the Heat Shield.



**PIONEER DOUBLE FLUE MOUNTED UNIVERSAL SHIELD MUST BE USED ON THE FLUE SYSTEM ALONG WITH THE HEAT SHIELD KIT TO OBTAIN CLEARANCES.**

# Installation Instructions

## Packing List

- 1 x Instructions
- 1 x Heat shield
- 6 x Spacer - Studio models 1/2 only
- 6 x Fixing screw - Studio models 1/2 only
- 8 x Spacer - Studio 3 only
- 8 x Fixing screw - Studio 3 only
- 1 x Fixing screw key

## Tools Required

Fixing screw key supplied

## 1. Installation - All Models

- 1.1 To fit the heat shield, locate it into position using the fixing screws and spacers supplied as shown. Using the pre-drilled pilot holes to locate the position. (See note), Diagrams 1 & 2.

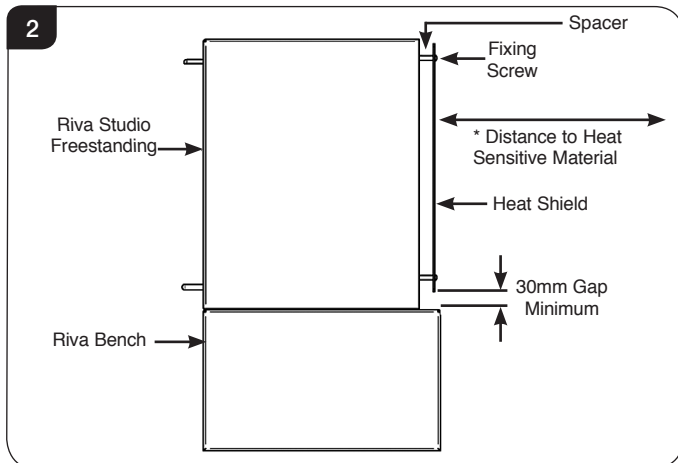
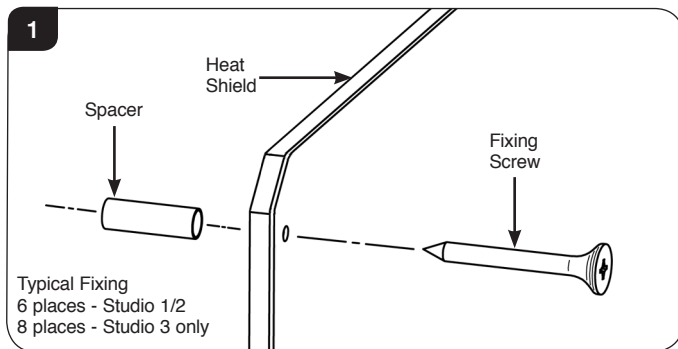

- 1.2 Take care to not over tighten the fixing screws if using a power screwdriver.

There are 6 fixing points for the Studio 1 & 2 models. The Studio 3 has 8.

**NOTE:** Some Studio products may not have the pre-drilled pilot holes. If this is the case drill 6/8 x 5mm diameter holes in the positions as shown.

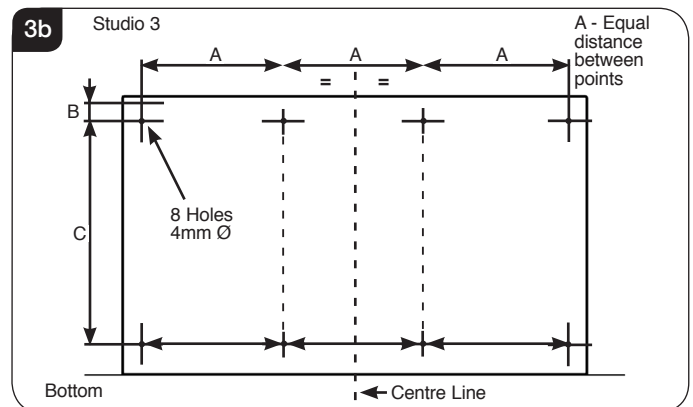
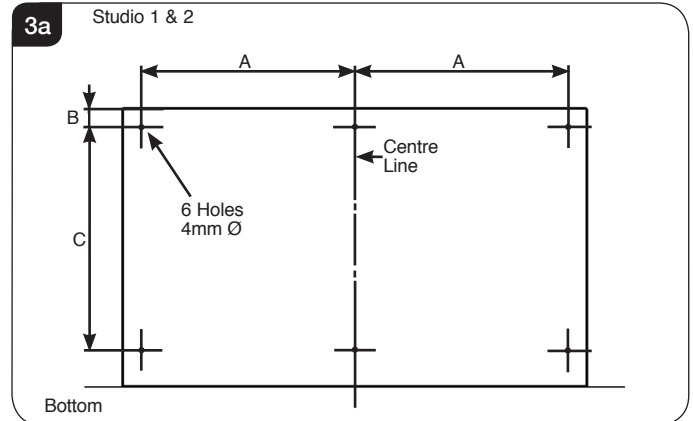

Model	A	B	C
Studio 1	365	33	389
Studio 2	463	34	413
Studio 3	438	35	423

- 1.3 Continue to install the bench as detailed in PM205.

**Bench must be fixed to the floor to comply with the seismic restraint provisions of AS/NZ 2918:2001.**

**Distributed by:**

Australia

castworks  
home heating specialists

A Division of Jezaru Pty Ltd ABN 95 591 448 552

57 INDUSTRIAL DRIVE

BRAESIDE

VICTORIA 3195

Ph (03) 9588 1169

Fax (03) 9588 2670

E-mail: [info@castworks.com.au](mailto:info@castworks.com.au)

Website: [www.castworks.com.au](http://www.castworks.com.au)

Adapted from English Issue 4 of PM732



PM732AU