



Vision Large

Balanced Flue

with Thermostatic Remote Control



IMPORTANT:
FOR EASY TO FOLLOW,
STEP BY STEP VIDEO
INSTRUCTIONS ON HOW TO
OPERATE AND MAINTAIN YOUR
GAZCO REMOTE SYSTEM GO TO
WWW.GAZCO.TV

Instructions for Use, Installation & Servicing

For use in NZ (New Zealand).

IMPORTANT

THE OUTER CASING, FRONT AND GLASS PANEL BECOME EXTREMELY HOT DURING OPERATION AND WILL RESULT IN SERIOUS INJURY AND BURNS IF TOUCHED. IT IS THEREFORE RECOMMENDED THAT A FIREGUARD IS USED IN THE PRESENCE OF YOUNG CHILDREN, THE ELDERLY OR INFIRM.

This product contains a heat resistant glass panel. This panel should be checked during Installation and at each servicing interval. If any damage is observed on the front face of the glass panel (scratches, scores, cracks or other surface defects), the glass panel must be replaced and the appliance must not be used until a replacement is installed. Under no circumstances should the appliance be used if any damage is observed, the glass panel is removed or broken.

These Instructions must be left with the appliance for future reference and for consultation when servicing the appliance. Please make the customer aware of the correct operation of the appliance before leaving these instructions with them.

The commissioning sheet found on Page 3 of this Instruction manual must be completed by the Installer prior to leaving the premises.

Contents

Vision Balanced Flue

Covering the following models:

MODEL	PEBBLE & STONE		LOG EFFECT	
	NAT GAS	LPG	NAT GAS	LPG
Black Reed	526-071NZ	526-419NZ	526-112NZ	526-425NZ
Vermiculite	526-163NZ	526-544NZ	526-202NZ	526-523NZ
Black Glass	526-382NZ	526-717NZ	526-333NZ	526-610NZ

Appliance Commissioning Checklist3

User Instructions4

Installation Instructions9

Technical Specifications 9

Site Requirements 11

Installation 16

Commissioning 25

Servicing Instructions26

Fault Finding 26

How To Replace Parts 28

Spare Parts List 33

Service Records 34

WARRANTY

For purchases outside of the United Kingdom , Republic of Ireland, France and Belgium please consult your Gazco retailer for the warranty available in your region.

Appliance Commissioning Checklist

To assist us in any guarantee claim please complete the following information:-

IMPORTANT NOTICE

Explain the operation of the appliance to the end user, hand the completed instructions to them for safe keeping, as the information will be required when making any guaranteed claims.

FLUE CHECK	PASS	FAIL
1. Flue Is correct for appliance		
2. Flue flow Test N/A		
3. Spillage Test N/A		
GAS CHECK		
1. Gas soundness & let by test		
2. Standing gas pressure	mb	
3. Appliance working pressure (on High Setting) NB All other gas appliances must be operating on full	mb	
4. Gas rate	m ³ /h	
5. Does Ventilation meet appliance requirements N/A		

RETAILER AND INSTALLER INFORMATION

Retailer Contact No. Date of Purchase Model No. Serial No. Gas Type	Installation Company Engineer Contact No. Registration No. Date of Installation
--	--

User Instructions

Welcome

Congratulations on purchasing your Vision fire, if installed correctly Gazco hope it will give you many years of warmth and pleasure for which it was designed.

The purpose of this manual is to familiarise you with your appliance and give guidelines for its installation, operation and maintenance. If, after reading, you need further information, please do not hesitate to contact your Gazco retailer.

WARNING



In the event of a gas escape or if you can smell gas, please take the following steps:

- Immediately turn off the gas supply at the meter/emergency control valve
- Extinguish all sources of ignition
- Do not smoke
- Do not operate any electrical light or power switches (On or Off)
- Ventilate the building(s) by opening doors and windows
- Ensure access to the premises can be made

Please report the incident immediately to the National Gas Emergency Service Call Centre on 0800 111 999 (England, Scotland and Wales) , 0800 002 001 (N. Ireland) or in the case of LPG, the gas supplier whose details can be found on the bulk storage vessel or cylinder.

The gas supply must not be used until remedial action has been taken to correct the defect and the installation has been recommissioned by a competent person.

1. General

- 1.1 Installation and servicing must only be carried out by a competent person.
- 1.2 In all correspondence, please quote the appliance type and serial number, which can be found on the data badge located on a plate under the Main Burner.
- 1.3 **Do not** place curtains above the appliance: You must have 300mm (1') clearance between the appliance and any curtains at either side.
- 1.4 No furnishings or other objects should be placed within 1 metre of the front of the appliance.
- 1.5 If a shelf is fitted, a distance of 400mm above the appliance is required.
- 1.6 If any cracks appear in the glass panel do not use the appliance until the panel has been replaced.

- 1.7 Do not obstruct the flue terminal in any way, i.e. by planting flowers, trees, shrubs etc. in the near vicinity, or by leaning objects against the terminal guard.
- 1.8 Do not put any objects on the terminal guard; it will lose its shape.
- 1.9 If you use a garden sprinkler, do not let quantities of water into the flue terminal.
- 1.10 This product is guaranteed from the date of installation, as set out in the terms and conditions of sale between Gazco and your local Gazco retailer. Please consult with your local Gazco retailer if you have any questions. In all correspondence always quote the Model Number and Serial Number.



IMPORTANT: NEVER position a television or screen above this appliance.

2. Operating the Appliance

The appliance is operated by thermostatic remote control.

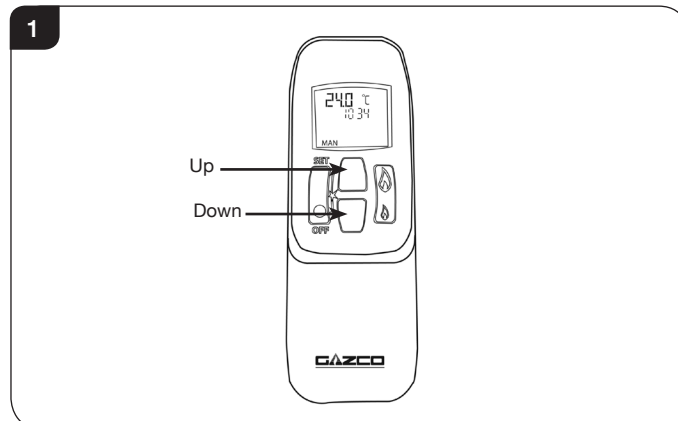

- 2.1 **Turning the appliance On:**
Your remote can control the gas fire from pilot ignition through to shut down.

To turn the fire on press the OFF button and the UP button simultaneously. You hear several short signals.
The pilot and main burner ignite and the remote is now in Manual Mode.



IMPORTANT: YELLOW FLAMES TYPICALLY APPEAR WHEN THE APPLIANCE HAS REACHED NORMAL OPERATING TEMPERATURE. THIS CAN TAKE UP TO 30 MINUTES.



WARNING: IF THE APPLIANCE FAILS TO LIGHT OR BECOMES EXTINGUISHED IN USE, WAIT 3 MINUTES BEFORE ATTEMPTING TO RELIGHT.

User Instructions

2.2 There are 3 different modes available for controlling and operating the appliance:

1. Manual Mode
2. Temp Mode (Automatic)
3. Timer Mode (Automatic)

2.3 In **MANUAL MODE** you can:

- turn on the main burner using the UP button
- regulate the flame from high to low and back
- turn off the burner leaving just the pilot burning

In **TEMP MODE (Automatic)** you can:

- set the room temperature so the thermostat in the remote automatically maintains that temperature

In **TIMER MODE (Automatic)** the fire:

- turns on and off according to the set time periods
- automatically regulates the room temperature during the set periods



NOTE: When operating the fire in Temp or Timer mode, the pilot remains lit and the fire then automatically switches on at programmed times to bring the room to the set temperature whether or not you are in the room. **NEVER LEAVE ANY COMBUSTIBLE MATERIALS WITHIN 1 METRE OF THE FRONT OF THE APPLIANCE.**

Switching Between Modes

2.4 Press the SET button to change to Temperature Mode. Press again to change to Timer Mode. Keep pressing to run through all operating modes. These are:

- MAN
- DAY TEMP
- NIGHT TEMP
- TIMER
- and back to MAN

NOTE: MAN mode can also be reached by pressing either the UP or DOWN button.

Manual Mode

2.5 Press the OFF button and the UP button simultaneously. You hear several clicks and audible beeps as the fire begins the ignition process, (up to 30 seconds).

Turning the appliance Off:

Press the OFF button to turn the appliance off.

FOR SAFETY, YOU MUST WAIT 30 SECONDS BEFORE LIGHTING THE FIRE AGAIN.

Increasing the Flame Height:

Press the UP button once to increase flame height one stage. Press and hold the UP button to increase to maximum.

Decreasing the Flame Height:

Press the DOWN button once to decrease flame height one stage. Press and hold the DOWN button to decrease to minimum. At the lowest point the fire goes to 'Standby Mode' (Only Pilot lit).



NOTE: While pressing a button a symbol indicating transmission appears on the display. The receiver confirms transmission with a sound signal.

Temp Mode (Automatic)

2.6 The display shows the current **room** temperature.

To increase or decrease the fire's output:

Press the SET button to select either the DAY TEMP or the NIGHT TEMP mode by briefly pressing the SET button.

Hold the SET button until the TEMP display flashes and then let go.

Set the desired temperature with the UP and DOWN arrows. (Minimum temperature 5C, maximum 40C or 40F to 99F when Fahrenheit is the preferred option).

Press the OFF button to stop the display flashing or wait to return to TEMP mode.



NOTE: If you set a temperature that is beneath the current room temperature, the fire automatically switches to PILOT (Stand by).

If you would like the Night temperature control to turn off then decrease the temperature until [--] is displayed.

Timer Mode (Automatic)

2.7 There are two programmable settings you can make over a 24 hour period, P1 and P2. These are normally used to provide an early morning and evening setting for each working week:

- P1 + ● = Start Timed Setting 1
- P1 + ☞ = End of Timed Setting 1
- P2 + ● = Start Timed Setting 2
- P2 + ☞ = End of Timed Setting 2

User Instructions

2.8 P1 - Program 1 for a Timed Setting

Press the SET button until the TIMER mode is displayed.

Hold the SET button. The display flashes the current time for P1. **While the time displayed is flashing you can alter the hours and minutes set.**

To set the time your fire first lights, change P1 :

- Press the UP button to alter the hour.
- Press the DOWN button to alter the minutes in 10 minute increments.



Press SET again to move to the end setting for P1 . This is the time your Vision first shuts down:

- Press the UP button to alter the hour.
- Press the DOWN button to alter the minutes.

2.9 P2 - Program 2 for a Timed Setting

Use the same steps outlined in 2.8 to change the setting for P2.

If you have already set P1 and want to alter the setting for P2 only:

- Press the SET button until TIMER mode is displayed.
- Hold the SET button **until the display flashes the current time** for P1 .
- Press the SET button once again to scroll past the settings for P1  and P1.

With the time still flashing:

- Press the UP button to alter the hour.
- Press the DOWN button to alter the minutes.

Once all four times are set press the OFF button.

2.10 To view existing settings:

- Select Timer Mode.
- Press and briefly hold the SET button you see the start time for P1.
- Repeat the above step for the start and end of each program.

Low Battery

“BATT” is displayed on the remote when its batteries need replacement.

Setting the time

Simultaneously press the up and down buttons.

Press the up button to set the hour and the down button to set the minutes.

Press OFF to return to the manual mode or simply wait.

Setting the °C/24 Hour or °F/12 Hour clock

Press OFF and the down arrow until the display changes from °C/24 hour clock to °F/12 hour clock and vice versa.



If the remote is removed, lost or damaged, signals transmitted to the receiver cease. Your fire will go to standby (pilot) mode after 6 hours.

Troubleshooting



IMPORTANT: In the unlikely event that the handset fails to communicate correctly with the appliance it may be necessary to turn off the gas supply at the isolation valve until any problems can be resolved.

The gas meter and isolation valve can be located outside in a meter box, under the stairs, beneath the kitchen sink or in the garage. Whilst this list is not exhaustive, it is important to be able to identify the location of the valve in case of any gas emergency.

To turn off the gas supply, simply turn the handle so the lever is at 90 degrees to the upright gas pipe.

If you smell gas, open doors and windows and never operate any electrical switches. Immediately call the Gas Emergency Services on 0800 111 999.

3. Changing the Appliance Batteries

- 3.1 The appliance batteries are located behind a bracket located behind the lower panel, see Diagram 2. To remove the panel lift slightly and pull forward.

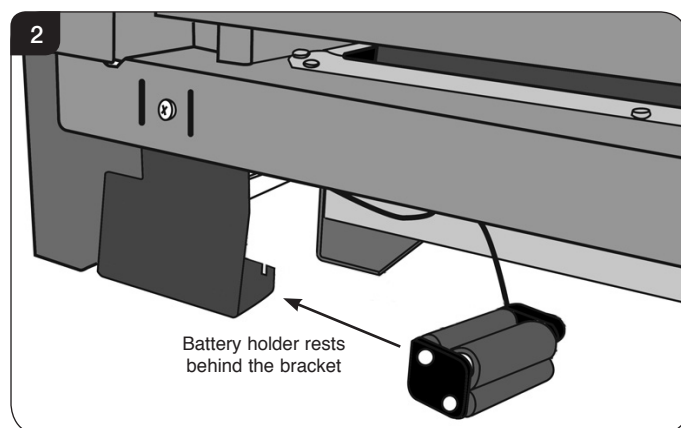

- 3.2 Unclip the battery holder from the connector and remove the old batteries.



It is essential to use high quality batteries (Duracell or equivalent) when replacing batteries in the handset or control box.

User Instructions

- 3.3 Correctly position the four new AA size batteries into the battery holder. Re-assemble the battery holder as shown in Diagram 3.

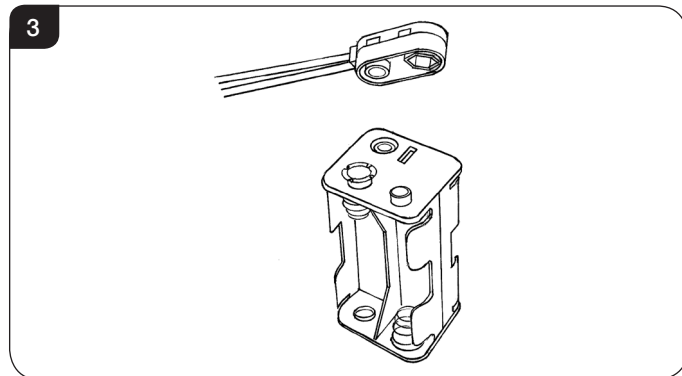

PLEASE ENSURE NO WIRES ARE TRAPPED BEFORE REPLACING THE WALL PLATE. THE LEAD IS EASILY DAMAGED.

4. Cleaning the Appliance

IMPORTANT: THE OUTER PANELLING OF THE VISION IS MADE FROM GLASS. USE CAUTION WHEN INSTALLING, REMOVING AND STORING AS THE COMPONENTS ARE FRAGILE AND COULD BREAK UNLESS HANDLED CAREFULLY.

- 4.1 Make sure the appliance and surrounds are cool before cleaning.
Use:
- A dry cloth or stainless steel product to clean the polished plate.
 - A damp cloth for the painted frame.
 - A damp cloth to clean the enamelled inner panels.
 - Use a soft brush to clean the vermiculite panels.
- 4.2 Remove the front from the appliance by lifting clear of the slotted hooks, see Diagram 4.

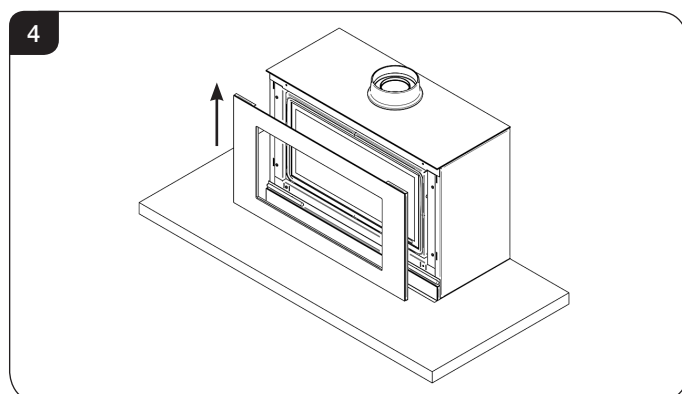

- 4.3 Using the hex key provided release the two window locks at the top of the glass door, see Diagram 5.

The locks move from shut to open towards the outer edges of the glass door.

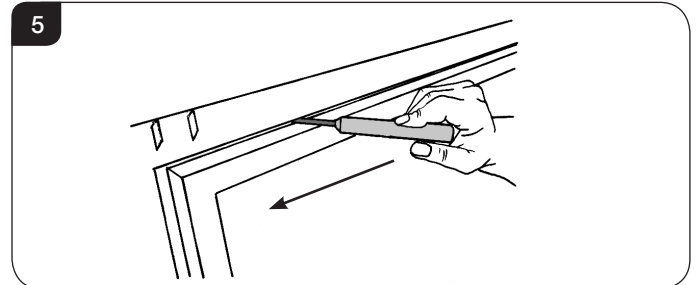

- 4.4 Support the frame and let it fall gently forward.
4.5 Open it down to its stop position.

When closing the window ensure the window catches are fully engaged.

UNDER NO CIRCUMSTANCES SHOULD THE APPLIANCE BE USED WITHOUT THE CATCHES HOLDING THE DOOR IN PLACE.

5. Flame Failure Device

- 5.1 This is a safety feature incorporated on this appliance which automatically switches off the gas supply if the pilot goes out and fails to heat the thermocouple.

IF THIS OCCURS DO NOT ATTEMPT TO RELIGHT THE APPLIANCE FOR 3 MINUTES.

6. Running In

- 6.1 During initial use of a new GAZCO appliance a strong odour will be encountered as various surface coatings become hot for the first time. Although these odours are harmless it is recommended that the appliance is operated on maximum for 4 to 8 hours in order to fully burn off these coatings. After this period the odours should then disappear.

If the odours persists, please contact your installer for advice.

- 6.2 During the first few hours of burning there may be discolouration of the flames. This will also disappear after a short period of use.

7. Servicing

- 7.1 The appliance must be serviced every 12 months by a qualified Gas Engineer. In all correspondence always quote the Model number and the Serial number which may be found on the Commissioning Checklist (Page 3).

User Instructions

8. Ventilation

- 8.1 This appliance requires no additional ventilation.

9. Installation Details

- 9.1 Your installer should have completed the commissioning sheet at the front of this book. This records the essential installation details of the appliance. In all correspondence always quote the Model number and Serial number.

10. Hot Surfaces

- 10.1 Parts of this appliance become hot during normal use.
- 10.2 Regard all parts of the appliance as a working surface.
- 10.3 Provide a suitable fire guard to protect young children and the infirm.

11. Appliance will not light

If you cannot light the Vision:

- 11.1 Check and change the batteries in the remote handset.
- 11.2 Check and change the appliance batteries, see Section 3.
- 11.3 Consult your Gazco retailer or installer if the Vision still does not light.

Installation Instructions

Technical Specification

Covering the following models:

MODEL	PEBBLE & STONE		LOG EFFECT	
	NAT GAS	LPG	NAT GAS	LPG
Black Reed	526-071NZ	526-419NZ	526-112NZ	526-425NZ
Vermiculite	526-163NZ	526-544NZ	526-202NZ	526-523NZ
Black Glass	526-382NZ	526-717NZ	526-333NZ	526-610NZ

Model	Gas CAT.	Gas Type	Working Pressure	Aeration	Injector	Gas Rate m ³ /h	Input kW (Gross)		Country
							High	Low	
Vision Large	I2H	Natural Gas(G20)	20mbar	8mm x 15mm (L)	400	0.600	6.3	4.0	NZ
	I3B/P	LPG Propane (G31)	29mbar	6mm x 15mm (B) + 16mm x 23mm	185	0.237	6.3	4.0	
		LPG Butane (G30)							
Efficiency Class 2 - 81% / NOx Class 4									
Flue Outlet Size Ø 100mm									
Flue Inlet Size Ø 150mm									
Gas Inlet Connection Size Ø 8mm									

RESTRICTOR REQUIREMENT				
VERTICAL & HORIZONTAL FLUE			TOP EXIT - VERTICAL ONLY INCLUDING OFFSET	
VISION BF			VISION BF	
Vertical Flue Height	Horizontal Length	Restrictor Size	Vertical Flue Height	Restrictor Size
200mm - 499mm	Up to 500mm	N/A	2000mm - 4999mm	52mm
500mm - 999mm	Up to 1000mm	N/A	5000mm - 10,000mm	47mm
1000mm - 1499mm	Up to 1000mm	70mm		
1500mm - 1999mm	Up to 5000mm	70mm		
2000mm - 3000mm	Up to 5000mm	60mm		

SPECIFIC INFORMATION FOR NEW ZEALAND		
Riva Vision BF		
Gas Type	Natural Gas	General Product LPG (Propane, Butane or mixture)
Test Point Pressure	2kPa	2.75kPa
Gas Input Rate	22.7MJ/h	22.7MJ/h
Max Supply Pressure	6kPa with external regulator	3.5kPa
Design Standard	EN613:2001	
Installation	This appliance must be installed in accordance with AS/NZS 5601.1:2013, the National Standard covering the Installation of gas appliances.	

Installation Instructions

Technical Specification

This appliance has been certified for use in countries other than those stated. To install this appliance in these countries, it is essential to obtain the translated instructions and in some cases the appliance will require modification. Contact Gazco for further information.

PACKING CHECKLIST

Qty	Description	Fixing Kit containing:
	Stone & Pebble Effect Version	1 x Instruction Manual 4 x Wood Screws 4 x Wall Plugs 1 x Handset 4 x AA cell batteries
	Log Version	1 x 9v cell battery 1 x Battery holder
	1 x White Stone Chippings	
	1 x Pebble Set	
	1 x Log Set	
	1 x Lava Rock	
	1 x Slate	

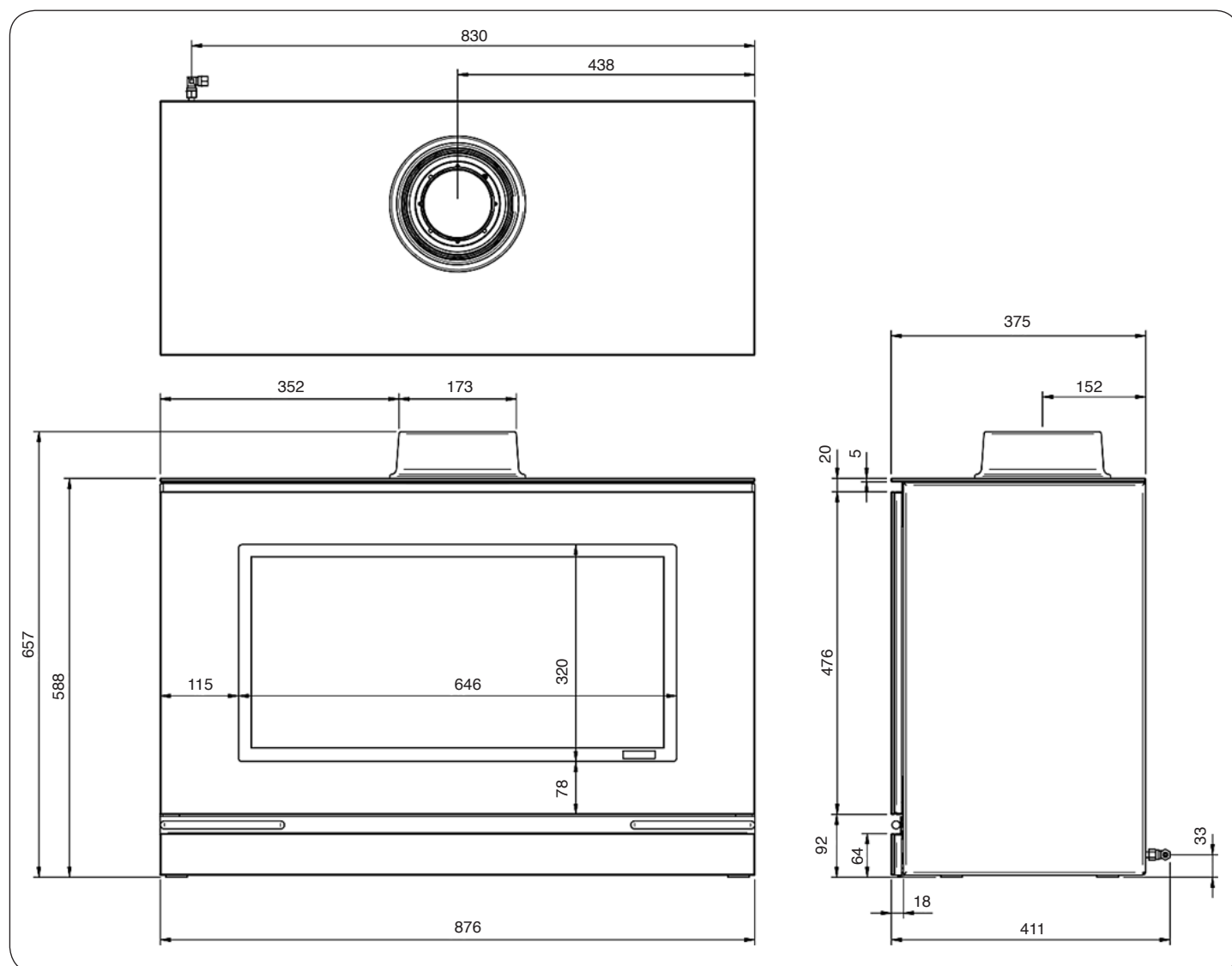

Installation Instructions

Site Requirements

1. Flue & Chimney Requirements

Note: This appliance must only be installed with the flue supplied.

You must adhere to the following:

- 1.1 The flue must be sited in accordance with the rules in force and comply with all local and National regulations, see Diagram 1.
- 1.2 Fit a guard to protect people from any terminal less than 2 metres above any access such as level ground, a balcony or above a flat roof.
- 1.3 All vertical and horizontal flues must be securely fixed and fire precautions followed in accordance with local and national codes of practice.
- 1.4 A restrictor may be required, see Technical Specifications on page 9.
- 1.5 Two types of flue terminals are available, horizontal and vertical.

- 1.6 To measure for a horizontal terminal decide on the terminal position.
- 1.7 Measure the height from the top of the appliance to the centre of the required outlet.
- 1.8 For minimum and maximum flue dimensions see Diagrams 1A & 1B.
- 1.9 Allow enough room either above or to the side of the appliance to assemble the flue on top
- 1.10 Assemble a horizontal flue in the following order:
 - Vertical section
 - 90° elbow
 - Horizontal plus terminal
- 1.11 Support the opening of a masonry installation with a lintel.
- 1.12 Only the horizontal terminal section can be reduced in size.

1

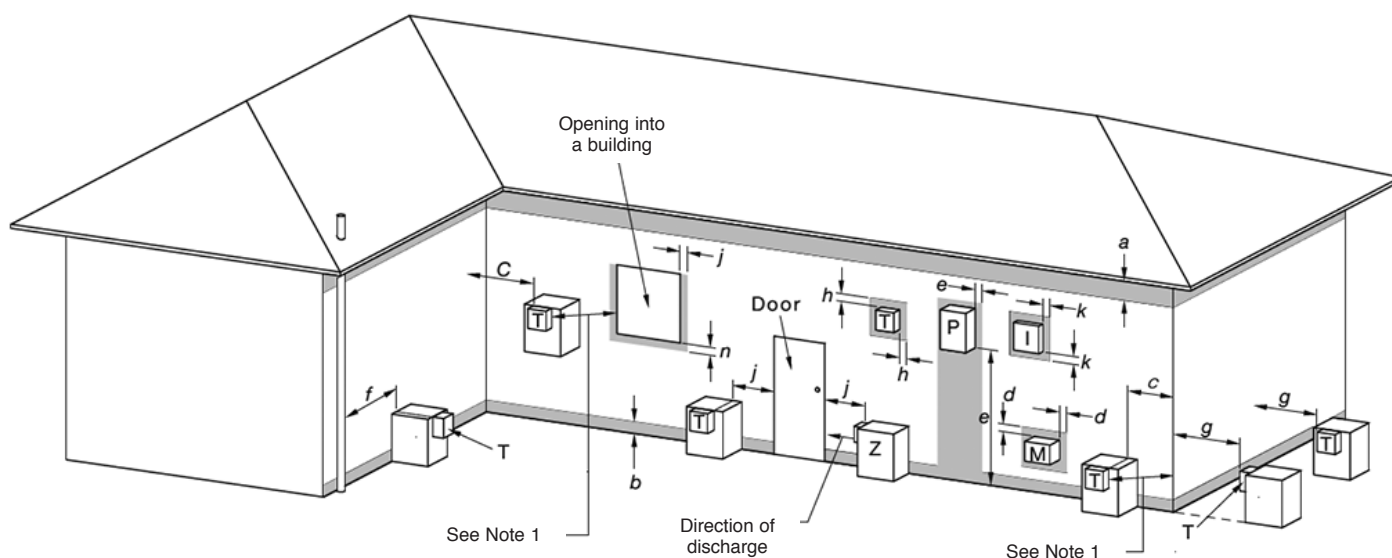

I = Mechanical air inlet

M = Gas Meter

P = Electricity meter or fuse box

T = Flue Terminal

Z = Fan-assisted appliance only

Shading indicates prohibited area for flue terminals

Installation Instructions

Site Requirements

Minimum clearances required for the flue terminals showing in Diagram 1 on page 16.

Ref	Item	Minimum clearances (mm)
		Natural Draught
a	Below eaves, balconies and other projections: Gas appliances up to 50 MJ/h	300
b	From the ground, above a balcony or other surface	300
c	From a return wall or external corner	500
d	From a gas meter (M)	1000
e	From an electricity meter or fuse box (P) [†]	500
f	From a drain pipe or soil pipe	150
g	Horizontally from any building structure or obstruction facing a terminal	500
h	From any other flue terminal, cowl, or combustion air intake	500
j	Horizontally from an openable window, door, non-mechanical air inlet, or any other opening into a building with the exception of sub-floor ventilation: Gas appliances up to 150 MJ/h input	500
k	From a mechanical air inlet, including a spa blower	1500
n	Vertically below a openable window, non-mechanical air inlet or any other opening into a building with the exception of sub-floor ventilation: Space heaters up to 50 MJ/h input	150

[†] Prohibited area below electricity meter or fuse box extends to ground level,

NOTE:

- (1) Where dimensions c, j or k cannot be achieved an equivalent horizontal distance measured diagonally from the nearest discharge point of the terminal to the opening may be deemed by the Technical Regulator to comply.

Installation Instructions

Site Requirements

2. Flue Options

1A

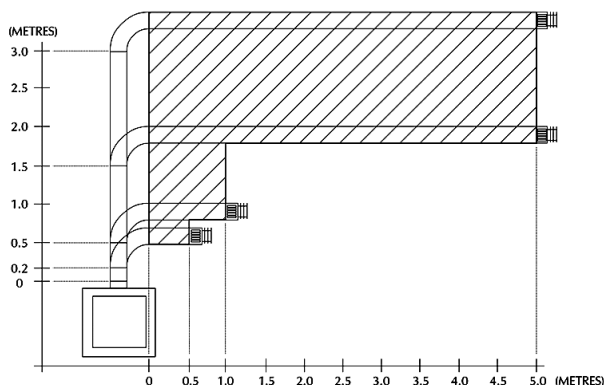

Start of bend to centre line of horizontal flue 170mm.
Centre line of vertical flue to end of bend 220mm.

2A. Top Flue Up and Out Kit (8534/8534AN)

- 2.1 Vertical from the top of the appliance then horizontally out, see Diagram 1A.

The basic kit comprises:

- 1 x 200mm vertical length
- 1 x 500mm terminal length (cut to length on site)
- 1 x 90° elbow
- 1 x wall plate
- 1 x 70mm restrictor
- 1 x 60mm restrictor

The kit may be used on its own. Extra lengths may be added to the vertical and horizontal from the table, see Section 3.

2B. Top Flue Up and Out with Additional Bend

- 2.2 Any additional bend may be used on the horizontal section (either 45° or 90°), but the overall horizontal flue run will be reduced, see Diagram 1B.

1B

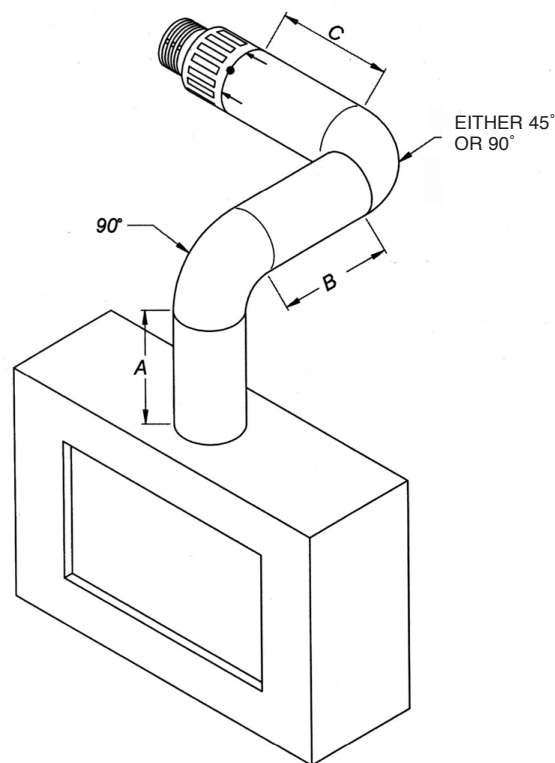

Vision Large

When A = 1.0 to 1.499 metres B + C = 1.0 metres maximum
When A = 1.499 metres to 3.0 metres B + C = 4.0 metres maximum

Installation Instructions

Site Requirements

2C. Top Flue Vertical Kit (8524/8524AN)

- 2.3 Vertical from the top of the appliance, see Diagram 1C. A minimum vertical rise 3m (9'10") to a maximum 10m (32'10").

The basic kit comprises:

- 2 x 1m lengths
- 1 x 1m terminal length
- 1 x 52mm restrictor
- 1 x 47mm restrictor
- 1 x 60mm restrictor
- 1 x 70mm restrictor

Extra lengths may be added from the table, see Section 3.

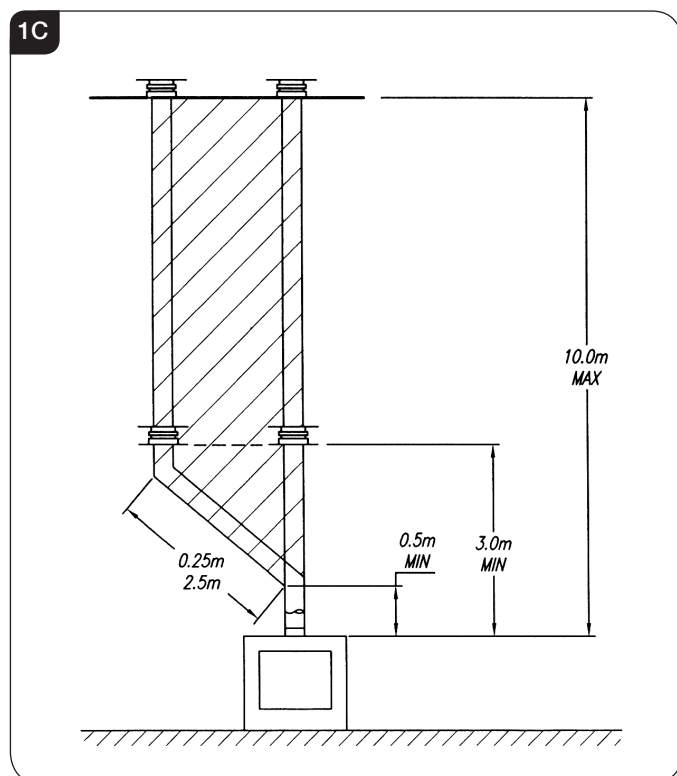

2D. Top Flue Vertical Offset Kit (8530/8530AN)

- 2.4 Used with kit 8524. A minimum rise of 500mm (19½") is required to the first bend, see Diagram 1C.

3. Optional Extra Flue Lengths and Bends

All flue components are 150mm diameter (6")

Nominal Length	Actual Length	Stainless Finish	Anthracite Finish
200mm	140mm	8527	8527AN
500mm	440mm	8528	8528AN
1000mm	940mm	8529	8529AN
45° Bend	N/A	8507	8507AN
90° Bend	N/A	8508	8508AN

NOTE: Carefully consider:

- a) Terminal positions
- b) Flue supports
- c) Weatherproofing
- d) Fire precautions

For all the above options, you must conform to local and national codes of practice .

4. Gas Supply

IMPORTANT: ALL NATURAL GAS FIRE INSTALLATIONS IN NEW ZEALAND MUST HAVE A REGULATOR FITTED UPSTREAM FROM THE APPLIANCE. THE REGULATOR MUST BE FITTED IN A SUITABLE LOCATION FOR SERVICING.

- 4.1 Before installation, ensure that the local distribution conditions (identification of the type of gas and pressure) and the adjustment of the appliance are compatible.
- 4.2 Ensure the gas supply delivers the required amount of gas and is in accordance with the rules in force.
- 4.3 Soft copper tubing can be used on the installation and soft soldered joints outside the appliance and below the firebed.
- 4.4 A factory fitted isolation device is part of the inlet connection; no further isolation device is required.
- 4.5 All supply gas pipes must be purged of any debris that may have entered prior to connection to the appliance.
- 4.6 The gas supply enters through the rear of the LEFT-HAND side of the outer box:
- 4.7 The gas supply must be installed in a way that does not restrict the removal of the appliance for servicing and inspection.

Installation Instructions

Site Requirements

5. Ventilation

- 5.1 This appliance requires no additional ventilation.

6. Appliance Location

- 6.1 This appliance has been designed to stand on either a hearth or an optional bench:

Code	Bench	Width
RVACLB100B	Riva Bench Low	1000mm
RVACB100B	Riva Bench	1000mm
RVACLB120B	Riva Bench Low	1200mm
RVACB120B	Riva Bench	1200mm
RVACLB140B	Riva Bench Low	1400mm
RVACB140B	Riva Bench	1400mm

6.2 To install the bench:

Follow Section 1, Installation - All Models in the installation guide (PM205) supplied with the bench kit.

6.3 To secure the appliance to the bench:

You must consider where you place the appliance on the bench before using the template, see Diagram 2.

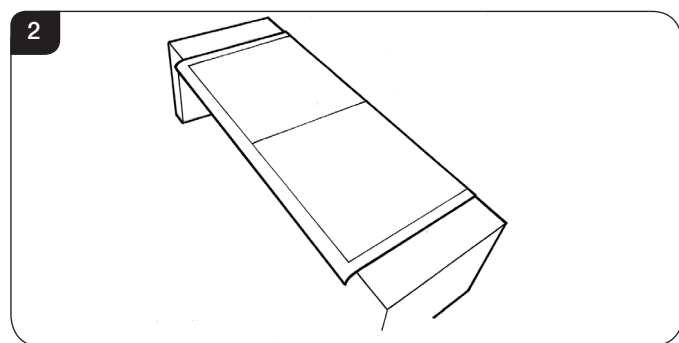

Using the template provided with this appliance as a guide to the final position of the appliance:

1. Mark and drill the holes.
 2. Fix the two brackets to the bench. For details refer to Installation Instructions, Section 2.
 3. Position the appliance on the bench lining up the holes in it's base with the fixing plates, see Installation instructions, Section 2.
- 6.4 The non-combustible hearth must be at least 12mm thick, and project a minimum of 50mm from the base of the appliance in all directions.

- 6.5 The appliance is not suitable for installation against a combustibile wall. A combustibile side wall must be a minimum of 150mm from the appliance.
- 6.6 This appliance can be installed with an up and out flue (vertical wall - horizontal flue) or with a vertical flue with roof termination (see **Flue Options, Section 2 Site Requirements**).
- 6.7 **Clearances to Non-combustible Walls**

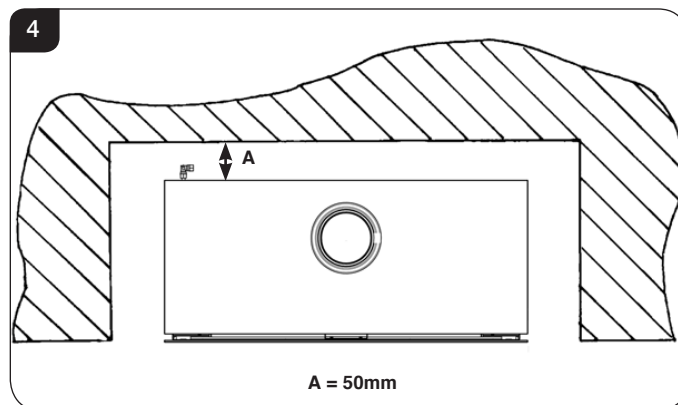
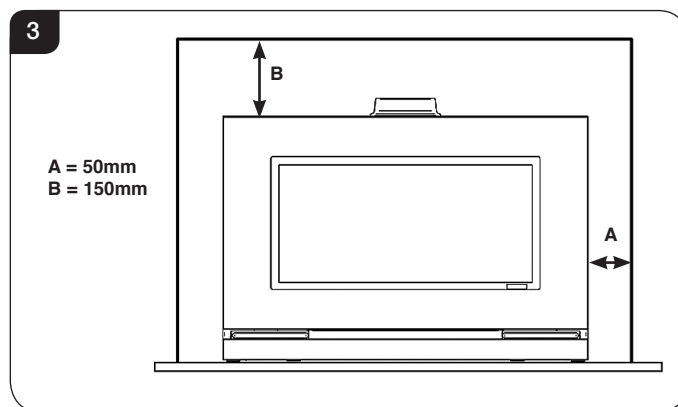

- 6.8 A combustibile shelf must be a minimum of 400mm above the top of the appliance. This is based on a 150mm deep shelf. For every extra 13mm of depth add 25mm above the 400mm from the top of the appliance.

Installation Instructions

1. Safety Precautions

- 1.1 For your own and other's safety, you must install this appliance according to local and national codes of practice. Failure to install the appliance correctly could lead to prosecution. **Read these instructions before installing and using this appliance.**
- 1.2 These instructions must be left intact with the user.
- 1.3 Do not attempt to burn rubbish on this appliance.
- 1.4 Keep all plastic bags away from young children.
- 1.5 Do not place any object on or near to the appliance and allow adequate clearance above the appliance.

IF THE APPLIANCE IS EXTINGUISHED OR GOES OUT IN USE, WAIT 3 MINUTES BEFORE ATTEMPTING TO RELIGHT THE APPLIANCE.



IMPORTANT: REFER TO DATA BADGE AND TECHNICAL SPECIFICATION AT THE FRONT OF THE MANUAL TO ENSURE THE APPLIANCE IS CORRECTLY ADJUSTED FOR THE GAS TYPE AND CATEGORY APPLICABLE IN THE COUNTRY OF USE.

FOR DETAILS OF CHANGING BETWEEN GAS TYPES REFER TO SERVICING, SECTION 15, REPLACING PARTS.

Unpacking

- 1.6 Remove the appliance from its packaging, and check that it is complete and undamaged.
- 1.7 The glass lid is stored on top of the appliance. Remove and store in a safe place.

Put the loose ceramic parts to one side so that they are not damaged during installation.

2. Installation of the Appliance



IMPORTANT: THE OUTER PANNELLING OF THE VISION IS MADE FROM GLASS. USE CAUTION WHEN INSTALLING, REMOVING AND STORING AS THE COMPONENTS ARE FRAGILE AND COULD BREAK UNLESS HANDLED CAREFULLY.



Please note: As an optional extra Gazco can provide a mains adapter to supply constant power to the appliance control box instead of the battery pack.

If installing an appliance with the adapter make provision for a mains power socket within 1.5m of the control box and follow the instructions provided.

- 2.1 Remove the front from the appliance by lifting clear of the slotted hooks, see Diagram 1.

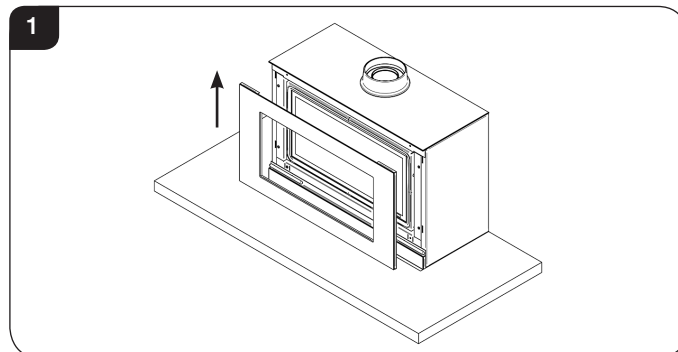

Use the hex key provided to release the window locks moving each from shut to open towards the outer edge of the glass door, see Diagram 2.

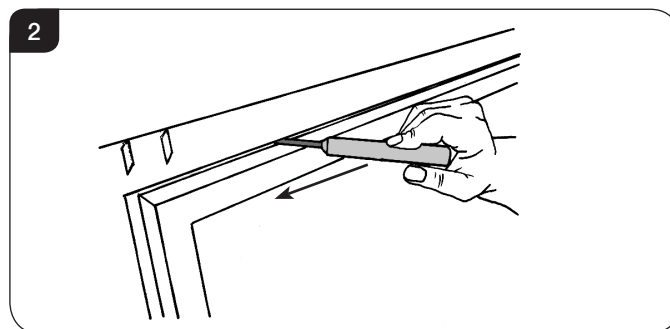

- 2.2 Remove the box from the appliance and store safely as it contains the remote control and fuel effects.
- 2.3 Remove all the enamel or vermiculite liners where necessary.
- 2.4 Remove the two screws securing the access panels to reveal the isolating elbow and pressure test point.

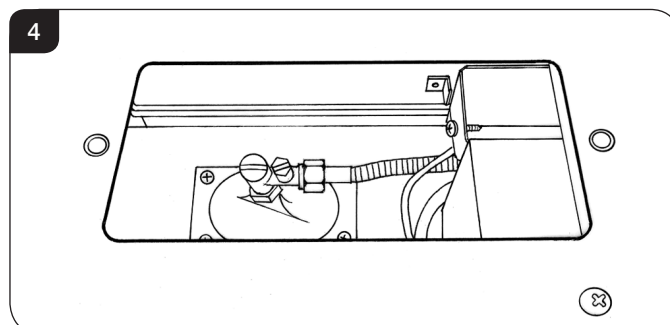
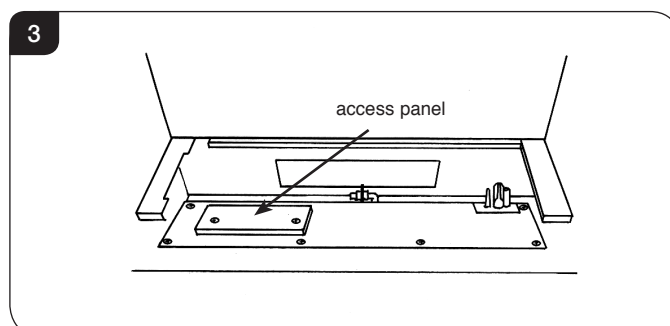

A drilling template is supplied in order to locate the fixing plates.

Installation Instructions

- 2.5 Remove the battery holder.

DO NOT PULL THE BRACKET AS THE BATTERY LEADS ARE ATTACHED. PLACE TO ONE SIDE. THIS IS TO ACCESS THE LEFT HAND FIXING, SEE DIAGRAM 5.

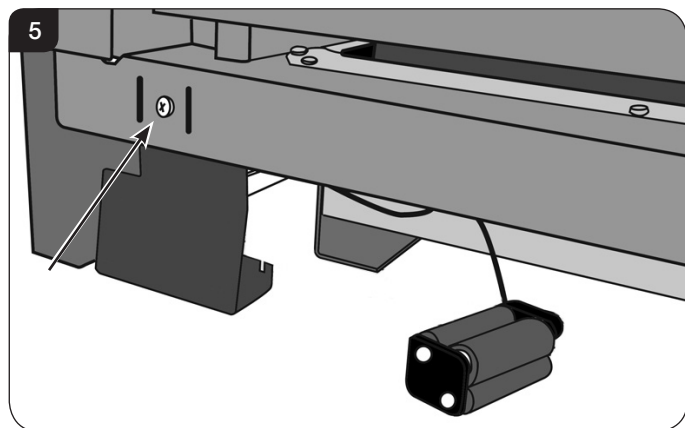

- 2.6 Following the template instructions. Fix the two brackets either to the hearth or the bench, see Diagram 6.

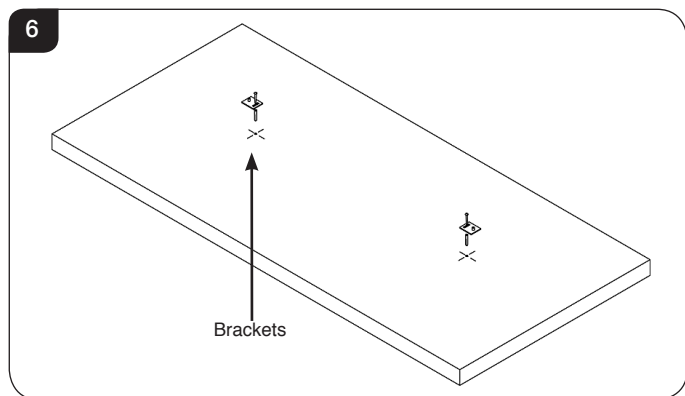

- 2.7 Lift the appliance so as to locate the carcass onto the fixing plates. There are two large holes the lower flanges on the front edges of the base, see Diagram 7.

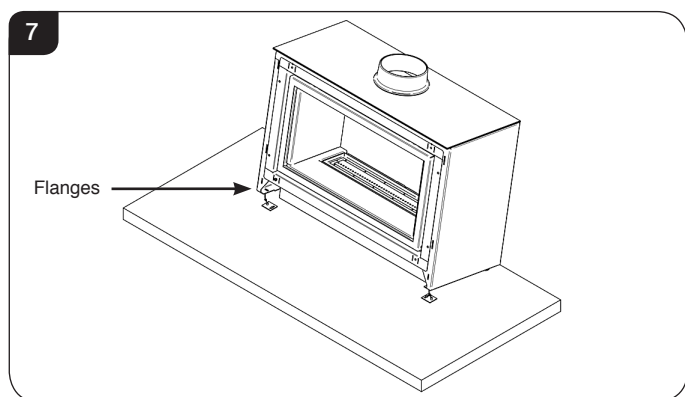

- 2.8 Place the two large washers over the studs and fix with two wing nuts, see Diagram 8.

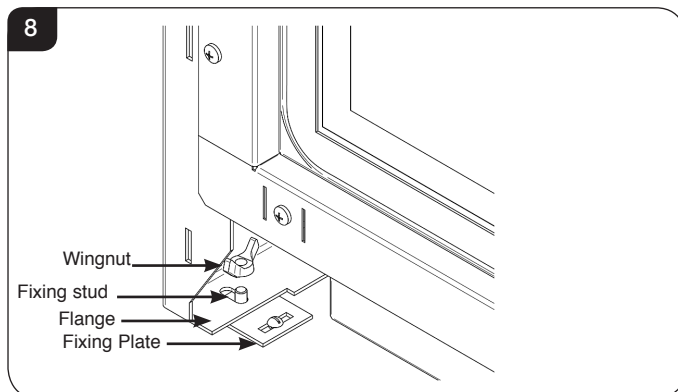

- 2.9 Replace the battery holder.

3. Flue Assembly

- 3.1 Refer to **Site Requirement, Section 2, Flue Options.**

ENSURE THE BLACK DECORATIVE TOP AND COLLAR IS FITTED TO THE TOP OF THE APPLIANCE PRIOR TO INSTALLATION OF THE FLUE.

TAKE CARE WHEN MARKING OUT FOR THE FLUE AS IT IS DIFFICULT TO MOVE AFTER INSTALLATION. IF A RESTRICTOR IS REQUIRED FIT THIS BETWEEN THE SMALL OUTLET SPIGOT AND THE AIR DUCT SEE DIAGRAM 9. REFER TO TECHNICAL SPECIFICATIONS FOR RESTRICTOR SIZE.

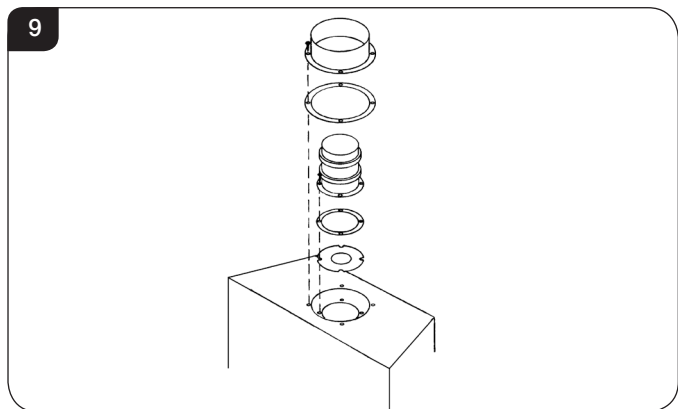

- 3.2 A 152mm (6") diameter hole in the wall is required to install the flue. This can be achieved by either:

- a) Core drill
- b) Hammer and chisel

- 3.3 Drill small holes around the circumference when using method b. Make good both ends of the hole.

- 3.4 Allow enough room either above or to the side of the appliance to assemble the flue on top.

- 3.5 Assemble a horizontal flue in the following order:

- Vertical section
- 90° elbow
- Horizontal plus terminal

Installation Instructions

- 3.6 Support the opening of a masonry installation with a lintel.
- 3.7 Only the horizontal terminal section can be reduced in size.
To find the length:
- 3.8 Measure from the outside of the wall to the stop on the 90°.
- 3.9 **Add 10mm to the outlet end.**
- 3.10 Measure from the edge of the slots closest to the wall.
- 3.11 Mark around the flue, see Diagram 10.

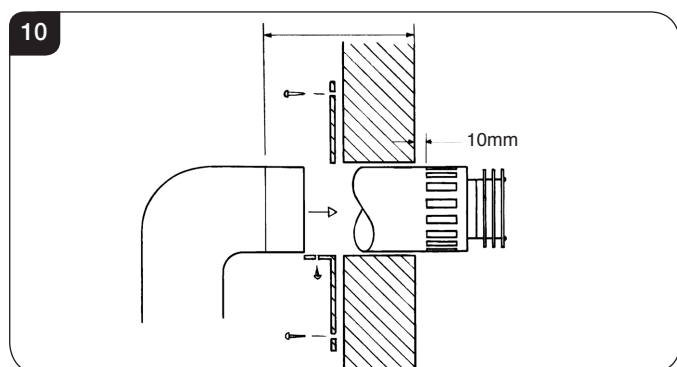

A wall plate is supplied to fix the flue to the wall:

- 3.12 Bend the tab to 90°.
- 3.13 Assemble the plate onto the flue but wait to secure to wall and flue after the flue is fully assembled, see Diagram 10.
- 3.14 The cardboard fitment in the terminal is used to support the flue whilst it is cut to length. **ONCE CUT TO SIZE, REMOVE THE CARDBOARD REMNANT**, see Diagram 11.

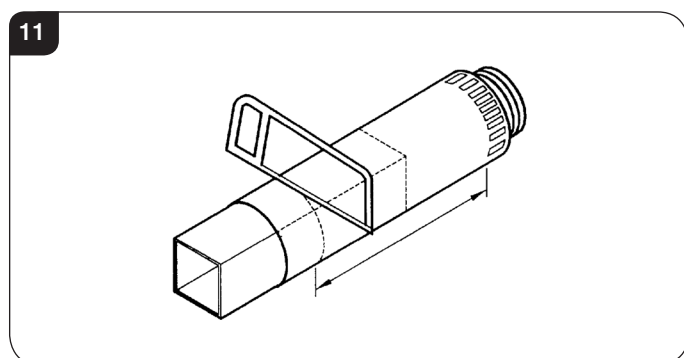

- 3.15 **PURGE THE SUPPLY PIPE.** This is essential to expel any debris that may block the gas controls.
- 3.16 Connect the gas to the 8mm elbow on the rear of the appliance.

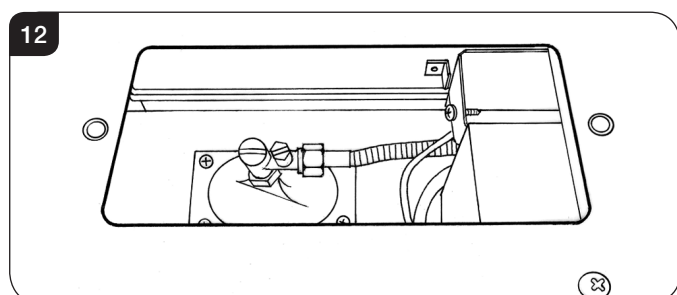

- 3.17 Connect a suitable pressure gauge to the test point located on the inlet fitting.
- 3.18 Turn on the gas.
- 3.19 Light the appliance and check for leaks.
- 3.20 Turn the appliance to maximum and check that the supply pressure is as stated on the data badge.
- 3.21 Turn off the gas and replace the test point screw.
- 3.22 Turn the gas back on and check the test point for leaks.

4. Assembling the Appliance

- 4.1 The Vision appliances have the option of 3 different liner finishes:

Vermiculite
Black Reeded Panels
Black Glass Linings

Vermiculite & Black Reeded

NOTE: ALL FRONT PANELS ARE IN TWO PIECES.

HOLD THE REAR PANELS UNTIL ALL THE OTHER PANELS ARE IN PLACE AS THEY CAN FALL FORWARD.

- 4.2 Place the rear panel(s) behind the locating bracket on the rear support bar.
- 4.3 Centralise the rear panel(s) with the chamfers touching and pushed together, see Diagram 13.

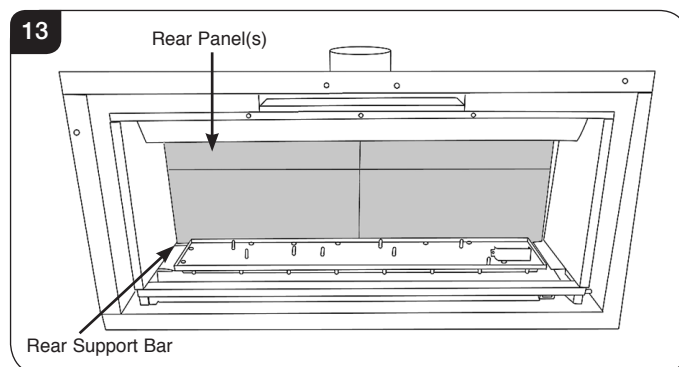

- 4.4 Place the lower side and front panels in position so the chamfers meet at the front edge of the burner.

Installation Instructions

- 4.5 Ensure the 2-piece front panels are engaged against the centre support tags on the burner and are pushed together in the middle, see Diagram 14.

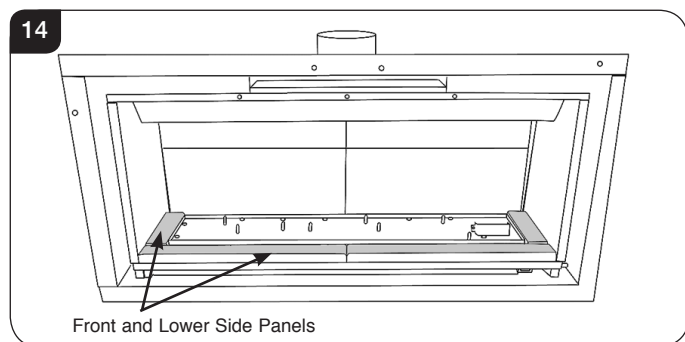

- 4.6 Slide the 2 side panels up to the rear panel, see Diagram 15.

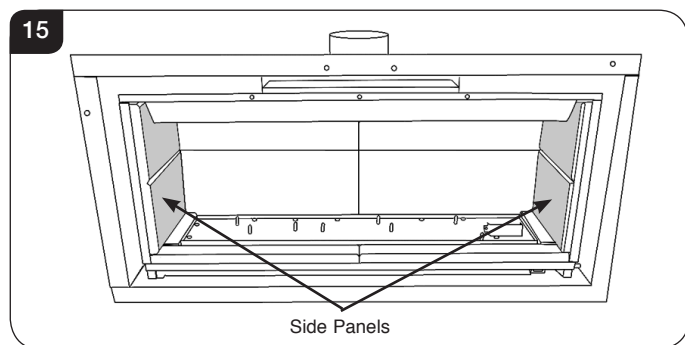

NOTE: THE HORIZONTAL CHAMFERS MUST ALIGN ON THE REAR AND SIDE PIECES.

Black Glass

NOTE: ALL REAR PANELS ARE ONE PIECE.

HOLD THE REAR PANEL UNTIL ALL THE OTHER PANELS ARE IN PLACE AS THEY CAN FALL FORWARD.

- 4.7 Place the lower side and front panels in position so the chamfers meet at the front edge of the burner.
- 4.8 Ensure the 2-piece front panels are engaged against the centre support tags on the burner and are pushed together in the middle, see Diagram 16.

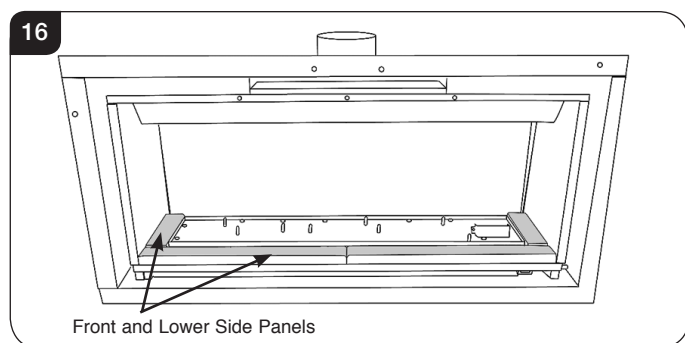

- 4.9 Fit and centralise the rear panel, see Diagram 17.

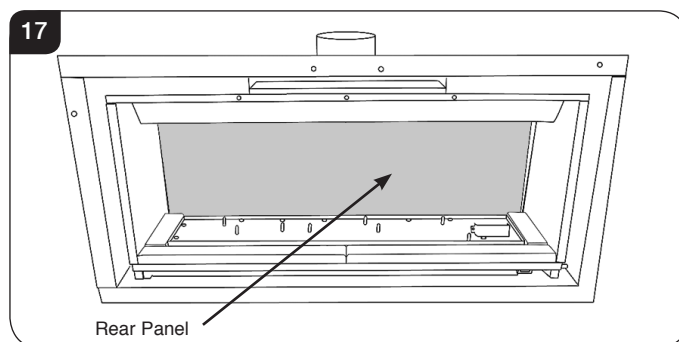

- 4.10 Slide the 2 side panels up to the rear panel, see Diagram 18.

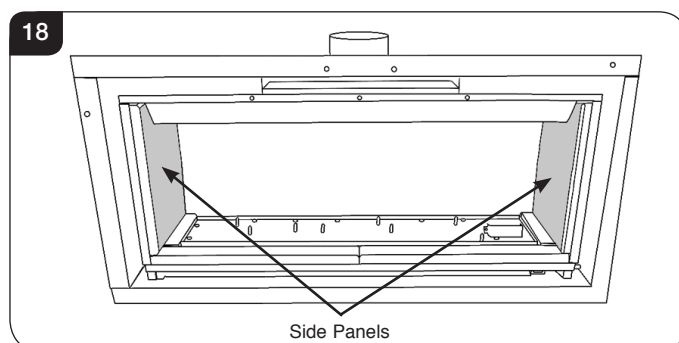

5. Arrangement of the fuel bed

Advice on handling and disposal of fire ceramics



The fuel effect of the log version of this appliance is made from Refractory Ceramic Fibre (RCF), a material which is commonly used for this application.

Protective clothing is not required when handling these articles, but we recommend you follow normal hygiene rules of not smoking, eating or drinking in the work area and always wash your hands before eating or drinking.

To ensure that the release of RCF fibres are kept to a minimum, during installation and servicing a HEPA filtered vacuum is recommended to remove any dust accumulated in and around the appliance before and after working on it. When servicing the appliance it is recommended that the replaced items are not broken up, but are sealed within heavy duty polythene bags and labelled as RCF waste.

RCF waste is classed as stable, non-reactive hazardous waste and may be disposed of at a licensed landfill site.

Excessive exposure to these materials may cause temporary irritation to eyes, skin and respiratory tract; wash hands thoroughly after handling the material.

Installation Instructions

5.1 **White Stone Effect:** To replace the white stone effect, make sure they are flattened so they are level with the rim of the tray.

5.2 **Lava Rock for Log Layout:** Use the entire bag of supplied Lava Rock.

TAKE CARE NOT TO SPILL THE EFFECT INTO THE PILOT AREA.

STACK STONE EFFECT IN FRONT OF THE PILOT SHIELD TO OBSCURE THE BLACK METAL SHIELD.

ONLY GENUINE GAZCO PARTS CAN BE USED IN THIS APPLIANCE.

6. Pebble & Stone Layout

PEBBLES & STONES MUST BE POSITIONED ACCORDING TO THE FOLLOWING INSTRUCTIONS TO GIVE THE CORRECT FLAME EFFECT.

The burner tray has a log elevator that must be removed prior to positioning the pebble and stone effect, see Diagram 19.

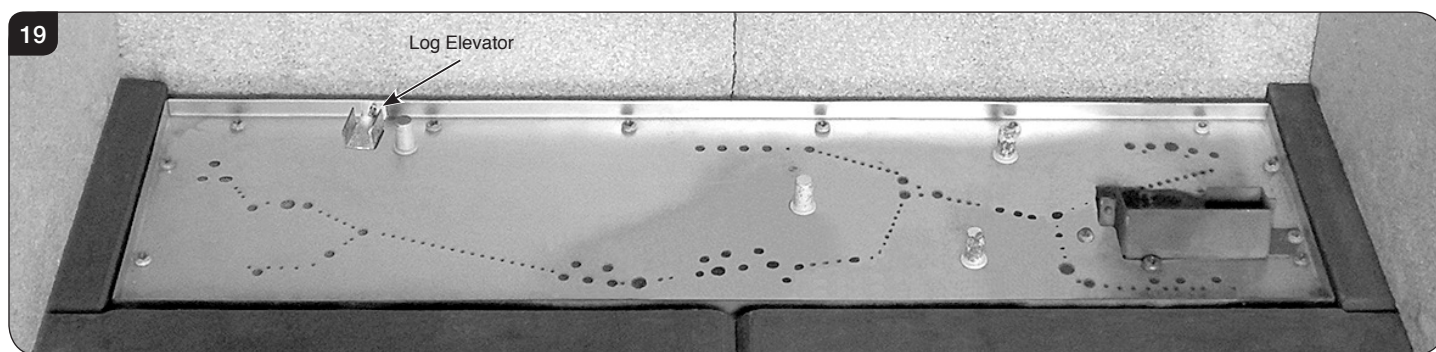

All pebbles can be identified by a number (ranging 1 - 18) on their underside. Pebbles 1, 3, 4, 5 & 12 have holes which locate onto a burner stud (please note that the Vision does not have Pebble 12).

6.1 Evenly spread the white stones over the fuel bed.

6.2 Position Pebbles 3*, 4*, 5* & 1* on to the locating studs in the burner tray.

NOTE: Pebble 4 on the front left corner of the burner tray and Pebble 5 on the front edge do not have a locating stud.

Once in position, place the remaining pebbles and embers in the below order, see Diagram 20.

Spread a liberal amount of the Embaglow fibres provided on the sections highlighted - Ensure the material is placed loosely to create a random glow.

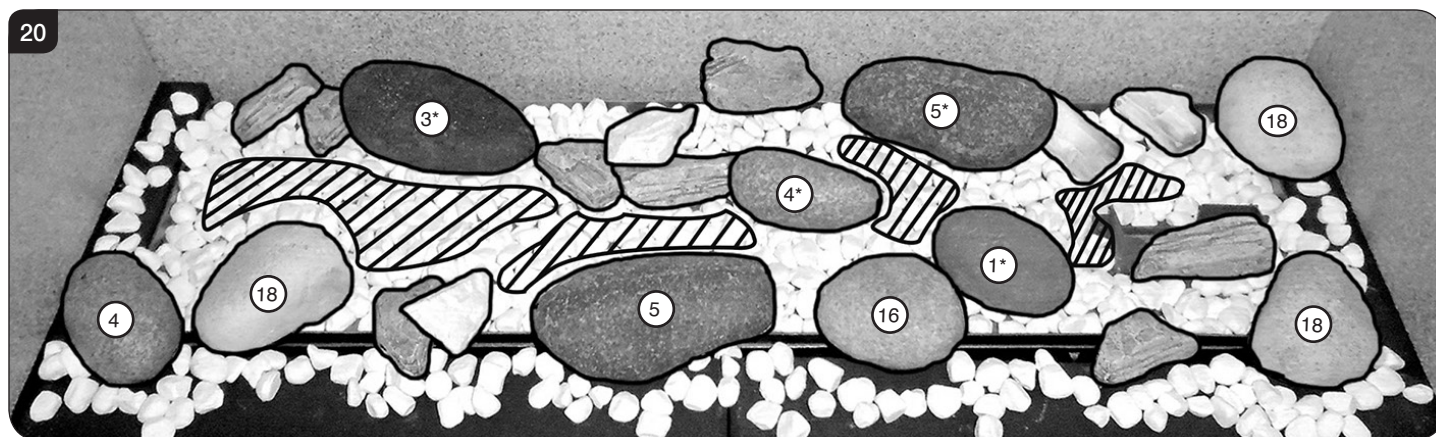

Installation Instructions

7. Log Layout

LOGS MUST BE POSITIONED ACCORDING TO THE FOLLOWING INSTRUCTIONS TO GIVE THE CORRECT FLAME EFFECT.

All logs can be identified by a letter (A - H) on their underside. Logs C and B have holes to locate each onto a burner stud (please note that the Vision does not have Logs G, E, or F).

- 7.1 Position log B on the left hand side of the burner tray, locating onto the middle and back left studs and resting on the bracket.

Cover the remainder of the tray in lava rock, see Diagram 21.

Take care not to spill the lava rock into the pilot area and the air gaps at the front and rear of the burner tray.



The appliance comes with 5 embers in total, 4 small and 1 large.

- 7.2 Position the 2 small embers in the left and right back corners, followed by 1 ember in the back centre of the appliance (behind Log B) and one in the front, slightly off-centre, see Diagram 22.

The final ember is placed after all the logs are in position.

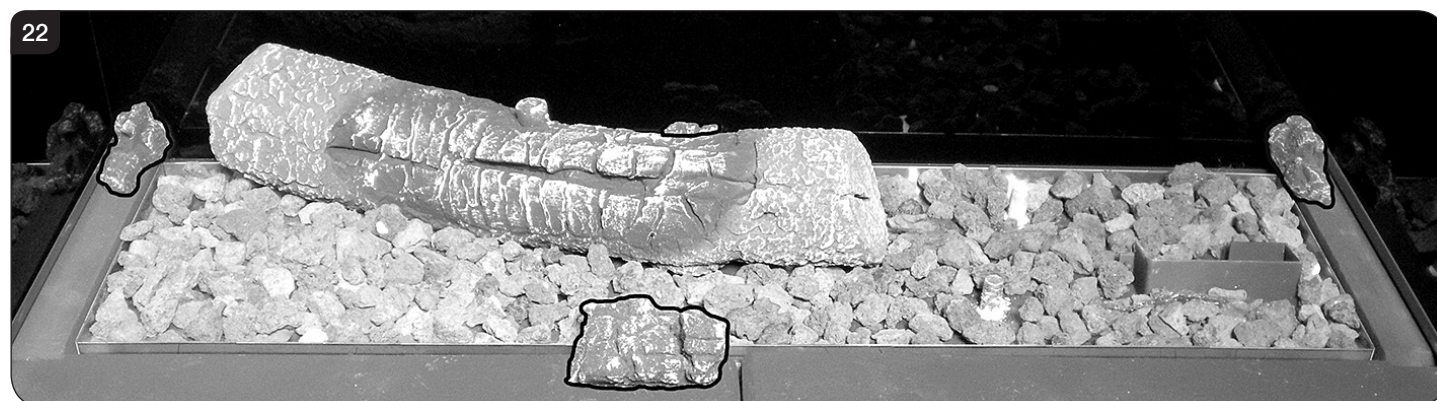

Installation Instructions

- 7.3 Log D is positioned in the rear right hand side of the burner tray, and rests on the Pilot Shield, see Diagram 23.
Log C Locates on the front right stud, and rests on the front ember, see Diagram 23.
Log A rests across Log B, and touches the rear panel, see Diagram 23.

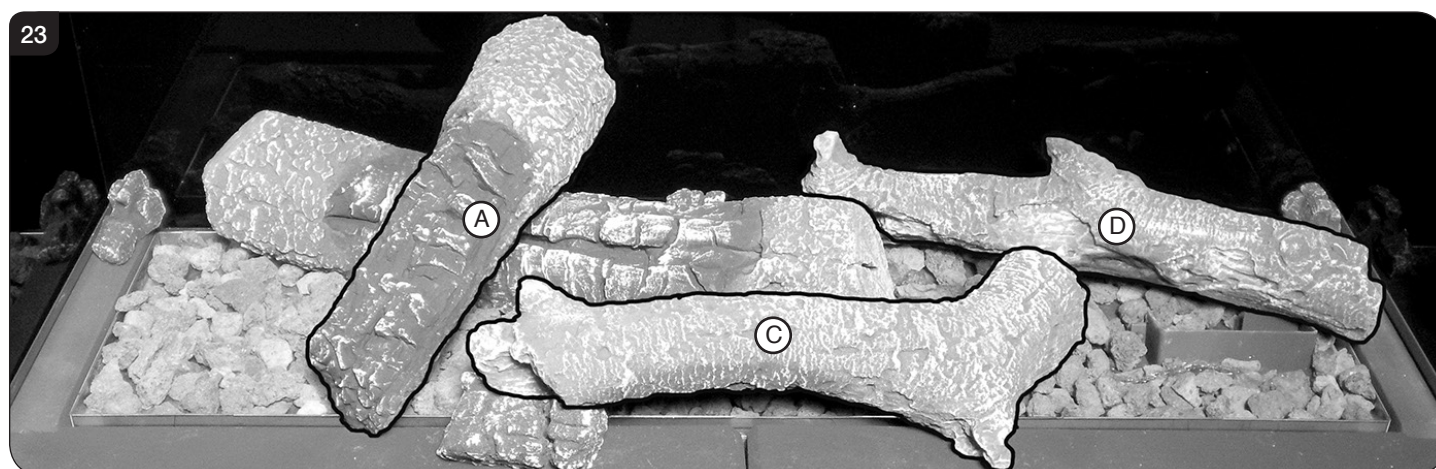

There are 2 Log H's, which are positioned on the front corners of the burner tray.

- 7.4 The left Log H is positioned with the charring facing in to the firebox, and the right is positioned with the charring facing out. Once in position the final ember can be placed between Log C and the right hand Log H, see Diagram 24.



- 7.5 Once all the logs are in place, spread the remaining lava rock across the front and side liners, see Diagram 25. **Take care not to spill the lava rock into the pilot area and the air gaps at the front and rear of the burner tray.**

- 7.6 Break the pieces of slate into 2 pieces and spread randomly across the front liner, see Diagram 25.

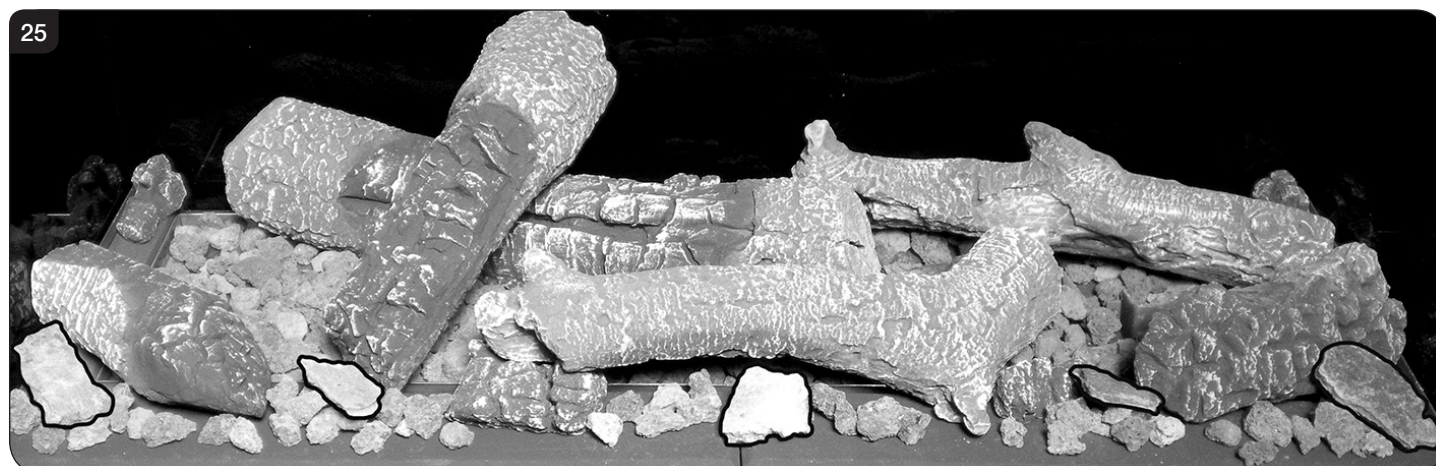

Installation Instructions

Separate the Embaglow material into smaller pieces and pull into shape to create a fine layer.

- 7.7 Place pieces of Embaglow between the logs in the highlighted areas shown in Diagram 26. Ensure the material is placed to create a random glow.

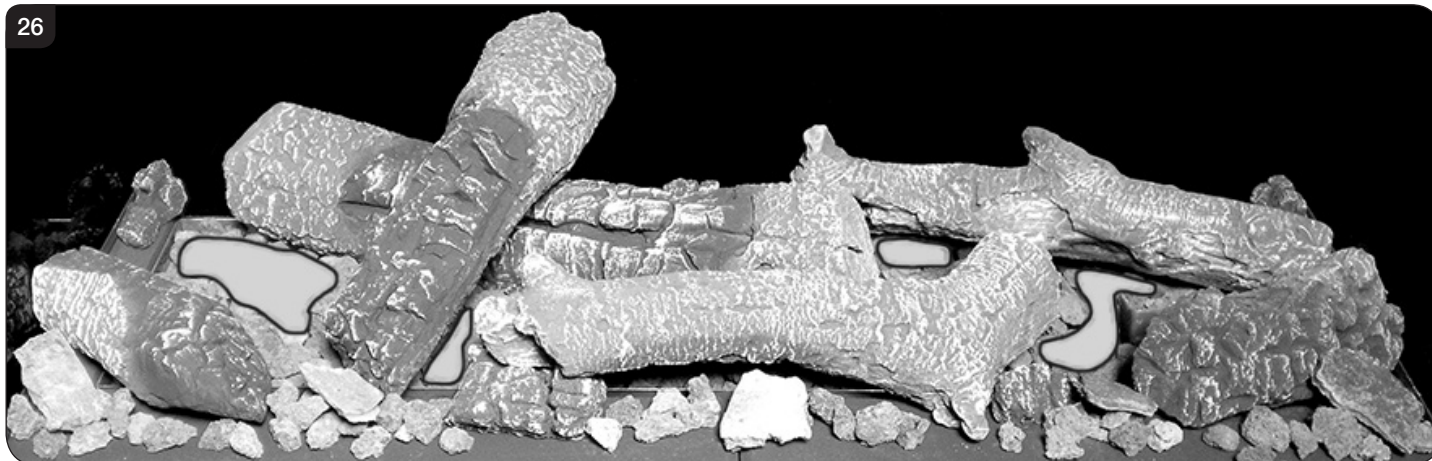

8. Completion of Assembly

- 8.1 To fit the window frame keep the frame in the upright position with the locks uppermost.
- 8.2 Offer the frame to the foot of the opening.
- 8.3 Slide the frame to the right to locate the right hinge pin.

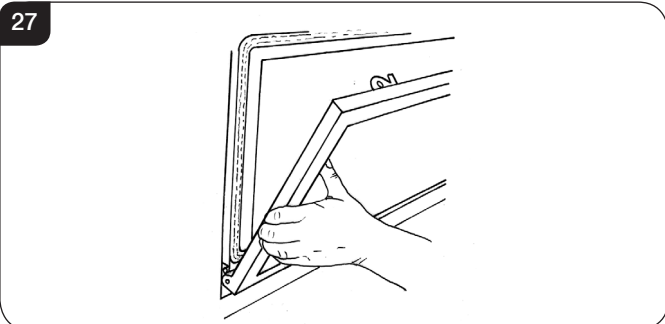

- 8.4 Manoeuvre the frame up towards the left side to locate the left hinge pin.
- 8.5 Slide onto the hinge with a right movement.
- 8.6 Secure in place with a spring clip at the right hinge pin, see Diagram 28.

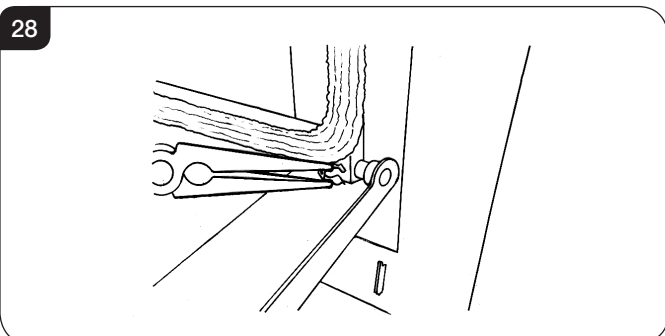

- 8.7 Close the window.

- 8.8 Using the hex key provided close the window locks by moving from open to shut towards the window centre, see Diagram 29.

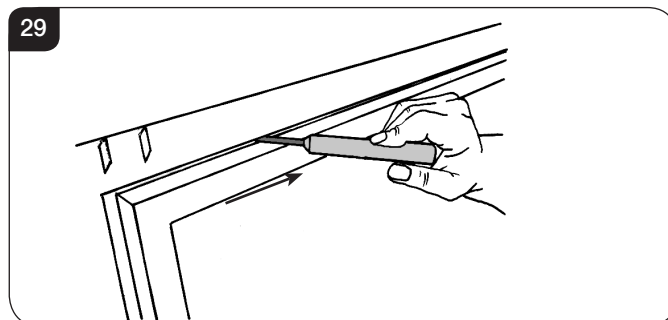

- 8.9 Replace the front by clipping into the four slots that secure it to the appliance.



UNDER NO CIRCUMSTANCES SHOULD THE APPLIANCE BE USED WITHOUT THE CATCHES HOLDING THE DOOR IN PLACE.

9. Lighting the Appliance

The appliance is operated by thermostatic remote control.

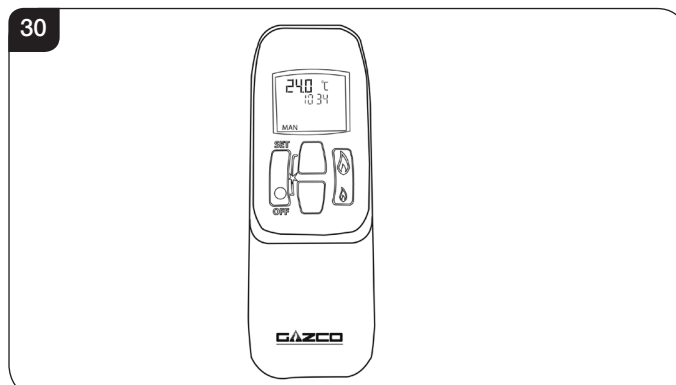

This remote controls the appliance from pilot ignition through to shut down.

Installation Instructions

In 'MANUAL MODE' you can:

- light the pilot
- turn on the main burner
- regulate the flame from low to high and back
- turn off the burner leaving just the pilot burning

In 'TEMP MODE' you can:

- set the room temperature so the stove automatically maintains that temperature

In 'TIMER MODE' the appliance:

- turns on and off according to the set time periods
- automatically regulates the room temperature during the set periods

9.1 Turning the appliance On

Your remote can control the gas appliance from pilot ignition through to shut down.

To turn the appliance on press the OFF button and the UP button simultaneously. You hear several short signals.

The pilot and main burner ignite and the remote is now in Manual Mode:

Turning the appliance Off:

Press the OFF button to turn the appliance off.

FOR SAFETY, YOU MUST WAIT 30 SECONDS BEFORE LIGHTING THE APPLIANCE AGAIN.



IMPORTANT: YELLOW FLAMES TYPICALLY APPEAR WHEN THE APPLIANCE HAS REACHED NORMAL OPERATING TEMPERATURE. THIS CAN TAKE UP TO 30 MINUTES.



WARNING: IF THE APPLIANCE FAILS TO LIGHT OR BECOMES EXTINGUISHED IN USE, WAIT 3 MINUTES BEFORE ATTEMPTING TO RELIGHT.

FOR FULL OPERATING INSTRUCTIONS AND TROUBLESHOOTING SEE USER SECTION.

Troubleshooting



IMPORTANT: In the unlikely event that the handset fails to communicate correctly with the appliance it may be necessary to turn off the gas supply at the isolation valve until any problems can be resolved.

The gas meter and isolation valve can be located outside in a meter box, under the stairs, beneath the kitchen sink or in the garage. Whilst this list is not exhaustive, it is important to be able to identify the location of the valve in case of any gas emergency.

To turn off the gas supply, simply turn the handle so the lever is at 90 degrees to the upright gas pipe.

If you smell gas, open doors and windows and never operate any electrical switches. Immediately call the Gas Emergency Services on 0800 111 999.

Commissioning

1. Commissioning

- 1.1 Complete the Commissioning Checklist at the front of this manual covering:
- Flue checks
 - Gas checks
 - Log layout - flame picture
- For working pressure test, use the access panel at the gas connection ensuring the burner is in position. Refer to Replacement Parts, Section 16.
- 1.2 Ensure all safety checks listed in the Commissioning Section are completed, paying particular attention to the glass panel checks and securing of the glass frame.
- 1.3 Upon completion of the commissioning and testing of the installation and correct operation of the appliance, the installer must instruct the user how to operate the appliance.
- 1.4 Guide the user through the User Instructions paying particular attention to:
- a) Regular servicing (Section 7 of the User Instructions).
 - b) Ventilation (Section 8 of the User Instructions) - point out the ventilation positions where applicable.
 - c) Hot surfaces (Section 10 of the User Instructions).
 - d) How the appliance works with the remote control handset and the modes of operation (Section 2 of the User Instructions).
 - e) How to change settings in the auto mode and program modes of operation.
 - f) What to do if the appliance fails to operate (Section 11 of the User Instructions).
- 1.5 **In the unlikely event that the appliance is receiving interference from other electronic devices, re-programme the handset/Control box.**

Reprogramming handset/Control box

To access the control box see Servicing Instructions, Section 7 - Main Control Assembly.

- Press and hold the reset button on the control box until you hear two signals. After the second longer signal:
- Release the reset button and within 20 seconds:
- Press the DOWN button on the handset until you hear two additional short signals confirming the new code is set.
If there is a single long signal the code learning sequence has failed or the wiring is incorrect.

Servicing Instructions

Servicing/Fault Finding Charts

1. Servicing Requirements

IMPORTANT – The glass panel on this appliance should be checked for any signs of damage on the front face of the glass panel (scratches, scores, cracks or other surface defects). If damage is observed, the glass panel must be replaced and the appliance must not be used until a replacement is installed. Under no circumstances should the appliance be used if any damage is observed. Please isolate the appliance until a replacement glass panel has been obtained and installed. Replacement glass panels can be purchased from Gazco via the retailer from which the appliance was purchased or any other Gazco distributor.

This appliance must be serviced at least once a year by a competent person.

All tests must be carried out in accordance with the current recommendations.

1.1 Before Testing:

- Conduct a gas soundness test for the property ensuring there are no leaks before servicing.
- Check the operation of the appliance before testing.

1.2 Special checks:

- Clean the burner using a vacuum cleaner with a soft brush attachment. Ensure all debris is removed from the burner ports.

- Clean away lint or fluff from the pilot.
- Clean away lint or fluff from under the burner.
- Check the spark gap on the pilot is correct.

1.3 Correct any faults found during the initial test.

1.4 Re-commission the appliance in accordance with Commissioning Procedures of these instructions.

1.5 Advise the customer of any remedial work undertaken.

REPLACE BATTERIES BEFORE ATTEMPTING TO RECTIFY ANY FAULTS.

ELECTRONIC CONTROL VALVE FAULT ANALYSIS

Symptom	Cause	Remedy
3 Short beeps from control	Batteries low in appliance	Replace appliance batteries
No ignition, 5 second continuous tone (there may be several short beeps before)	Loose/damaged wire	Check interrupter block and wires
No ignition, no tone, motor turns slightly when operated	Receiver board damaged	Replace receiver
No pilot flame and control continues to spark	Thermocouple circuit wired incorrectly	Correct wiring
Pilot lights, control continues to spark, valve shuts down after 10 - 30 seconds	1. No spark at pilot burner 2. Loose/damaged wire	1. Rectify spark at pilot burner 2. Check interrupter and wires

IGNITION FUNCTIONAL CHECK 1

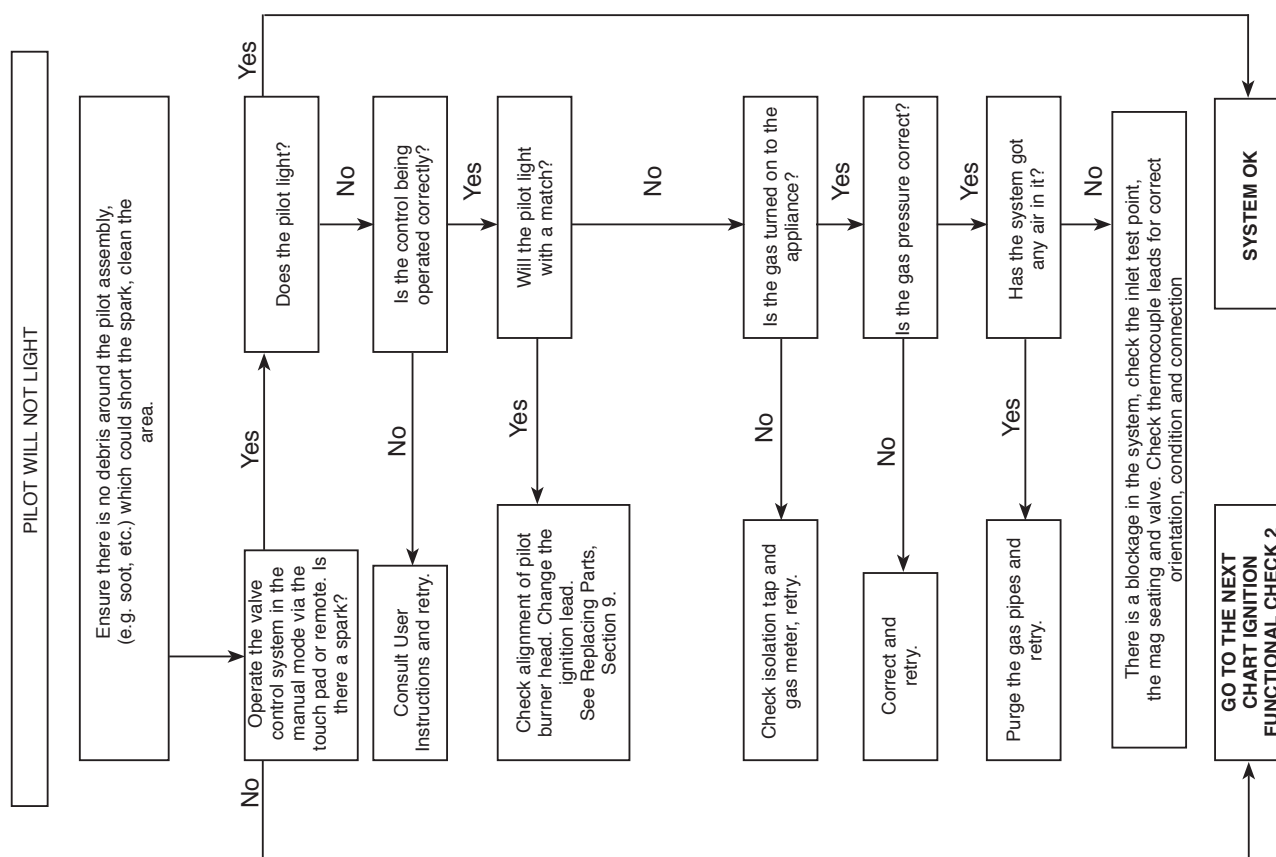

Servicing Instructions

Fault Finding Charts

FLAME FAILURE FUNCTIONAL CHECK 3

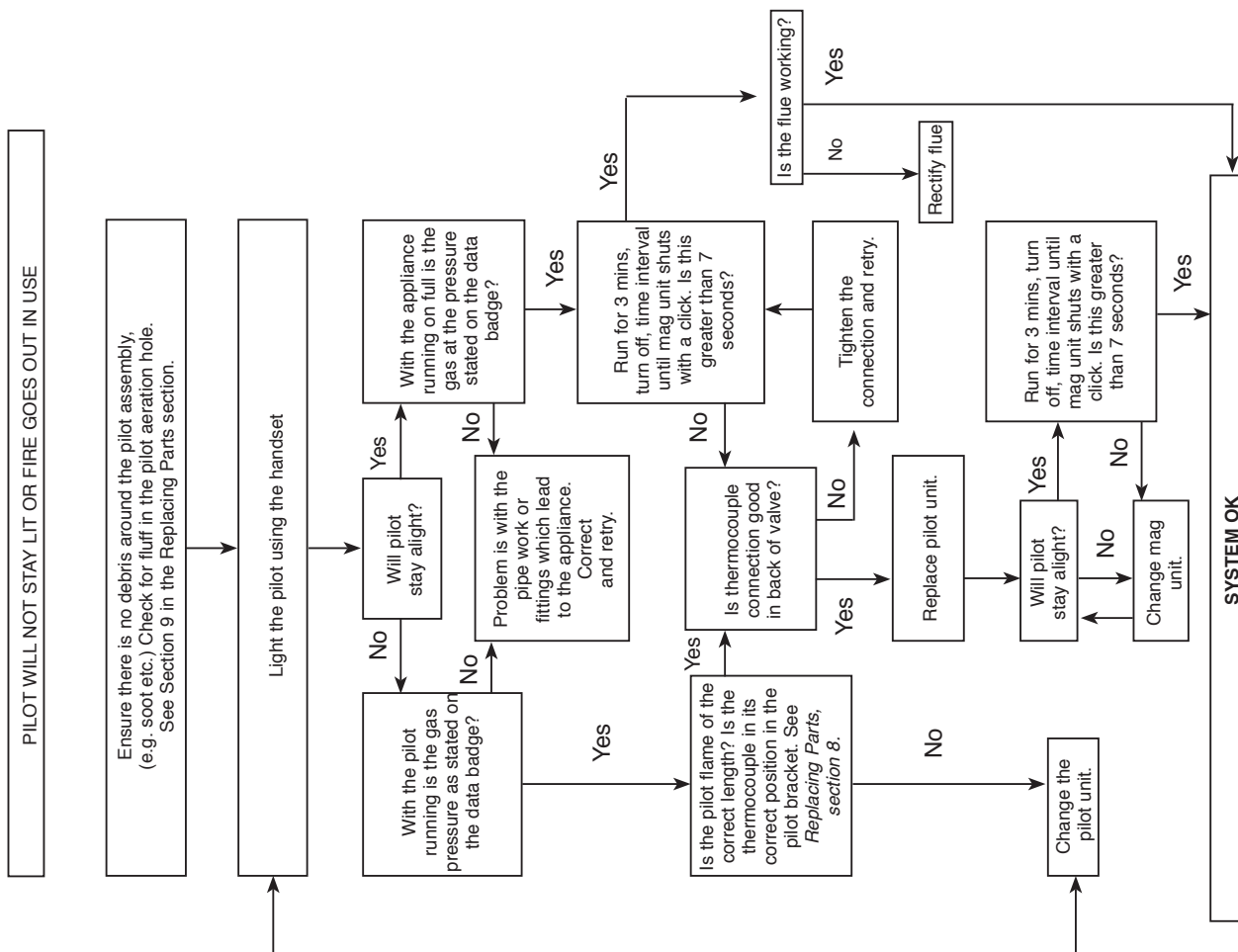

IGNITION FUNCTIONAL CHECK 2

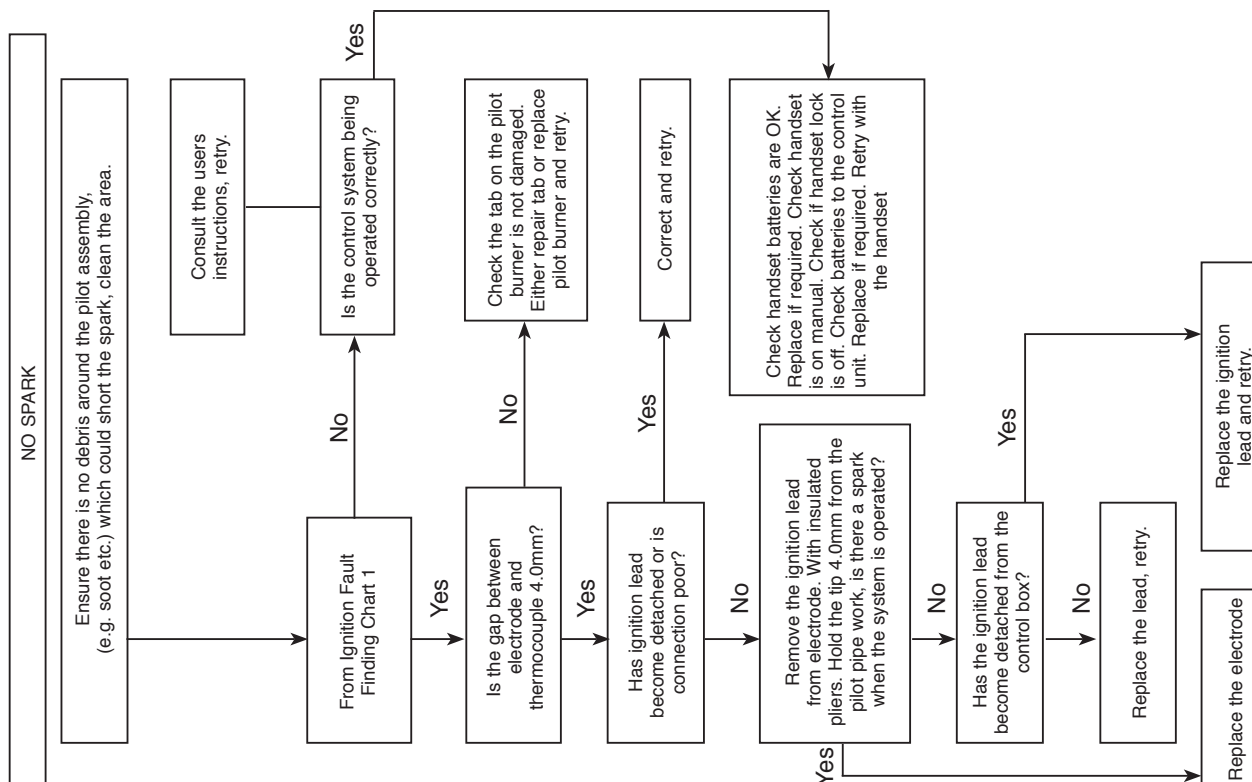

Servicing Instructions - Replacing Parts

1. General

- 1.1 All main components can be replaced without removing the appliance from its installation.

IT IS ESSENTIAL THAT THE GAS SUPPLY TO THE APPLIANCE IS TURNED OFF AT THE ISOLATION DEVICE BEFORE PROCEEDING FURTHER.

- 1.2 **DISCONNECT BATTERIES BEFORE SERVICING THE APPLIANCE.**

- 1.3 **Removal of Flue**

If, for any reason, the flue has to be removed from the appliance, the seal must be replaced in the inner spigot.

- 1.4 Access to the controls is restricted and the whole of the control assembly is to be removed as one unit, see Servicing Section 8.

2. Decorative Front



IMPORTANT: THE OUTER PANELLING OF THE VISION IS MADE FROM GLASS. USE CAUTION WHEN INSTALLING, REMOVING AND STORING AS THE COMPONENTS ARE FRAGILE AND COULD BREAK UNLESS HANDLED CAREFULLY.

1

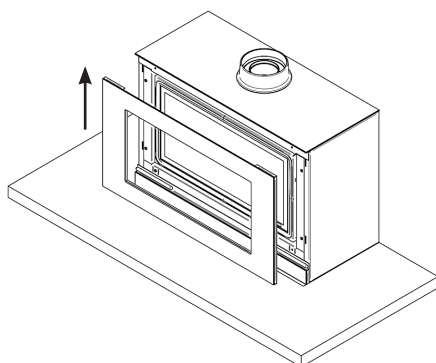

- 2.1 Lift the front off the main body and pull forward.

3. Window Frame Assembly

- 3.1 To open the glass door use the hexagon key provided.
- 3.2 Release the window locks by moving them from shut to open towards the outer edges, see Diagram 2.

2

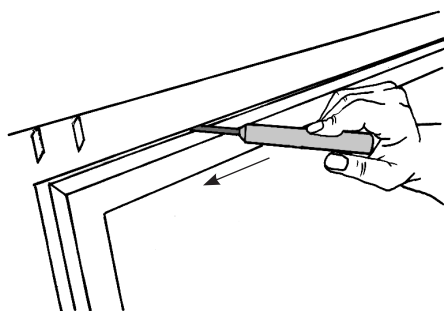

To completely remove the glass front:

- 3.3 Remove the securing spring clip from the bottom-right of the window frame, see Diagram 3.

3

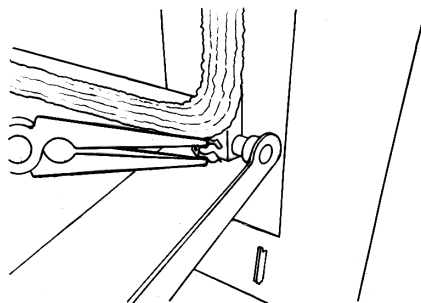

- 3.4 With the window frame in an upright position slide the frame to the left so that it comes off the left hinge pin.

- 3.5 Still keeping the frame upright drop the left side down and forward slightly, see Diagram 4.

4

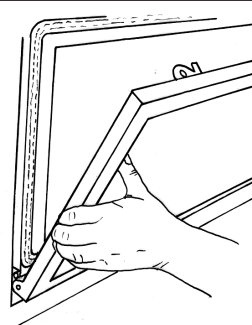

- 3.6 Slide the frame to the right so it comes off the right hinge pin. The window frame should now be free.

- 3.7 Refit in reverse order.

- 3.8 **When closing the door ensure the door catches are fully engaged.**



UNDER NO CIRCUMSTANCES SHOULD THE APPLIANCE BE USED WITHOUT THE CATCHES HOLDING THE DOOR IN PLACE.

4. Glass Window

- 4.1 Remove the 2 clips and brackets from either side of the frame, see Diagram 5.

5

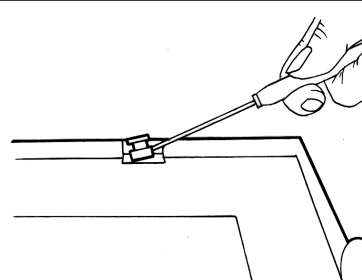

- 4.2 Lift the glass clear from the lock bracket at the top of the frame and slide out.

Servicing Instructions - Replacing Parts

5. Liners

- 5.1 The Vision appliances have the option of 3 different liner finishes:

Vermiculite
Black Reeded Panels
Black Glass Linings

Vermiculite & Black Reeded

NOTE: ALL FRONT PANELS ARE IN TWO PIECES.

HOLD THE REAR PANELS UNTIL ALL THE OTHER PANELS ARE IN PLACE AS THEY CAN FALL FORWARD.

- 5.2 Place the rear panel(s) behind the locating bracket on the rear support bar.
- 5.3 Centralise the rear panel(s) with the chamfers touching and pushed together, see Diagram 6.

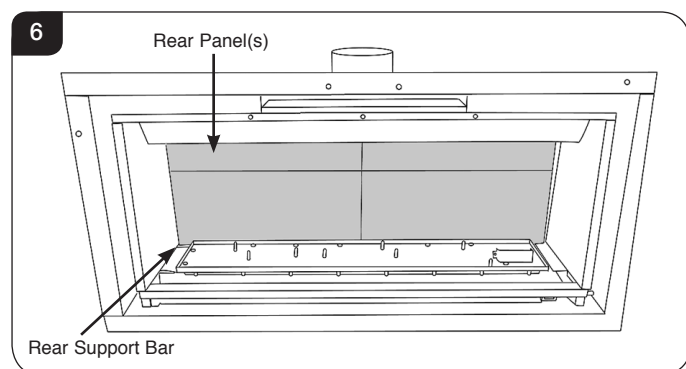

- 5.4 Place the lower side and front panels in position so the chamfers meet at the front edge of the burner.
- 5.5 Ensure the 2-piece front panels are engaged against the centre support tags on the burner and are pushed together in the middle, see Diagram 7.

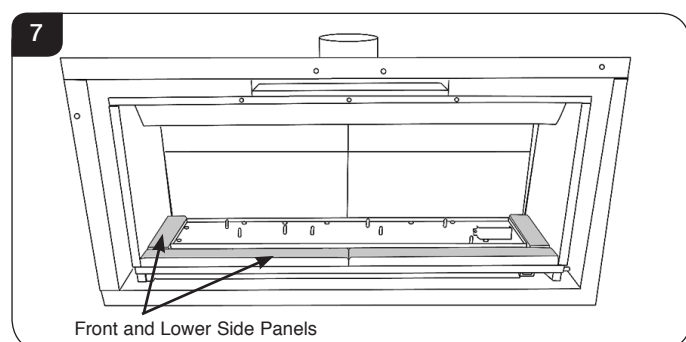

- 5.6 Slide the 2 side panels up to the rear panel, see Diagram 8.

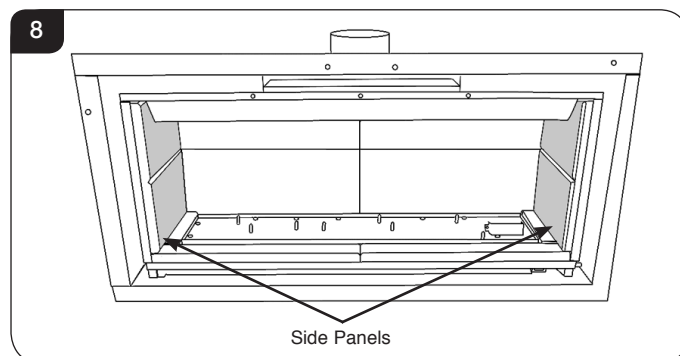

NOTE: THE HORIZONTAL CHAMFERS MUST ALIGN ON THE REAR AND SIDE PIECES.

Black Glass

NOTE: ALL REAR PANELS ARE ONE PIECE.

HOLD THE REAR PANEL UNTIL ALL THE OTHER PANELS ARE IN PLACE AS THEY CAN FALL FORWARD.

- 5.7 Place the lower side and front panels in position so the chamfers meet at the front edge of the burner.
- 5.8 Ensure the 2-piece front panels are engaged against the centre support tags on the burner and are pushed together in the middle, see Diagram 9.

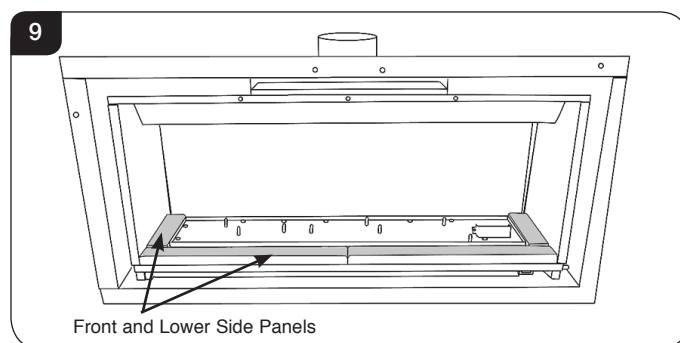

- 5.9 Fit and centralise the rear panel, see Diagram 10.

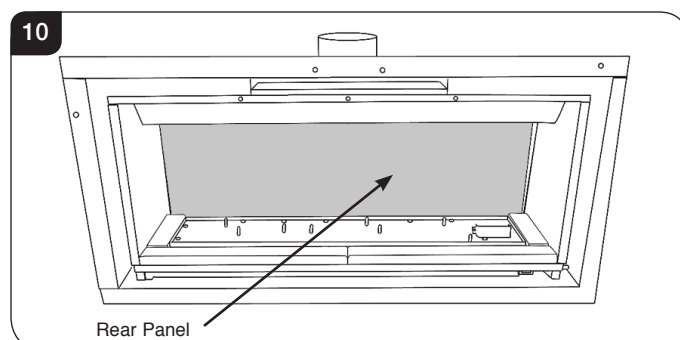

- 5.10 Slide the 2 side panels up to the rear panel, see Diagram 11.

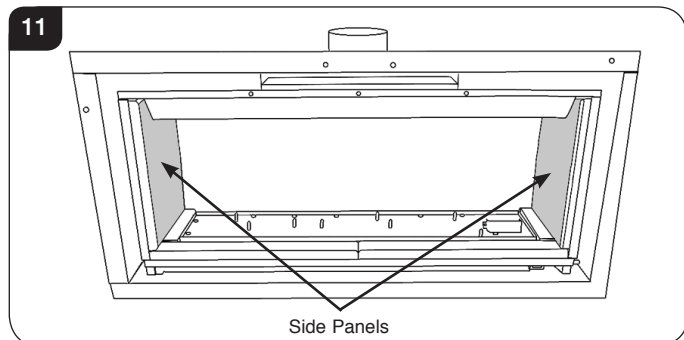

6. Main Burner

To replace the main burner:

- 6.1 Remove the fuel effect from the burner.
6.2 Remove the burner securing screw from the left side of the burner, see Diagram 12.

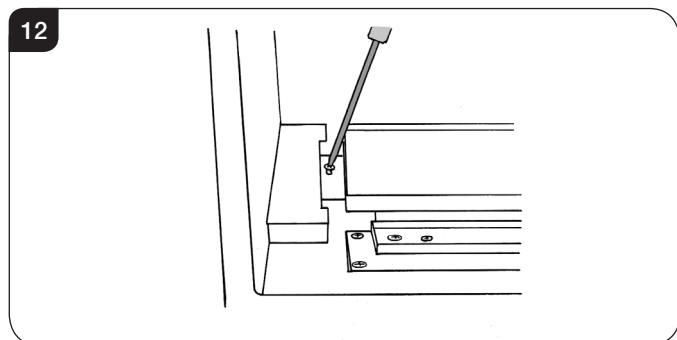

- 6.3 Slide the burner fully to the left.
6.4 Lift the right side clear of the pilot, see Diagram 13.

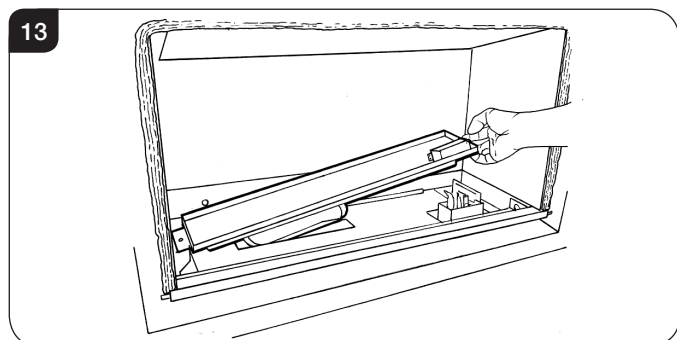

- 6.5 Slide the burner to the right and out of its location.
6.6 Refit in reverse order.
6.7 When refilling the fuel effect fill to the level of the rim of the burner tray and flatten level.

TAKE CARE NOT TO SPILL THE EFFECT INTO THE PILOT AREA.

STACK STONES EFFECT IN FRONT OF THE PILOT SHIELD TO OBSCURE THE BLACK METAL SHIELD.

7. Main Control Assembly

- 7.1 To access the main control assembly first remove:

- The decorative Steel frame (if fitted)
- Window frame
- Main burner
- Splitter plate

- 7.2 To remove the splitter plater:

- Loosen the fixing screws (one each side).
- Lift the front of the plate off the screws.
- Pull forward and upwards, see Diagram 14.

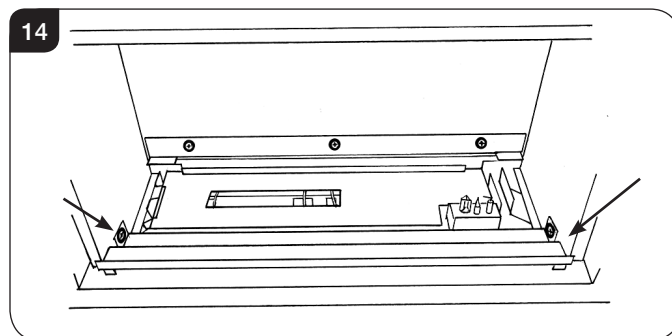

- 7.3 It is now possible to access all of the Main Control Assembly. The control box is covered by a metal bracket, see Diagram 15. Remove the screw securing the bracket and lift off carefully.

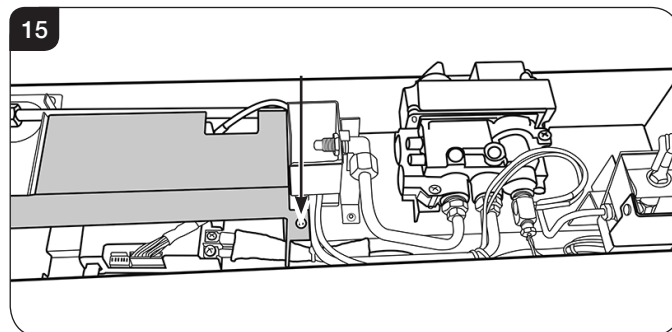

- 7.4 Disconnect the two cables marked 'A' in Diagram 16.

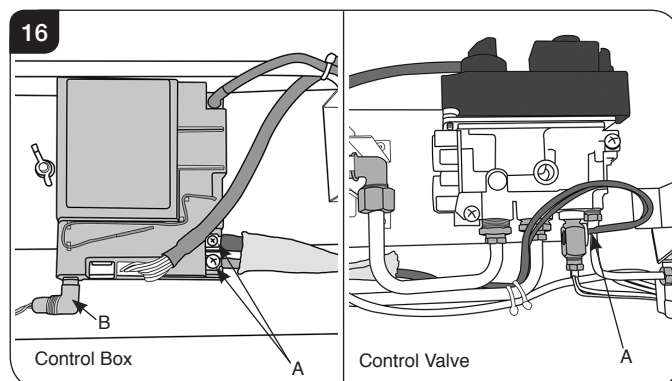

- 7.5 Disconnect the battery extension lead, Diagram 16, B.

The control assembly can now be lifted up and removed.

- 7.6 Reassemble in reverse order.

Servicing Instructions - Replacing Parts

8. Pilot Unit Assembly

- 8.1 Remove the screw retaining the pilot cover.

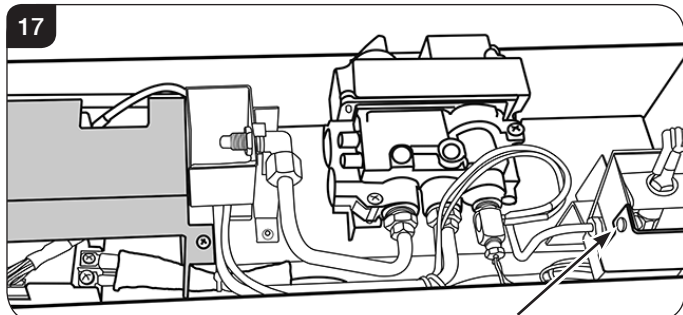

- 8.2 Cut the cable tie retaining the vidaflex sleeve and disconnect the ignition lead from the electrode.

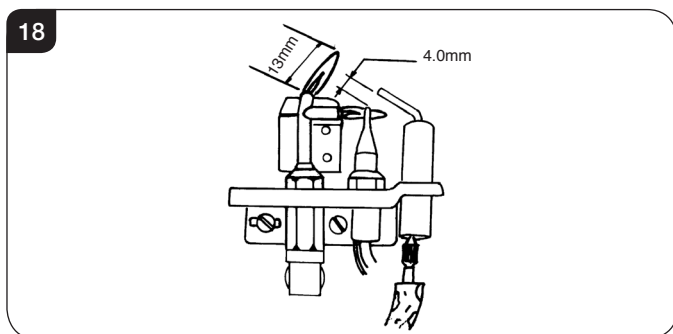

- 8.3 Undo the pilot pipe and thermocouple from the rear of valve.
8.4 Remove the two fixing screws and retain the vidaflex sleeve which is needed for the replacement.
8.5 Replace in reverse order.
8.6 Ensure the thermocouple and ignition lead are threaded through the vidaflex and secured with a cable tie. There is a cut out in the pilot shroud to hold the vidaflex.
8.7 Check for gas leaks.

9. Ignition Lead

- 9.1 Cut the cable tie securing the vidaflex (if present) and disconnect the ignition lead from the electrode.
9.2 Pull the lead through the vidaflex.
9.3 Cut the remaining cable ties and disconnect the lead from the control box, see Diagram 19.

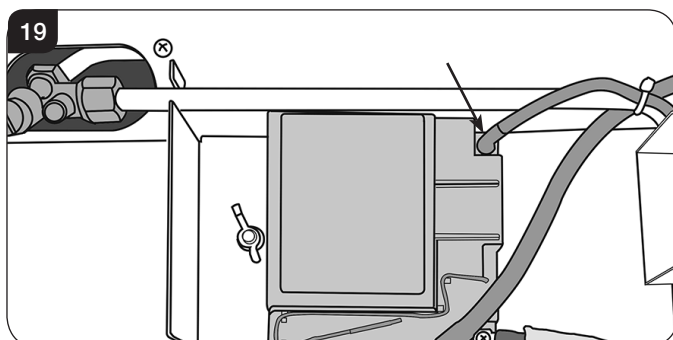

- 9.4 Replace in reverse order.

- 9.5 Ensure the lead is passed through the vidaflex, secured with a cable tie and the red insulated end is attached to the electrode.



NOTE: DO NOT ROUTE THE IGNITION LEAD IN THE VICINITY OF THE ANTENNA ON THE CONTROL BOX. THIS DAMAGES THE COMPONENTS.

10. Gas Valve

To change the gas valve:

- 10.1 Disconnect the gas inlet pipe, Diagram 20, Arrow A.
10.2 Disconnect the gas outlet pipe, Diagram 20, Arrow B.
10.3 Disconnect the pilot pipe, Diagram 20, Arrow C.
10.4 Disconnect the thermocouple, thermo current wires and the interrupter block, Diagram 20, Arrow D.
10.5 Remove the two screws and rotate the valve to access the front.
10.6 The cable can now be removed from the valve, Diagram 20 Arrow E.

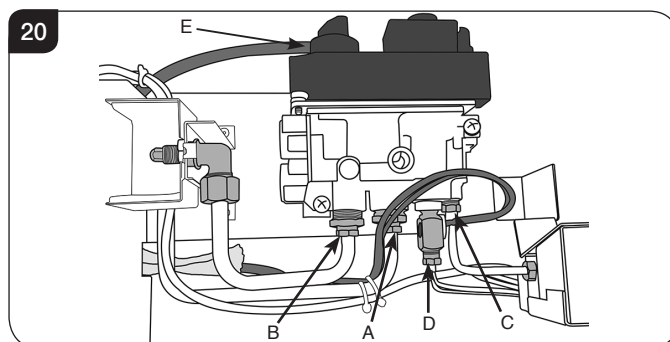

Replace in reverse order ensuring and check for leaks.

11. Magnetic Safety Valve

To replace the magnetic safety valve:

- 11.1 Undo the thermocouple from the interrupter block and remove the two interrupter leads.
11.2 Unscrew the interrupter block from the back of the valve.
11.3 Undo the silver magnetic valve retaining nut on the back of the valve.
11.4 Gently tap out the mag valve.
11.5 Replace with a new unit.
11.6 Reassemble in reverse order ensuring that the interrupter leads are connected correctly with the red tag lead nearest to the gas valve body.
11.7 Check for leaks.

Servicing Instructions - Replacing Parts

12. Control Box

- 12.1 To replace the control box first remove the main control assembly, See Section 7.
- 12.2 Remove the two thermocurrent cables by removing the two screws, Diagram 21.
- 12.3 Remove the ignition lead, Diagram 21.
- 12.4 Remove the eight wire loom from the control box.
- 12.5 Remove the battery extension cable, Diagram 21.

The control box can now be replaced.

When replacing the sealing plate on the rear of the control cover use a suitable silicone sealant.

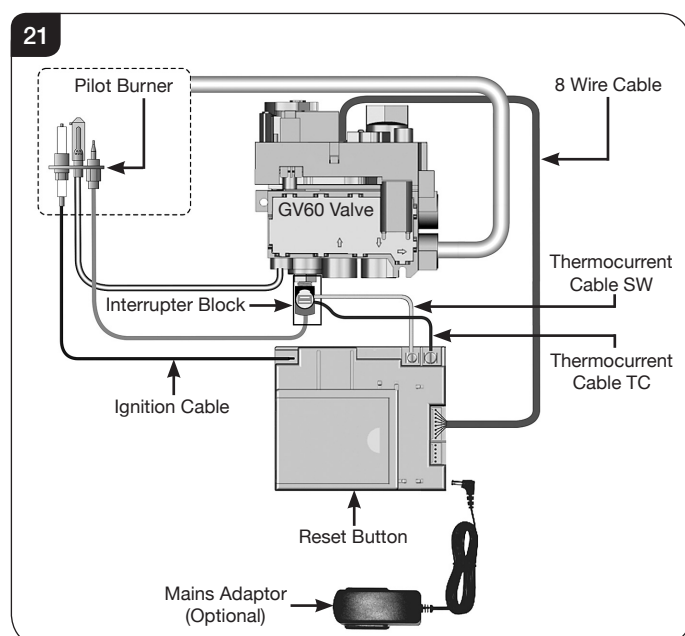

- 12.6 After replacing the control box you may need to reprogram the handset.
 - Press and hold the reset button on the control box until you hear two signals. After the second longer signal:
 - Release the reset button and within 20 seconds:
 - Press the DOWN button on the handset until you hear two additional short signals confirming the new code is set. If there is a single long signal the code learning sequence has failed or the wiring is incorrect.

13. Main Injector

To change the main injector:

- 13.1 Undo the injector feed pipe.
- 13.2 Undo the lock nut from the injector and remove the silencer.
- 13.3 Replace with the correct size injector.
- 13.4 Check for leaks.

14. Primary Aeration Plate

NOT ALL MODELS HAVE AERATION PLATES. REFER TO TECHNICAL SPECIFICATIONS, PAGES 9.

- 14.1 Remove the burner module as described in Replacing Parts Section 6.
- 14.2 Remove the fixing screw and slide the plate off the venturi.
- 14.3 Replace with the correct size plate and secure with the screw. Ensure the lower edge of the plate is located over the venturi flange, see Diagram 22.

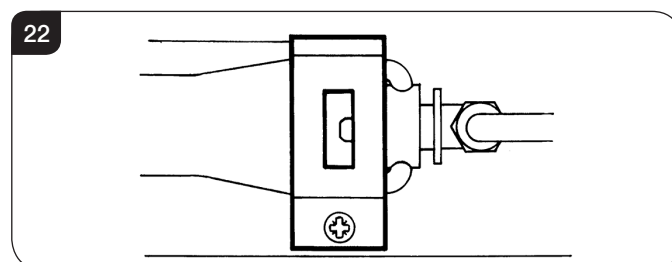

15. Changing Between Gas Types

A kit of parts is available for this - Contact your Gazco retailer for further information.

Always quote the Model number and Serial number when ordering any spare parts.

16. Pressure and leak testing the appliance

- 16.1 Follow Section 7, Main Control Assembly.
- 16.2 Access to the pressure test point can now be reached, see Diagram 23.

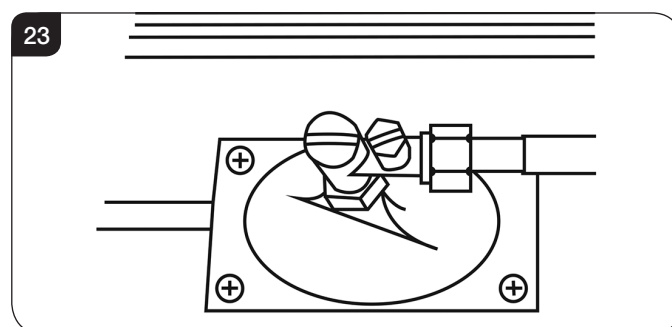

- 16.3 Refer to Installation Instructions, Section 7.48 to check gas pressure.
- 16.4 Light the appliance and spray any joints with leak detector fluid.
- 16.5 Tighten joints or replace as required.
- 16.6 To check the inlet working pressure, replace the control assembly and connect a manometer to the pressure test point, see Diagram 23. Replace the burner and relight the appliance. Operate the appliance at highest flame setting and check that the inlet pressure is in accordance with specifications detailed on page 9.

Servicing Instructions - Replacing Parts

17. Short Spares List

COMPONENT	RIVA VISION LARGE	
	NG	LPG
PILOT INJECTOR	PI0069	PI0070
MAIN INJECTOR	IN0007 - Size 400	IN0040 - Size 185
BURNER ASSEMBLY	GZ13817	GZ13820NZ
AERATION PLATE	GZ3966 - ID Letter L	GZ3269 - ID Letter C
ELECTRODE	PI0075	
THERMOCOUPLE	PI0077	
MAG UNIT	GC0166	
IGNITION LEAD	GC0125	
GAS VALVE	GC0123K	
RECEIVER	EL0589	
HANDSET	EL0571	
INTERRUPTOR BLOCK	GC0124	
THERMOCURRENT CABLE TC	GC0136	
THERMOCURRENT CABLE SW	EL0590	
BATTERY HOLDER	EL0410	
BATTERY CABLE	GC0138	
CONTROL BOX/VALVE CABLE	GC0133	
EMBAGLOW	GZ8471	
LOG SET	CE1839	
PEBBLE & STONE SET	923-632	

LINERS			
	Black Glass	Black Reeded	Vermiculite
LINER BASE SIDE PIECE (2 PER APPLIANCE)	CE1243		
LINER BASE FRONT L/H PIECE	CE1224		
LINER BASE FRONT R/H PIECE	CE1227		
LINER BACK PANEL	GZ13079	CE1225	CE0678
LINER SIDE PANEL L/H	GZ13081	CE1226 (Full Width)	CE0679 (Full Width)
LINER SIDE PANEL R/H	GZ13082		

Service Records

1ST SERVICE

Date of Service:.....
Next Service Due:.....
Signed:.....
Retailer's Stamp/Installer Registration Number

3RD SERVICE

Date of Service:.....
Next Service Due:.....
Signed:.....
Retailer's Stamp/Installer Registration Number

5TH SERVICE

Date of Service:.....
Next Service Due:.....
Signed:.....
Retailer's Stamp/Installer Registration Number

7TH SERVICE

Date of Service:.....
Next Service Due:.....
Signed:.....
Retailer's Stamp/Installer Registration Number

9TH SERVICE

Date of Service:.....
Next Service Due:.....
Signed:.....
Retailer's Stamp/Installer Registration Number

2ND SERVICE

Date of Service:.....
Next Service Due:.....
Signed:.....
Retailer's Stamp/Installer Registration Number

4TH SERVICE

Date of Service:.....
Next Service Due:.....
Signed:.....
Retailer's Stamp/Installer Registration Number

6TH SERVICE

Date of Service:.....
Next Service Due:.....
Signed:.....
Retailer's Stamp/Installer Registration Number

8TH SERVICE

Date of Service:.....
Next Service Due:.....
Signed:.....
Retailer's Stamp/Installer Registration Number

10TH SERVICE

Date of Service:.....
Next Service Due:.....
Signed:.....
Retailer's Stamp/Installer Registration Number

Distributed by



The Fireplace
Head Office & Showroom
12 Tawari Street Mt Eden,
Auckland ph 09 623 6996
www.thefireplace.co.nz

Manufactured by

Gazco Limited, Osprey Road, Sowton Industrial Estate, Exeter, Devon, England EX2 7JG
Technical Customer Services (01392) 261950 Fax: (01392) 261951
E-mail: technicalservices@gazco.com

A member of the Stovax Group
Adapted from English Issue 1

E & O E

