



Fire Your Imagination

Studio Slimline Range

Balanced Flue - Stone Chippings and Log

with Thermostatic Remote Control



IMPORTANT:
FOR EASY TO FOLLOW,
STEP BY STEP VIDEO
INSTRUCTIONS ON HOW TO
OPERATE AND MAINTAIN YOUR
GAZCO REMOTE SYSTEM GO TO
WWW.GAZCO.TV

Instructions for Installation

For use in NZ (New Zealand).

IMPORTANT

THE OUTER CASING, FRONT AND GLASS PANEL BECOME EXTREMELY HOT DURING OPERATION AND WILL RESULT IN SERIOUS INJURY AND BURNS IF TOUCHED. IT IS THEREFORE RECOMMENDED THAT A FIREGUARD IS USED IN THE PRESENCE OF YOUNG CHILDREN, THE ELDERLY OR INFIRM.

This product contains a Heat resistant glass panel. This panel should be checked during Installation and at each servicing interval. If any damage is observed on the front face of the glass panel (scratches, scores, cracks or other surface defects), the glass panel must be replaced and the appliance must not be used until a replacement is installed. Under no circumstances should the appliance be used if any damage is observed, the glass panel is removed or broken.

These Instructions must be left with the appliance for future reference and for consultation when servicing the appliance. Please make the customer aware of the correct operation of the appliance before leaving these instructions with them.

The commissioning sheet found on Page 3 of this Instruction manual must be completed by the Installer prior to leaving the premises.

Contents

Studio Slimline Balanced Flue

Covering the following models:

Model		Studio 1 Slimline	Studio 2 Slimline
Log Effect	Natural Gas	123-191NZ	123-056NZ
	LPG	123-489NZ	123-518NZ
White Stone Effect	Natural Gas	123-238NZ	123-529NZ
	LPG	123-642NZ	123-529NZ

Appliance Commissioning Checklist3

Installation Instructions4

General.....	4
Installation Checklist.....	4
Technical Specifications	5
Site Requirements.....	8

Installation of the Appliance15

Safety Precautions	15
Unpacking.....	15
Installation	15
Installation with Decorative Front.....	19
Installation with Edge Kit.....	23
Installation with Cool Wall kit.....	26
Wallbox Installation.....	29
Flue Assembly	29
Assembling the Appliance	31
Arrangement of the Fuel Bed.....	32
Log Layout.....	32
Completion of Assembly.....	37
Lighting the Appliance	37

Commissioning.....38

WARRANTY

For the length, terms and conditions of the product warranty available in your region please consult your Gazco retailer.



DO NOT OPERATE THIS APPLIANCE BEFORE READING THE INSTRUCTION BOOKLET.
DO NOT PLACE ARTICLES ON OR AGAINST THIS APPLIANCE.
DO NOT USE OR STORE FLAMMABLE MATERIALS NEAR THIS APPLIANCE.
DO NOT SPRAY AEROSOLS IN THE VICINITY OF THIS APPLIANCE WHILE IT IS IN OPERATION.
DO NOT OPERATE WITH PANELS, COVERS OR GUARDS REMOVED FROM THE APPLIANCE
DO NOT MODIFY THIS APPLIANCE.

Appliance Commissioning Checklist

To assist us in any warranty claim please complete the following information:-

IMPORTANT NOTICE

Explain the operation of the appliance to the end user, hand the completed instructions to them for safe keeping, as the information will be required when making any guaranteed claims.

FLUE CHECK	PASS	FAIL
1. Flue is correct for appliance		
GAS CHECK		
1. Gas soundness test		
2. Standing gas Inlet pressure	kPa	kPa
3. Appliance working Inlet pressure (on High Setting) NB All other gas appliances must be operating on full	kPa	kPa

RETAILER AND INSTALLER INFORMATION

Retailer.....
.....
.....

Contact No.....

Date of Purchase.....

Model No.

Serial No.....

Gas Type

Installation Company.....
.....
.....

Engineer.....

Contact No.....

Installer Reg No.

Date of Installation



END USER: Please keep this information safe for future reference.

Installation Instructions

1. General

- 1.1 Installation and servicing must only be carried out by an authorised person.
- 1.2 In all correspondence, please quote the appliance type and serial number, which can be found on the data badge located on a plate under the Main Burner, see Diagram 1.
- 1.3 **Do not** place curtains above the appliance:
You must have 300mm (1') clearance between the appliance and any curtains at either side.
- 1.4 No furnishings or other objects should be placed within 1 metre of the front of the appliance.
- 1.5 If a shelf is fitted, a distance of 400mm above the appliance is required.
- 1.6 If any cracks appear in the glass panel do not use the appliance until the panel has been replaced.
- 1.7 Do not obstruct the flue terminal in any way, i.e. by planting flowers, trees, shrubs etc. in the near vicinity, or by leaning objects against the terminal guard.
- 1.8 Do not put any objects on the terminal guard; it will lose its shape.
- 1.9 If you use a garden sprinkler, do not let quantities of water into the flue terminal.
- 1.10 This product is guaranteed from the date of installation, as set out in the terms and conditions of sale between Gazco and your local Gazco retailer. Please consult with your local Gazco retailer if you have any questions. In all correspondence always quote the Model Number and Serial Number.

1

Gazco Studio 3 (NZ)

Gas Type : Natural Gas

Test Point Pressure : 2.0kPa

Gas Input Rate : 36.4 MJ/h

Max. Supply Pressure : 6.0kPa
(when supplied against a regulator)

Design Standard : EN613:2001

07020PLECHZ PR1051

MODELLNR. MODEL N.	NO. DE MODELO MODEL NUMBER	MODÈLE NO. MODEL NO.	MODEL No.
SERIE NR. N. O. SERIE	NO. DE SERIE VOLGNUMMER	SÉRIE NO. SERIAL NO.	SERIAL No.
PIN-NR. NIP	NIP	NO. TIP PINNUMMER	PIN No.
GASKATEGORIE CAT. DE APARAT			CAT. D'APPAREIL APPL. CATEGORY
CAT. DELL'APPARECCHIO SOORT APPARAAT			ULTRASTRUKTURECATEGORIE
LEISTUNGSKLASSE CLASSE DE RENDIMENTO			EFFICIENCY CLASS EFFICIENCY CLASS
GASTYP TIPO DI GAS			GAS TYPE
GASKATEGORIE CATEGORIE GAS			GAS CATEGORY
GASDRUCK PRESSIONE GAS			GAS PRESSURE
ENERGIECATEGORIE CATEGORIE ENERGIE			ENERGY CATEGORY
BESTIMMUNGSLAND PAIS DE DESTINATION			COUNTRY OF DESTINATION

Data Badge Example:
Individual details may vary.

i **IMPORTANT: NEVER position a television or screen above this appliance.**

2. Installation Checklist

1. **Siting the Appliance**
 - i) Room Location - see Appliance Location
 - ii) Clearances to Combustibles - see Studwork Installation
 - iii) Vent requirements - see Ventilation section
 - iv) Framing & Finishing - see Installation section on frames
2. **Assemble the Studwork**

See Studwork installation section for details
3. **Locate the appliance in the Studwork**
4. **Make Gas Connections**
5. **Test the pilot**
6. **Test the Gas Pressure**
7. **Install standard and optional features**
 - i) Mains Adapter
 - ii) Lining Panels
 - iii) Log effect
 - iv) Appliance Door
8. **Commission the appliance**

See Commissioning section for details

Installation Instructions

Technical Specification

PACKING CHECKLIST

Qty Description	Fixing Kit containing:
For Stone Chippings Layout	1 x Instruction Manual
1 White Stone Chippings	6 x Wood Screws
1 Liner Set	6 x Wall Plugs
	1 x Handset
For Log Layout	4 x AA cell batteries
1 Log Set	1 x 9v cell batteries
1 Liner Set	1 x Wall box
1 Bag Embaglow material	1 x Wall plate
	1 x Battery holder

2

TO BE INSTALLED ONLY BY AN AUTHORISED PERSON
TO BE INSTALLED ON A NON-COMBUSTABLE FLOOR



PR2048

DO NOT OPERATE THIS APPLIANCE BEFORE READING THE INSTRUCTION BOOKLET

DO NOT PLACE ARTICLES ON OR AGAINST THIS APPLIANCE.

DO NOT STORE CHEMICALS OR FLAMMABLE MATERIALS, OR SPRAY AEROSOLS NEAR THIS APPLIANCE.

DO NOT OPERATE WITH PANELS, COVERS OR GUARDS REMOVED FROM THIS APPLIANCE.

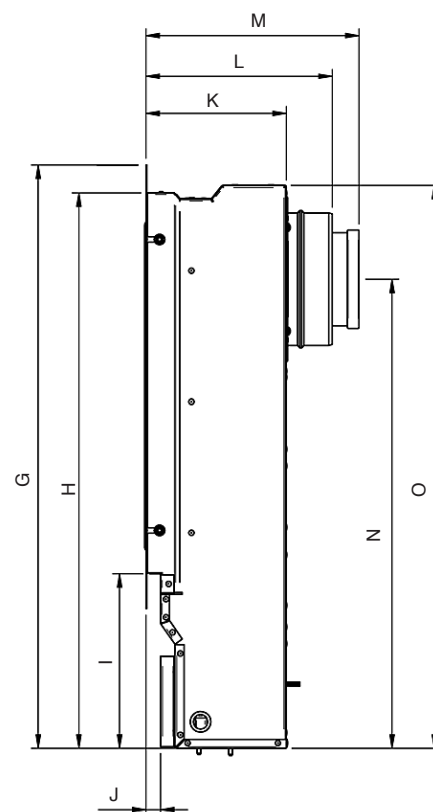
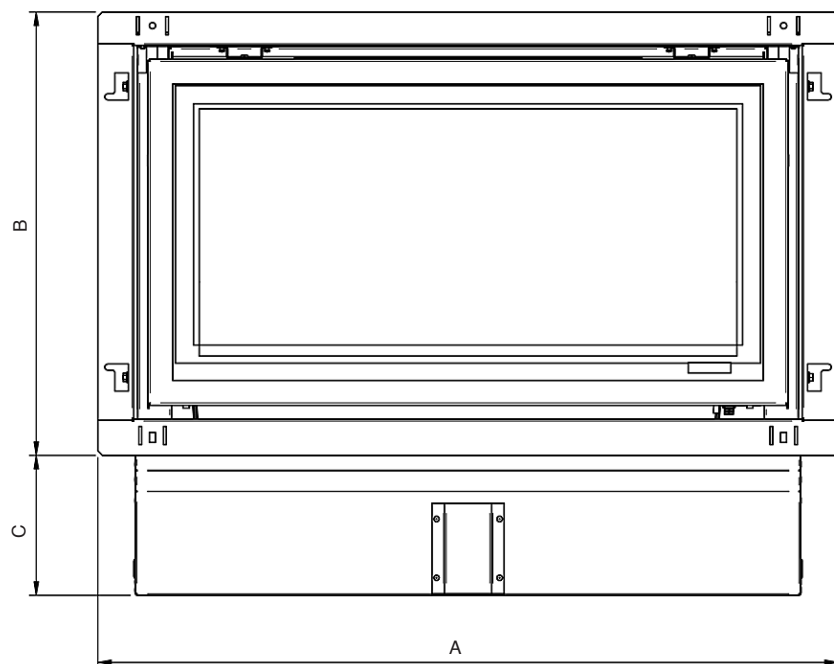
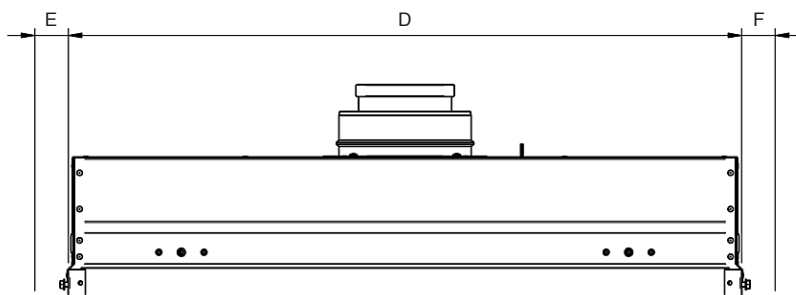

Model	A	B	C	D	E	F	G	H	I	J	K	L	M	N	O
Slimline 1	820	491	155	746	37	37	645	614	193	16	155	206	236	519	623
Slimline 2	1020	491	155	946	37	37	645	614	193	16	155	206	236	519	623

Installation Instructions

Technical Specification

Covering the following models:

Model		Studio 1 Slimline	Studio 2 Slimline
Log Effect	Natural Gas	123-191NZ	123-056NZ
	LPG	123-489NZ	123-518NZ
White Stone Effect	Natural Gas	123-238NZ	123-004NZ
	LPG	123-642NZ	123-529NZ

Model	Gas CAT.	Gas Type	Working Pressure	Aeration	Injector	Gas Rate m ³ /h	Input kW (Gross)		Country
							High	Low	
Studio Slimline 1 Log Effect	I ₂ H	Natural (G20)							NZ
	I ₃ P	Propane (G31)							
Studio Slimline 1 Stone Effect	I ₂ H	Natural (G20)							
	I ₃ P	Propane (G31)							
Studio Slimline 2 Log Effect	I ₂ H	Natural (G20)							
	I ₃ P	Propane (G31)							
Studio Slimline 2 Stone Effect	I ₂ H	Natural (G20)							
	I ₃ P	Propane (G31)							
Efficiency Class 1 - 82% / NO _x Class 4									
Flue Outlet Size Ø 100mm									
Flue Inlet Size Ø 150mm									
Gas Inlet Connection Size Ø 8mm									

Specific Information for New Zealand			
Gas Type		Natural Gas	General Product LPG
Test Pressure Point		2 kPa	2.75 kPa
Gas Input Rate	White Stone Effect	18.7 MJ/h	18.4 MJ/h
	Logs	18.7 MJ/h	18.4 MJ/h
Max Supply Pressure		6 kPa with external regulator	3.5 kPa
Design Standard		EN 613:2000	EN 613:2000

Installation Instructions

Technical Specification

Steel / Glass / Verve

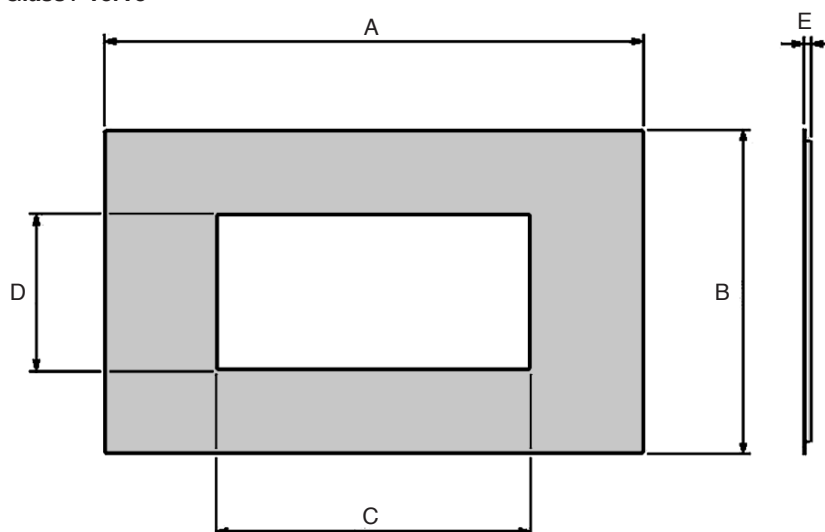

Steel / Glass / Verve Fronts

Front	A	B	C	D	E
Steel	1264	528	646	320	27
Glass	1264	528	650	324	29
Verve	1264	528	650	324	53

Profil / Bauhaus / Expression

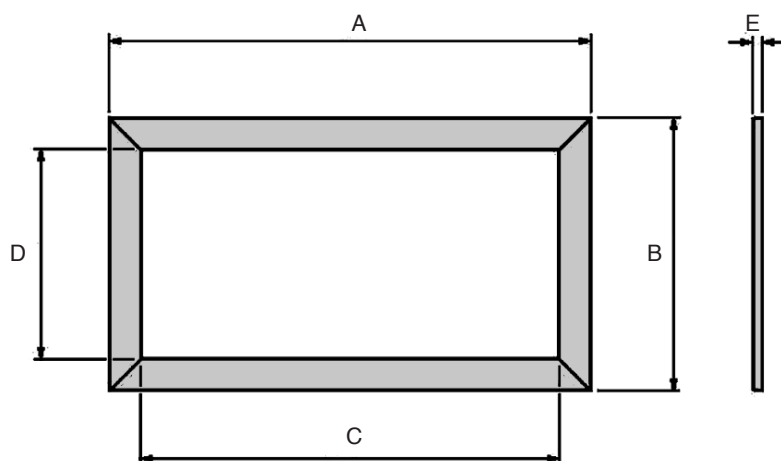

Profil / Bauhaus Expression Frames

Frame	A	B	C	D	E
Profil	836	510	740	414	12.5
Bauhaus	850	524	740	414	28
Expression	940	614	740	414	40

Installation Instructions

Site Requirements

1. Flue & Chimney Requirements

Note: This appliance must only be installed with the flue supplied.

You must adhere to the following:

- 1.1 The flue must be sited in accordance with the rules in force and comply with all local and National regulations, see Diagram 1.
- 1.2 Fit a guard to protect people from any terminal less than 2 metres above any access such as level ground, a balcony or above a flat roof.
- 1.3 All vertical and horizontal flues must be securely fixed and fire precautions followed in accordance with local and national codes of practice.
- 1.4 A restrictor may be required, see Technical Specifications on Page 6 & 7.

- 1.5 Two types of flue terminals are available, horizontal and vertical.
- 1.6 To measure for a horizontal terminal decide on the terminal position.
- 1.7 Measure the height from the top of the appliance to the centre of the required outlet.
- 1.8 For minimum and maximum flue dimensions, see Diagrams 2A.
- 1.9 Allow enough room either above or to the side of the appliance to assemble the flue on top.
- 1.10 Assemble a horizontal flue in the following order:
 - Vertical section
 - 90° elbow
 - Horizontal plus terminal
- 1.11 Support the opening of a masonry installation with a lintel.
- 1.12 Only the horizontal terminal section can be reduced in size.

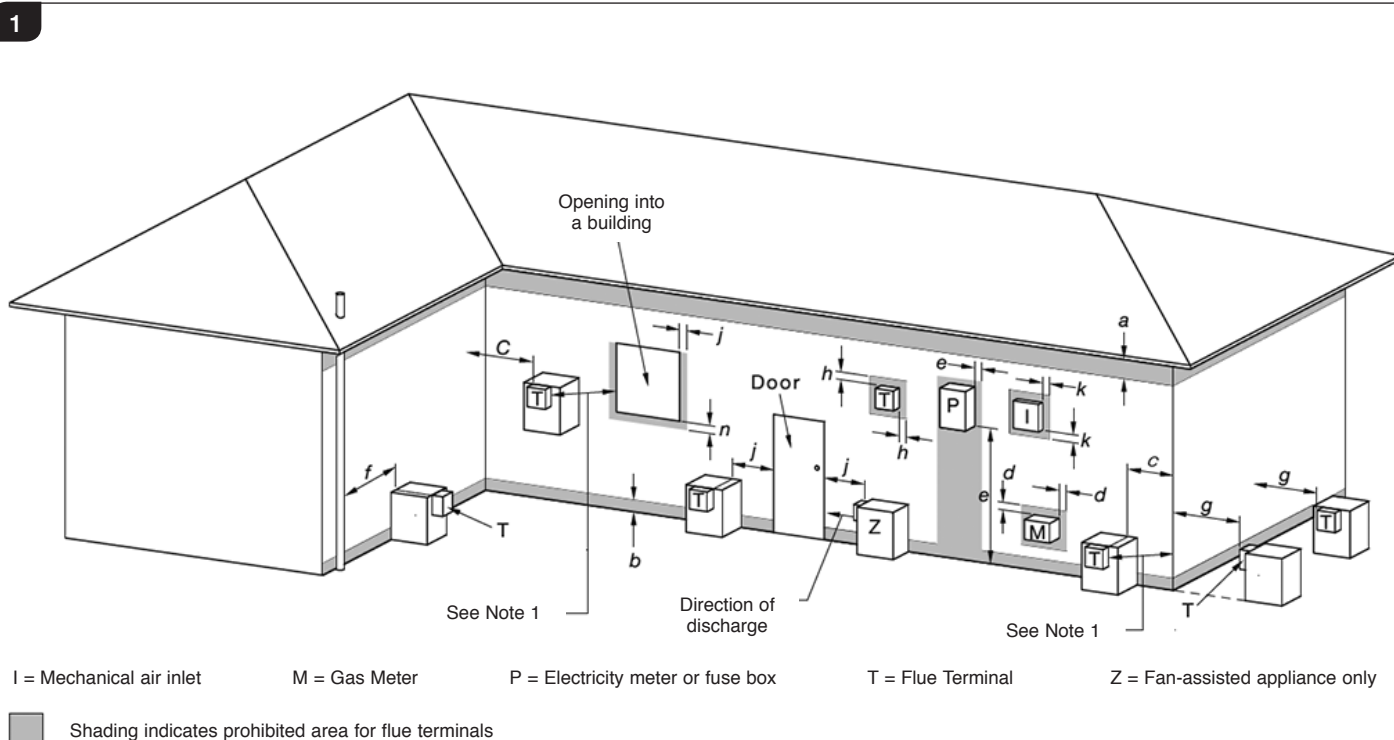

Installation Instructions

Site Requirements

Minimum clearances required for the flue terminals showing in Diagram 1 on page 9.

Ref	Item	Minimum clearances (mm)
		Natural Draught
a	Below eaves, balconies and other projections: Gas appliances up to 50 MJ/h	300
b	From the ground, above a balcony or other surface	300
c	From a return wall or external corner	500
d	From a gas meter (M)	1000
e	From an electricity meter or fuse box (P) †	500
f	From a drain pipe or soil pipe	150
g	Horizontally from any building structure or obstruction facing a terminal	500
h	From any other flue terminal, cowl, or combustion air intake	500
j	Horizontally from an openable window, door, non-mechanical air inlet, or any other opening into a building with the exception of sub-floor ventilation: Gas appliances up to 150 MJ/h input	500
k	From a mechanical air inlet, including a spa blower	1500
n	Vertically below a openable window, non-mechanical air inlet or any other opening into a building with the exception of sub-floor ventilation: Space heaters up to 50 MJ/h input	150

† Prohibited area below electricity meter or fuse box extends to ground level,

NOTE:

- (1) Where dimensions c, j or k cannot be achieved an equivalent horizontal distance measured diagonally from the nearest discharge point of the terminal to the opening may be deemed by the Technical Regulator to comply.

Flue Clearances

Minimum Flue Clearances to Combustibles

To the sides and undersides: 25mm

Above the flue: 75mm

Installation Instructions

Site Requirements

2. Flue Options

2A. Top Flue Up and Out Kit

Start of bend to centre line of horizontal flue 170mm. Centre line of vertical flue to end of bend 220mm. Vertical from the top of the appliance then horizontally out, see Diagram 2A.

2.1 The basic kit comprises:

STUDIO 1 BF (8534)

- 1 x 200mm vertical length
- 1 x 500mm terminal length (cut to length on site)
- 1 x 90° elbow
- 1 x wall plate
- 1 x 70mm restrictor
- 1 x 60mm restrictor

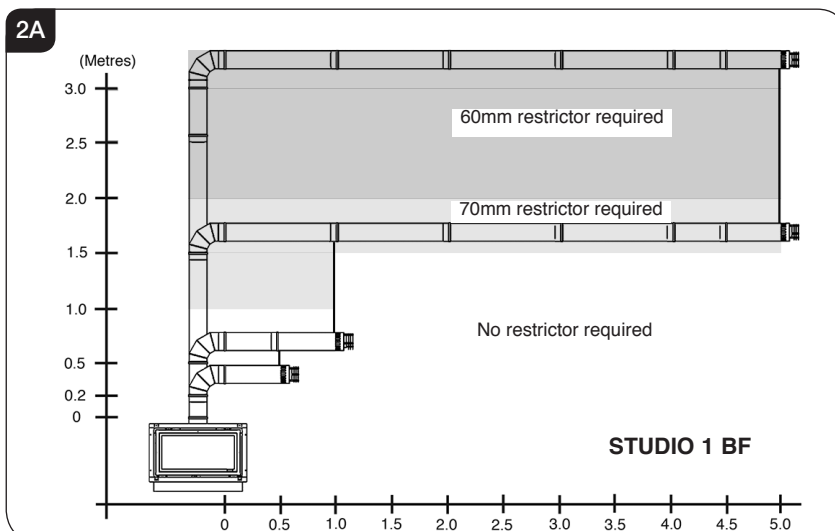

STUDIO 2 BF (8509)

- 1 x 200mm vertical length
- 1 x 500mm vertical length
- 1 x 500mm terminal length (cut to length on site)
- 1 x 90° elbow
- 1 x wall plate
- 1 x 75mm restrictor

The kit may be used on its own. (Note – STUDIO 1 BF with a 200mm rise only the 500mm terminal length can be used). Extra lengths may be added to the vertical and horizontal from the table, see Section over page.

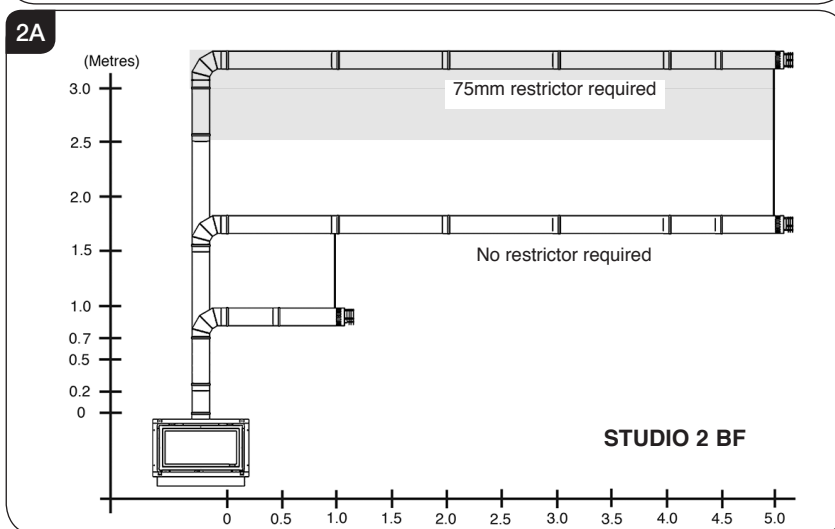

Installation Instructions

Site Requirements

2B. Top Flue Up and Out with Additional Bend

- 2.2 An additional bend may be used on the horizontal section (either 45° or 90°), but the overall horizontal flue run will be reduced, see Diagram 2B.

2B

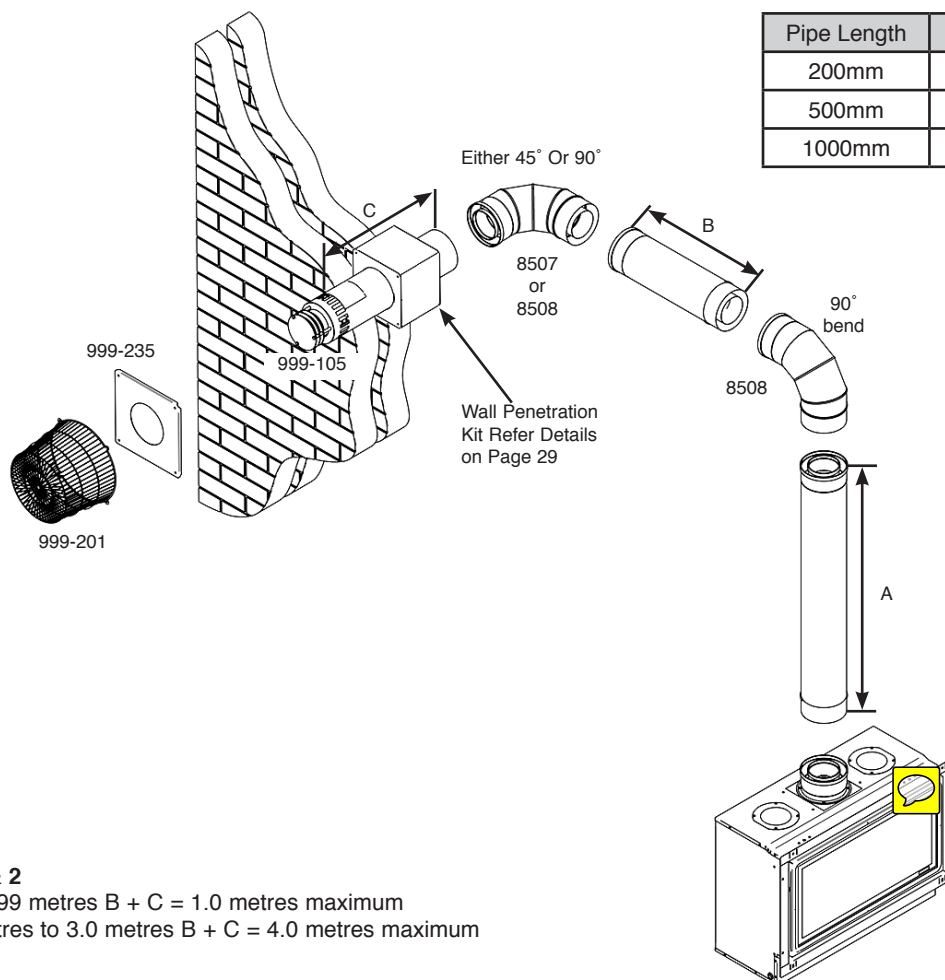

Optional Extra Flue Lengths and Bends

All flue components are 150mm diameter (6")

NOMINAL LENGTH	ACTUAL LENGTH	STAINLESS FINISH
200mm	140mm	8527
500mm	440mm	8528
1000mm	940mm	8529
40° Bend	N/A	8507
90° Bend	N/A	8508

NOTE - Carefully consider:

- a) Terminal positions
- b) Flue supports
- c) Weatherproofing
- d) Fire precautions

For all the above options, you must conform to local and national codes of practice.

Installation Instructions

Site Requirements

2C. Top Flue Vertical Kit (8524)

- 2.3 Vertical from the top of the appliance, see Diagram 3.
A minimum vertical rise 3m (9'10") to a maximum 10m (32'10"). The basic kit comprises:
- 2 x 1m lengths
 - 1 x 1m terminal length
 - 1 x 52mm restrictor
 - 1 x 47mm restrictor
 - 1 x 60mm restrictor
 - 1 x 70mm restrictor
- Extra lengths may be added from the table, see Page 12.

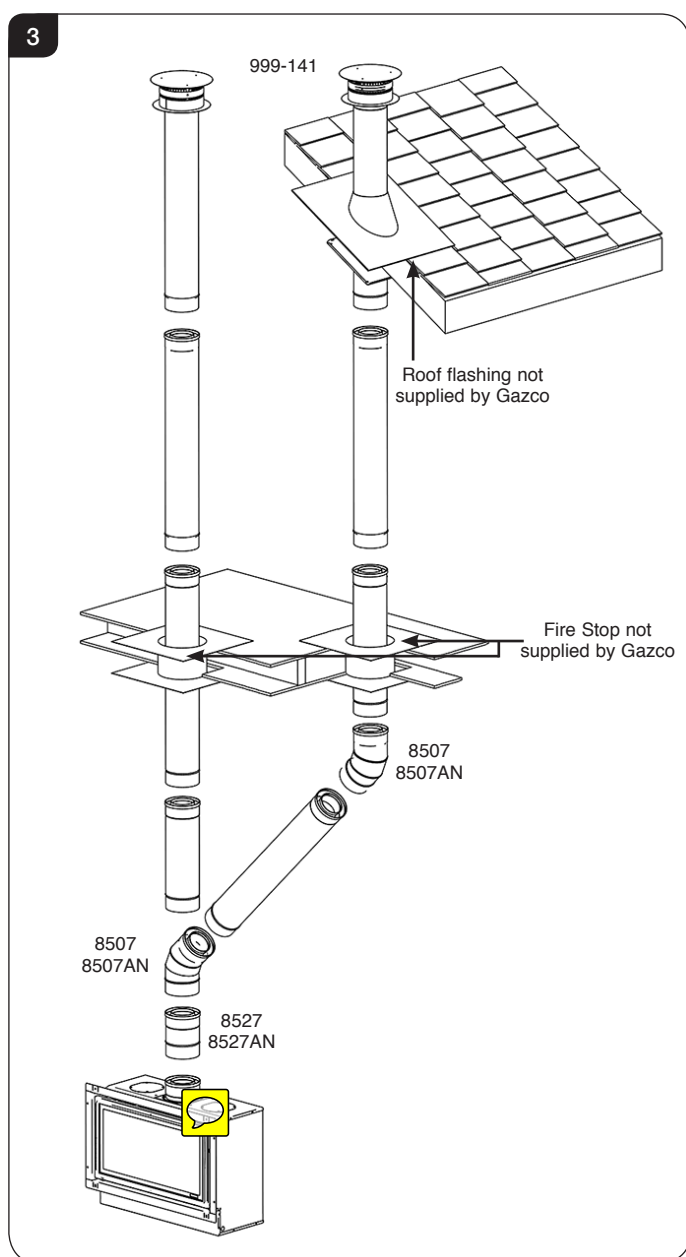

Note: Vertical Terminations can only use a maximum of 2 x 45° bends where offsets are required.
DO NOT use 90° bends.

2D.Top Flue Vertical Offset Kit (8530)

- 2.4 Used with kit 8524. A minimum rise of 500mm (19½) is required to the first bend, see Diagram 4.

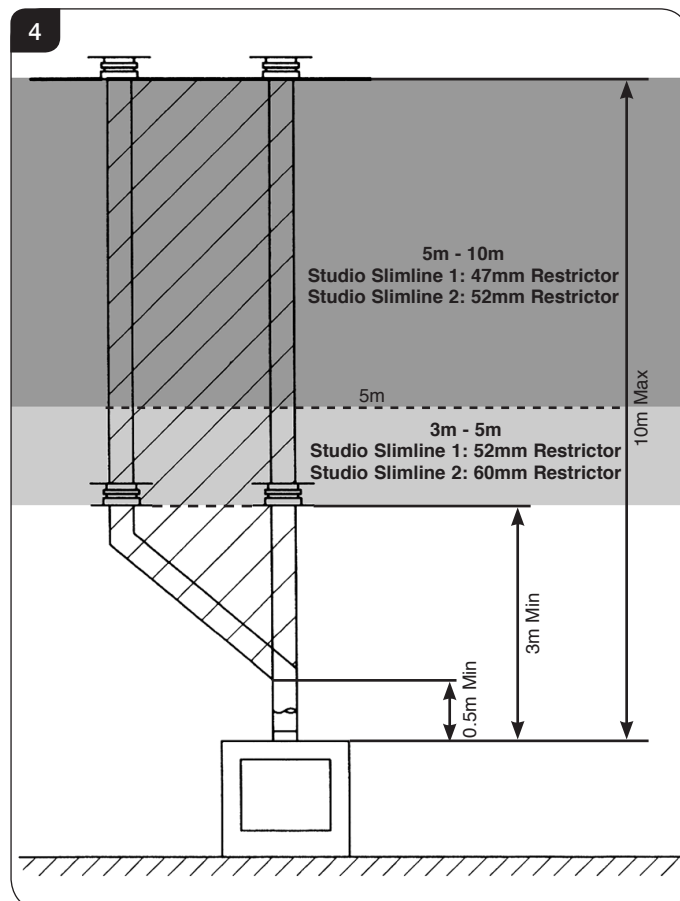

Pipe Length	Stainless Steel Finish
200mm	8527
500mm	8528
1000mm	8529

Installation Instructions

Site Requirements

3. Gas Supply

IMPORTANT: ALL NATURAL GAS FIRE INSTALLATIONS IN NEW ZEALAND MUST HAVE A REGULATOR FITTED UPSTREAM FROM THE APPLIANCE. THE REGULATOR MUST BE FITTED IN A SUITABLE LOCATION FOR SERVICING.

- 3.1 Before installation, ensure that the local distribution conditions (identification of the type of gas and pressure) and the adjustment of the appliance are compatible.
- 3.2 Ensure the gas supply delivers the required amount of gas and is in accordance with the rules in force and specifications.
- 3.3 Soft copper tubing can be used on the installation and soft soldered joints outside the appliance and below the firebed.
- 3.4 A factory fitted isolation device is part of the inlet connection; no further isolation device is required.
- 3.5 All supply gas pipes must be purged of any debris that may have entered prior to connection to the appliance.
- 3.6 The gas supply enters through the silicone panel located on the LEFT-HAND side of the outer box. Slit with a sharp knife before passing the supply pipe through.
- 3.7 The gas supply must be installed in a way that does not restrict the removal of the appliance for servicing and inspection.

4. Ventilation

- 4.1 This appliance has its own dedicated air supply through the flue system and requires no additional ventilation. The cavity housing the appliance must be ventilated to prevent a build up of heat. Refer to Section 7.4 (Page 15) for details.

5. Appliance Location

- 5.1 Please note this appliance has been primarily designed for studwork applications. However, there are circumstances where one of the kits could be used on a block or brickwork fireplace using different methods and materials for the final effect.

The three methods of studwork installation are:

1. **Decorative Frame** - Timber framing details for the Studio Slimline with a selected Decorative Frame.
2. **Edge** - Framing details for the Studio Slimline with additional Studio Edge kit (without frame).
3. **Cool Wall** - Framing details for the Studio Slimline with the additional Studio Cool Wall kit with Edge Plus Frame finish.

- 5.2 This appliance must stand on a Non-Combustible platform that is at least 12mm thick.

6. List of Approved Material for Studwork installation

The following is a list of approved Non-Combustible Material, tested to AS1530.1 or AS/NZS1530.3, and classed as Fire Resistant by for use in the construction lining of a studwork frame out:

9mm Villaboard (Restricted use only for internal frame out linings and for Cool Wall kits as shown elsewhere)
 9mm Promina Board
 12mm - 20mm Promatect H
 12mm - 20mm Eterpan LD
 12mm Supalux

It is essential to maintain the correct distances to Combustible material when constructing a studwork frame out.

Installation Instructions

7. Clearances

- 7.1 DISTANCE TO COMBUSTIBLE MATERIAL**
COMBUSTIBLE PARTS OF THE STUDWORK MUST BE KEPT BEYOND THE MINIMUM DIMENSIONS SHOWN IN DIAGRAM 5. EVEN IF THE FRAMEWORK IS PROTECTED BY NON-COMBUSTIBLE MATERIAL, THESE DIMENSIONS MUST BE MAINTAINED, SEE DIAGRAM 5.
- 7.3 ALL MODELS**
DO NOT PACK THE VOID AROUND OR ABOVE THE APPLIANCE WITH INSULATION MATERIALS SUCH AS MINERAL WOOL.
- 7.4 THE VOID BUILT FOR THE CASSETTE MUST BE VENTILATED TO PREVENT A BUILD-UP OF HEAT. IF THE VOID IS SEALED, THEN YOU MUST FIT VENTS AT BOTH LOW AND HIGH LEVELS - SEE INDIVIDUAL INSTALLATION REQUIREMENTS. THESE VENTS MUST TAKE COLD AIR FROM THE ROOM AND RETURN WARM AIR BACK INTO THE ROOM.**
- 7.5 AN ACCESS HATCH MUST BE LEFT IN THE SIDE OF THE CHIMNEY BREAST FOR FUTURE SERVICING AND INSPECTION OF THE FLUE AND APPLIANCE.**

- 7.6** A combustible shelf must be:
- Maximum 150mm in depth from the front of the appliance.
 - Minimum 400mm high above the appliance.
- A combustible side wall must be a minimum of 150mm from the appliance.
- 7.7** This appliance can be installed with an up and out flue (vertical wall - horizontal flue) or with a vertical flue with roof termination, see Site Requirements, Section 2, Flue Options.
- 7.8** This appliance is not suitable for installation onto a combustible wall. Remove all combustible material from the area shown, see Diagram 5.

5

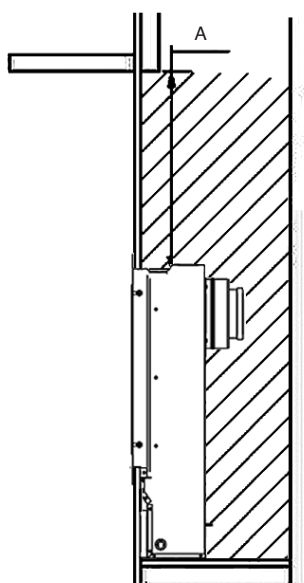
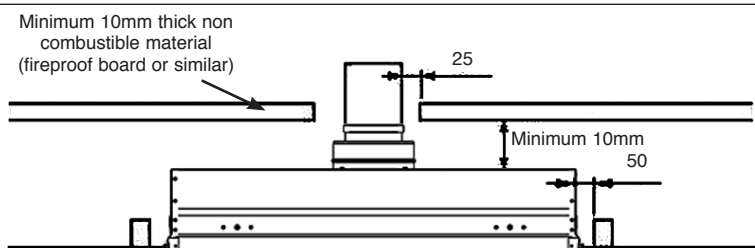

Dimension A	
Studio Slimline 1	400
Studio Slimline 2	700

Installation Instructions

1. Safety Precautions

- 1.1 For your own and other's safety, you must install this appliance according to local and national codes of practice. Failure to install the appliance correctly could lead to prosecution. **Read these instructions before installing and using this appliance.**
- 1.2 These instructions must be left intact with the user.
- 1.3 Do not attempt to burn rubbish on this appliance.
- 1.4 Keep all plastic bags away from young children.
- 1.5 Do not place any object on or near to the appliance and allow adequate clearance above the appliance.

IF THE APPLIANCE IS EXTINGUISHED OR GOES OUT IN USE, WAIT 3 MINUTES BEFORE ATTEMPTING TO RELIGHT THE APPLIANCE.



IMPORTANT: REFER TO DATA BADGE AND TECHNICAL SPECIFICATION AT THE FRONT OF THE MANUAL TO ENSURE THE APPLIANCE IS CORRECTLY ADJUSTED FOR THE GAS TYPE AND CATEGORY APPLICABLE IN THE COUNTRY OF USE, SEE PAGES 6 & 7.

FOR DETAILS OF CHANGING BETWEEN GAS TYPES REFER TO SERVICING INSTRUCTIONS, SECTION 18, REPLACING PARTS.

Unpacking

- 1.6 Remove the appliance from its packaging, and check that it is complete and undamaged.

Put the loose parts to one side so that they are not damaged during installation.

2. Installation of the Appliance



Note: This appliance has been designed to fit a masonry opening, however a studwork installation is possible if required.

- 2.1 To open the glass door, use the hexagon key provided:
- 2.2 Release the window locks moving each from shut to open towards the outer edge of the glass door, see Diagram 1.

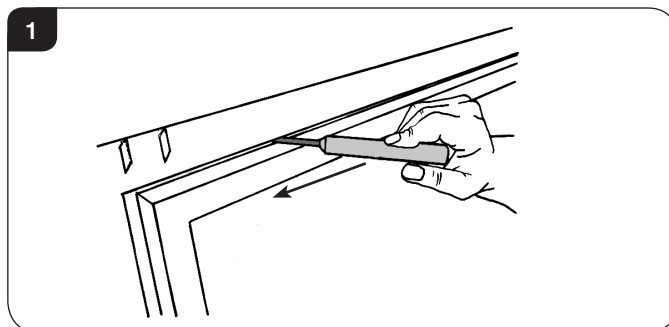

For ease of installation it is advisable to completely remove the glass front:

- 2.3 Remove the securing spring clip from the bottom-right of the window frame, see Diagram 2.

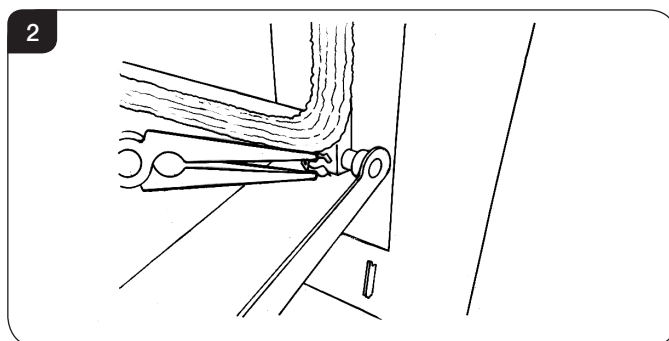

- 2.4 With the window frame in an upright position slide the frame to the left so that it comes off the left hinge pin.

Installation Instructions

- 2.5 Still keeping the frame upright drop the left side down and forward slightly, see Diagram 3.

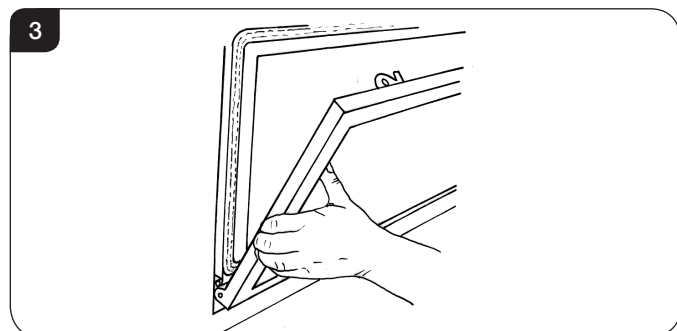

- 2.6 Slide the frame to the right so it comes off the **right** (all models) **and middle** (Studio 2 only) hinge pins. The window frame should now be free.
- 2.7 Place carefully to one side.
- 2.8 Remove all the liners where necessary.

Liners

There are several lining options available for the Studio Slimline range:

Vermiculite
Black Reeded
Brick Effect
Black Glass Linings - see separate instructions

To remove the liners:

- 2.9 Slide the two side panels forwards until clear of the appliance, see diagram 4.

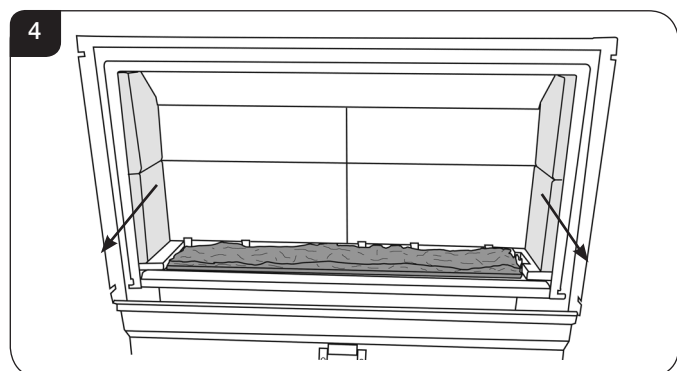

- 2.10 Remove the two clips which hold the back panel in place, see Diagram 5.

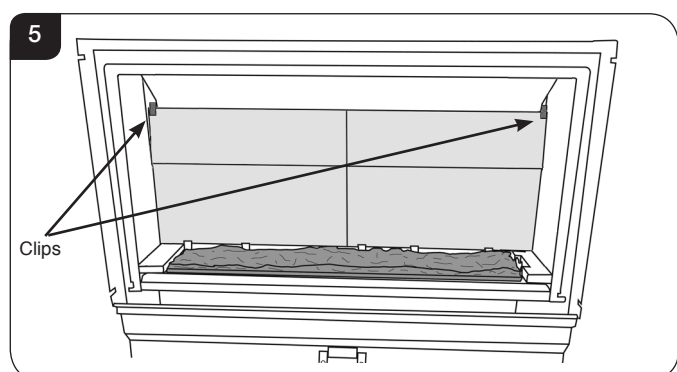

- 2.11 Remove the bottom side panels which are positioned in the back corners of the appliance.

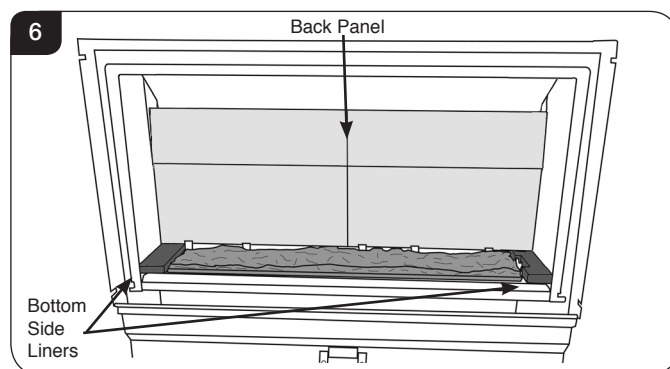

- 2.12 The back panel can now be manoeuvred out of the firebox.
- 2.13 Remove the main burner.

Removing the Main Burner

To remove the main burner:

- 2.14 Remove the 3 burner securing screws and clips from the front of the burner, see Diagram 7.

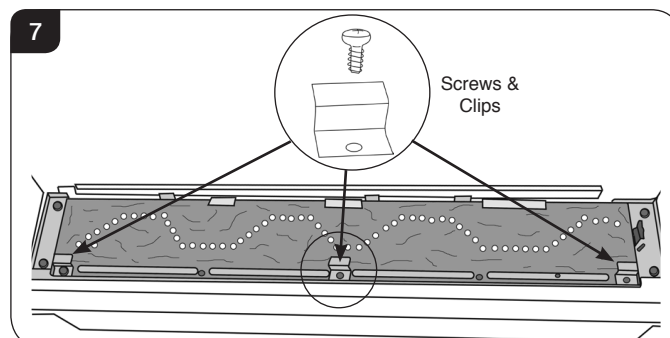

- 2.15 Lift the burner up and out of the appliance.

Installation Instructions

Main Control Assembly

2.16 To access the main control assembly first remove:

- The decorative frame
- Window frame
- Liners
- Main burner

To remove the access panel:

2.17 Undo the two screws, see Diagram 8.

2.18 **Note the orientation of the access panel with the return edges facing forward.**

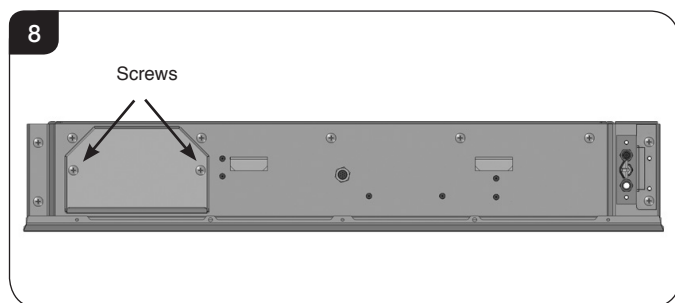

2.19 Isolate the gas supply at the isolation device and disconnect the gas inlet, see Diagram 9.

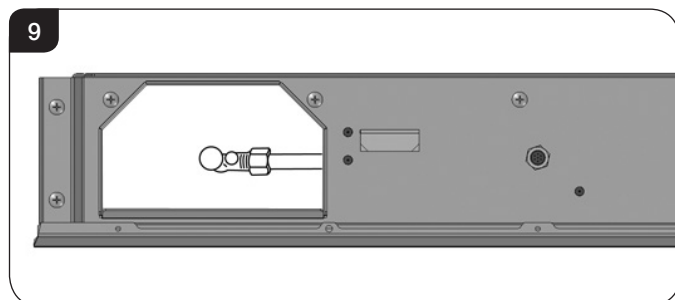

2.20 Remove the nine screws securing the control assembly, see Diagram 10.

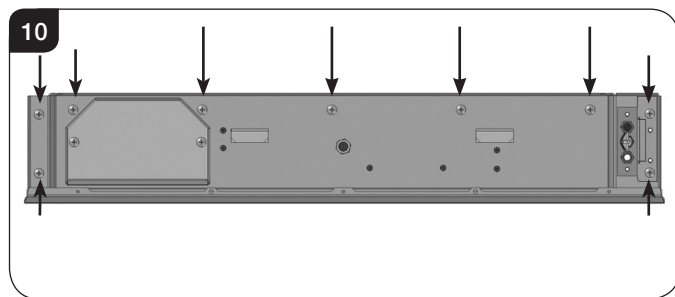

2.21 The control assembly can now be lifted up and out of the appliance.

2.22 Disconnect the battery supply cable from the control unit.

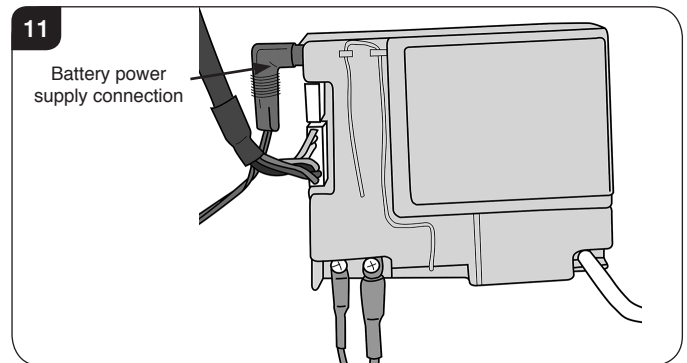

2.23 The gas supply enters the appliance through a silicon panel either on the floor or in the back panel under the access panel, see Diagram 12.

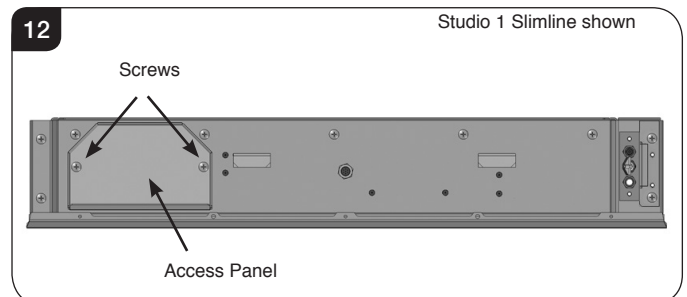

2.24 The Access Panel can now be reached when the gas supply needs to be connected.

3. Masonry Installation

This method of installation requires structural alteration to the intended location. A suitable supporting lintel must be installed to maintain the structural integrity of the surrounding blockwork.

3.1 Mark the position of the lintel so that it sits centrally over the intended installation. Remove the blockwork and install the lintel using mortar to ensure a strong bond with the surrounding wall, see Diagram 13.

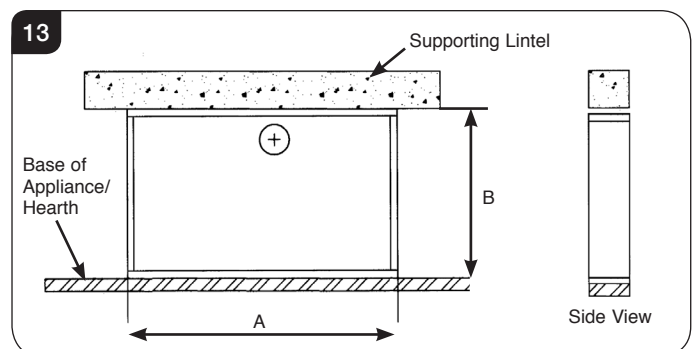

Model	Studio 1 Slimline	Studio 2 Slimline
A	780	980
B	655	655

Installation Instructions

- 3.2 With the lintel in position mark the width of the aperture and remove the blockwork.
- 3.3 Remove wall finish (eg plaster) from the area shown in Diagram 14 to the size of the appliance and minimum non-combustible clearances in all directions.

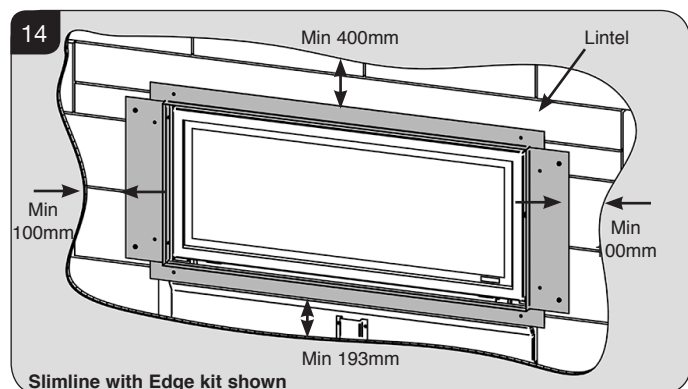

- 3.4 Ensure that there is a minimum of 10mm gap left between the back of the appliance and the outer wall. **There must be no combustible materials behind this appliance.**
- 3.5 Consider the final flue position ensuring that all required clearances are complied with, see Site Requirements Section 1.
- 3.6 Mark the position of the flue on the wall by measuring from the top of the finished hearth level/ base of the appliance, see Diagram 15.

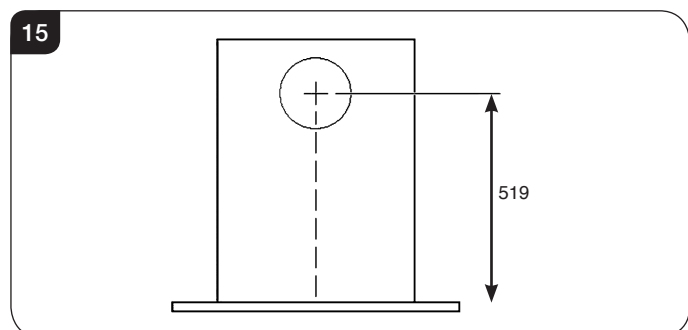

- 3.7 A 152mm (6") diameter hole is required to install the flue. This can be achieved by either:
a) Core drill
b) Hammer and chisel
It is advisable to drill small holes around the circumference when using method b. Make good both ends of the hole.
- 3.8 Line the sides, top and bottom of the opening with non-combustible board to prevent heat entering the cavity.
- 3.8 Prepare gas supply and cable.
If installing into a cavity, no joints should be within the cavity and the pipe must be sleeved. Refer to gas installation requirements.
- 3.9 Install the battery cable and wall plate box.
Gazco recommend that the cable is installed through conduit or similar to give protection and allow for future servicing.

When deciding the route of the cables consideration must be given to avoid contact with the appliance and the flue system.



IMPORTANT - Do not run the battery cable up the side of the appliance outer casing.

See Section 11 for wall box and batteries installation.



The wall box must be installed using a non-metallic mounting box, please ensure that the plastic dry lining box is used where possible. For masonry installation it is possible to drill through the rear of the box and secure in position using wall plugs and screws although a small amount of finishing work will be required to cover the plastic side securing tags. Alternatively a standard 45mm (or greater) deep pattress box can be used to surface mount the wall plate.

- 3.10 Position the appliance in the aperture, ensure that the appliance is level and that the front edge aligns with the proposed front face of the wall.
- 3.11 Mark the fixing holes in the base of the appliance.
- 3.12 Remove the appliance then drill and plug the holes.
- 3.13 Position the appliance in the aperture. It will be necessary to pass the gas supply pipe with the elbow through the silicone panel and the battery cable through the left or right hand rubber grommit.
- 3.14 Secure the appliance through the fixing holes in the base and check the appliance is level, see Diagram 16.

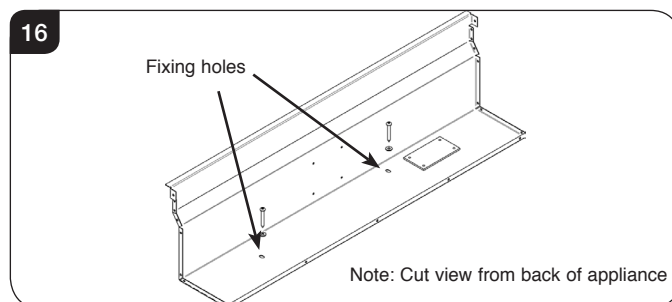

THERE ARE THREE TYPES OF INSTALLATION INTO STUDWORK DESCRIBED IN THE FOLLOWING PAGES:

- 1) **FOR STUDIO WITH A DECORATIVE FRAME, SEE SECTION 3.**
- 2) **FOR AN INSTALLATION WHERE THE STUDIO SITS FLUSH TO THE FINISHED 'EDGE' OF THE WALL, SEE SECTION 4.**
- 3) **FOR A FURTHER 'EDGE' INSTALLATION PROVIDING A COOL WALL ABOVE THE APPLIANCE TO ALLOW CUSTOMERS TO HANG PICTURES ETC. SEE SECTION 5.**

Installation Instructions

4. Studwork Installation for Studio with frames

4.1 BUILD THE STUDWORK CHIMNEY BREAST AND ENCLOSURES TO THE SPECIFICATIONS ON PAGE 19.

- The appliance can be installed in a timber frame out.
 - The following details are the absolute minimum required based on using 90 x 45 framing.
 - The following dimensions are based on wall finishing using Non-combustible board.
- If using tiles, stonework or similar provision must be made for the minimum clearances required.

Note:

These dimensions are for a studwork frame out used in conjunction with a decorative frame.
For Edge and Cool Wall dimension fitting requirements see Installation Sections 4 or 5.

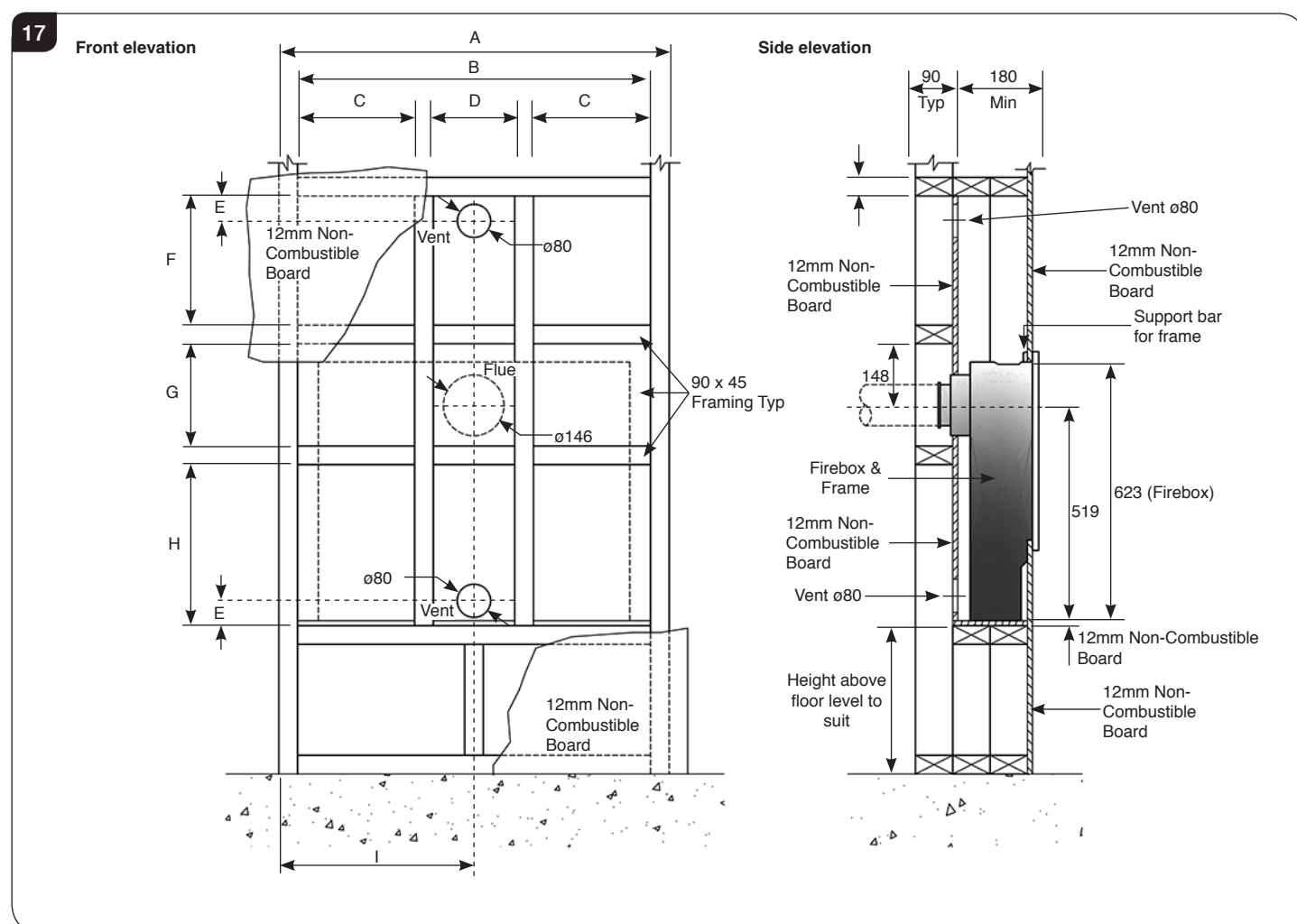

	A	B	C	D	E	F	G	H
Studio Slimline 1	940	850 Min	282	196	60	311	246	388
Studio Slimline 2								



This appliance is NOT suitable for installation into a combustible wall. Remove all combustible material from the area shown, see Diagram 5, Page 14.

No part of the stud work must be built within 400mm of the top and 50mm to the sides of the firebox.

If the fascia of the fireplace is to be constructed from natural materials (stone) it is recommended that this is laid in 3 or more sections along the top edge to prevent cracking. It is recommended for such finishes that an Edge kit be used to aid the alignment around the front face of the appliance.

Installation Instructions

4.2 Site the appliance and decide on flue requirements, see Diagram 18.

4.3 Cut a hole for the flue exit.

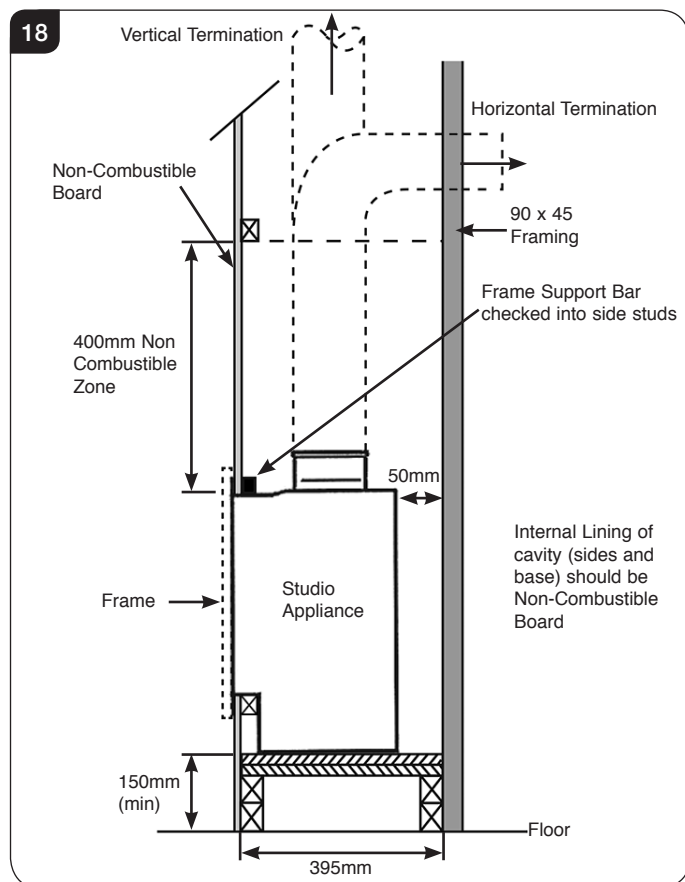

4.4 Provide gas and electric services into the cassette void on the left-hand side.

Because no combustible material can be used above the appliance, we provide a support bar:

4.5 Mark out the position to fit the supplied top support bar into the studwork at the correct height. This bar needs to be recessed into the studwork, see Diagram 19.

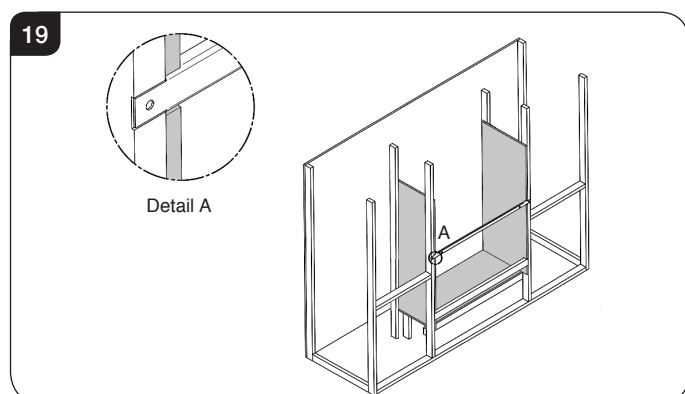

4.6 Fit the support bar into the studwork at the correct height, see Diagram 20.

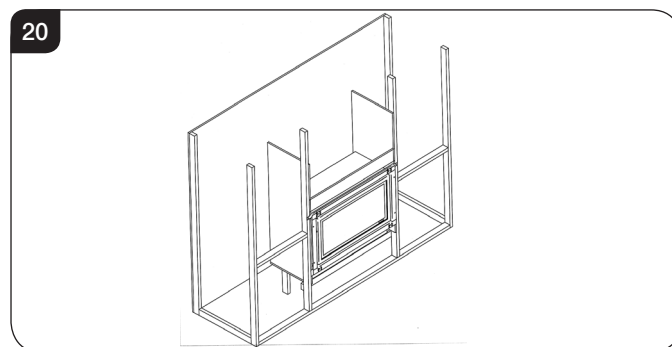

4.7 Position the appliance in the aperture, ensure that the appliance is level and that the front edge aligns with the proposed front edge of the wall.

4.8 Secure the appliance to the base of the studwork plinth using the fixing screws supplied, see Diagram 21.

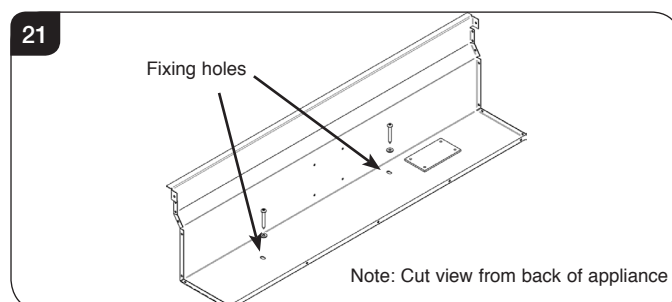

4.9 Fit non-combustible board to the studwork around the appliance. This should extend a minimum of 400mm above and at least 100mm to the sides of the appliance, leaving a minimum of 15mm gap either side of the appliance to allow clearance for the sub frame fixings, see Diagram 22.

4.10 Apply plasterboard to the remainder of the studwork.

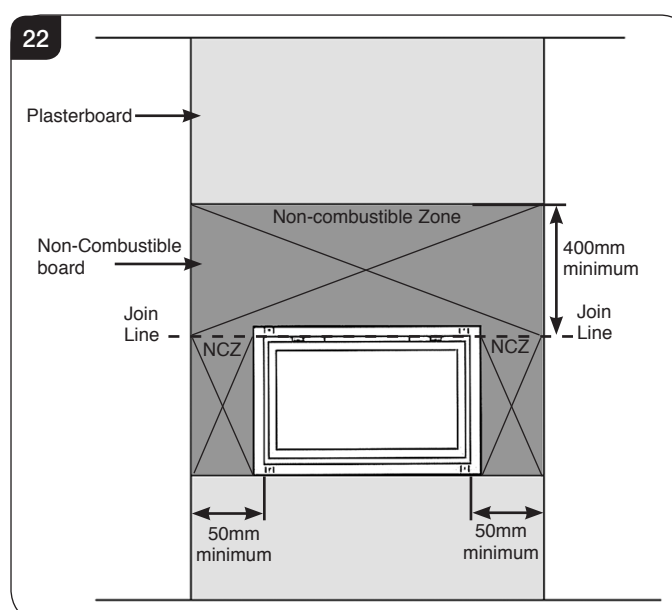

Installation Instructions

- 4.11 Apply a plaster finish to the front of the chimney breast, ensuring that heat resistant plaster is used in the areas shown in Diagram 23.

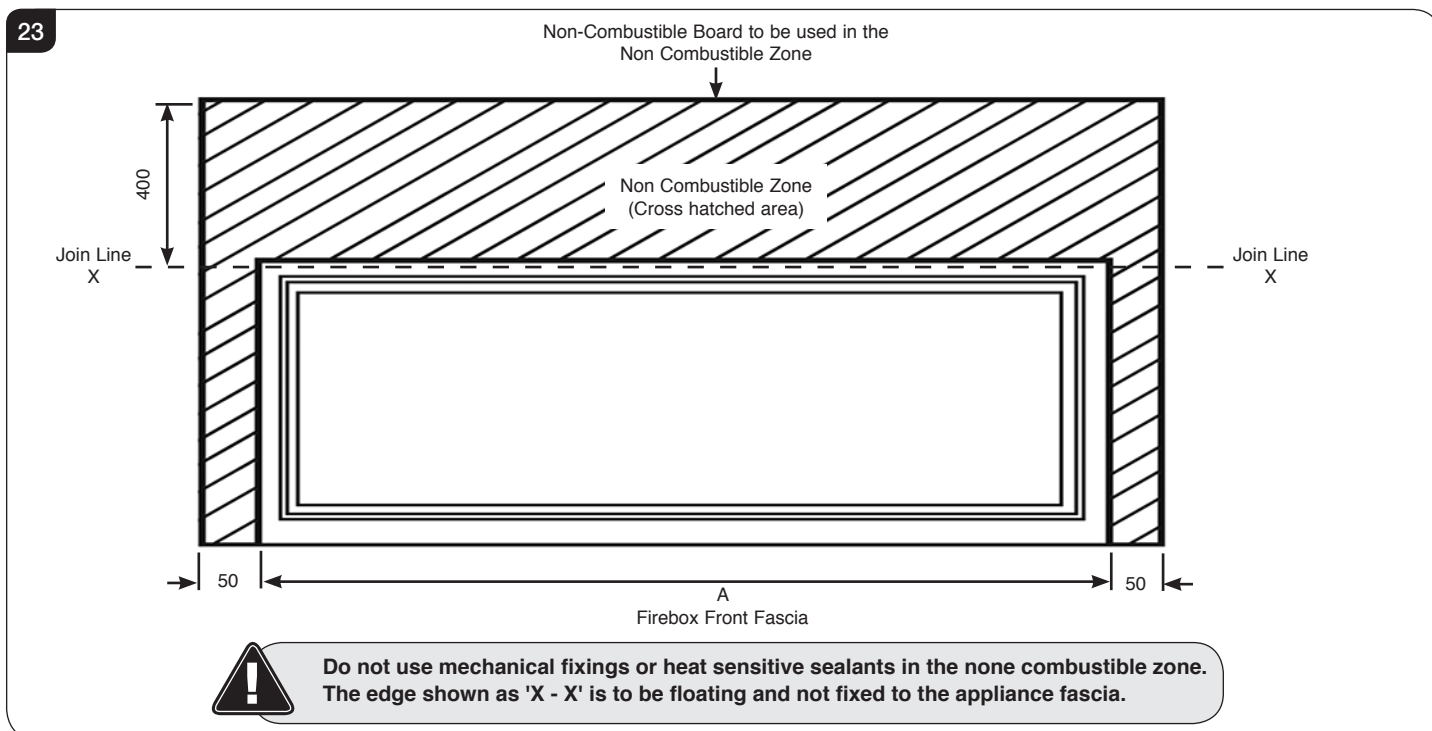

- 4.12 Attach the 4 x frame fixing brackets to the sub-frame, see Diagram 24.

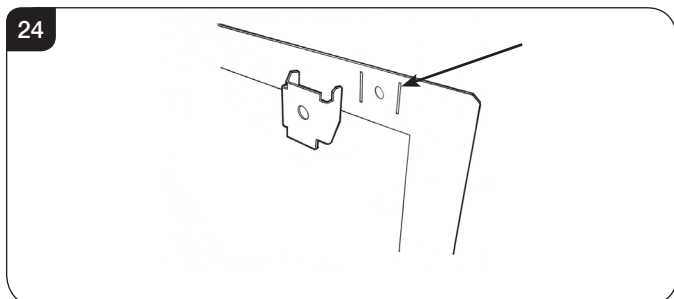

- 4.13 Fix foam seal to the rear of the outer flange of the appliance, see Diagram 25.

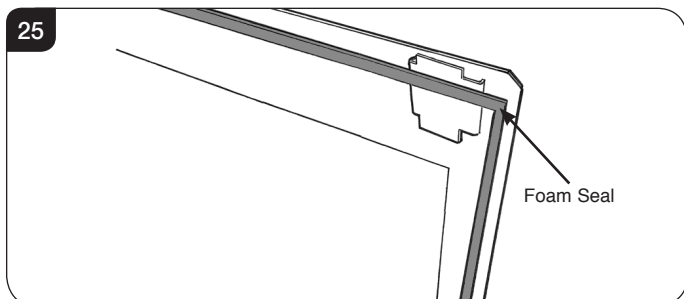

- 4.14 Fit the sub-frame to the appliance and ensure the returns of the sub-frame fit internally into the main outer box with the studs and securing nuts passing through the side slots. Secure by tightening the 4 nuts, see Diagram 26.

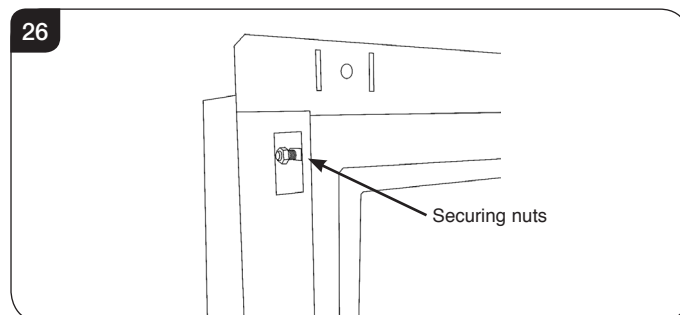

- 4.15 Secure the appliance to the studwork using four screws through flange, bracket and support bar.

Slips

Because of the high temperatures this appliance achieves, it is advisable to use marble slips or similar material between the appliance and the plasterboard.

Never use a one-piece slip as expansion (even cracking) can occur.

Note: If a slip is used, longer screws are needed to secure the appliance.

To finish this installation:

- 4.16 Connect the wall box and batteries following the instructions in Section 11.

Installation Instructions

4.17 Connect:

- The flue system, see Installation, Section 4.
- Gas services, see Installation, Section 2, using the opening in the side of the chimney breast for access.

After commissioning:

4.18 Finish the sides of the chimney breast, see Diagram 27.

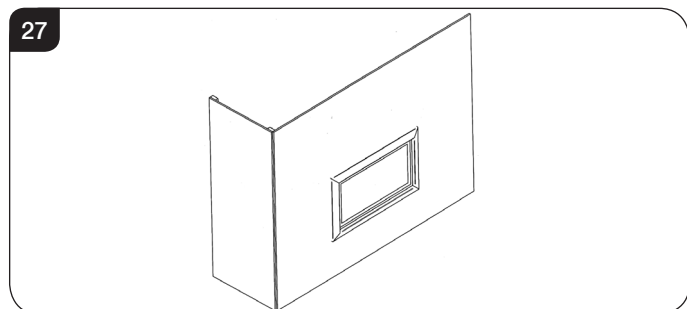

Installation Instructions

5. Studwork Installation for Studio with Edge Kit

5.1 BUILD THE STUDWORK CHIMNEY BREAST AND ENCLOSURES TO THE SPECIFICATIONS ON PAGE 23 & 24.

- The appliance can be installed in a timber frame out.
 - The following details are the absolute minimum required based on using 90 x 45 framing.
 - The following dimensions are based on wall finishing using Non-combustible board.
- If using tiles, stonework or similar provision must be made for the minimum clearances required.

Note:

These dimensions are for a studwork frame out used in conjunction with an Edge Frame kit.
For Decorative Frame and Cool Wall kit requirements see Installation Sections 4 or 6.

28

Front elevation

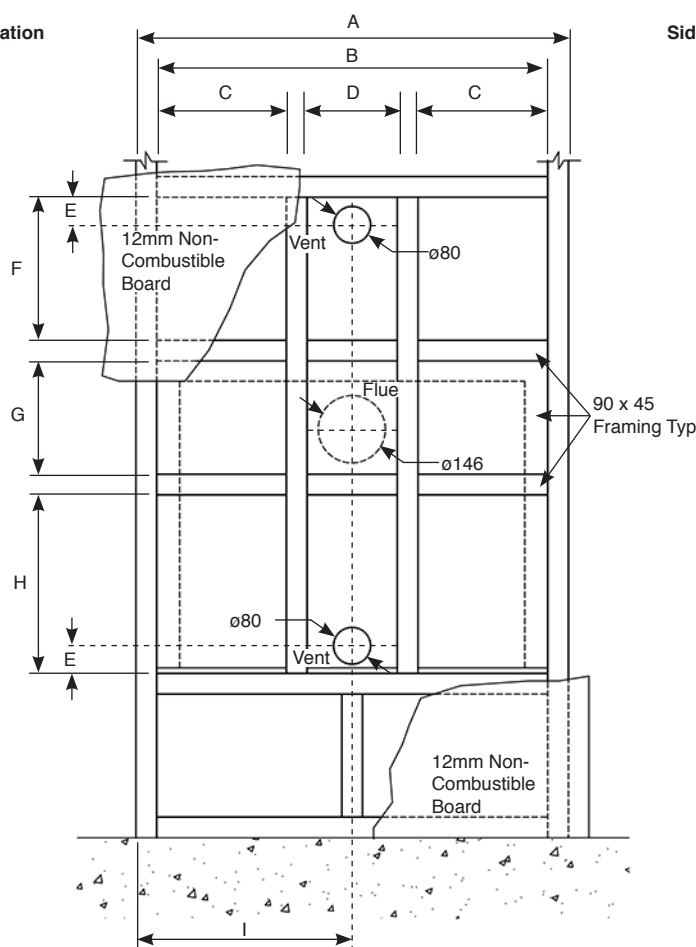

Side elevation

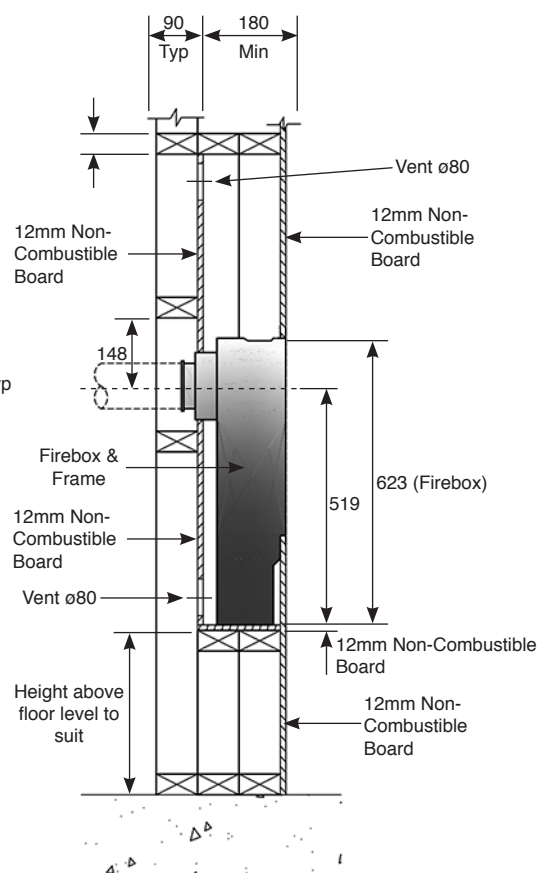

	A	B	C	D	E	F	G	H
Studio Slimline 1	940	850 Min	282	196	60	311	246	388
Studio Slimline 2								

Installation Instructions

There is an optional Studio Edge Installation Kit available for installing the appliance without a frame: Studio Code No. 8727BF EK01.

Using the installation kit:

- 5.2 Fit the four metal brackets of the kit to the sub-frame, see Diagram 29.

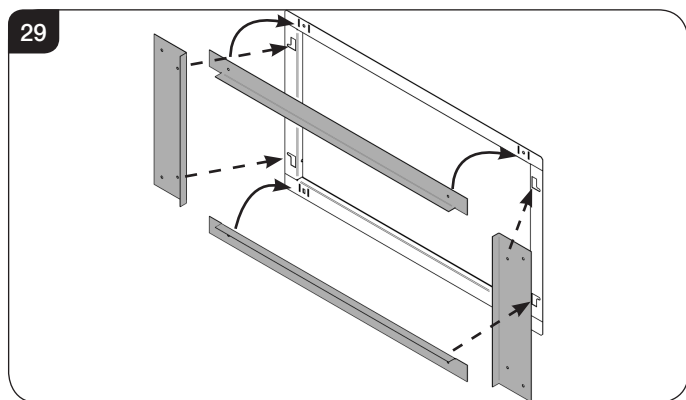

- 5.3 Fix foam seal to the rear of the outer flange of the appliance, see Diagram 30.

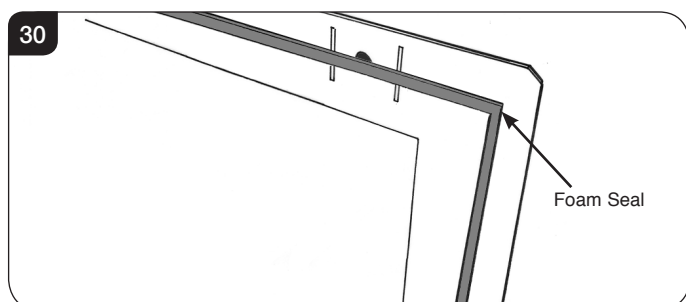

- 5.4 Fit the sub-frame to the appliance and ensure the returns of the sub-frame fit internally into the main outer box with the studs and securing nuts passing through the side slots. Secure by tightening the 4 nuts, see Diagram 31.

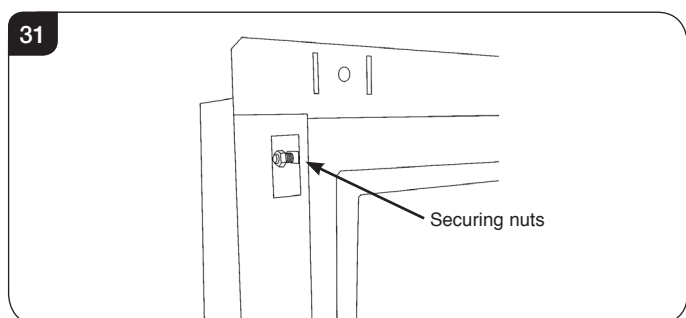

- 5.5 Build the studwork chimney breast to the desired size.
5.6 Ensure all clearances to combustible material are maintained, see Section 7.

- 5.7 Put vertical studwork at minimum clearance to the side of the appliance (50mm).
5.8 Decide on flue requirements.
5.9 Cut a hole for the flue exit, see Installation Instructions, Section 4.

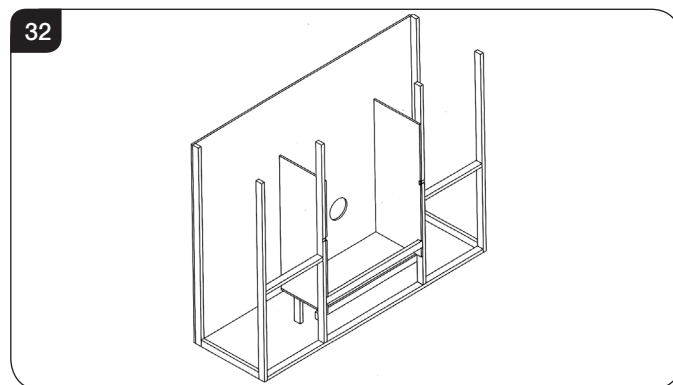

- 5.10 Secure to the vertical studwork through the holes in the metal brackets fitted to the appliance.
5.11 The kit has been designed so that non-combustible board can be taken right up to the edge of the four brackets, see Diagrams 33 & 34.

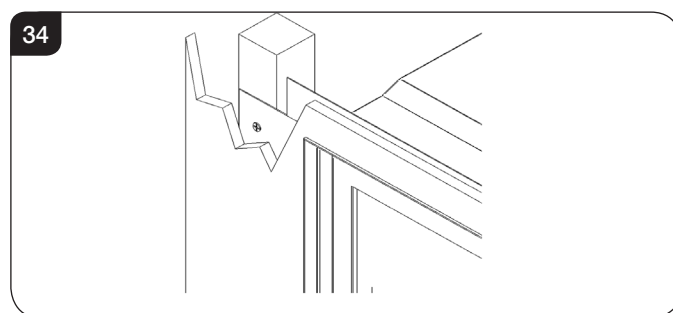
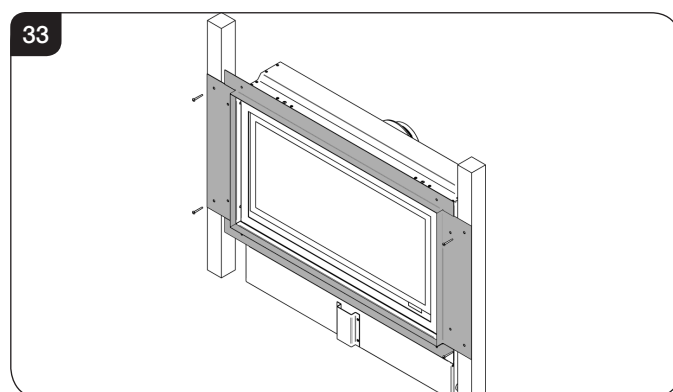

Installation Instructions

- 5.12 Fit non-combustible board to the studwork above the appliance. This should extend a minimum of 400mm above the appliance and 100mm to the sides, see Diagram 35.

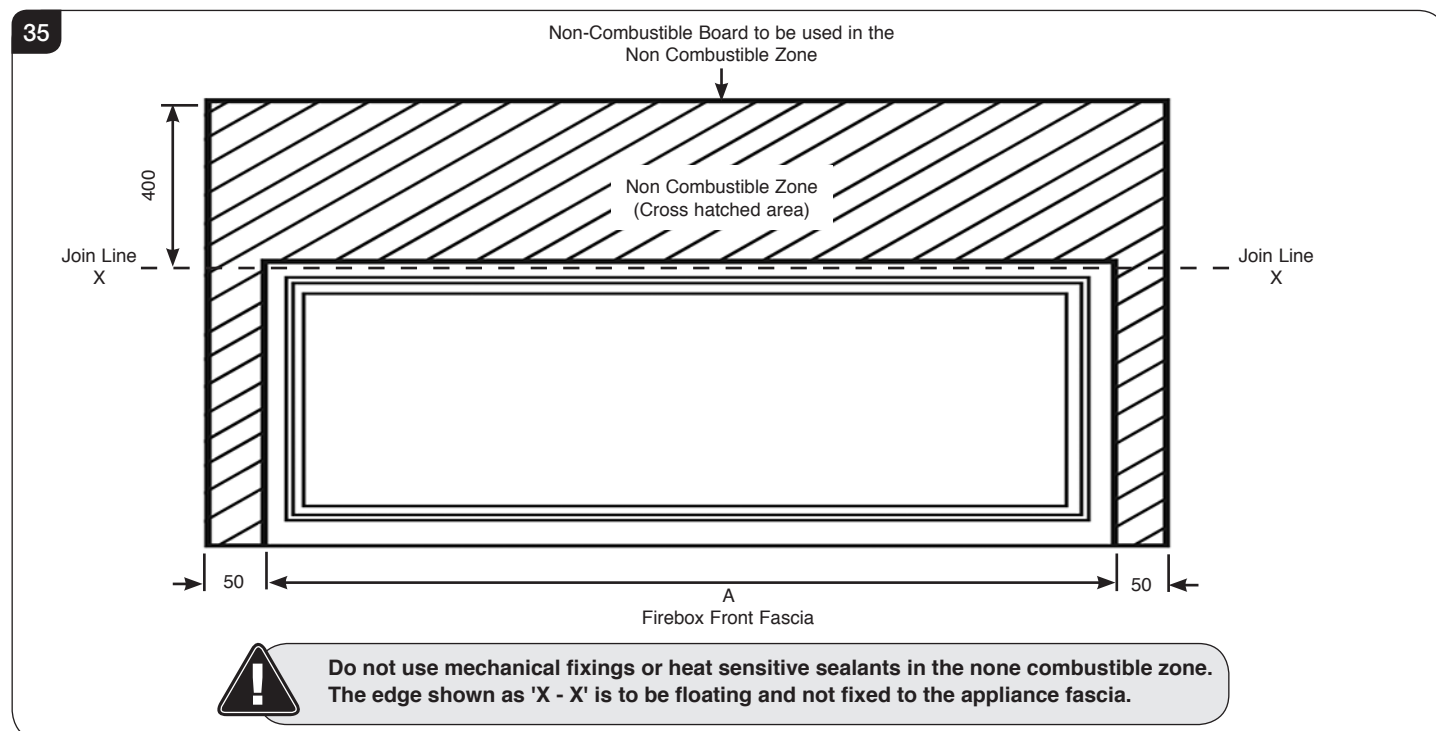

- 5.13 Fit plasterboard to the remaining chimney breast front.

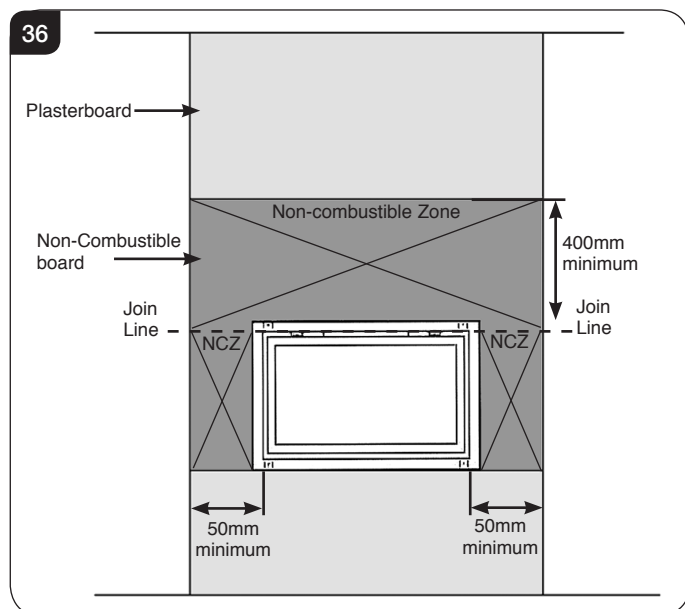

- 5.14 Connect the flue system and gas services using the opening in the side of the chimney breast for access.

- 5.15 After commissioning, finish the sides of the chimney breast, see Diagram 37.

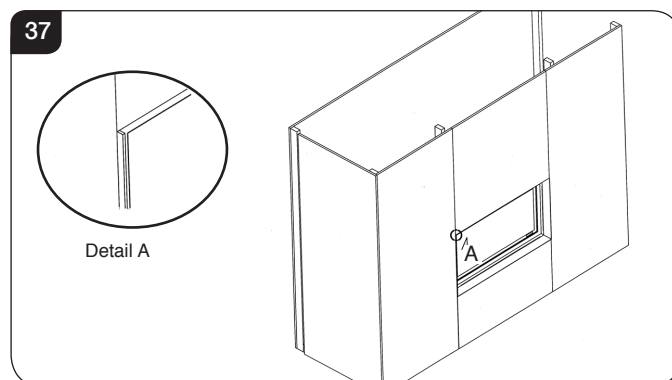

- 5.16 Apply a plaster finish to the chimney breast using heat resistant plaster in the area directly around the appliance, see Diagram 36.

Installation Instructions

6. Studwork for Cool Wall installation kit (with Edge Plus Frame)

6.1 BUILD THE STUDWORK CHIMNEY BREAST AND ENCLOSURES TO THE SPECIFICATIONS ON PAGE 28 & 29.

- The appliance can be installed in a timber frame out.
 - The following details are the absolute minimum required based on using 90 x 45 framing.
 - The following dimensions are based on wall finishing using Non-Combustible Board.
- If using tiles, stonework or similar provision must be made for the minimum clearances required.

Note:
 These dimensions are for a studwork frame out used in conjunction with an Cool Wall kit.
 For Decorative Frame and Edge Frame kit requirements see Installation Sections 4 or 5.

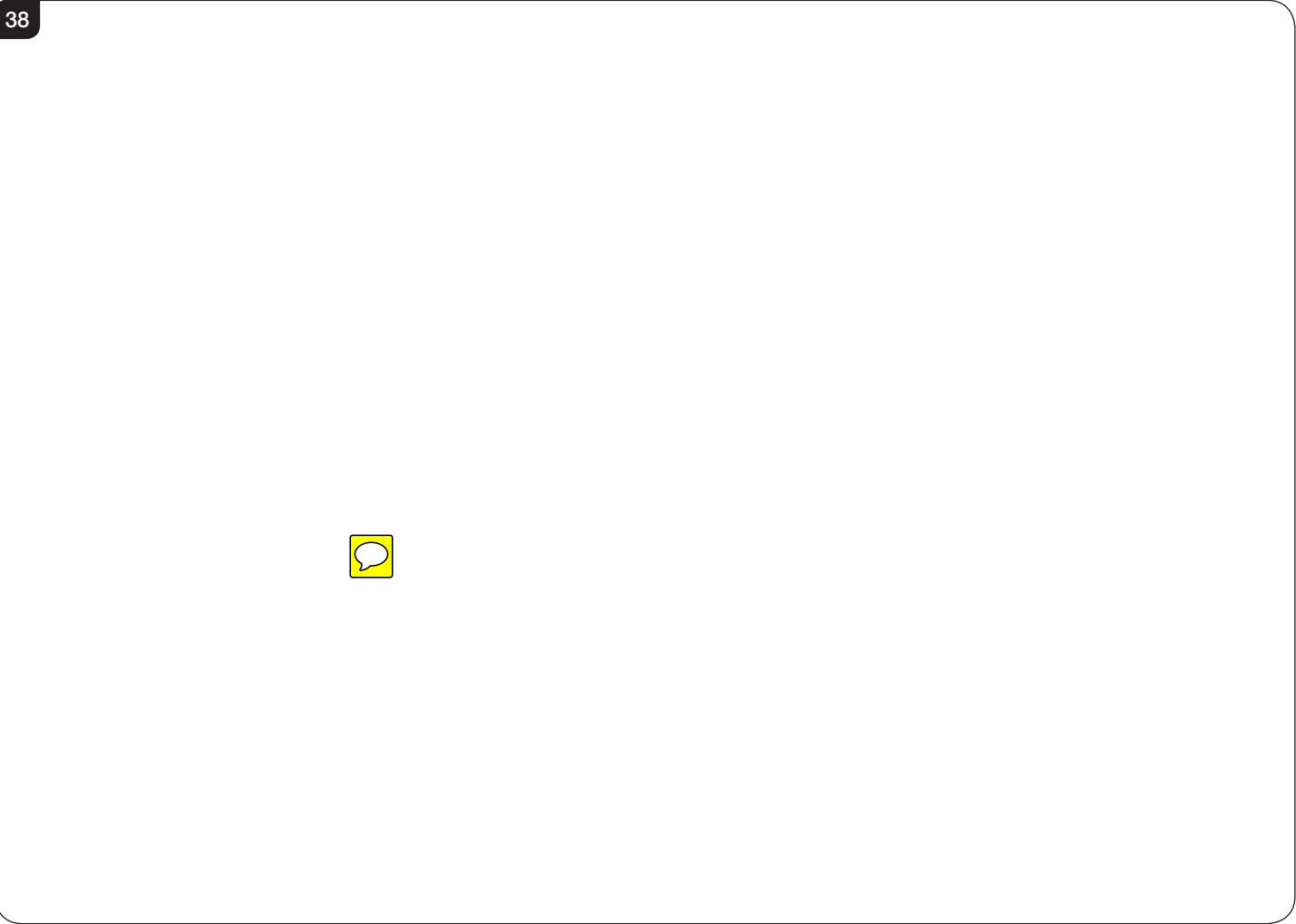

	A	B	C	D	E	F	G	H
Studio Slimline 1								
Studio Slimline 2								

Installation Instructions

For this cool-wall installation, the convected heat produced by the appliance is channelled into the chimney cavity and vented at the top.

The cool wall installation kit is provided unfinished. This allows the kit to be finished to match the front face decor.

There is an optional Studio Cool Wall Installation Kit available for installing the appliance without a frame: Studio Code No. 8727BFCW01.

Using the fixing kit:

- 6.2 Fit the four metal brackets of the kit to the sub-frame, see Diagram 39. There is a deliberate gap at the top for convected heat.

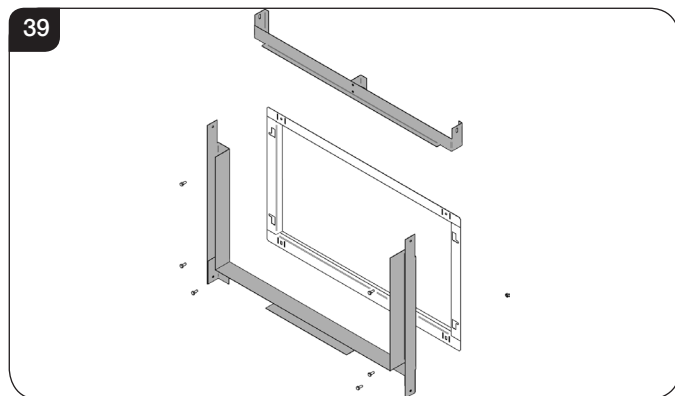

- 6.3 Fit the sub-frame to the appliance and ensure the returns of the sub-frame fit internally into the main outer box with the studs and securing nuts passing through the side slots. Secure by tightening the 4 nuts, see Diagram 30.

- 6.4 This now determines the width of your two vertical studwork supports. The kit has been designed so that non-combustible board can be taken right up to the edge of the four brackets, see Diagrams 40 & 41.

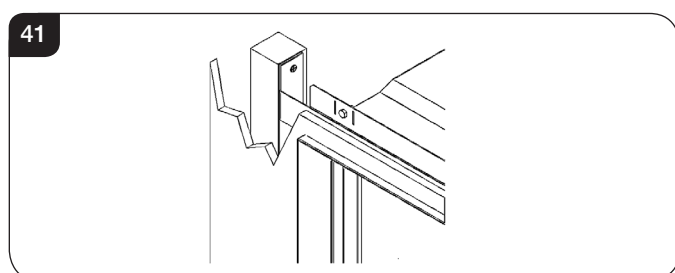
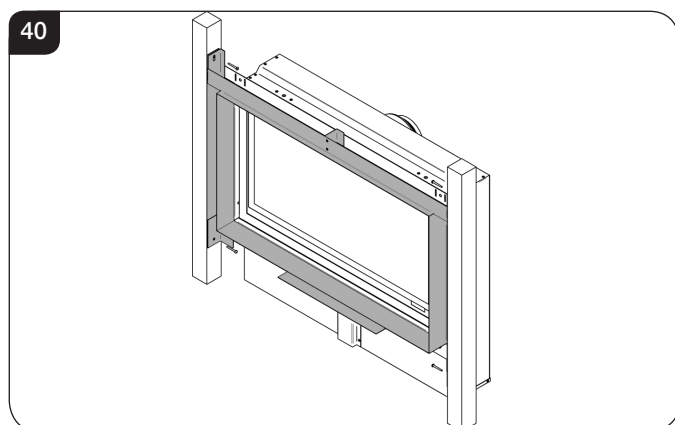

- 6.5 Fix the left and right metal brackets into the studwork. Build the studwork chimney breast to the desired size.
- 6.7 Ensure all clearances to combustible material are maintained, see Section 7.
- 6.8 Decide on flue requirements.
- 6.9 Cut a hole for the flue exit, see Installation Instructions, Flue Assembly.

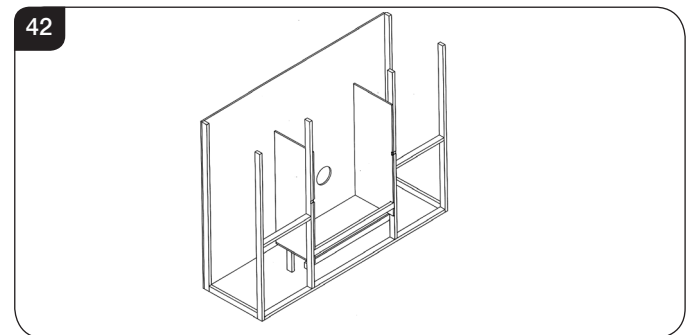

- 6.10 Secure the appliance to the vertical studwork through the holes in the metal brackets fitted to the appliance.

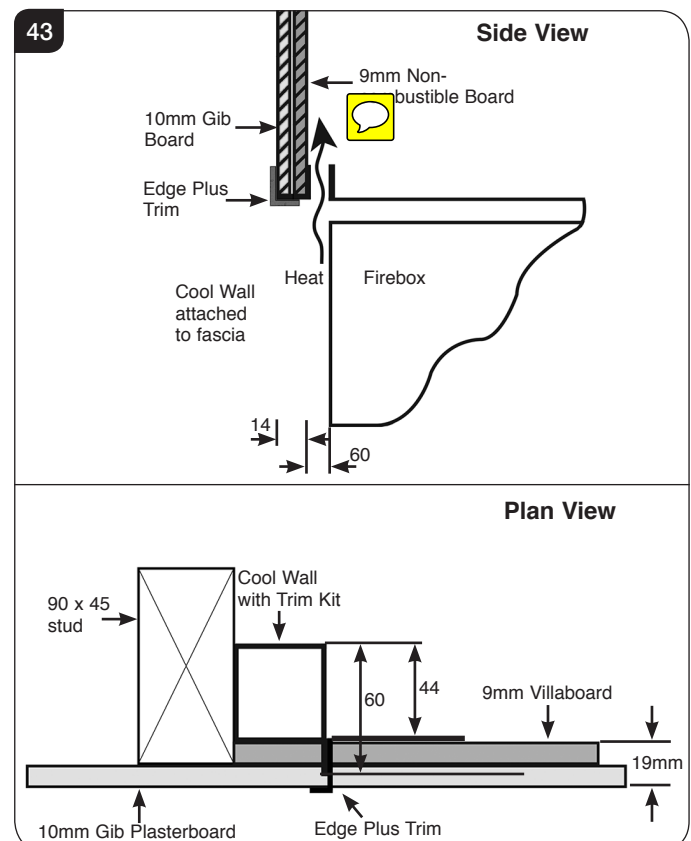

Installation Instructions

- 6.11 Fit Non-combustible board to the studwork around the appliance. This should extend a minimum of 400mm above the appliance and at least 50mm to the sides of the appliance (from the outer box, not the flanges).

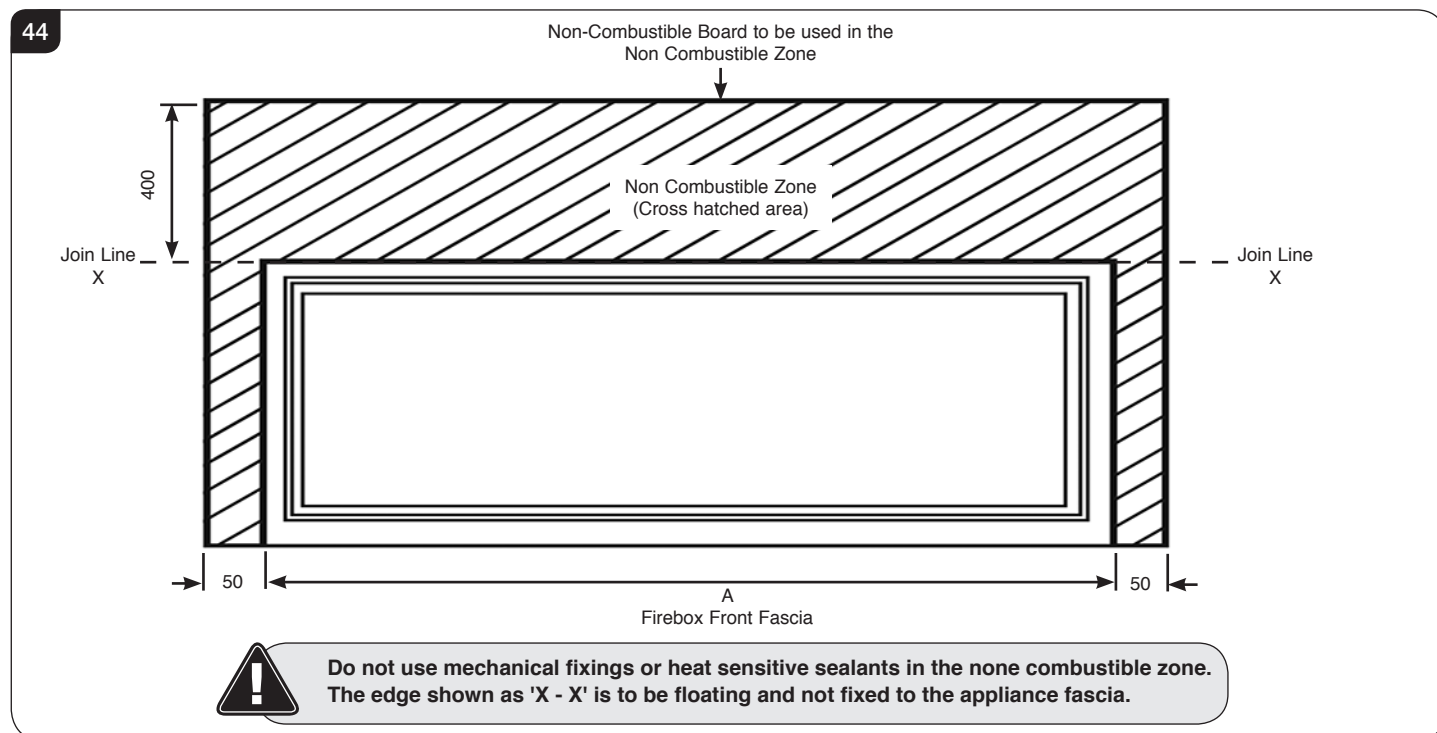

- 6.12 Fit plasterboard to the remaining chimney breast front.

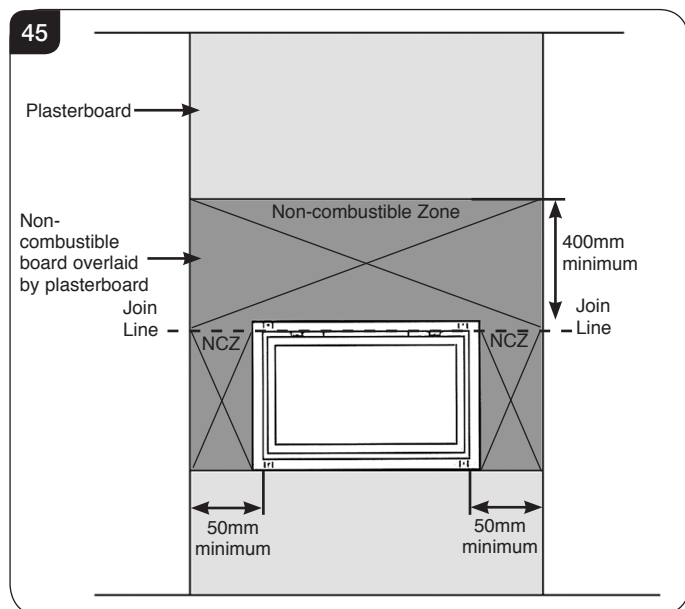

- 6.13 Connect the flue system and gas services using the opening in the side of the chimney breast for access.

- 6.14 After commissioning, finish the sides of the chimney breast, see Diagram 46.

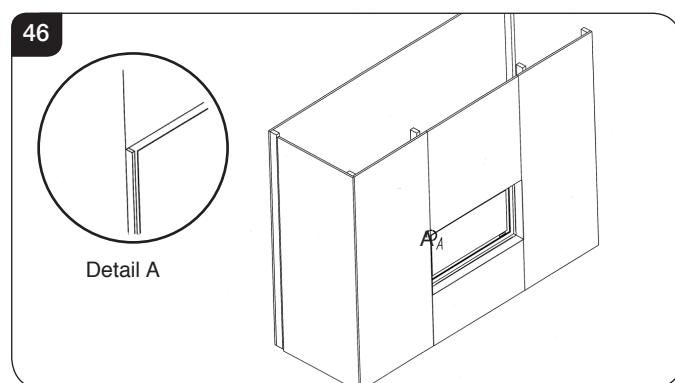

- 6.15 The top of the chimney breast must have a minimum 200cm² vent.

- 6.16 Apply a plaster finish to the chimney breast using heat resistant plaster in the area directly around the appliance, see Diagram 45.

7. All types of Installation

- Wall Box & Batteries

Installation Instructions

8.9 Cut through the flue and sleeve, see Diagram 51.

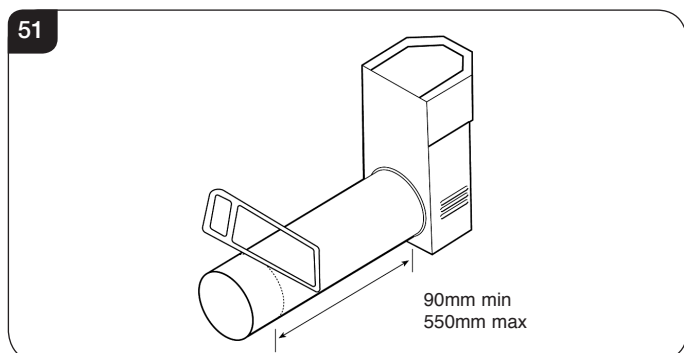

8.10 **REMOVE THE CARDBOARD REMNANTS FROM THE FLUE.**

8.11 File the cut edges smooth.

Terminal

On the outside wall:

8.12 Position the flue assembly into the hole. The terminal should be flat against the wall.

8.13 Make sure the terminal is vertical, see Diagram 10.

8.14 Mark the 4 fixing holes.

8.15 Remove the terminal to drill the holes.

8.16 Insert wall plugs supplied.

DO NOT FIX THE FLUE AT THIS STAGE.

Flue and Appliance Fixings

8.17 Position the appliance observing appropriate clearances.

8.18 Apply a bead of suitable weatherproof sealant (silicone or similar) to perimeter of back face of terminal, see Diagram 52.

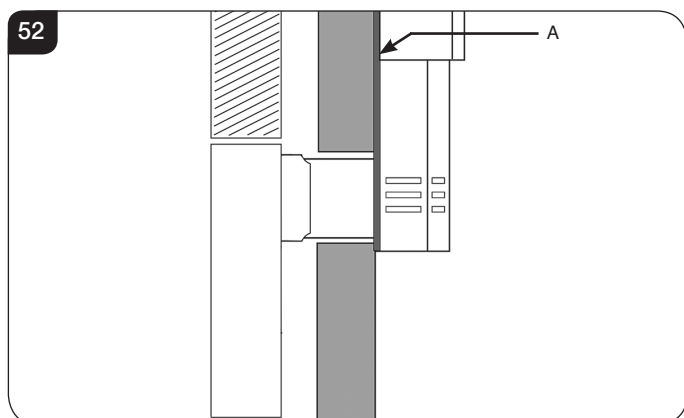

8.19 Feed the flue through the wall, making sure it runs smoothly.

8.20 Engage the flue in the inner and outer spigots.

8.21 Make sure rubber seal on the inner spigot is not damaged, it may be necessary to lubricate the seals with washing up liquid (or similar) to ease assembly.



To ensure a successful installation take out the baffle plate by removing the 8 fixing screws, see Diagram 53.

It is now possible to view if the end of the flue is located correctly, see Diagram 54.

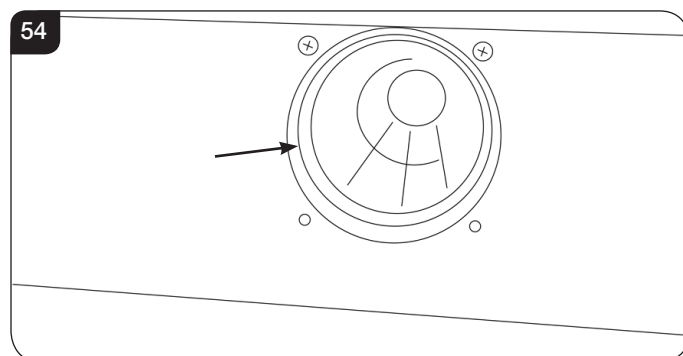
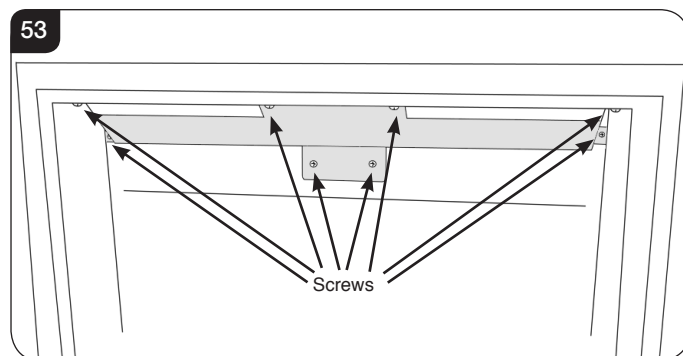

8.22 Insert 4 screws in the flanges of the flue terminal.

8.23 Check sealant has formed a water-tight joint to the wall.

8.24 Any terminal less than 2m above any access (level ground, balcony or flat roof with access) must be fitted with the guard supplied, see Diagram 55.

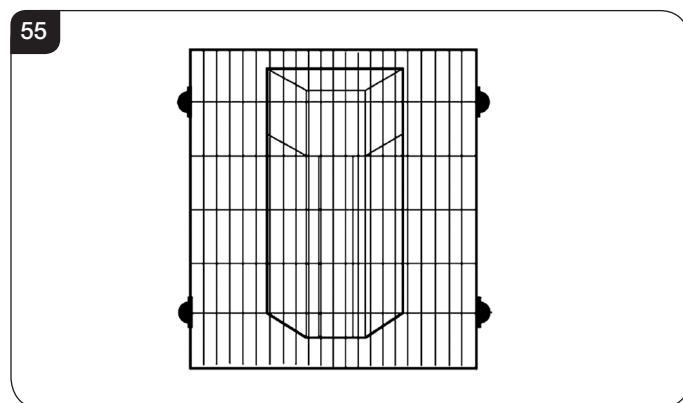

Installation Instructions

- 8.25 Finish the wall up to the edge of the appliance leaving a minimum of 15mm gap either side of the appliance to allow clearance for the sub frame fixings, see Diagram 56.

Ensure distance to combustibles are observed, see Diagram 56.

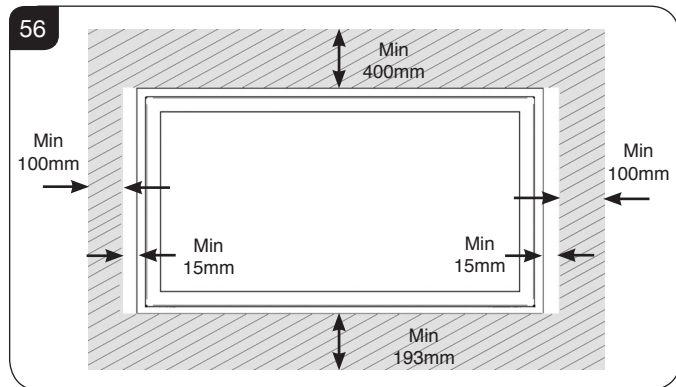

- 8.26 Fit non-combustible board from the bottom edge of the appliance to a minimum depth of 193mm, see Diagram 56. Finish these areas with heat resistant plaster.



IMPORTANT - IT IS THE RESPONSIBILITY OF THE INSTALLER TO ENSURE THAT THE APPLIANCE IS FIXED SECURELY IN THE WALL.

9. Assembling the Appliance

LINERS

There are several lining options available for the Studio Slimline range:

Vermiculite
Black Reeded
Brick Effect
Black Glass Linings - see separate instructions

To fit the liners:

- 9.1 There are two clips at the top of the firebox that are used to secure the back panel in position. These must be removed before fitting the liners, see Diagram 57.

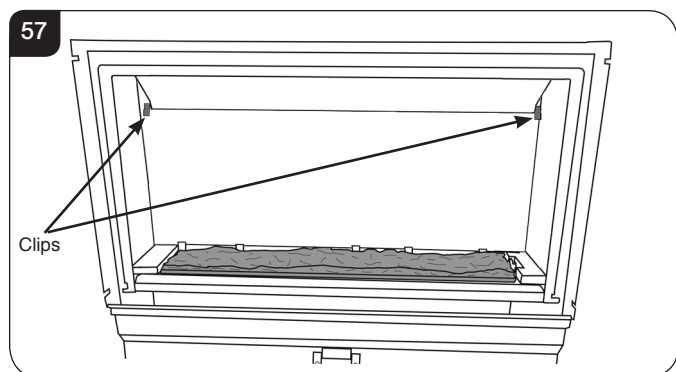

- 9.2 Place the Bottom Side Liners against the side and back of the firebox, then fit back liner panel into position against the back of the appliance, see Diagram 58.

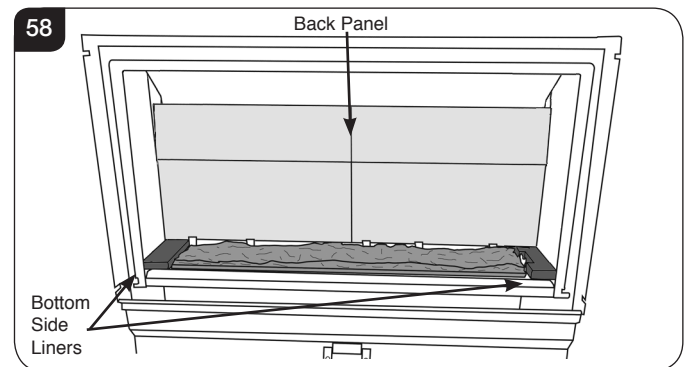

- 9.3 Reattach the two clips to hold the back panel in place, see Diagram 59.

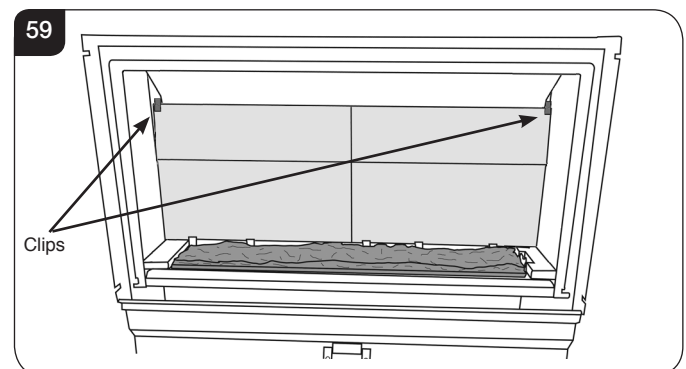

- 9.4 Slide the two side liners into place to finish, see Diagram 60.

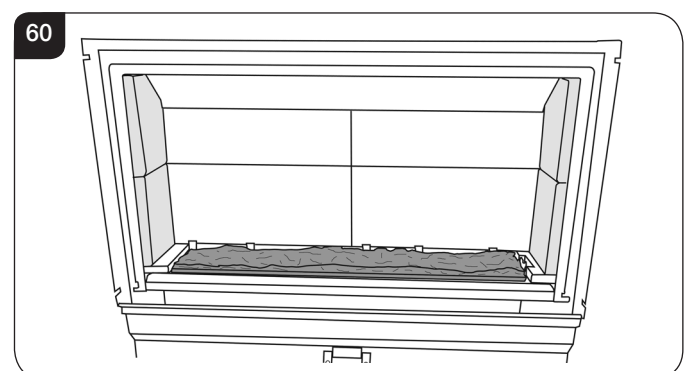

- 9.5 Removal of the liners is the reverse of this process.

Installation Instructions

10. Arrangement of the fuel bed

Advice on handling and disposal of fire ceramics



The fuel effect and liners of this appliance are made from Refractory Ceramic Fibre (RCF), a material which is commonly used for this application.

Protective clothing is not required when handling these articles, but we recommend you follow normal hygiene rules of not smoking, eating or drinking in the work area and always wash your hands before eating or drinking.

To ensure that the release of RCF fibres are kept to a minimum, during installation and servicing a HEPA filtered vacuum is recommended to remove any dust accumulated in and around the appliance before and after working on it. When servicing the appliance it is recommended that the replaced items are not broken up, but are sealed within heavy duty polythene bags and labelled as RCF waste.

RCF waste is classed as stable, non-reactive hazardous waste and may be disposed of at a licensed landfill site.

Excessive exposure to these materials may cause temporary irritation to eyes, skin and respiratory tract; wash hands thoroughly after handling the material.

11. Log Layout

LOGS MUST BE POSITIONED ACCORDING TO THE FOLLOWING INSTRUCTIONS TO GIVE THE CORRECT FLAME EFFECT

Studio 1 Layout

- 11.1 Ensure the burner tray is clean and free from any debris.
- 11.2 All logs can be identified by a letter (A - D) on their underside.

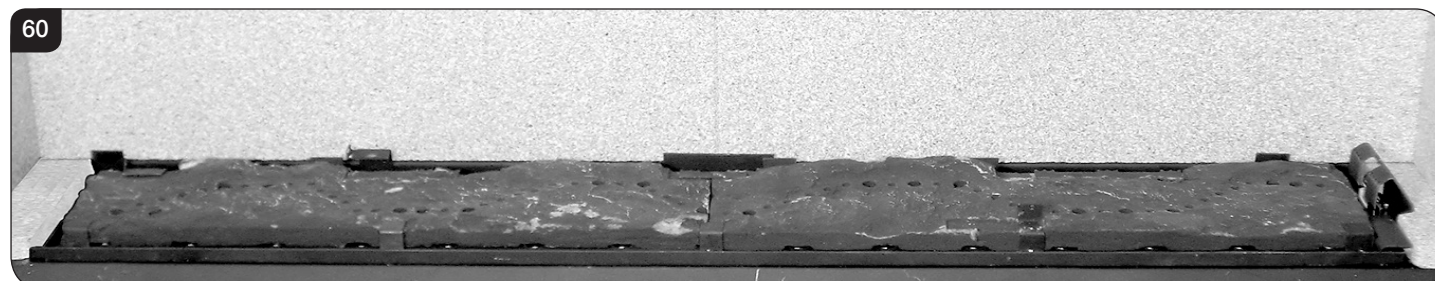

- 11.3 Position Log A between the two tabs at the back of the burner tray, see Diagram 61. The left hand side should rest on the tab at the back of the burner tray and be pushed up to the supporting lip, see Diagram 61 Detail.

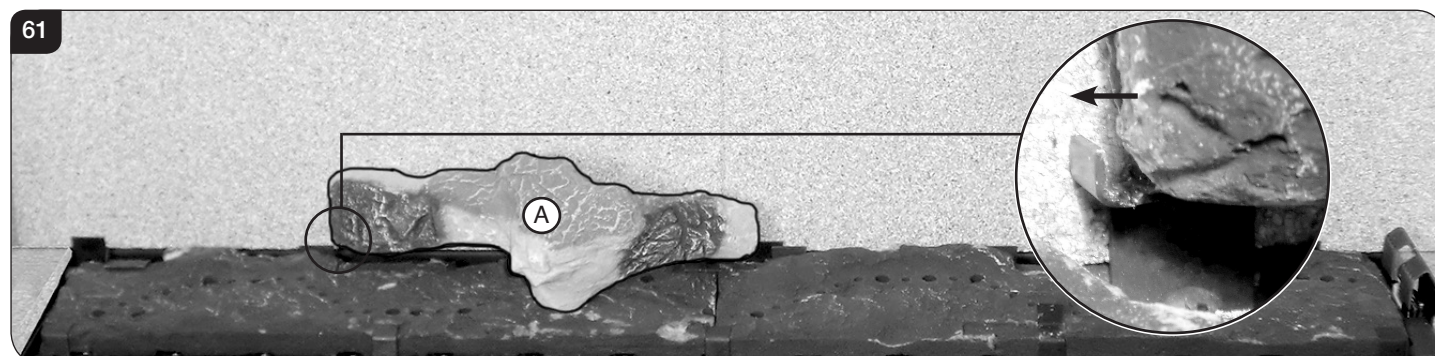

Installation Instructions

- 11.4 Place the left hand end of Log B against the back right tab on the burner tray, see Diagram 62.
Ensure that the front branch is in line with the front of the burner tray.

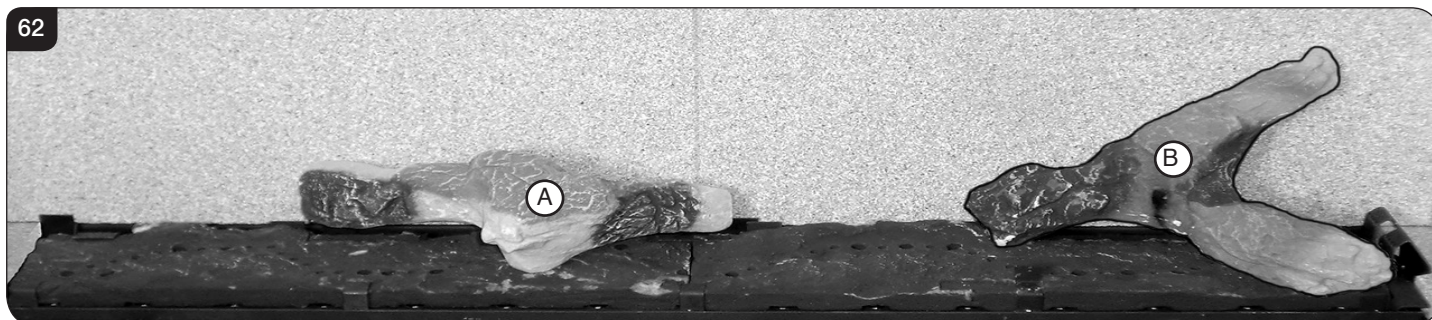

- 11.5 Rest the left end of Log C on the bottom left vermiculite panel in the back left corner, see Diagram 63.
The right end of Log C rests across Log A with the small front branch resting on the burner tray.
- 11.6 Engage the left hand end of Log D with the right hand end of Log A.
The right hand end of Log D fits in front of the metal stop on the front of the burner tray.

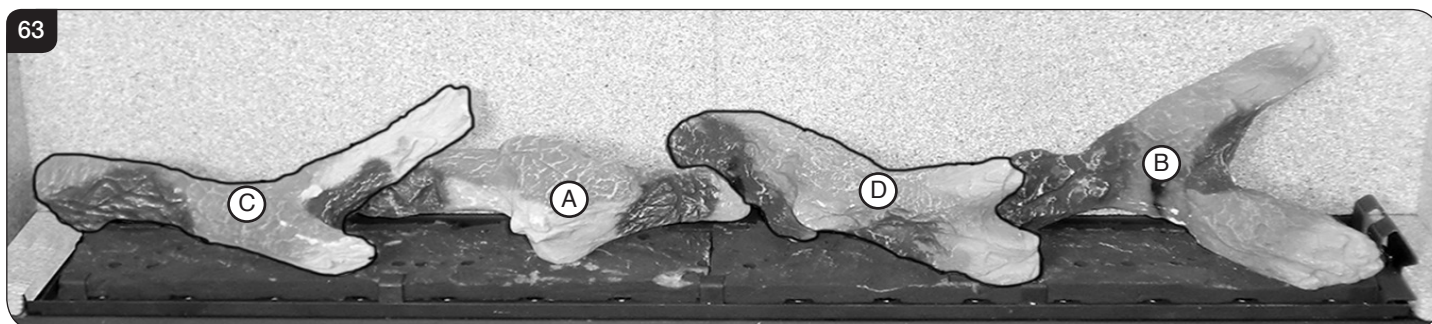

- 11.7 Separate the Embaglow material into smaller pieces and pull into shape to create a fine layer.
- 11.8 Place the pieces of Embaglow between the logs in the highlighted areas shown in Diagram 64. Ensure the material is placed loosely between the logs to create a random glow.



Installation Instructions

Studio 2 Layout

11.9 Ensure the burner tray is clean and free from any debris.

11.10 All logs can be identified by a letter (A , B, C, 2 x D, E) on their underside.

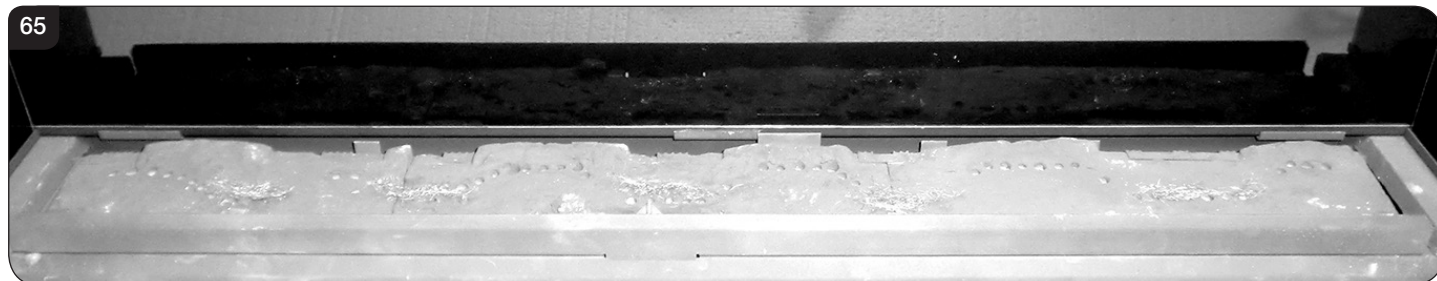

11.11 Position Log A between the two tabs at the back of the burner tray, see Diagram 66. Ensure that it is pushed up against the back panel and the end of Log A is on the raised section of the burner.

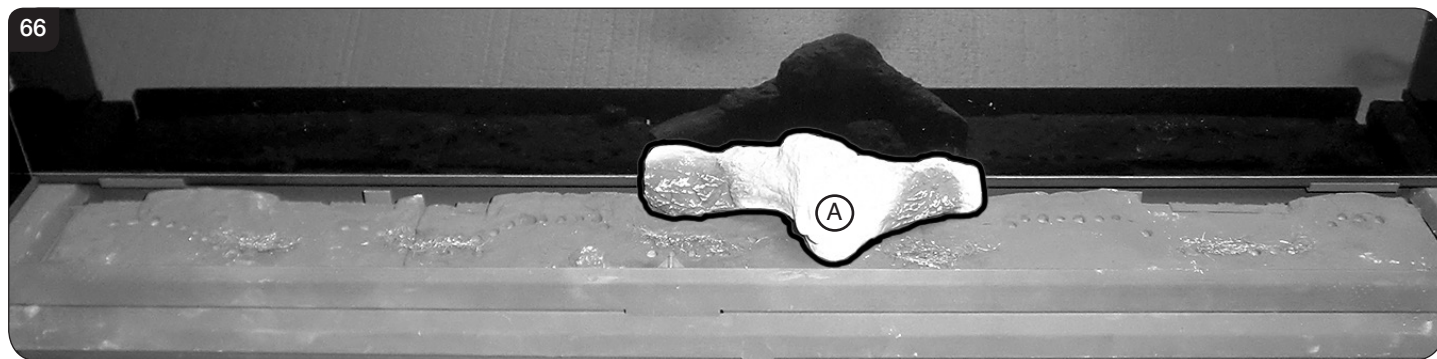

11.12 Place the left hand end of Log B against the back right tab on the burner tray, see Diagram 67. Ensure that the front branch is in line with the front of the burner tray.

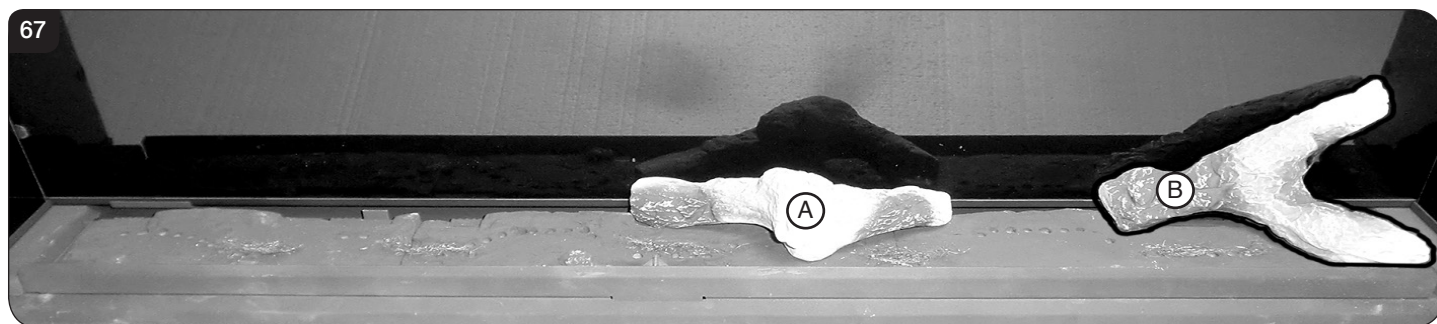

11.13 Rest the left end of Log D on the bottom left vermiculite pane, see Diagram 68. The right end of Log D should be touching the rear liner.

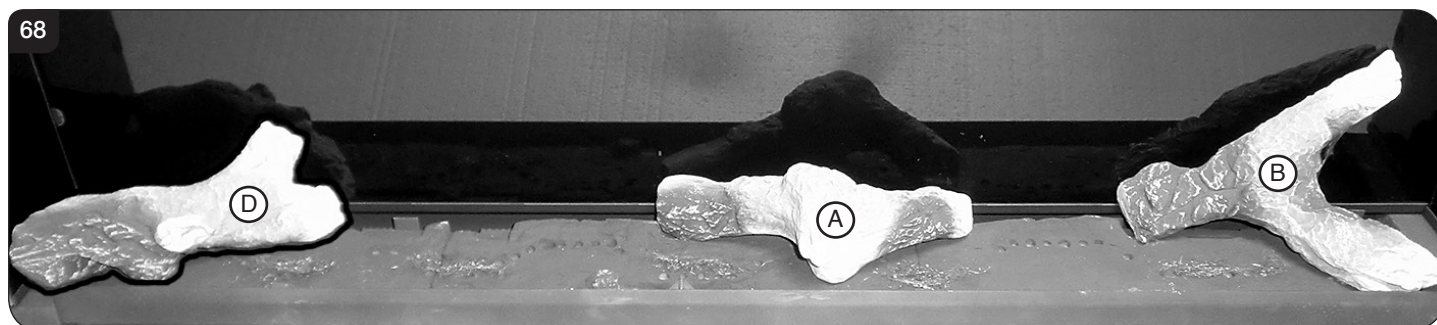

Installation Instructions

- 11.14 Engage the left hand end of Log D with the right hand end of Log A.
The right hand end of Log D fits in front of the metal stop on the front of the burner tray.

- 11.15 Place the left hand side of Log C to the rear of the burner tray against the tab and the right hand side at the front of the burner with the rear section resting on Log A.



- 11.16 Log E rests against logs C and D with the lower end located in the cutout in the burner, see Diagram 70.

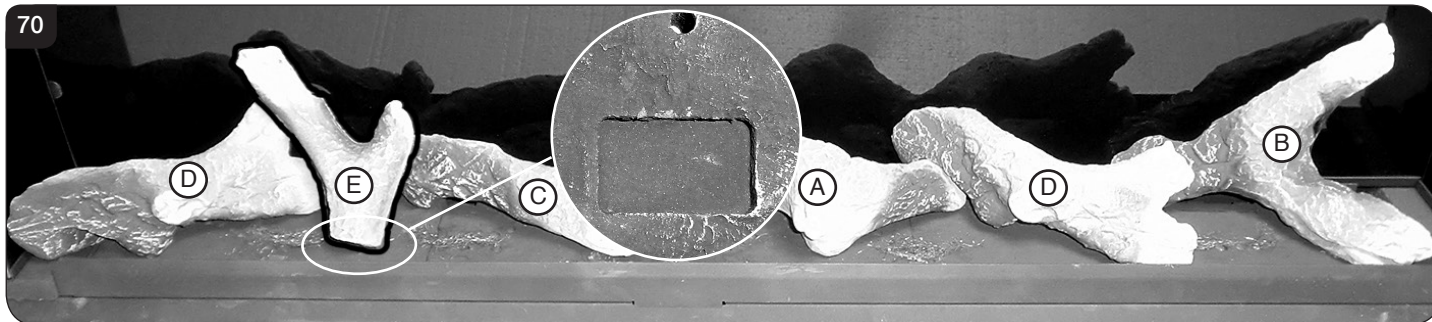

- 11.17 Separate the Embaglow material into smaller pieces and pull into shape to create a fine layer.

- 11.18 Place the pieces of Embaglow between the logs in the highlighted areas shown in Diagram 71. Ensure the material is placed loosely between the logs to create a random glow.

IMPORTANT EMBAGLOW MUST BE KEPT AWAY FROM THE PILOT.

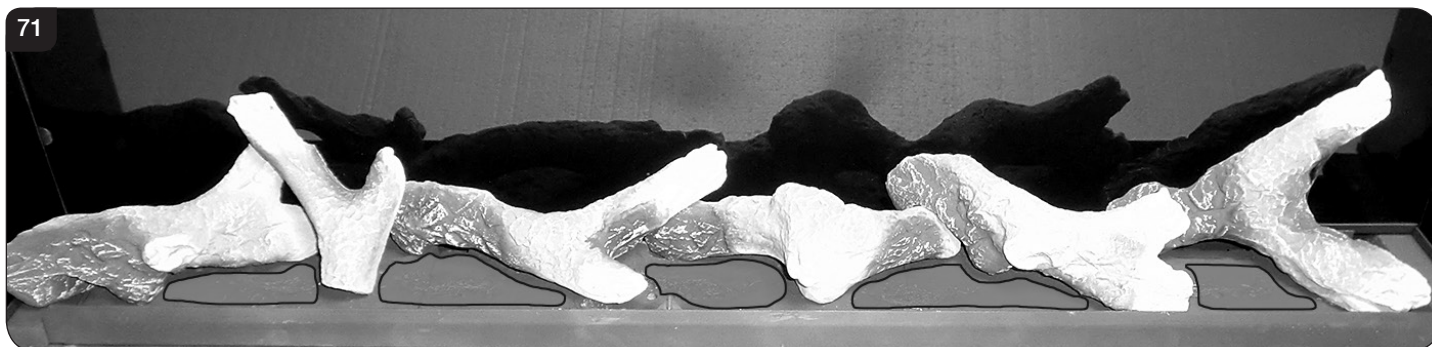

Installation Instructions

12. Stone/ Glass Fuel Effect Layout

- 12.1 To use the white stone or glass granule fuel effect, apply according to the following instructions to give the correct flame effect.
- 12.2 Ensure the burner tray is clean and free from any debris, see Diagram 72.

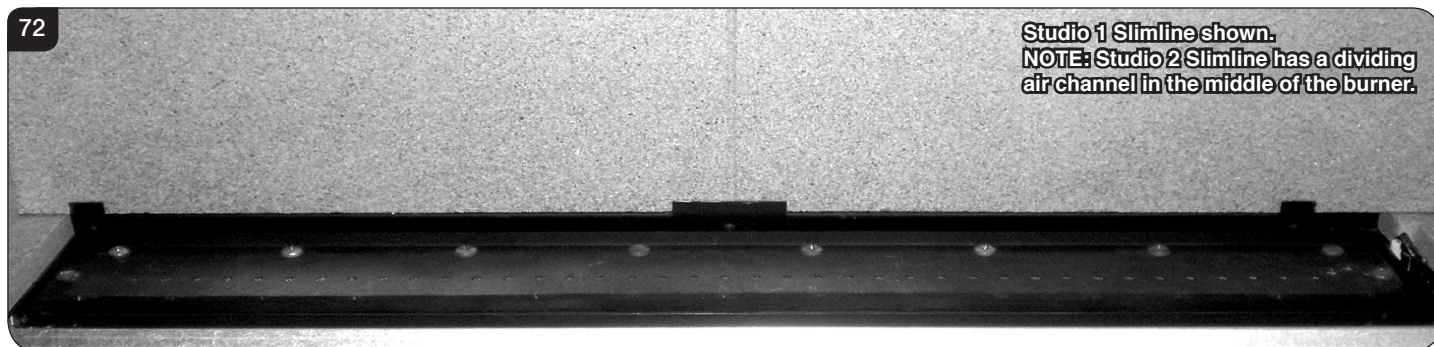

- 12.3 **ALL MODELS:** Fill the tray making sure the effect is flattened so it is level with the rim of the tray.
DO NOT OVERFILL THE BURNER TRAY.

STUDIO 2: Stack stones to cover dividing air channel but do not obstruct the gap.

TAKE CARE NOT TO SPILL EFFECT INTO THE PILOT AREA FRONT CHANNEL OR GAP AT REAR OF TRAY (ALL MODELS) AND THE DIVIDING AIR CHANNEL (STUDIO 2 ONLY) see Diagram 73 & 74.

ONLY GENUINE GAZCO PARTS CAN BE USED IN THIS APPLIANCE.

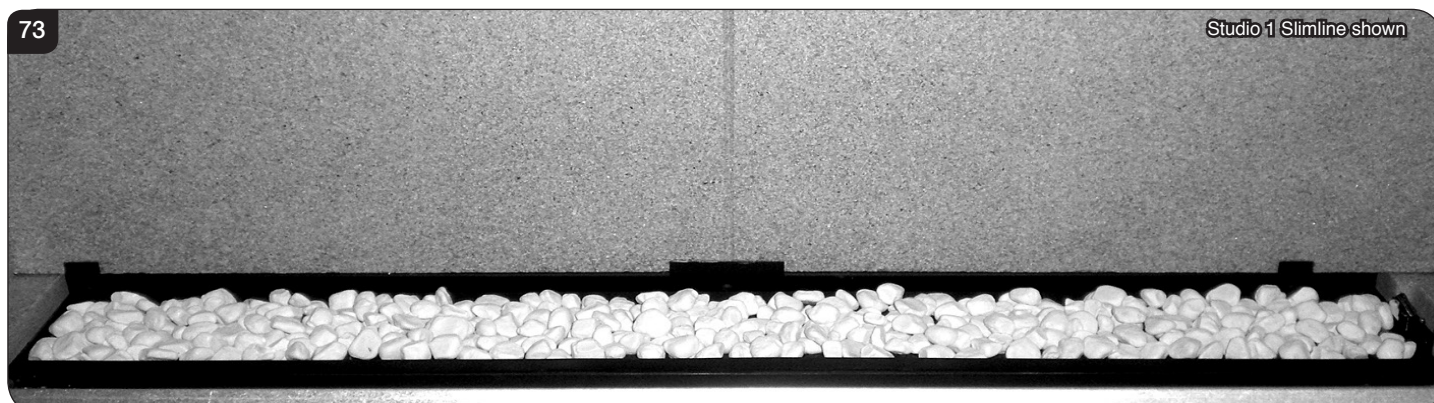

13. Completion of assembly

- 13.1 To fit the window frame keep the frame in the upright position with the locks uppermost.
- 13.2 Offer the frame to the foot of the opening.
- 13.3 Slide the frame to the right to locate the right hinge pin.
- 13.4 Manoeuvre the frame up towards the left side to locate the left hinge pin.
- 13.5 Slide onto the hinge with a right movement.
- 13.6 Secure in place with a spring clip at the right hinge pin, see Diagram 75.

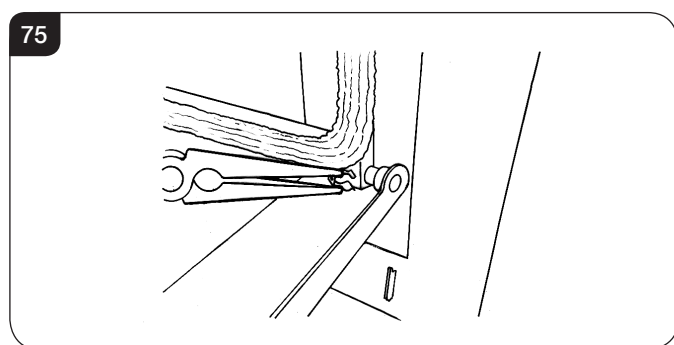

- 13.7 Close the window.
- 13.8 Using the hexagon key provided close the window locks by moving from open to shut towards the window centre, see Diagram 76.

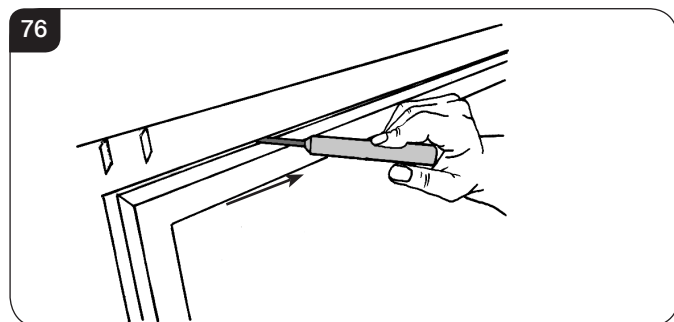

- 13.9 When closing the door ensure the door catches are fully engaged.

! UNDER NO CIRCUMSTANCES SHOULD THE APPLIANCE BE USED WITHOUT THE CATCHES HOLDING THE DOOR IN PLACE.

14. Lighting the Appliance

The appliance is operated by thermostatic remote control.

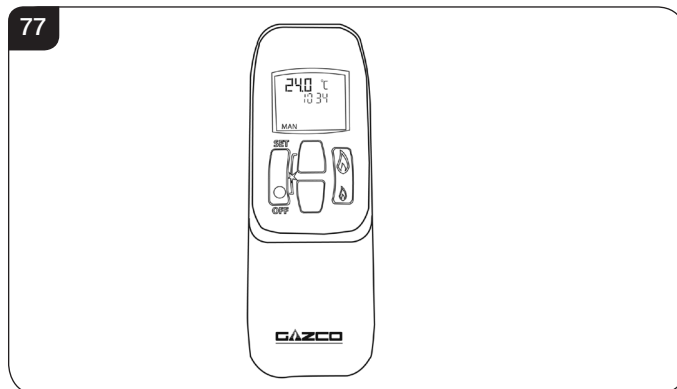

This remote controls the appliance from pilot ignition through to shut down.

In 'MANUAL MODE' you can:

- light the pilot.
- turn on the main burner.
- regulate the flame from low to high and back.
- turn off the burner leaving just the pilot burning.

In 'TEMP MODE' you can:

- set the room temperature so the stove automatically maintains that temperature.

In 'TIMER MODE' the fire:

- turns on and off according to the set time periods.
- automatically regulates the room temperature during the set periods.

14.1 Turning the appliance On

Your remote can control the gas fire from pilot ignition through to shut down.

To turn the fire on press the OFF button and the UP button simultaneously. You hear several short signals.

The pilot and main burner ignite and the remote is now in Manual Mode:

Turning the appliance Off:

Press the OFF button to turn the appliance off.
FOR SAFETY, YOU MUST WAIT 30 SECONDS BEFORE LIGHTING THE FIRE AGAIN.

i IMPORTANT: YELLOW FLAMES TYPICALLY APPEAR WHEN THE APPLIANCE HAS REACHED NORMAL OPERATING TEMPERATURE. THIS CAN TAKE UP TO 30 MINUTES.

! WARNING: IF THE APPLIANCE FAILS TO LIGHT OR BECOMES EXTINGUISHED IN USE, WAIT 3 MINUTES BEFORE ATTEMPTING TO RELIGHT.

FOR FULL OPERATING INSTRUCTIONS AND TROUBLESHOOTING SEE USER SECTION.

Commissioning

1. Commissioning

1.1 Complete the Commissioning Checklist at the front of this manual covering:

- Flue checks
- Gas checks
- Log layout - flame picture

For working pressure test, use the access panel at the gas connection ensuring the burner is in position. Refer to Replacement Parts, Section 16.

1.2 Ensure all safety checks listed in the Commissioning Section are completed, paying particular attention to the glass panel checks and securing of the glass frame.

1.3 Upon completion of the commissioning and testing of the installation and correct operation of the appliance, the installer must instruct the user how to operate the appliance.

1.4 Guide the user through the User Instructions paying particular attention to:

- a) Regular servicing (Section 10 of the User Instructions).
- b) Ventilation (Section 11 of the User Instructions) - point out the ventilation positions where applicable.
- c) Hot surfaces (Section 13 of the User Instructions).
- d) How the appliance works with the remote control handset and the modes of operation (Section 2 of the User Instructions).
- e) How to change settings in the auto mode and program modes of operation.
- f) What to do if the appliance fails to operate (Section 14 of the User Instructions).

Reprogramming handset/Control box

To access the control box see Servicing Instructions, Section 7 - Main Control Assembly.

— Press and hold the reset button on the control box until you hear two signals. After the second longer signal:

— Release the reset button and within 20 seconds:

— Press the DOWN button on the handset until you hear two additional short signals confirming the new code is set. If there is a single long signal the code learning sequence has failed or the wiring is incorrect.

Distributed by



The Fireplace
Head Office & Showroom
12 Tawari Street Mt Eden,
Auckland ph 09 623 6996
www.thefireplace.co.nz

Manufactured by

Gazco Limited, Osprey Road, Sowton Industrial Estate, Exeter, Devon, England EX2 7JG
Technical Customer Services (01392) 261950 Fax: (01392) 261951
E-mail: technicalservices@gazco.com

A member of the Stovax Group
Adapted from English Issue 6

E & O E



PR2317