



*Fire Your Imagination*

# Studio Slimline Range

## Zero Clearance Box



## Instructions for Installation

For use in GB & IE (Great Britain & Republic of Ireland).

### **IMPORTANT**

These products are only for use with the Studio Slimline products listed and must be installed and used in accordance with these instructions.

This manual is to be read in conjunction with the Studio Slimline Installation Instructions (PR2015).

# Installation Instructions

## 1. General

This manual has been designed to show the installation methods available when installing a Studio Slimline with the Gazco Zero Clearance Box.

Please carefully read in conjunction with the Installation Instructions for the Studio Slimline making sure the appropriate method is understood before attempting to install the product.

## 2. Kit Contents

- 1 x Installation Instructions (PR2268)
- 1 x A4 Self Sealing Bag

Box Fixings:

- 4 x Universal Rawl Plug
- 4 x 1/2" Recessed Pozi Screw
- 2 x M5 Pozi Screw

Frame Fixings:

- 2 x Retaining Clip
- 4 x M5 Pozi Screw

## 3. Appliance Location



**NOTE: THIS APPLIANCE HAS BEEN PRIMARILY DESIGNED TO BE RECESSED INTO THE INTERNAL BRICKWORK OF A STANDARD CAVITY WALL. HOWEVER, IT IS ALSO POSSIBLE TO INSTALL THE APPLIANCE INTO A FALSE CHIMNEY BREAST CONSTRUCTED OF STUDWORK AND PLASTERBOARD CLADDING.**

- 3.1 **If this appliance is fitted at floor level (giving a visible opening located 193mm from the floor) then it will require a hearth to protect the floor. The hearth should have a minimum non-combustible thickness of 12mm, projecting 300mm in front and 150mm either side of the base of the appliance.**
- 3.2 This appliance must stand on a non-combustible platform that is at least 12mm thick.  
This can be made from brickwork or using non-combustible board.
- 3.3 Using the Zero Clearance Box the appliance can only be finished with the decorative frame supplied.
- 3.4 There are two methods of installation:
1. Masonry Installation - see Section 5
  2. Studwork Installation - see Section 6

# Installation Instructions

## 4. Technical Specification

### Dimensions

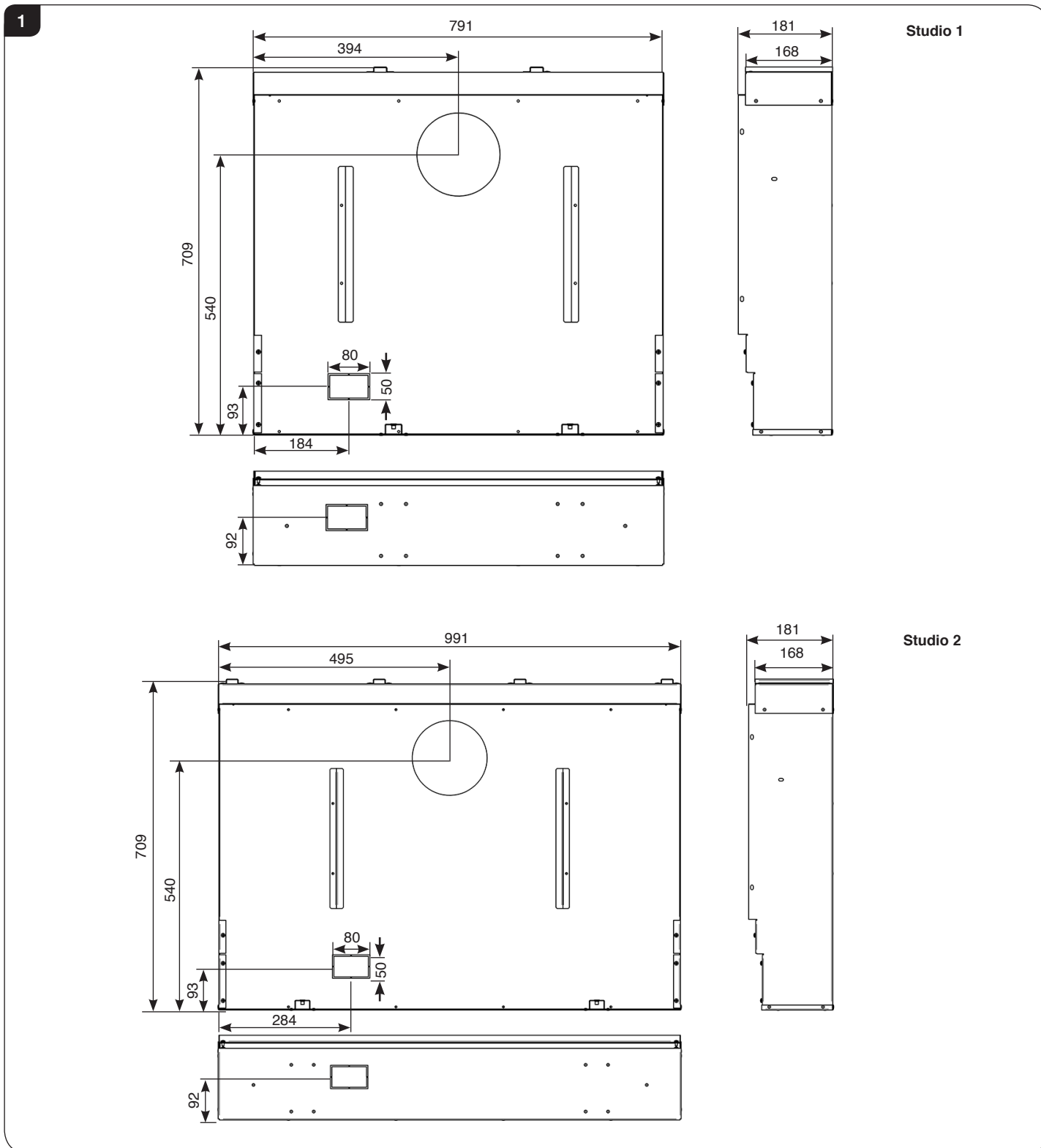

# Installation Instructions

## 5. Masonry Installation

This method of installation requires structural alteration to the intended location. A suitable supporting lintel must be installed to maintain the structural integrity of the surrounding blockwork.

The Masonry Installation is finished with a Decorative Frame. **Carefully read and understand the installation section before proceeding.**

- 5.1 Mark the position of the lintel so that it sits centrally over the intended installation. Remove the blockwork and install the lintel using mortar to ensure a strong bond with the surrounding wall, see Diagram 2.

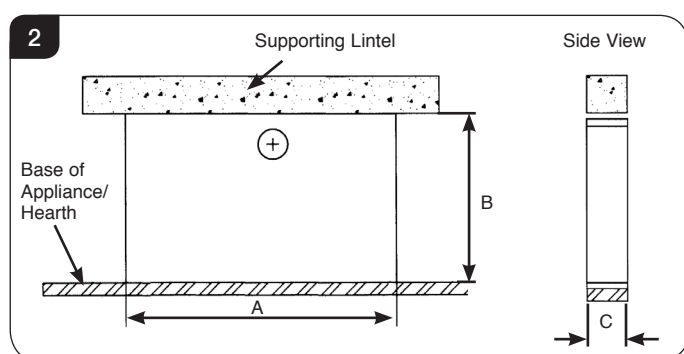

Model	Studio 1 Slimline	Studio 2 Slimline
A	801mm	1001mm
B	719mm	719mm
C	153mm	153mm

- 5.2 With the lintel in position mark the width of the aperture and remove the blockwork.

- 5.3 Remove wall finish (eg plaster) from the area shown in Diagram 3 to the size of the appliance and lintel area.

It is recommended a larger area is removed above the opening so that when reapplying plaster joints are outside the heatzone.

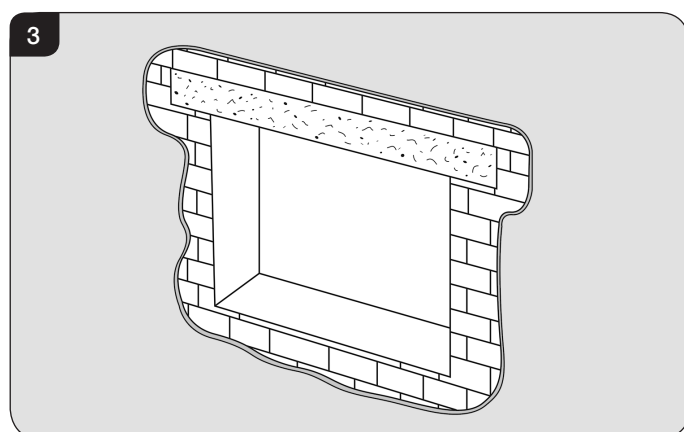

- 5.4 Consider the final flue position ensuring that all required clearances are complied with, see Installation Instructions, Site Requirements Section 1.

- 5.5 Mark the position of the flue on the wall by measuring from the top of the finished hearth level/ base of the appliance, see Diagram 4.

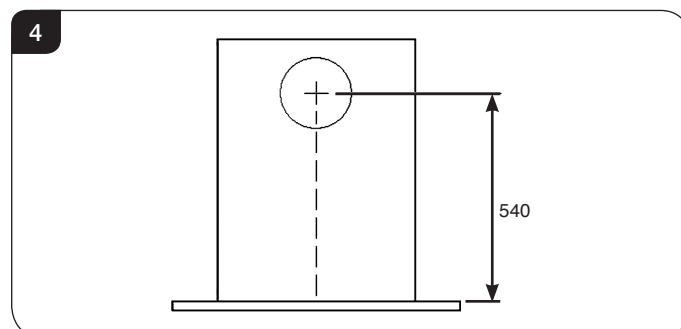

- 5.6 A 152mm (6") diameter hole is required to install the flue. This can be achieved by either:

- Core drill
- Hammer and chisel

It is advisable to drill small holes around the circumference when using method b. Make good both ends of the hole.

- 5.7 Prepare gas supply and cable. If installing into a cavity, no joints should be within the cavity and the pipe must be sleeved. Refer to gas installation requirements.

- 5.8 Install the battery cable and wall plate box. Gazco recommend that the cable is installed through conduit or similar to give protection and allow for future servicing.

When deciding the route of the cables consideration must be given to avoid contact with the appliance and the flue system.



**IMPORTANT - Do not run the battery cable up the side of the appliance outer casing.**

See Installation Instructions, Section 9 for wall box and batteries installation.



The wall box must be installed using a non-metallic mounting box, please ensure that the plastic dry lining box is used where possible. For masonry installation it is possible to drill through the rear of the box and secure in position using wall plugs and screws although a small amount of finishing work will be required to cover the plastic side securing tags. Alternatively a standard 45mm (or greater) deep patress box can be used to surface mount the wall plate.

# Installation Instructions

- 5.9 Fit the Zero Clearance Box into the builders opening, see Diagram 5.

The two standoffs on top of the box are to ensure sufficient air circulation around the appliance.

Ensure nothing is closer than these two points.

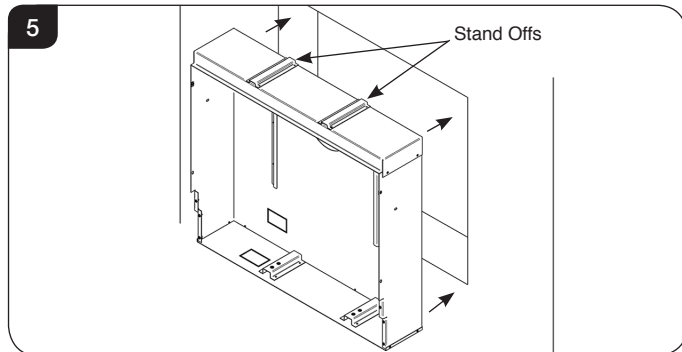

The fitted box will protrude 28mm from the opening, see Diagram 6.  
This allows for the wall to be finished with a sheet of 12mm plasterboard and a 3mm skim of plaster up to the first protruding edge - see 5.17 for more details.

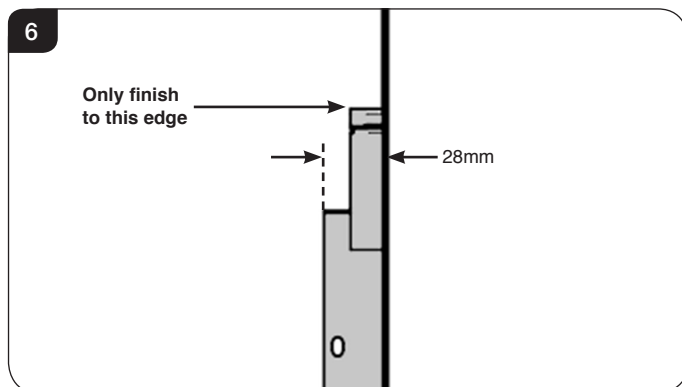

- 5.10 Secure with 4 x 1/2" bolts through the holes in the sides and base of the box.

- 5.11 Remove the lower plate.

- 5.12 Fit the supplied flue seal to the Rear exit spigot, see Diagram 7.

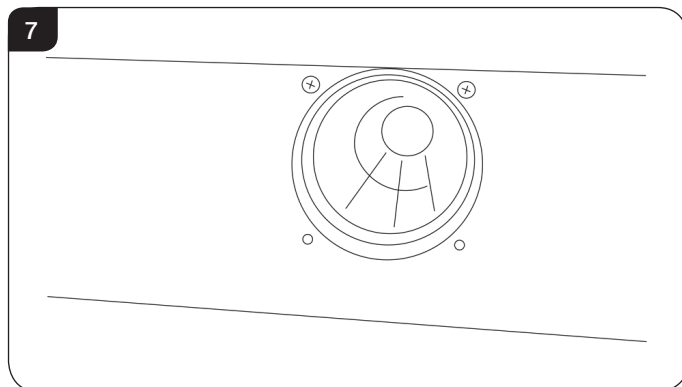

- 5.13 Remove engine and burner assembly.

- 5.14 Slide the appliance into the box taking care to fit the flue into position.

- 5.15 Secure through the base of the appliance using the fixing screws supplied, see Diagram 8.

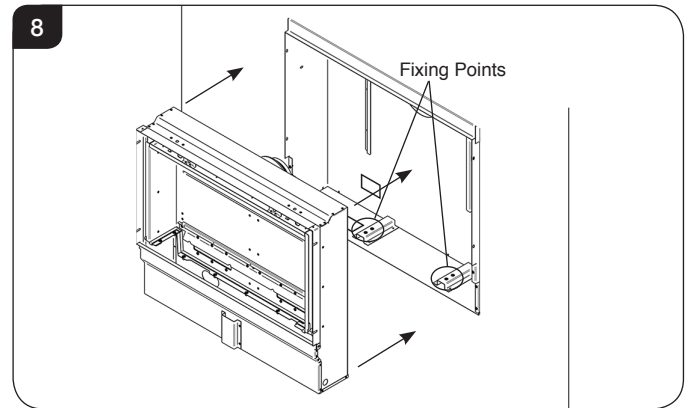

- 5.16 Attach the front panel to the Zero Clearance Box, see Diagram 9.

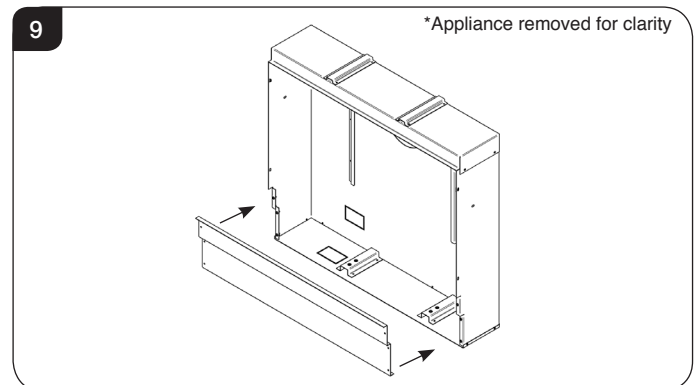

- 5.17 Finish the wall to the first protruding edge top, bottom and sides using plasterboard and a plaster skim, see Diagram 10.

**Note: This will leave an exposed metal face which will be covered by the decorative frame.  
Do not finish up to the flange for the frame.**

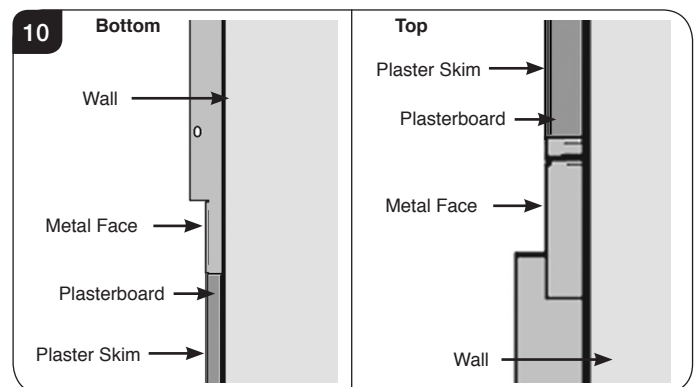

- 5.18 Proceed to Section 7.

# Installation Instructions

## 6. Studwork Installation

- 6.1 Build the studwork chimney breast and enclosures to the desired size including the protected platform at the required height, see Diagram 11.

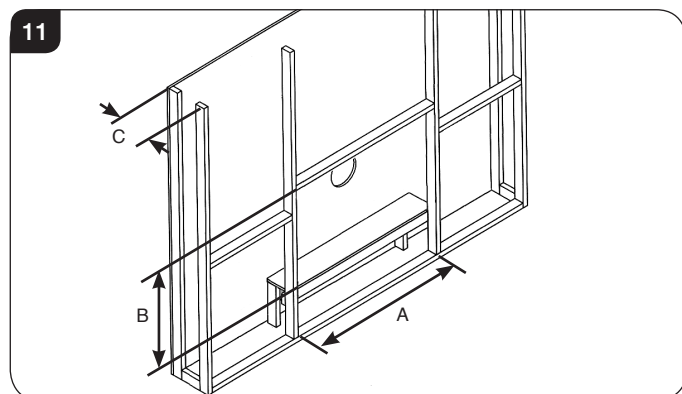

Model	Studio 1 Slimline	Studio 2 Slimline
A	801mm	1001mm
B	719mm	719mm
C	153mm	153mm

The Studwork Installation is finished with a Decorative Frame. **Carefully read and understand the installation section before proceeding.**

- 6.2 Consider the final flue position ensuring that all required clearances are complied with, see Installation Instructions, Site Requirements Section 1.
- 6.3 Mark the position of the flue on the wall by measuring from the top of the finished hearth level/ base of the appliance, see Diagram 12.

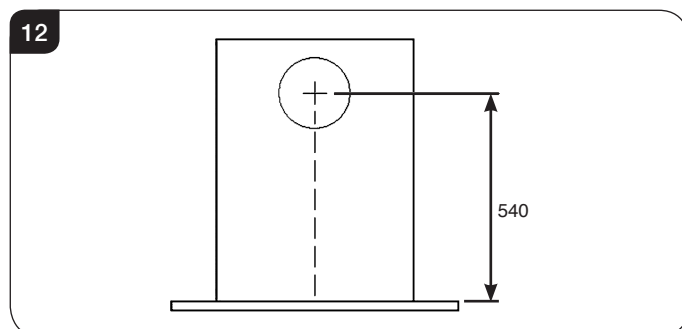

- 6.4 A 152mm (6") diameter hole is required to install the flue. This can be achieved by either:
- Core drill
  - Hammer and chisel
- It is advisable to drill small holes around the circumference when using method b. Make good both ends of the hole.
- 6.5 Prepare gas supply and cable. If installing into a cavity, no joints should be within the cavity and the pipe must be sleeved. Refer to gas installation requirements.

- 6.6 Fit the Zero Clearance Box into the builders opening, see Diagram 13.

The two standoffs on top of the box are to ensure sufficient air circulation around the appliance.

Ensure nothing is closer than these two points.

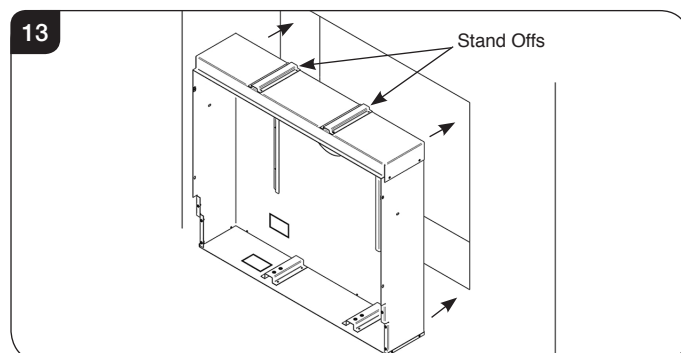

The fitted box will protrude 28mm from the opening, see Diagram 14.

This allows for the wall to be finished with a sheet of 12mm plasterboard and a 3mm skim of plaster up to the first protruding edge - see 6.14 for more details.

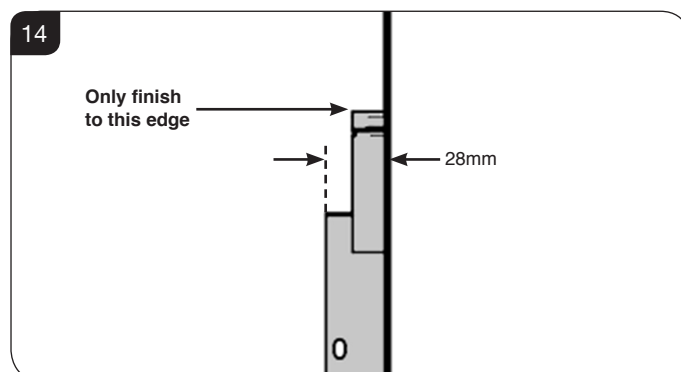

- 6.7 Secure with 4 x 1/2" bolts through the holes in the sides and base of the box and into the studwork.
- 6.8 Remove the lower plate.
- 6.9 Fit the supplied flue seal to the Rear exit spigot, see Diagram 15.

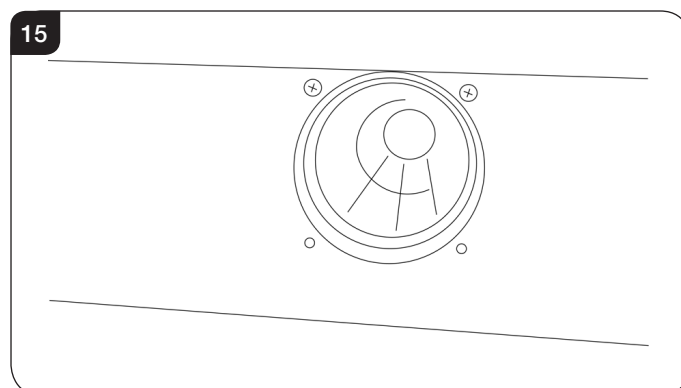

- 6.10 Remove engine and burner assembly.

# Installation Instructions

- 6.11 Slide the appliance into the box taking care to fit the flue into position.
- 6.12 Secure through the base of the appliance using the fixing screws supplied, see Diagram 16.

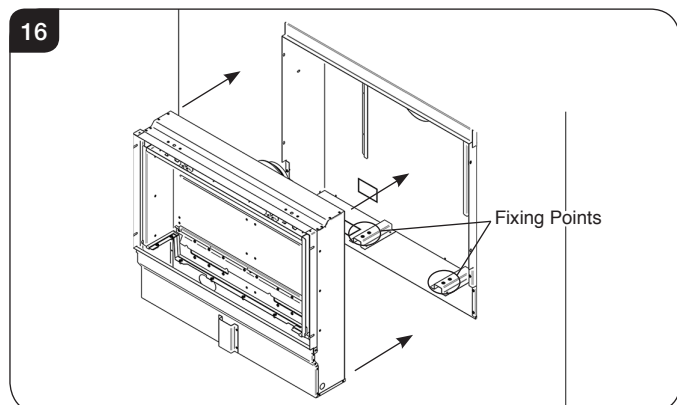

- 6.13 Attach the front panel to the Zero Clearance Box, see Diagram 17.

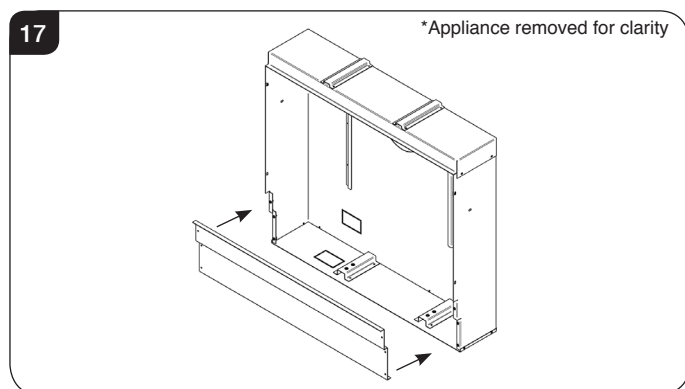

- 6.14 Finish the wall to the first protruding edge top, bottom and sides using plasterboard and a plaster skim, see Diagram 18.
- Note: This will leave an exposed metal face which will be covered by the decorative frame. Do not finish up to the flange for the frame.**

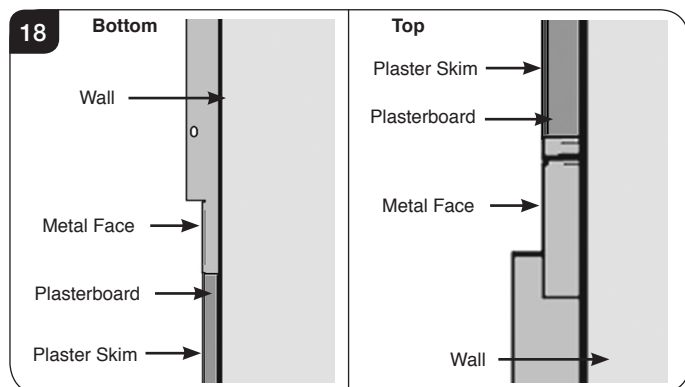

- 6.15 Commission the appliance as described in the main installation instructions.
- 6.16 Proceed to Section 7.

## 7. Fitting the Frame

- 7.1 The Zero Clearance box is supplied with a choice of bespoke frames, however the fitting method is the same for both.
- 7.2 The frame consists of two parts - a subframe and a decorative inner frame.

### Fitting the Sub-frame

- 7.3 Offer the subframe to the Zero Clearance Box. The tabs with fixing holes on each side must go outside the box wall, see Diagram 19a & 19b.

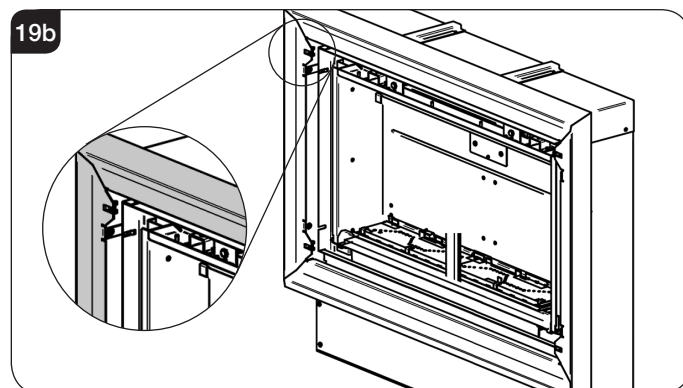
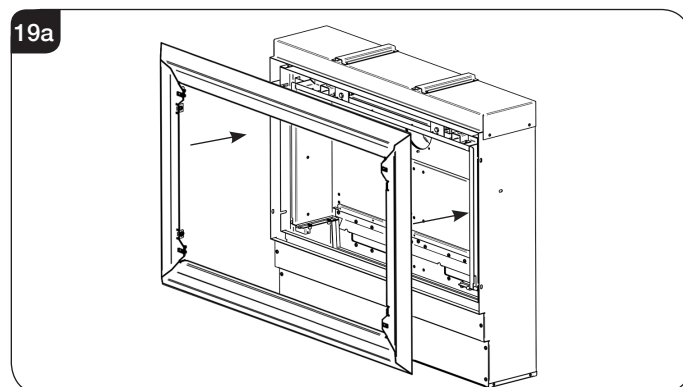

- 7.4 Secure on each side with 2 fixing screws. Before fitting the top screws, retaining brackets must be used to holdback the Zero Clearance Box, see Diagram 20.

**NOTE: When fitting the retaining brackets it is essential to push the brackets as far back into the slots of the Zero Clearance Box as possible. Maintain pressure whilst securing with the screws to ensure the box is in the correct position.**

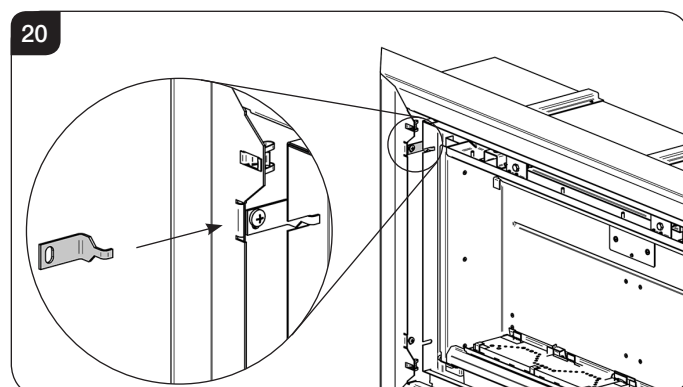



# Installation Instructions

## Fitting the Inner-frame

### 7.5 ZC Glass Only

The inner frame has a specific orientation. Ensure the tab on the rear of the frame is at the top when fitting, see Diagram 21.

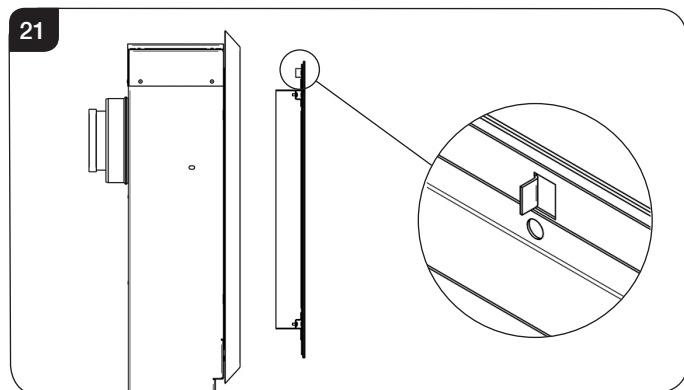

### 7.6 All models

Offer the Inner frame in an upright position to the subframe.

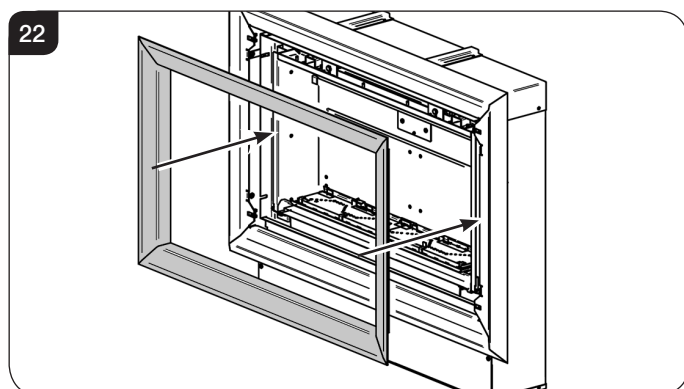

7.7 Push the four studs on the Inner frame into the catches on the subframe, see Diagram 23.

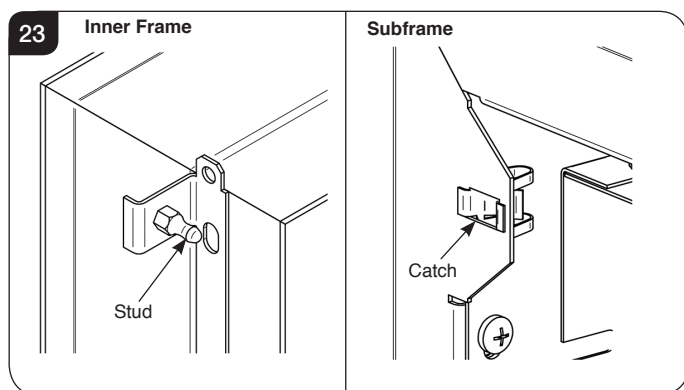

The inner frame is held securely and can be pulled off if servicing requires.

24

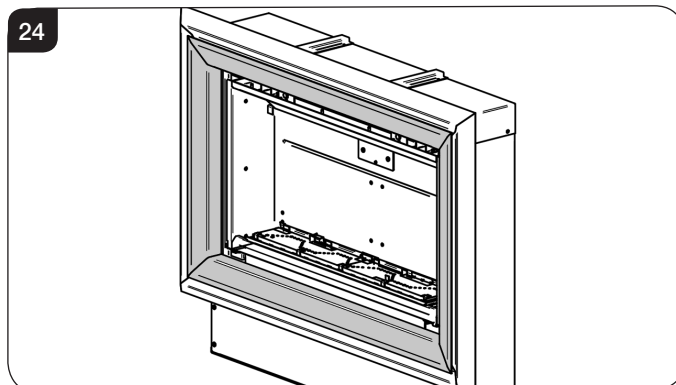

**NOTE: IT IS POSSIBLE TO FIT/REMOVE THE DECORATIVE FRAME WITH THE WINDOW FRAME ASSEMBLY IN POSITION, HOWEVER IT IS EASIER TO DO THIS OPERATION WITH THIS REMOVED - SEE INSTALLATION INSTRUCTIONS FOR DETAILS.**



**TAKE CARE NOT TO MARK THE DECORATIVE FRAME WHEN REMOVING/FITTING THE WINDOW FRAME ASSEMBLY.**









**Gazco Limited, Osprey Road, Sowton Industrial Estate, Exeter, Devon, England EX2 7JG**  
**Technical Customer Services: (01392) 261950 Fax: (01392) 261951**  
**E-mail: [technicalservices@gazco.com](mailto:technicalservices@gazco.com)**

A member of the Stovax Group

E & O E