

## 2B. Top Flue Up and Out with Additional Bend

An additional bend may be used on the horizontal section (either 45° or 90°), but the overall horizontal flue run will be reduced, see Diagram 5B.

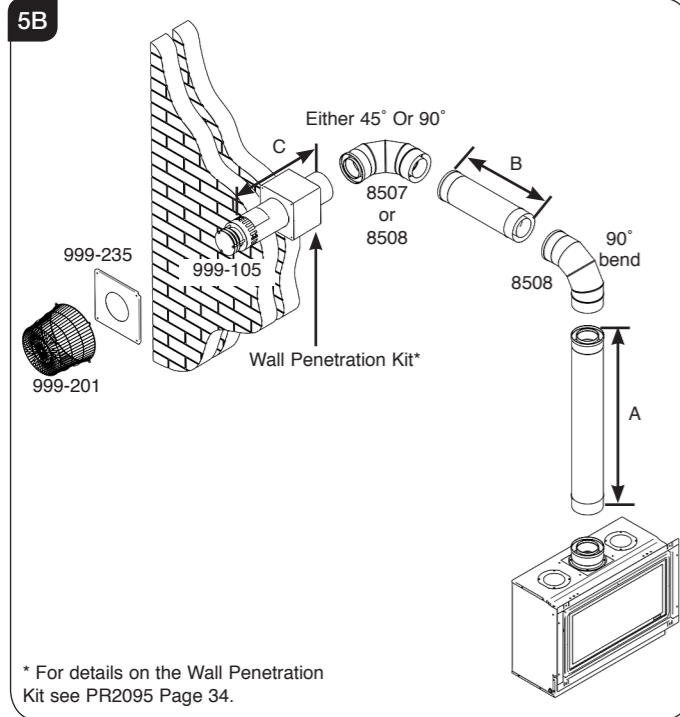

\* For details on the Wall Penetration Kit see PR2095 Page 34.

### Studio 1 & 2

When A = 1.0 to 1.499 metres B + C = 1.0 metres maximum  
When A = 1.499 metres to 3.0 metres B + C = 4.0 metres maximum

### Studio 3

When A = 1.5 to 2.499 metres B + C = 1.0 metres maximum  
When A = 2.5 metres to 3.0 metres B + C = 4.0 metres maximum

Pipe Length	Stainless Steel Finish
200mm	8527
500mm	8528
1000mm	8529

## Frame Options

Frames available for this appliance:

- Edge
- Cool Wall
- Profil
- Bauhaus
- Glass
- Verve
- Steel2
- Expression

Depending on frame choice refer to the main Installation Instruction manual provided with the appliance or PR1158 Studio Frame Instructions

## 2C Top Flue Vertical Kit (8524)

- 2.3 Vertical from the top of the appliance, see Diagram 5C.  
A minimum vertical rise 3m (9'10") to a maximum 10m (32'10").  
The basic kit comprises:  
2 x 1m lengths  
1 x 1m terminal length  
1 x 52mm restrictor  
1 x 47mm restrictor  
1 x 60mm restrictor  
1 x 70mm restrictor  
Extra lengths may be added, see PR2095 Page 12.

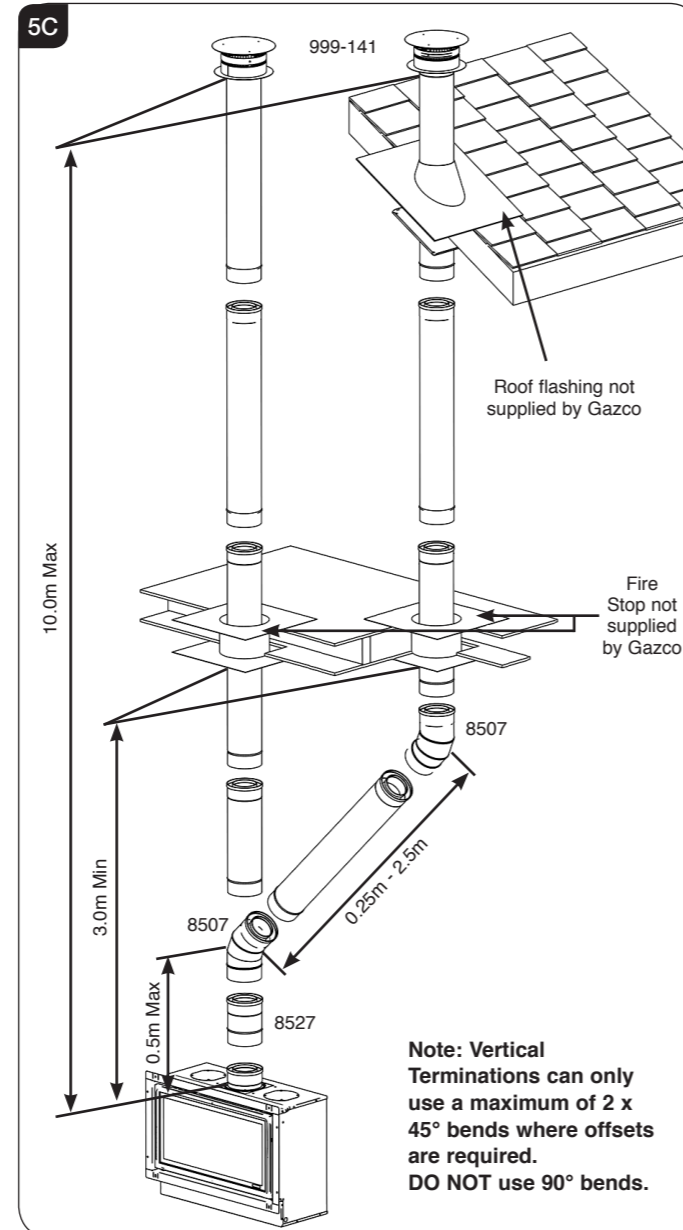

## Flue Clearances

### Minimum Flue Clearances to Combustibles

To the sides and undersides: 25mm  
Above the flue: 75mm

# GAZCO

Fire Your Imagination

PR2093 NZ Info Sheet Issue 2 (May 2015)



## Glass Fronted Studio Balanced Flue (NZ)

### Information Sheet for Builders & Designers



### IMPORTANT

This Information Sheet is intended as a reference guide for minimum cavity and flue requirements when installing a Gazco Studio appliance only and not a substitution for the full instruction manual. It is essential to read and fully understand the installation instructions (PR2095) before undertaking this project.

## Appliance Information

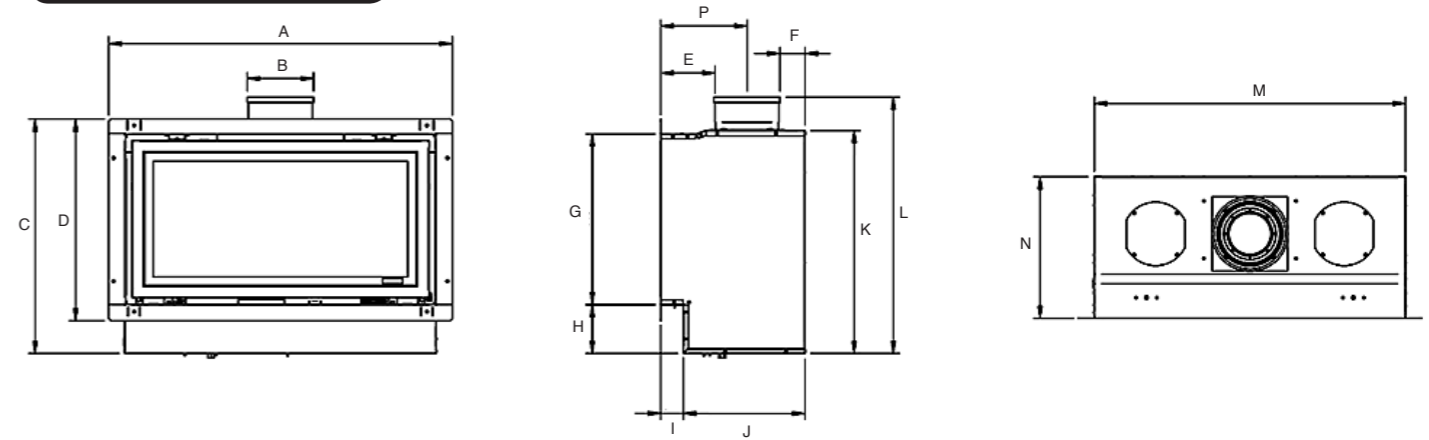

Model	A	B	C	D	E	F	G	H	I	J	K	L	M	N	P
Studio 1	820	153	571	491	127	60	416	119	54	291	543	624	745	345	203
Studio 2	1020	153	571	491	127	60	416	119	54	291	543	624	945	345	203
Studio 3	1410	153	571	491	127	60	416	119	54	291	543	624	1335	345	203

Technical Specifications		Studio 1	Studio 2	Studio 3
Studio NG with White Chippings		8700BFCHECNZ	8701BFCHECNZ	8702BFCHECNZ
Studio NG with Logs		8700BFLECNZ	8701BFLECNZ	8702BFLECNZ
Studio LPG with White Chippings		P8700BFCHECNZ	P8701BFCHECNZ	P8702BFCHECNZ
Studio LPG with Logs		P8700BFLECNZ	P8701BFLECNZ	N/A
Heat Output		5.2kW	6.97kW	7.3kW
Efficiency		81%	81%	81%
Gas Input Rate	Nat Gas	White Stone: 22.7 Mj/h Logs: 23.0 Mj/h	White Stone: 30.2 Mj/h Logs: 31.0 Mj/h	White Stone: 32.4 Mj/h Logs: 36.4 Mj/h
	LPG	White Stone: 22.0 Mj/h Logs: 22.7 Mj/h	White Stone: 26.3 Mj/h Logs: 28.8 Mj/h	N/A
Test Point Pressure		2kPa NG		2.75kPa LPG
Gas Inlet Connection		8mm		
Lining Options		Black Reeded, Vermiculite Lining, Enamel Black		
Frame Options		Edge Kit, Cool Wall Kit, Profil, Bauhaus, Steel, Glass, Verve, Expression		
Fuel Effect		Logs, White Chippings, Glass Beads (Black, Red, Clear)		
<b>Materials Required</b>				
Non-combustible Board		Villaboard, Promina, Promotec, Eterpan LD or Supalux and Plasterboard - see Main instructions for details		
Gazco Balanced Flue		Refer to installation instructions PR2095		
<b>Air Replacement</b>				
Cavity Ventilation Area (min)		Using Decorative Frame and Edge Kit 2 x 50mm <sup>2</sup>		Using Cool Wall with Edge Plus Kit 2 x 200mm <sup>2</sup> or equivalent

Distributed by



The Fireplace  
0800 843 347 | 0800 The Fire  
www.thefireplace.co.nz



PR2093

## Appliance Location & Framing Details

- The appliance can be installed in a timber frame out.
- The following details are the absolute minimum required based on using 90 x 45 framing.
- The following dimensions are based on wall finishing using Heat Resistant board that complies with the AS/NZS 2918:2001 definition - a list of recommended materials is provided, see PR2095 Page 14.

There are 3 methods of stud work installation:

- Decorative Frame** - Timber framing details for the Studio with a selected frame (refer fig 1 & 2).
- Edge** - Framing details for the Studio with additional Edge kit (without frame).
- Cool Wall** - Framing details for the Studio with the additional Cool Wall kit (with Edge Plus frame).

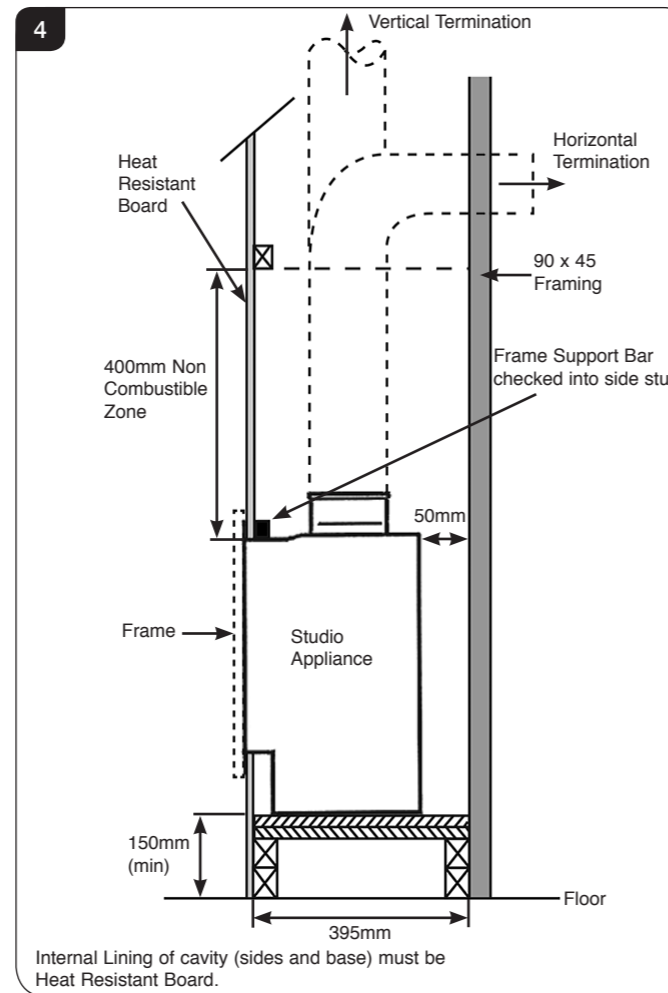
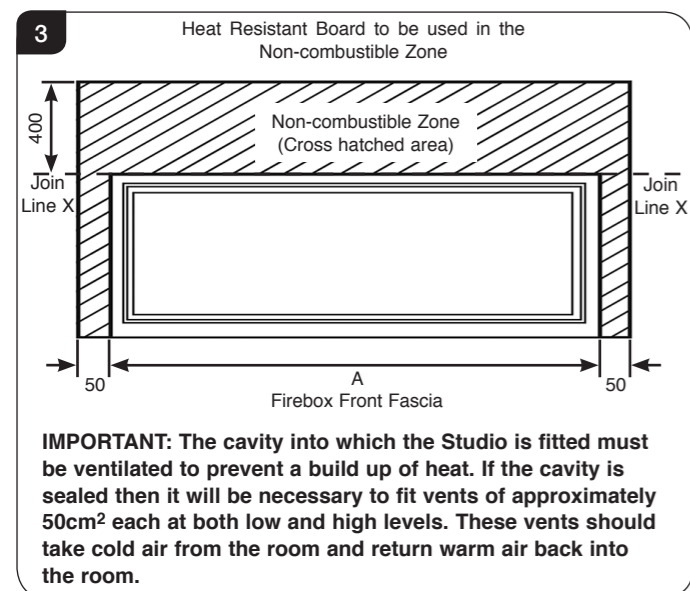
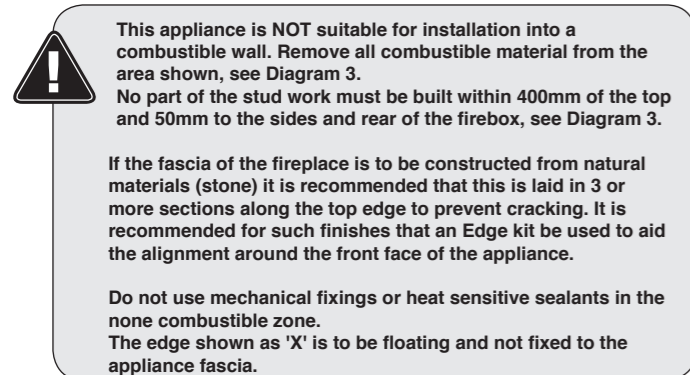
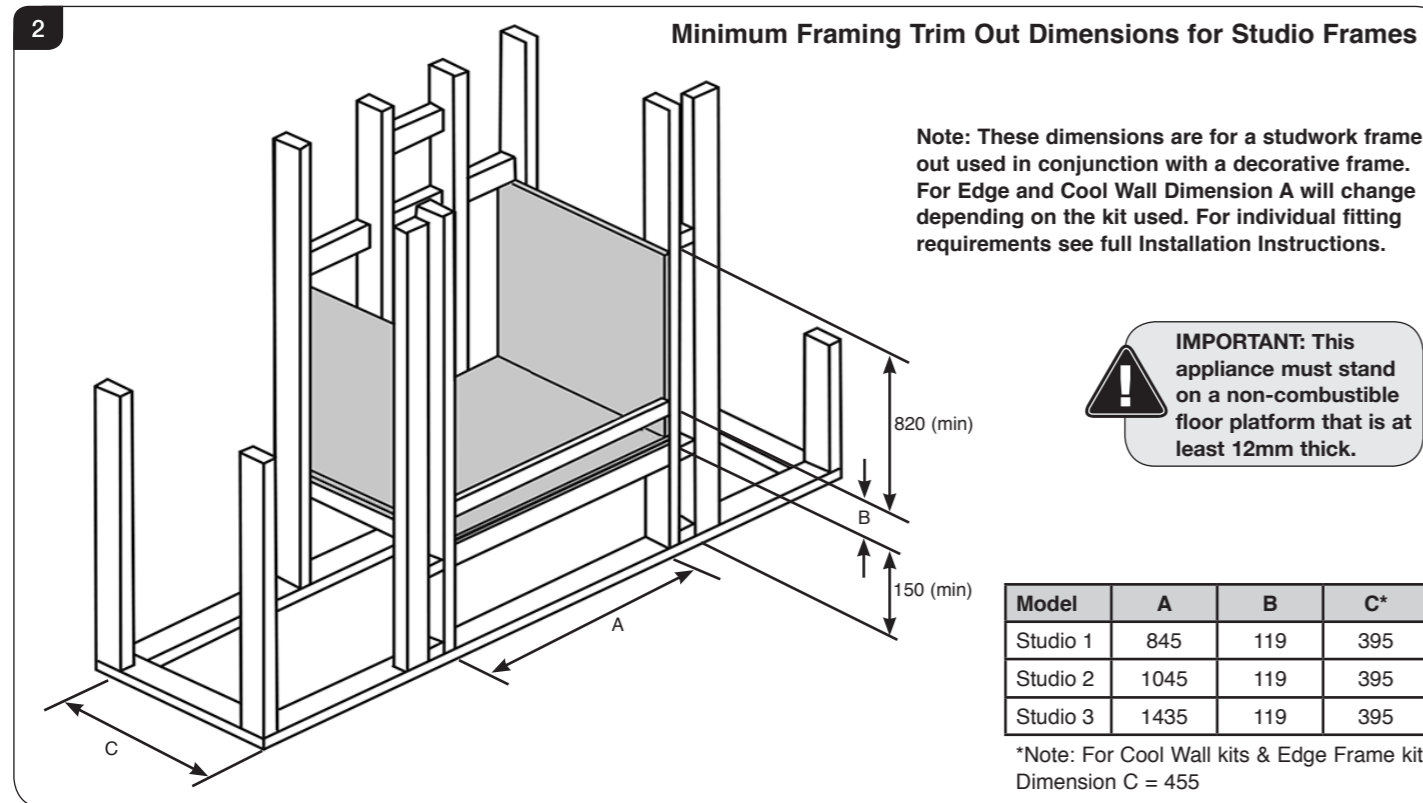

## Flue Options

### 2A. Top Flue Up and Out Kit

The basic kit comprises:

#### STUDIO 1 BF (Kit no. 8534)

- 1 x 200mm vertical length
- 1 x 500mm terminal length (cut to length on site)
- 1 x 90° elbow
- 1 x wall plate
- 1 x 70mm restrictor
- 1 x 60mm restrictor

Start of bend to centre line of horizontal flue 170mm. Centre line of vertical flue to end of bend 220mm. Vertical from the top of the appliance then horizontally out, see Diagram 5A.

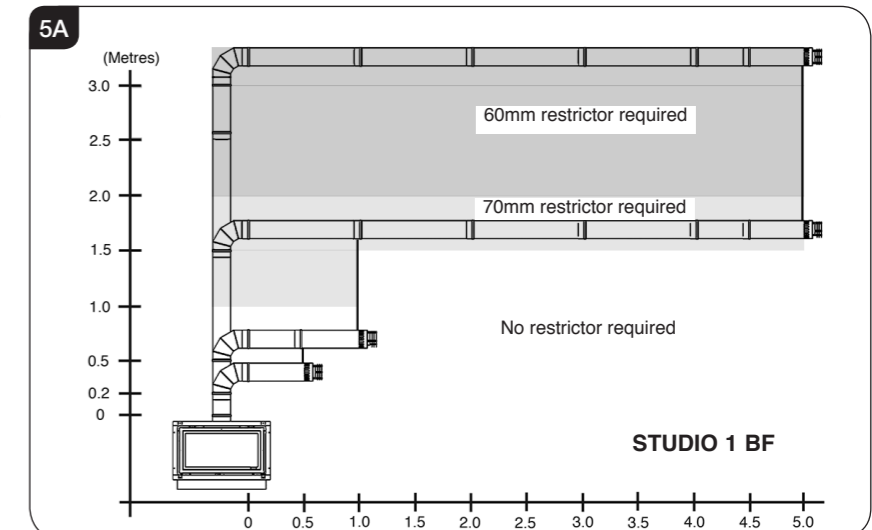

#### STUDIO 2 BF (Kit no. 8509)

- 1 x 200mm vertical length
- 1 x 500mm vertical length
- 1 x 500mm terminal length (cut to length on site)
- 1 x 90° elbow
- 1 x wall plate
- 1 x 75mm restrictor

The kit may be used on its own. (Note – STUDIO 1 BF with a 200mm rise only the 500mm terminal length can be used). Extra lengths may be added to the vertical and horizontal from the table, see PR2095 Page 12.

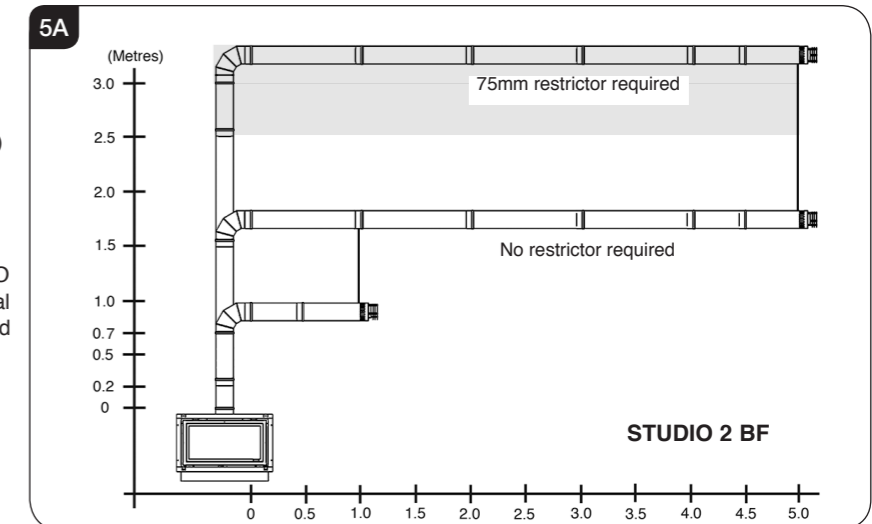

#### STUDIO 3 BF (Kit no. 8567)

- 1 x 1000mm vertical length
- 1 x 500mm terminal length (cut to length on site)
- 1 x 90° elbow
- 1 x wall plate

The kit may be used on its own. (Note – STUDIO 1 BF with a 200mm rise only the 500mm terminal length can be used). Extra lengths may be added to the vertical and horizontal from the table, see PR2095 Page 12.

