



Studio 22
Balanced Flue
**Instructions for Use,
Installation and Servicing**
For use in New Zealand (NZ)

IMPORTANT

THE OUTER CASING, FRONT AND GLASS PANEL BECOME EXTREMELY HOT DURING OPERATION AND WILL RESULT IN SERIOUS INJURY AND BURNS IF TOUCHED. IT IS THEREFORE RECOMMENDED THAT A FIREGUARD IS USED IN THE PRESENCE OF YOUNG CHILDREN, THE ELDERLY OR INFIRM.

This product contains a Heat resistant glass panel. This panel should be checked during Installation and at each servicing interval. If any damage is observed on the front face of the glass panel (scratches, scores, cracks or other surface defects), the glass panel must be replaced and the appliance must not be used until a replacement is installed. Under no circumstances should the appliance be used if any damage is observed, the glass panel is removed or broken.

These Instructions must be left with the appliance for future reference and for consultation when servicing the appliance. Please make the customer aware of the correct operation of the appliance before leaving these instructions with them.

The commissioning sheet found on Page 3 of this Instruction manual must be completed by the Installer prior to leaving the premises.

	PAGE
APPLIANCE COMMISSIONING CHECKLIST	3
USER INSTRUCTIONS	4
INSTALLATION INSTRUCTIONS	9
Technical Specifications	9
Site Requirements	12
Installation	17
Commissioning	27
SERVICING INSTRUCTIONS	28
Fault Finding	28
How to replace parts	30
Basic spare parts list	36
Service Records	37

APPLIANCE COMMISSIONING CHECKLIST

IMPORTANT NOTICE

Explain the operation of the appliance to the end user, hand the completed instructions to them for safe keeping, as the information will be required when making any guaranteed claims.

FLUE CHECK	PASS	FAIL
1. Flue is correct for appliance		
2. Flue flow test N/A		
3. Spillage test N/A		
GAS CHECK		
1. Gas soundness & let by test		
2. Standing pressure test	mb	
3. Appliance working pressure (on High Setting) NB All other gas appliances must be operating on full	mb	
4. Gas rate	m ³ /h	
5. Does ventilation meet appliance requirements	N/A	
SAFETY CHECK		
1. Glass checked to ensure no damage, scratches, scores or cracks.		
2. Glass frame secured correctly		

DEALER AND INSTALLER INFORMATION

Dealer

.....

.....

Contact No.

Date of Purchase

Model No.

Serial No.

Gas Type

Installation Company

.....

.....

Engineer

Contact No.

Gas Safe Reg No.

Date of Installation

Warranty

For purchases outside of the United Kingdom, Republic of Ireland, France, Belgium and the Netherlands, please consult your Gazco retailer for the warranty available in your region.

USER INSTRUCTIONS

1. GENERAL

In the event of a gas escape or if you can smell gas, please take the following steps:

- Immediately turn off the gas supply at the meter/emergency control valve
- Extinguish all sources of ignition
- Do not smoke
- Do not operate any electrical light or power switches (On or Off)
- Ventilate the building(s) by opening doors and windows
- Ensure access to the premises can be made

Please report the incident immediately to the National Gas Emergency Service Call Centre or your gas supplier.

The gas supply must not be used until remedial action has been taken to correct the defect and the installation has been recommissioned by a competent person.

- 1.1 Installation and servicing must only be carried out by a competent person.
- 1.2 In all correspondence, please quote the appliance type and serial number, which can be found on the data badge located on a plate attached to the lower slotted trim.
- 1.3 **Do not** place curtains above the fire:
You must have 300mm (1') clearance between the fire and any curtains at either side.
- 1.4 No furnishings or other objects should be placed within 1 metre of the front of the appliance.
- 1.5 If any cracks appear in the glass panel do not use the appliance until the panel has been replaced.
- 1.6 If, for any reason, the flue has to be removed from the appliance, the seals must be replaced in the inner spigot.
- 1.7 Do not obstruct the flue terminal in any way, i.e. by planting flowers, trees shrubs etc in the near vicinity, or by leaning objects up against the terminal guard.
- 1.8 Do not put any objects on the terminal guard; it will lose its shape.
- 1.9 Do not use a garden sprinkler, do not let quantities of water into the flue terminal.
- 1.10 In the unlikely event the appliance is receiving interference from other electronic devices, the handset/Control box can be reprogrammed. Please consult your dealer if you think this may be the case.
- 1.11 This product is guaranteed from the date of installation, as set out in the terms and conditions of sale between Gazco and your local Gazco retailer. Please consult with your local Gazco retailer if you have any questions. In all correspondence always quote the Model Number and Serial Number.

IMPORTANT : NEVER position an LCD/Plasma TV above this fire.

2. LIGHTING THE APPLIANCE

There are two ways of lighting the appliance:

- by thermostatic remote control, see 2A
- using the fire's touch pad, see 2B

2A - THERMOSTATIC and TIMER REMOTE CONTROL

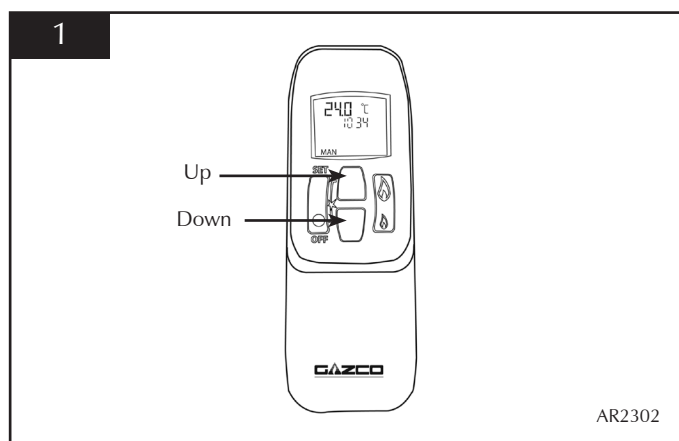

Turning the appliance On

Your remote can control the gas fire from pilot ignition through to shut down.

To turn the fire on:

- Press the OFF button and the UP button simultaneously. You hear several short signals.

The pilot and main burner ignite and the remote is now in Manual Mode:

IMPORTANT: YELLOW FLAMES TYPICALLY APPEAR WHEN THE APPLIANCE HAS REACHED NORMAL OPERATING TEMPERATURE. THIS CAN TAKE UP TO 30 MINUTES.

WARNING: IF THE APPLIANCE FAILS TO LIGHT OR BECOMES EXTINGUISHED IN USE, WAIT 3 MINUTES BEFORE ATTEMPTING TO RELIGHT.

In 'MANUAL MODE' you can:

- turn on the main burner using the UP button
- regulate the flame from high to low and back
- turn off the burner leaving just the pilot burning

In 'TEMP MODE' (Automatic) you can:

- set the room temperature so the thermostat in the remote automatically maintains that temperature

In 'TIMER MODE' (Automatic) the fire:

- turns on and off according to the set time periods
- automatically regulates the room temperature during the set periods

USER INSTRUCTIONS

NOTE: WHEN OPERATING THE FIRE IN TEMP OR TIMER MODE, THE PILOT REMAINS LIT AND THE FIRE THEN AUTOMATICALLY SWITCHES ON AT PROGRAMMED TIMES TO BRING THE ROOM TO THE SET TEMPERATURE WHETHER OR NOT YOU ARE IN THE ROOM.

NEVER LEAVE ANY COMBUSTIBLE MATERIALS WITHIN 1 METRE OF THE FRONT OF THE APPLIANCE.

2.1 SWITCHING BETWEEN MODES

- Press the SET button to change to Temperature Mode
- Press again to change to Timer Mode
- Keep pressing to run through all operating modes. These are:
 - MAN
 - DAY TEMP
 - NIGHT TEMP
 - TIMERand back to MAN

NOTE: MAN mode can also be reached by pressing either the UP or DOWN button

2.2 MAN MODE

- Press the OFF button and the UP button simultaneously. You hear several clicks and audible beeps as the fire begins the ignition process, (up to 30 seconds)

Turning the appliance Off

- Press the OFF button to turn the appliance off

FOR SAFETY, YOU MUST WAIT 30 SECONDS BEFORE LIGHTING THE FIRE AGAIN.

INCREASE FLAME HEIGHT

- Press the UP button once to increase flame height one stage. Press and hold the UP button to increase to maximum.

DECREASE FLAME HEIGHT

- Press the DOWN button once to decrease flame height one stage. Press and hold the DOWN button to decrease to minimum. At the lowest point the fire goes to 'Standby Mode' (Only Pilot lit).

NOTE: While pressing a button a symbol indicating transmission appears on the display. The receiver confirms transmission with a sound signal.

2.3 TEMP MODE (AUTOMATIC)

The display shows the current **room** temperature. To increase or decrease the fire's output:

- Press the SET button to select either the DAY TEMP or the NIGHT TEMP mode by briefly pressing the SET button
- Hold the SET button until the TEMP display flashes and then let go
- Set the desired temperature with the UP and DOWN arrows. (Minimum temperature 5C, maximum 40C or 40F to 99F when fahrenheit is the preferred option)
- Press the OFF button to stop the display flashing or wait to return to TEMP mode.

NOTE: If you set a temperature that is beneath the current room temperature, the fire automatically switches to PILOT (Stand by).

NOTE: If you would like the NIGHT temperature control to turn off then decrease the temperature until [--] is displayed.

2.4 TIMER MODE (AUTOMATIC)

There are two programmable settings you can make over a 24 hour period, P1 and P2. These are normally used to provide an early morning and evening setting for each working week:

- P1 + ● = Start Timed Setting 1
- P1 + ⤵ = End of Timed Setting 1
- P2 + ● = Start Timed Setting 2
- P2 + ⤵ = End of Timed Setting 2

2.4.1 P1 - Program 1 for a Timed Setting

- Press the SET button until the TIMER mode is displayed
- Hold the SET button. The display flashes the current time for P1. **While the time displayed is flashing you can alter the hours and minutes set.**

To set the time your fire first lights, change P1 ●

- Press the UP button to alter the hour
- Press the DOWN button to alter the minutes in 10 minute increments
- Press SET again to move to the end setting for P1 ⤵ This is the time your Studio first shuts down:
 - Press the UP button to alter the hour
 - Press the DOWN button to alter the minutes

2.4.2 P2 - Program 2 for a Timed Setting

Use the same steps outlined in 2.4.1 to change the setting for P2.

If you have already set P1 and want to alter the setting for P2 only:

- Press the SET button until TIMER mode is displayed
- Hold the SET button **until the display flashes the current time** for P1 ●
- Press the SET button once again to scroll past the settings for P1 ● and P1 ⤵

With the time **s t i l l** flashing:

- Press the UP button to alter the hour
- Press the DOWN button to alter the minutes

Once all four times are set press the OFF button.

2.4.3 To view existing settings:

- Select Timer Mode
- Press and briefly hold the SET button you see the start time for P1
- Repeat the above step for the start and end of each program.

2.5 LOW BATTERY

"BATT" is displayed on the remote when its batteries need replacement.

2.6 SETTING THE TIME

- Simultaneously press the up and down buttons
- Press the up button to set the hour and the down button to set the minutes
- Press OFF to return to the manual mode or simply wait

USER INSTRUCTIONS

2.7 SETTING THE °C/24 HOUR OR °F/12 HOUR CLOCK

- Press OFF and the down arrow until the display changes from °C/24 hour clock to °F/12 hour clock and vice versa.

If the remote is removed, lost or damaged, signals transmitted to the receiver cease. Your fire will go to standby (pilot) mode after 6 hours.

2B - TOUCH PAD CONTROL

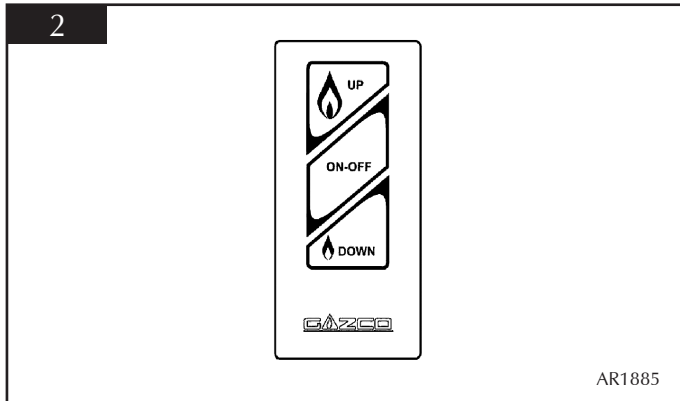

Press the ON-OFF button to light the appliance (up to 30 seconds). The UP button to increase the flame height.

Press the DOWN button to decrease the flame height. At the lowest point it goes to 'standby mode', (only pilot lit).

Press the ON-OFF button again to turn the appliance off

IMPORTANT: YELLOW FLAMES TYPICALLY APPEAR WHEN THE APPLIANCE HAS REACHED NORMAL OPERATING TEMPERATURE. THIS CAN TAKE UP TO 30 MINUTES.

WARNING: IF THE APPLIANCE FAILS TO LIGHT OR BECOMES EXTINGUISHED IN USE, WAIT 3 MINUTES BEFORE ATTEMPTING TO RELIGHT.

2C EMERGENCY SHUT OFF

If the batteries fail during use of the fire, move the switch to the OFF (O) position, Diagram 3
(This switch is set to be ON during normal operation and must remain ON)

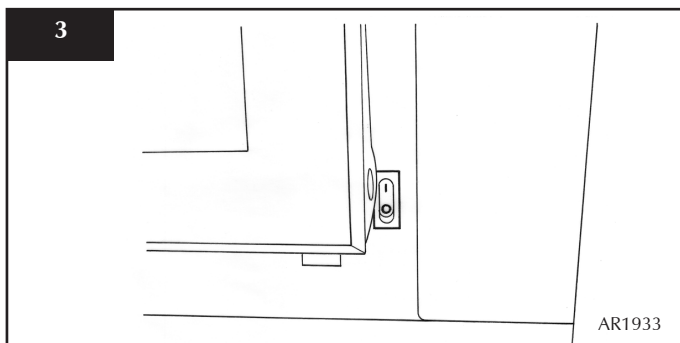

TAKE EXTREME CARE AS THE GLASS WILL BE VERY HOT.

3. CLEANING THE APPLIANCE

- 3.1 Make sure the fire and surrounds are cool before cleaning.
Use:

- A damp cloth for the painted frame
- Use soap and water to clean the glass

- 3.2 Opening the Glass Door

3.2.1 Steel Frame only

[If fitted with a Steel Frame, this needs to be removed first:

- Lift the frame upwards off its four support brackets, Diagram 4

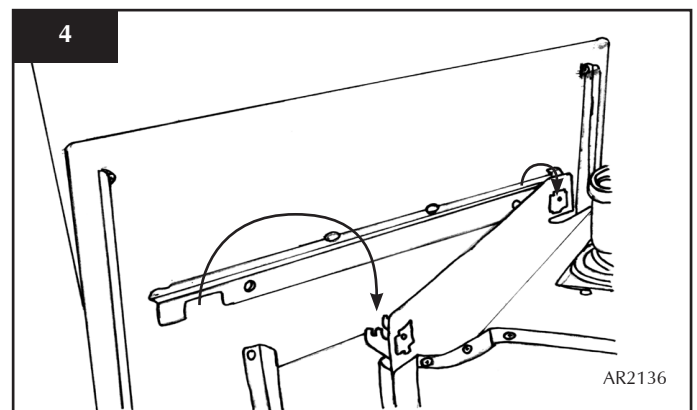

- 3.3 All models

Using the allen key provided to release the upper and lower catches on the right side of the door:

- Slide the allen key into the gap between the door and frame and locate the catch of the upper lock
- Push the allen key DOWN
- Slide the allen key into the gap and locate the lower lock
- Push the allen key UP

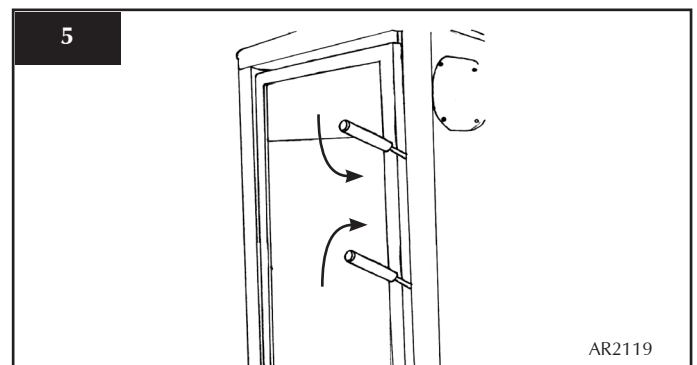

- Open the door outwards

When closing the door ensure the door catches are fully engaged.

UNDER NO CIRCUMSTANCES SHOULD THE APPLIANCE BE USED WITHOUT THE CATCHES HOLDING THE DOOR IN PLACE.

USER INSTRUCTIONS

4. CHANGING THE APPLIANCE BATTERIES

The appliance batteries are located behind the wall switch plate.

- 4.1 Undo the two screws securing the wall switch and plate and remove, Diagram 6

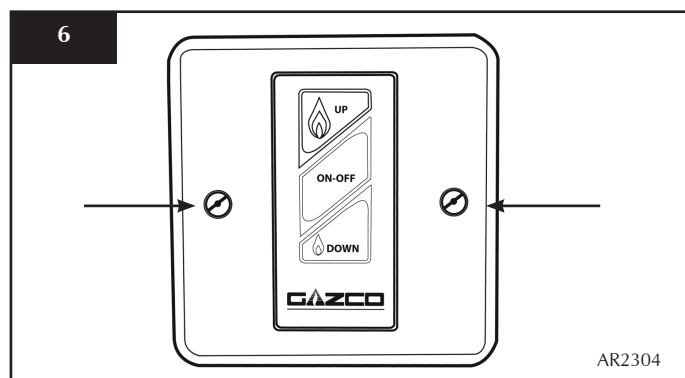

- 4.2 Unclip the battery holder from the wall switch and remove the old batteries.

- 4.3 Correctly position the four new AA size batteries into the battery holder. Re-assemble the battery holder as shown in Diagram 7

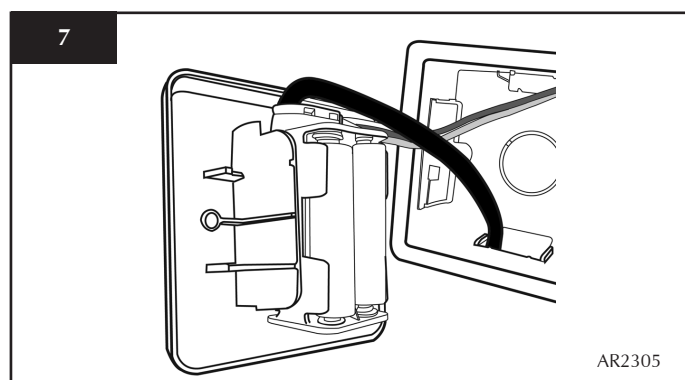

PLEASE ENSURE NO WIRES ARE TRAPPED BEFORE REPLACING THE WALL PLATE. THE TOUCH PAD LEAD IS EASILY DAMAGED.

5. ARRANGEMENT OF FUEL BED

ADVICE ON HANDLING AND DISPOSAL OF FIRE CERAMICS

The fuel effect in this appliance is made from Refractory Ceramic Fibre (RCF), a material which is commonly used for this application.

Protective clothing is not required when handling these articles, but we recommend you follow normal hygiene rules of not smoking, eating or drinking in the work area and always wash your hands before eating or drinking. To ensure that the release of RCF fibres are kept to a minimum, during installation and servicing a HEPA filtered vacuum is recommended to remove any dust accumulated in and around the appliance before and after working on it. When servicing the appliance it is recommended that the replaced items are not broken up, but are sealed within heavy duty polythene bags and labelled as RCF waste. RCF waste is classed as stable, non-reactive hazardous waste and may be disposed of at a licensed landfill site. Excessive exposure to these materials may cause temporary irritation to eyes, skin and respiratory tract; wash hands thoroughly after handling the material.

After cleaning the fire or replacing parts, carefully re-assemble the ceramic components. **WHEN THE EMBERS ARE PLACED ON THE BURNER IT IS IMPORTANT THEY DO NOT COVER ANY PORTS!**

The fuel bed is made up of embers and 6 logs, identifiable by moulded letters on their base:

- 5.1 Place the embers around the burner holes as shown in Diagram 8. **Do not cover any of the holes.**

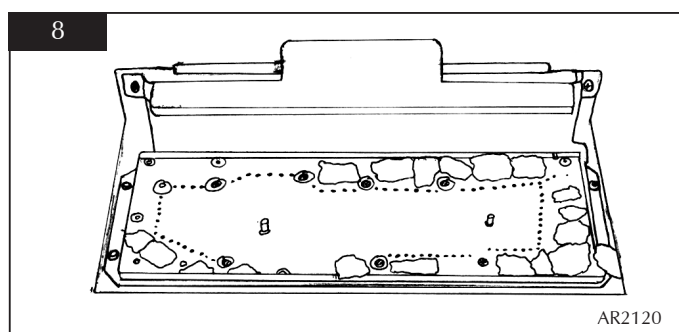

- 5.2 Place Log C onto the two studs on the burner skin, Diagram 9, with charred effect of the log facing forward.



USER INSTRUCTIONS

- 5.3 Place Log A on the ledge at the rear of the fire, Diagram 10.

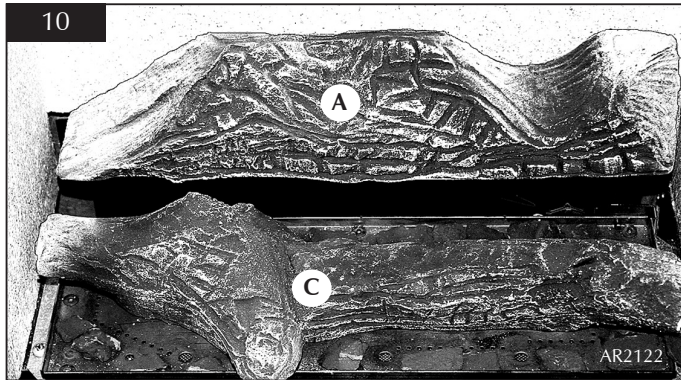

- 5.4 Place Log D so that the back end sits in the groove in the rear of Log A and the front left rests in the cut-out groove in Log C, Diagram 11.

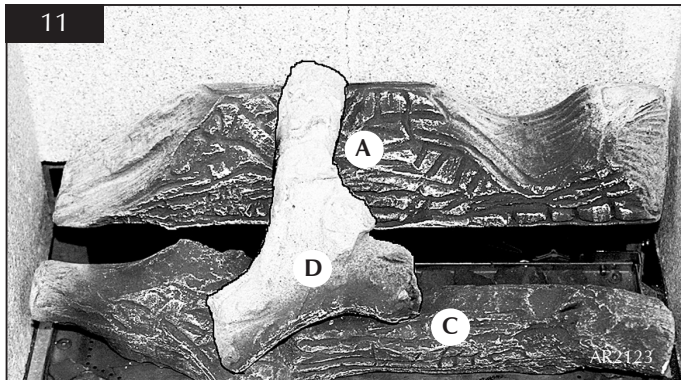

- 5.5 Position Log B so that the underneath rests in the groove of Log C, and the triangular groove in the base of Log C fits into the corner of the burner, Diagram 12.



- 5.6 Put the groove in the base of Log E into the indent on the right of Log C. The left branch rests on the upper end of Log A, Diagram 13.

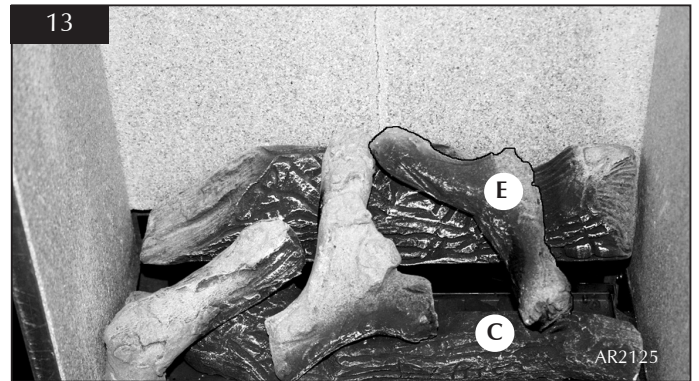

- 5.7 Log F rests against Log C at its far right end, between Log A and the side panel. The front end of Log F sits on the front panel, see Diagram 14



You must ensure the door catches are fully engaged:

- Slide the allen key into the gap between the door and frame and locate the catch of the lower lock
- Push the allen key DOWN
- Slide the allen key into the gap and locate the upper lock
- Push the allen key UP

USER INSTRUCTIONS

6. FLAME FAILURE DEVICE

- 6.1 This is a safety feature incorporated on this appliance which automatically switches off the gas supply if the pilot goes out and fails to heat the thermocouple.

IF THIS OCCURS DO NOT ATTEMPT TO RELIGHT THE APPLIANCE FOR 3 MINUTES.

7. RUNNING IN

- 7.1 During initial use of a new GAZCO appliance a strong odour will be encountered as various surface coatings become hot for the first time. Although these odours are harmless it is recommended that the appliance is operated on maximum for 4 to 8 hours in order to fully burn off these coatings. After this period the odours should then disappear.

If the odours persists, please contact your installer for advice.

- 7.2 During the first few hours of burning there may be discolouration of the flames. This will also disappear after a short period of use.

8. SERVICING

- 8.1 The fire must be serviced every 12 months by a qualified Gas Engineer. In all correspondence always quote the Model number and the Serial number which may be found on the data badge.

9. VENTILATION

- 9.1 Any purpose provided ventilation should be checked periodically to ensure that it is free from obstruction.

10. INSTALLATION DETAILS

- 10.1 Your installer should have completed the commissioning sheet at the front of this book. This records the essential installation details of the appliance. In all correspondence always quote the Model number and Serial number.

11. HOT SURFACES

- 11.1 Parts of this appliance become hot during normal use.
- Regard all parts of the appliance as a 'working surface'
 - Provide a suitable fire guard to protect young children and the infirm

12. FIRE WILL NOT LIGHT

- 12.1 If you cannot light the Studio:

- Check that the emergency shut off switch is in the ON (1) position, see *Section 2C, Emergency Shut Off*
- Check and change the batteries in the remote handset
- Check and change the appliance batteries, *Section 4*.

Consult your Gazco dealer if the Studio still does not light.

INSTALLATION INSTRUCTIONS

TECHNICAL SPECIFICATION

COVERING THE FOLLOWING MODELS:

STUDIO 22 BF: 8704BFLECNZ P8704BFLECNZ

Model	Gas CAT.	Gas Type	Working Pressure	Nox Class	Aeration	Injector	Gas Rate m ³ /h	Input kW (Gross)		Country
								High	Low	
8704BFLECNZ	I _{2H}	Natural Gas (G20)	20 mbar	4	5 x 16 mm	530	0.715	7.5	3.75	NZ
P8704BFLECNZ	I _{3B/P}	Butane (G30)	29 mbar	4	16 x 23 (2)	200	0.200	7	3.6	NZ
		Propane (G31)								
REAR EXIT WALL THICKNESS			Min 200 mm - Max 550 mm							
Efficiency Class II										
Flue Outlet Size Ø 150mm										
Flue Inlet Size Ø 100mm										
Gas Inlet Connection Size Ø 8mm										

RESTRICTOR REQUIREMENT		
VERTICAL & HORIZONTAL FLUE SPECIFICATIONS		
Vertical Flue Height from Top of Appliance	Horizontal Length	Restrictor Size
200 mm	500 mm	No restrictor
500 mm	1000 mm	No restrictor
1000 mm to 1500 mm	250 mm to 5000 mm	Ø 70 mm
1510 mm to 3000	250 mm to 5000 mm	Ø 60 mm
TOP EXIT - VERTICAL INCLUDING OFFSET		
Vertical Flue Height from Top of Appliance	Restrictor Size	
3000 mm up to 4990 mm	Ø 52 mm	
5000 mm up to 10,000 mm	Ø 47 mm	

SPECIFIC INFORMATION FOR NEW ZEALAND		
	Studio 22	Studio 22
Gas Type	Natural Gas	General Products LPG
Test Point Pressure	2kPa	2.75kPa
Gas Input Rate	27mj/h	25.2mj/h
Max Supply Pressure	6kPa with external regulator	3.5kPa
Design Standard	EN613:2001	
Installation	This appliance must be installed in accordance with NZS 5261:2003, the National Standard covering the Installation of gas appliances.	

INSTALLATION INSTRUCTIONS

TECHNICAL SPECIFICATION

This appliance has been certified for use in countries other than those stated. To install this appliance in these countries, it is essential to obtain the translated instructions and in some cases the appliance will require modification. Contact Gazco for further information.

PACKING CHECKLIST

Qty Description	Fixing Kit containing:-
1 Log Set	1 x Instruction Manual 4 x Wood Screws 4 x Rawl Plugs 1 x Handset 4 x AA cell batteries 1 x 9V cell batteries 1 x Wall box 1 x Touch pad/wall plate 1 x Battery holder 1 x Foam seal

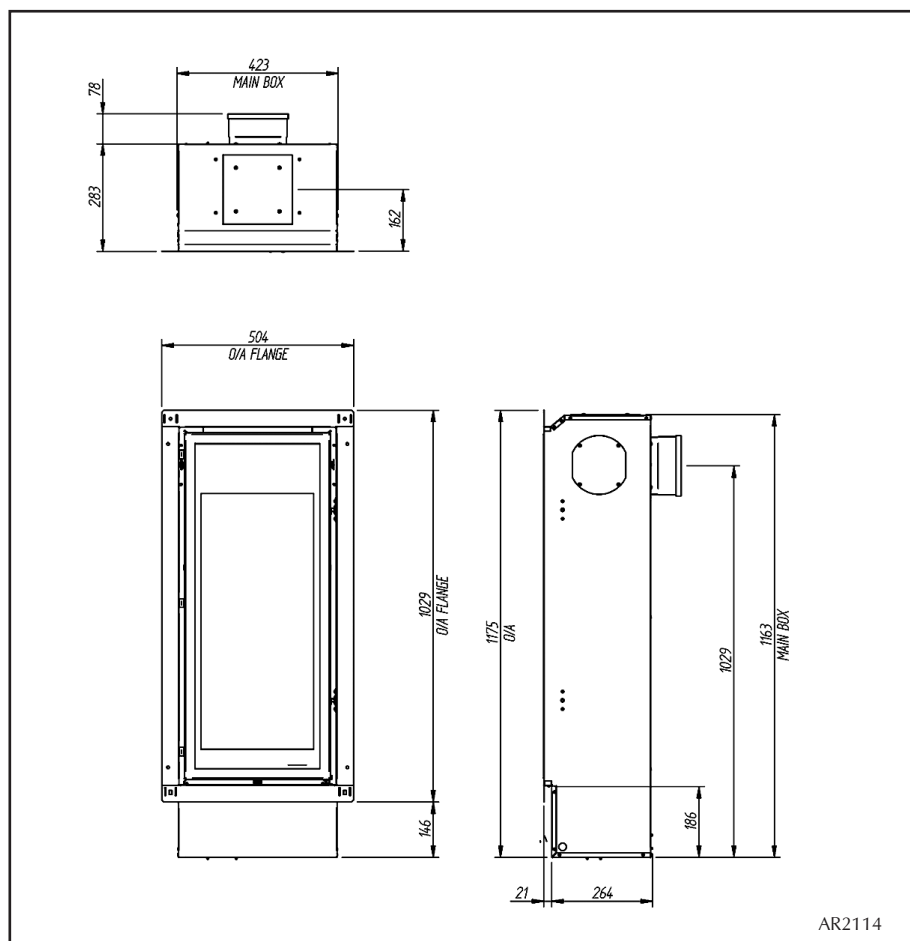

INSTALLATION INSTRUCTIONS

TECHNICAL SPECIFICATION

Steel Frame Dimensions	
Dimension:	Size (mm)
A	1350
B	675
C	846
D	320
E	177
F	237
G	25

Profil Frame Dimensions	
Dimension:	Size (mm)
A	1036
B	510
C	940
D	414
E	48
F	48
G	12.5

Bauhaus Frame Dimensions	
Dimension:	Size (mm)
A	1050
B	524
C	940
D	414
E	55
F	55
G	28

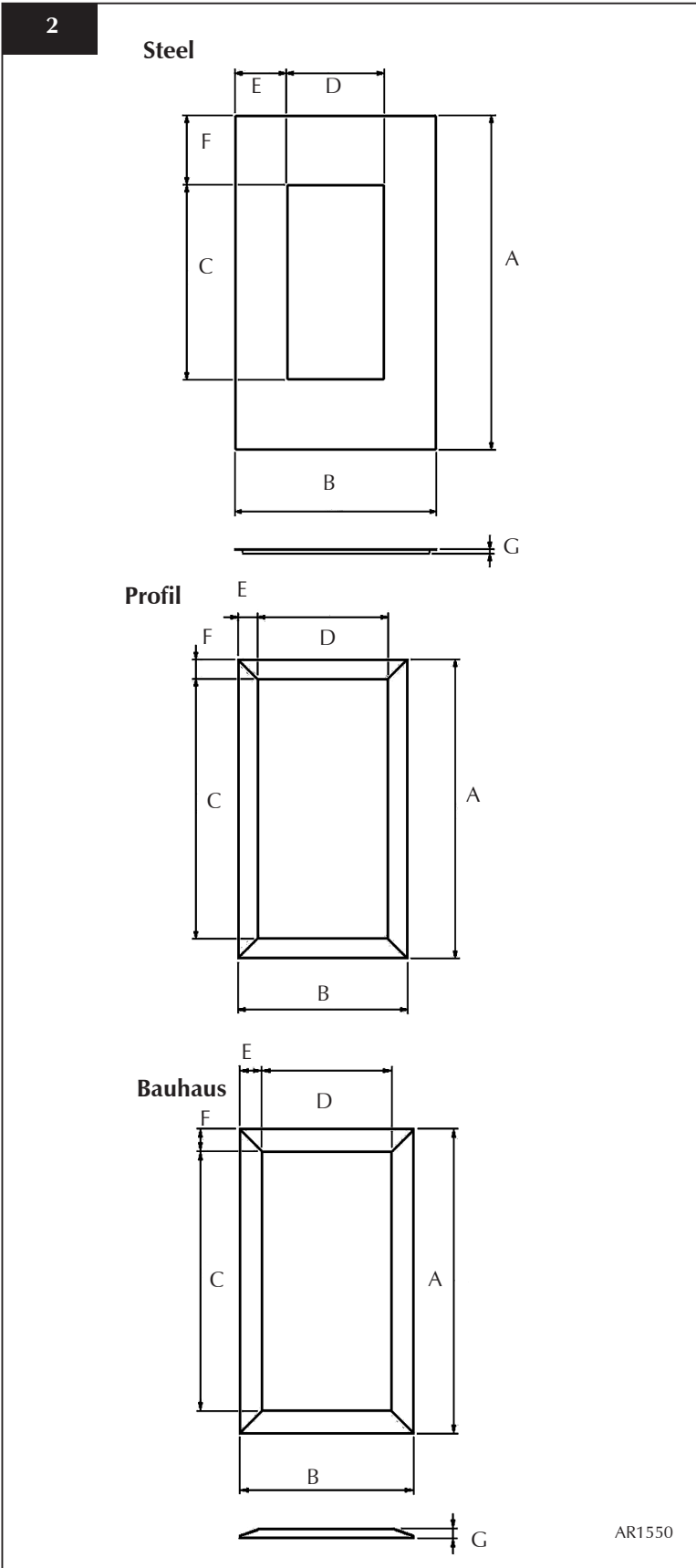

INSTALLATION INSTRUCTIONS

SITE REQUIREMENTS

1. FLUE AND CHIMNEY REQUIREMENTS

Note: This appliance must only be installed with the flue supplied.

You must adhere to the following:

- 1.1 The flue must be sited in accordance with the rules in force and comply with all local and National regulations. See Diagram 1.
- 1.2 Fit a guard to protect people from any terminal less than 2 metres above any access such as level ground, a balcony or above a flat roof.
- 1.3 All vertical and horizontal flues must be securely fixed and fire precautions followed in accordance with local and national codes of practice.
- 1.4 A restrictor may be required. Refer to Technical Specifications on page 10.

- 1.5 Three types of flue termination are possible, rear, top exit horizontal and top exit vertical. To measure for a top exit horizontal terminal:

- Decide on the terminal position
- Measure the height from the top of the appliance to the centre of the required outlet.

For minimum and maximum flue dimensions see *Section 2, Flue Options*.

- Allow enough room either above or to the side of the appliance to assemble the flue on top
- Assemble a horizontal flue in the following order:
 - Vertical section
 - 90° elbow
 - Horizontal plus terminal
- Support the opening of a masonry installation with a lintel.

- 1.7 Only the horizontal terminal section can be reduced in size.

1

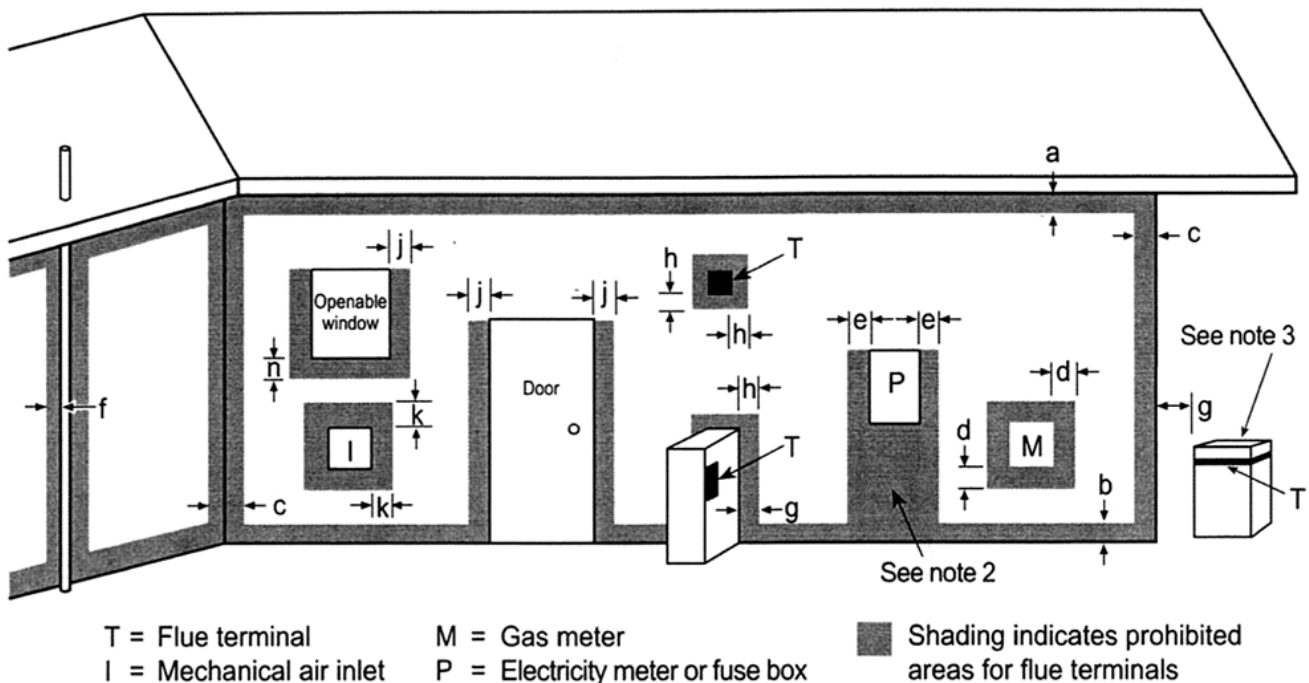

INSTALLATION INSTRUCTIONS

SITE REQUIREMENTS

Minimum clearances required for the flue terminals showing in Diagram 1 on page 12

Ref.	Item	Minimum clearances (mm)	
		Natural Draught	Fan Assisted
a	Below eaves, balconies and other projections:		
	Gas appliances up to 50 MJ/h input	300	200
	Gas appliances over 50 MJ/h input	500	300
b	From the ground, above a balcony or other surface (see Note 6)	300	300
c	From a return wall or external corner (see Note 6)	500	300
d	From a gas meter (M) (see 2.5.4.9 for vent terminal location of regulator)	1000	1000
e	From an electricity meter or fuse box (P)	500	500
f	From a drain pipe or soil pipe	150	75
g	Horizontally from any building structure (see Note 6) or obstruction facing a terminal	500	500
h	From any other flue terminal, cowl, or combustion air intake (see Note 6)	500	300
j	Horizontally from an openable window, door, non-mechanical air inlet, or any other opening into a building with the exception of sub-floor ventilation:		
	Gas appliances up to 150 MJ/h input	500	300
	Gas appliances over 150 MJ/h input to 200 MJ/h input	1500	500
	Gas appliances over 200 MJ/h input	1500	1500
	All fan-assisted flue gas appliances in the direction of discharge		1500
k	From a mechanical air inlet, including a spa blower	1500	1000
n	Vertically below an openable window, non-mechanical air inlet or any other opening into a building with the exception of sub-floor ventilation:		
	Space heaters up to 50 MJ/h input	150	150
	Other gas appliances up to 50 MJ/h input	500	500
	Gas appliances over 50 MJ/h input and up to 150 MJ/h input	1000	1000
	Gas appliances over 150 MJ/h input	1500	1500

NOTE:

- (1) All distances are measured to the nearest part of the flue terminal.
- (2) Prohibited area below electricity meter or fuse box extends to ground level.
- (3) See NZS5261 for restrictions on a flue terminal under a covered area.
- (4) See NZS5261 for clearances required from a flue terminal to an LPG cylinder. A flue terminal is considered to be a source of ignition.
- (5) For gas appliances not addressed above, the design shall be certified by a suitably qualified engineer.

INSTALLATION INSTRUCTIONS

SITE REQUIREMENTS

2. FLUE OPTIONS

REAR EXIT (8708)

- Cut to length as required on site

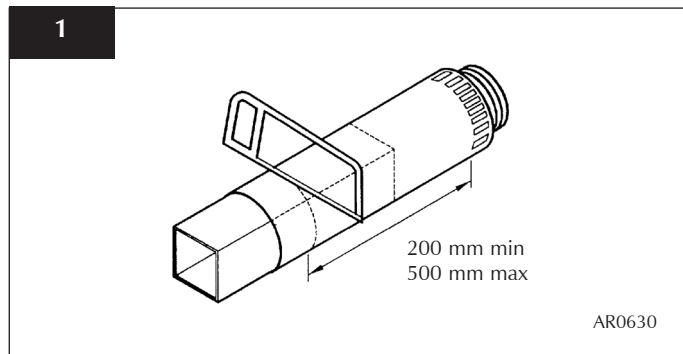

Guard Supplied.

TOP EXITS

2.1 TOP FLUE UP & OUT KIT (8534)

This flue is vertical from the top of the appliance then horizontally out. (See Diagram 2). The basic kit comprises:

1 x 200mm vertical length

1 x 500mm terminal length (cut to length on site)

1 x 90° elbow

1 x wall plate

1 x 70mm restrictor

1 x 60mm restrictor

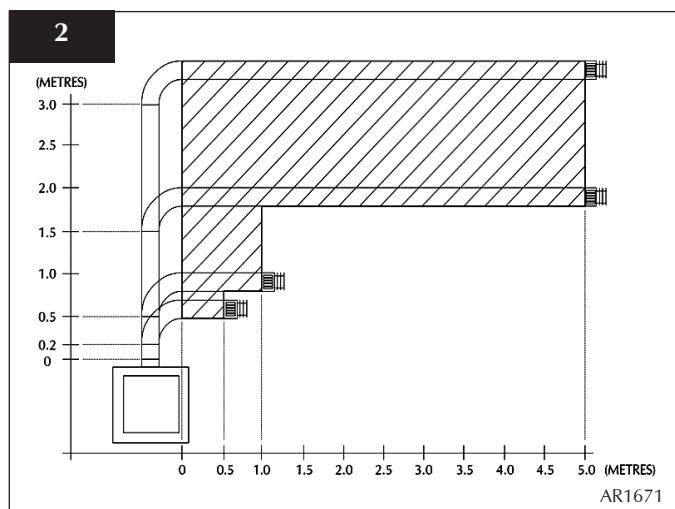

NOTE:

The start of the bend to the centre line of horizontal flue is 170mm.

The centre line of vertical flue to end of bend is 220mm.

2.2 TOP FLUE UP & OUT WITH ADDITIONAL BEND

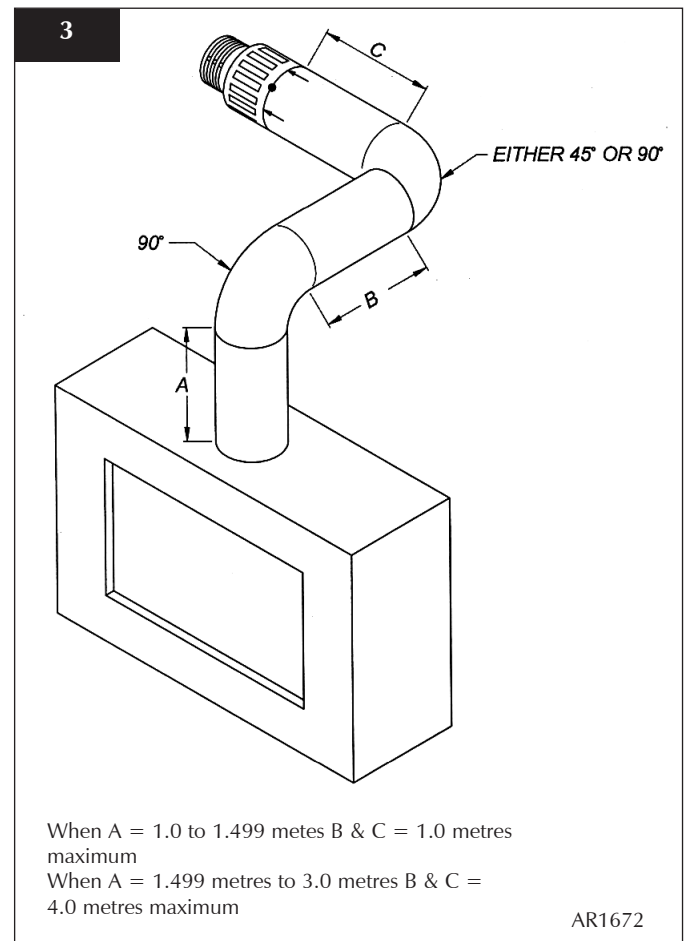

Any additional bend may be used on the horizontal section (either 45° or 90°), but the overall horizontal flue run will be reduced. Refer to Diagram 3.

INSTALLATION INSTRUCTIONS

SITE REQUIREMENTS

2.3 TOP FLUE VERTICAL KIT (8524/8524AN)

Vertical from the top of the appliance (See Diagram 4).

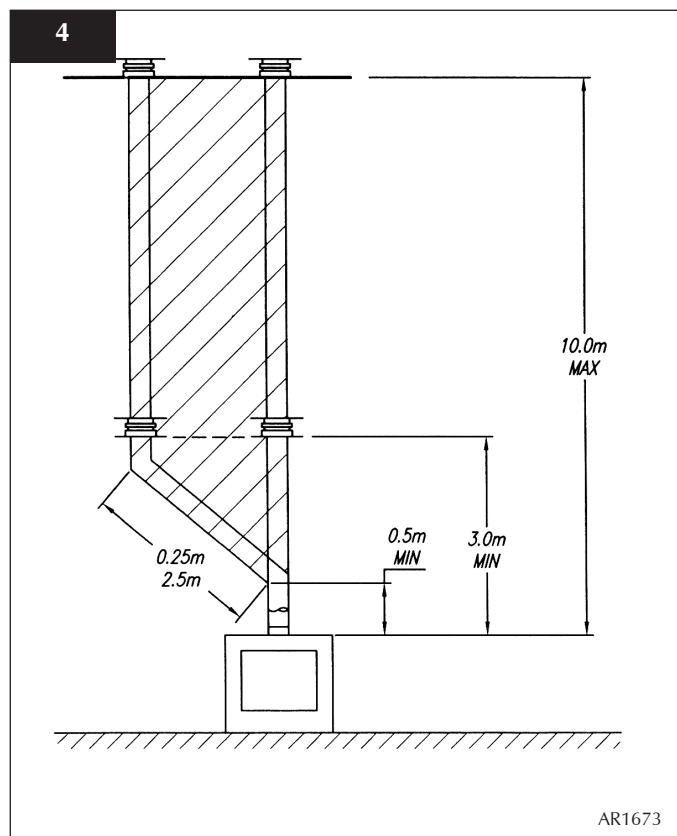

A minimum vertical rise 3m (9'10") to a maximum 10m (32'10"). The basic kit comprises:

- 2 x 1m lengths
- 1 x 1m terminal length
- 1 x 52mm restrictor
- 1 x 47mm restrictor
- 1 x 60mm restrictor

Extra lengths may be added from the list below.

2.4 TOP FLUE VERTICAL OFFSET KIT (8530/8530AN)

Used with kit 8524. A minimum rise of 500mm (19 1/2") is required to the first bend. See Diagram 1C.

2.5 EXTRA FLUE LENGTHS

All flue components are 150mm diameter (6")

NOMINAL LENGTH	ACTUAL LENGTH	STAINLESS FINISH	ANTHRACITE FINISH
200mm	140mm	8527	8527AN
500mm	440mm	8528	8528AN
1000mm	940mm	8529	8529AN
40° Bend	N/A	8507	8507AN
90° Bend	N/A	8508	8508AN

NOTE: Carefully consider:

- a) **Terminal positions**
- b) **Flue supports**
- c) **Weatherproofing**
- d) **Fire precautions**

For all the above options, you must conform to local and national codes of practice .

3. GAS SUPPLY

IMPORTANT: ALL NATURAL GAS FIRE INSTALLATIONS IN NEW ZEALAND MUST HAVE A REGULATOR FITTED UPSTREAM FROM THE APPLIANCE. THE REGULATOR MUST BE FITTED IN A SUITABLE LOCATION FOR SERVICING.

- 3.1 Before installation, ensure that the local distribution conditions (identification of the type of gas and pressure) and the adjustment of the appliance are compatible.
- 3.2 Ensure the gas supply delivers the required amount of gas and is in accordance with the rules in force.
- 3.3 You can use soft copper tubing on the installation and soft soldered joints outside the appliance and below the fire.
- 3.4 A factory fitted isolation device is part of the inlet connection; no further isolation device is required.
- 3.5 All supply gas pipes must be purged of any debris that may have entered prior to connection to the appliance.
- 3.6 The gas supply enters through the silicone panel located on the bottom or rear of the outer box:
 - Slit with a sharp knife prior to passing the supply pipe through.
- 3.7 The gas supply must be installed in a way that does not restrict the removal of the appliance for servicing and inspection.

4. VENTILATION

- 4.1 This appliance requires no additional ventilation.

INSTALLATION INSTRUCTIONS

SITE REQUIREMENTS

5. APPLIANCE LOCATION

5.1 Please note this appliance has been specifically designed for studwork applications although installation into other constructions, including masonry, is entirely feasible. **There are two methods of installation, see *Installation Instructions* 3.2 Frame, 3.3 Edge**

5.2 This appliance must stand on a non-combustible hearth/platform that is at least 12mm thick.

NOTE: It is recommended you construct the back panel of the fireplace from natural materials cut into three or more sections to prevent cracking. Resin-based materials may not be suitable. This appliance is an effective heat producer and attention must be paid to the construction and finish of the fireplace.

5.3 A combustible shelf must be:

- maximum 150mm in depth
- minimum, 400mm high above the fire

A combustible side wall must be a minimum of 150mm from the appliance.

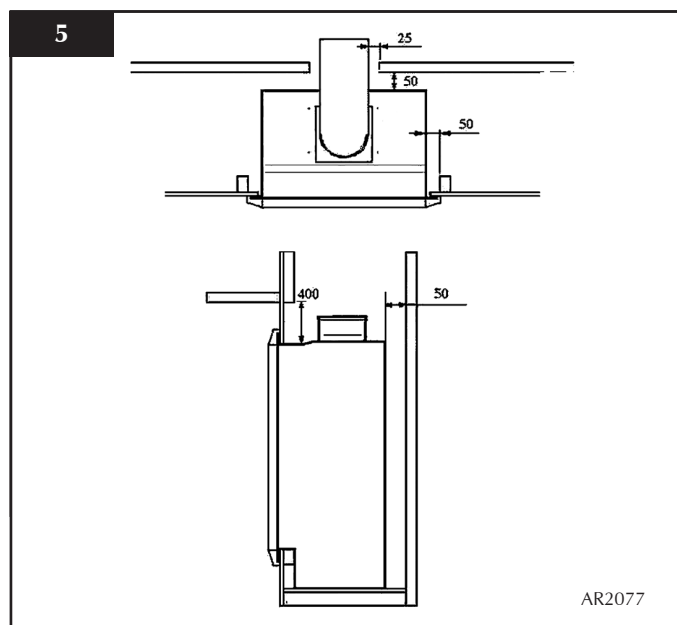

INSTALLATION INSTRUCTIONS

INSTALLATION

IMPORTANT: REFER TO DATA BADGE AND TECHNICAL SPECIFICATION AT THE FRONT OF THE MANUAL TO ENSURE THE APPLIANCE IS CORRECTLY ADJUSTED FOR THE GAS TYPE AND CATEGORY APPLICABLE IN THE COUNTRY OF USE.
FOR DETAILS OF CHANGING BETWEEN GAS TYPES REFER TO **SECTION 10, 'SERVICING, 'REPLACING PARTS'.**

1. SAFETY PRECAUTIONS

- 1.1 For your own and other's safety, you must install this fire according to local and national codes of practice. Failure to install the fire correctly could lead to prosecution:
 - Read these instructions before installing and using this fire.
- 1.2 These instructions must be left intact with the user.
- 1.3 Do not attempt to burn rubbish on this appliance.
- 1.4 Keep all plastic bags away from young children.
- 1.5 Do not place any object on or near to the appliance and allow adequate clearance above the appliance.
IF THE APPLIANCE IS EXTINGUISHED OR GOES OUT IN USE, WAIT 3 MINUTES BEFORE ATTEMPTING TO RELIGHT THE APPLIANCE.

2. INSTALLATION OF THE APPLIANCE

REFER TO THE SITE REQUIREMENTS SECTION FOR ALL FLUE OPTIONS.

This stove is suitable for top or rear flue exit.

- For top exit, read **Section 8.2**
- For rear flue exit, read **Section 8.1**

THERE IS AN OPTIONAL DUCT KIT, CODE No. 8572 WHICH CAN BE FITTED AT THE SAME TIME AS THE APPLIANCE INSTALLATION.

- 2.1
 - Remove the appliance from the carton and discard all unnecessary packaging
 - Ensure no components are thrown away when unpacking
- 2.2 To open the glass door, use the allen key provided:
 - Slide the allen key into the gap between the door and frame and locate the catch of the upper lock
 - Push the allen key DOWN
 - Slide the allen key into the gap and locate the lower lock
 - Push the allen key UP

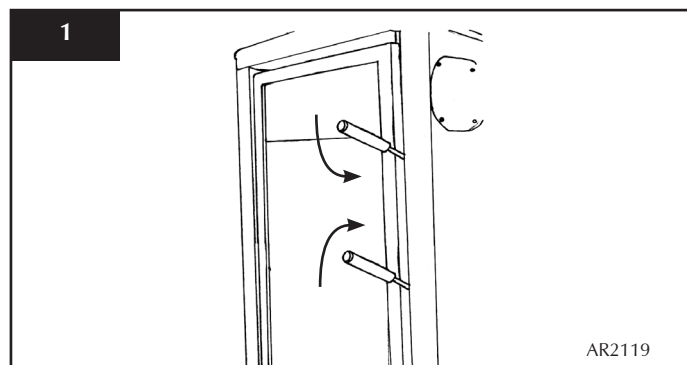

- Open the door outwards

- 2.3 The gas supply enters the fire through a silicon panel on the floor or in the back panel of the fire, underneath the control unit, Diagram 2

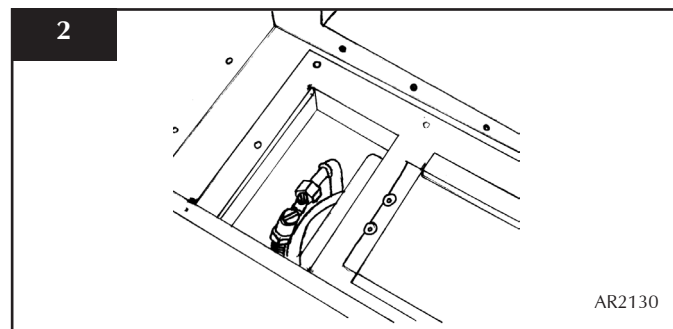

- 2.4 To access the gas pipe:
 - Undo the clips on the upper inside holding the vermiculite side panels in place, Diagram 3

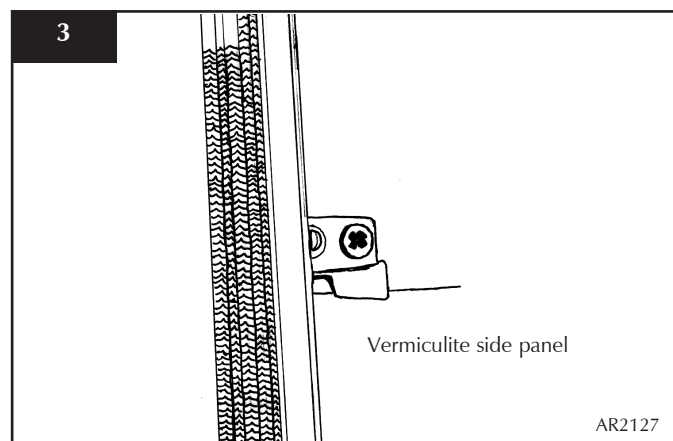

- Remove the two side panels and back panel and put to one side
- Ensure the back panel is supported when removing the side panels

TAKE CARE WHEN HANDLING THE VERMICULITE PANELS, THEY ARE FRAGILE.

- 2.5 You can now remove the burner:

- Undo the four screws holding the burner tray in place
- Remove the burner
- Lift the left-hand side up and out

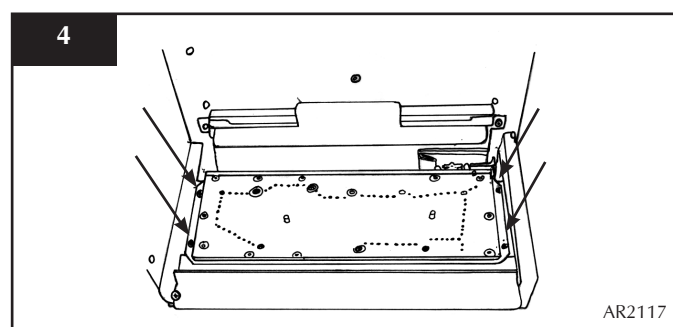

INSTALLATION INSTRUCTIONS

INSTALLATION

- 2.6 • Undo the two screws in the rear air baffle to remove it, Diagram 5, arrow A

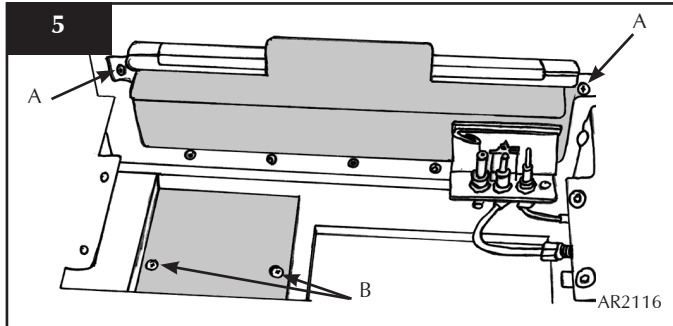

- Remove the two screws holding the access panel in place, Diagram 5, arrow B

- 2.7 • Undo the 13 screws fixing the control unit in place

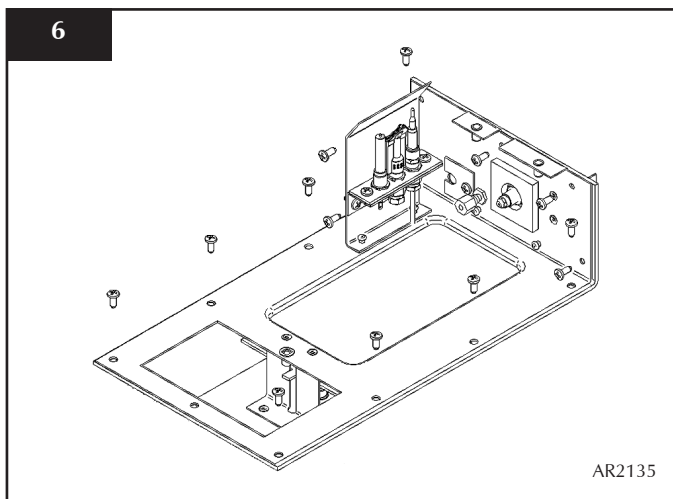

With all screws removed:

- Slide the control unit to the left to clear the injector and pilot pipework at the right side
- Lift the right-hand side up and out

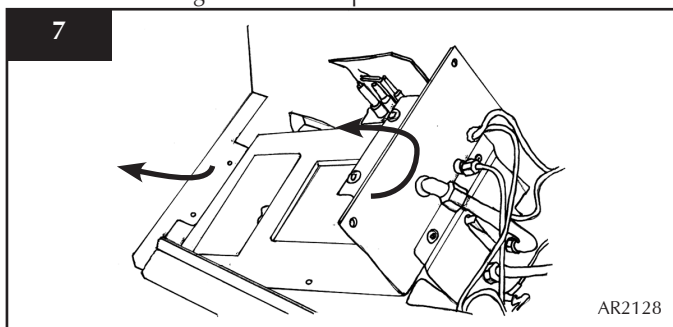

3. STUD WORK INSTALLATION

THERE ARE THREE TYPES OF INSTALLATION INTO STUDWORK DESCRIBED IN THE FOLLOWING PAGES:

- 1) FOR STUDIO 22 WITH EITHER THE STEEL, PROFIL OR BAUHAUS FRAME, SEE SECTION 4
- 2) FOR AN INSTALLATION WHERE THE STUDIO 22 SITS FLUSH TO THE FINISHED 'EDGE' OF THE WALL, SEE SECTION 5
- 3) FOR A FURTHER 'EDGE' INSTALLATION PROVIDING A COOL WALL ABOVE THE APPLIANCE TO ALLOW CUSTOMERS TO HANG PICTURES ETC., SEE SECTION 6

- 3.1 **DISTANCE TO COMBUSTIBLE MATERIAL**
COMBUSTIBLE PARTS OF THE STUDWORK MUST BE KEPT BEYOND THE MINIMUM DIMENSIONS SHOWN IN DIAGRAM 8. EVEN IF THE FRAMEWORK IS PROTECTED BY NON-COMBUSTIBLE MATERIAL, YOU MUST MAINTAIN THESE DIMENSIONS.

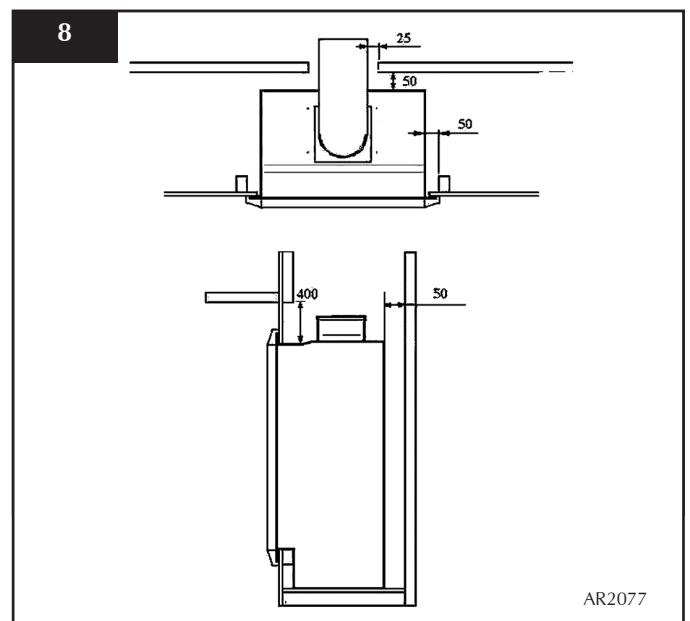

- 3.2 DO NOT PACK THE VOID AROUND OR ABOVE THE APPLIANCE WITH INSULATION MATERIALS SUCH AS MINERAL WOOL.
- 3.3 THE VOID BUILT FOR THE APPLIANCE MUST BE VENTILATED TO PREVENT A BUILD-UP OF HEAT. IF THE VOID IS SEALED, THEN YOU MUST FIT VENTS AT BOTH LOW AND HIGH LEVELS OF APPROXIMATELY 50CM² EACH. THESE VENTS MUST TAKE COLD AIR FROM THE ROOM AND RETURN WARM AIR BACK INTO THE ROOM
- 3.4 AN ACCESS HATCH MUST BE LEFT IN THE SIDE OF THE CHIMNEY BREAST FOR FUTURE SERVICING AND INSPECTION OF THE FLUE AND APPLIANCE.

INSTALLATION INSTRUCTIONS

INSTALLATION

4. STUDWORK INSTALLATION FOR STUDIO WITH FRAMES

- Build the studwork chimney breast and enclosures to the desired size to include the protected platform at the required height.
- Line the aperture for the appliance with 12mm thick non-combustible material as shown, Diagram 9

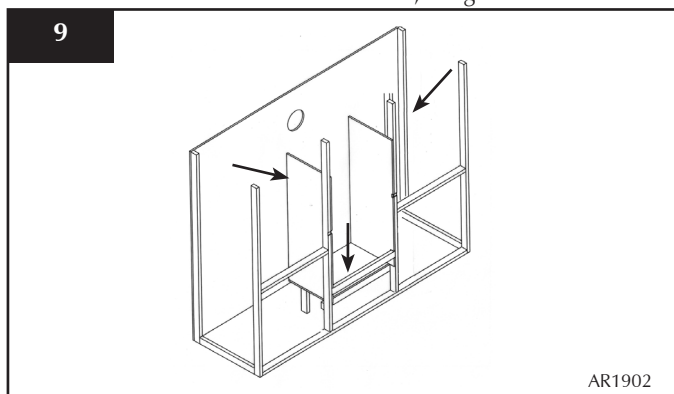

- Ensure the clearances are maintained, see Diagram 8
- Site the appliance and decide on flue requirements
- Cut a hole for the flue exit - see **Installation Instructions, Flue Assembly**

Instructions, Flue Assembly

- Provide gas services into the appliance void on the left-hand side

Because no combustible material can be used above the fire, we provide a support bar:

- Mark out the position to fit the supplied top support bar into the studwork at the correct height. This bar needs to be recessed into the studwork, Diagram 10

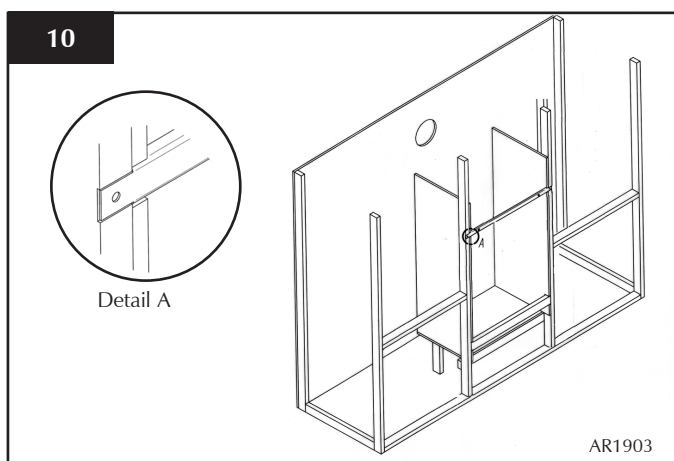

- Fit the support bar into the studwork at the correct height, Diagram 11.

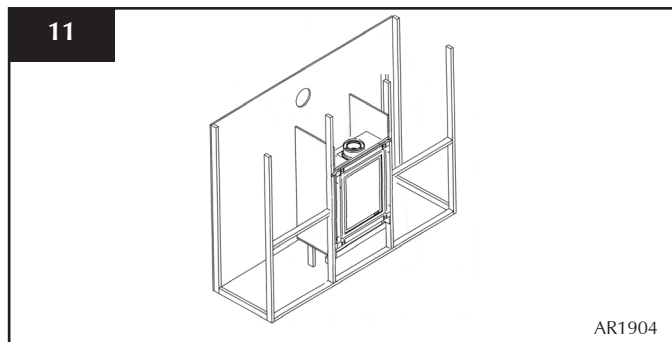

- Attach the 4 frame fixing brackets to the fire by placing the top part of the bracket through the slots
- Push the bracket flat against the panel, then slide down to the stop, see Diagram 12

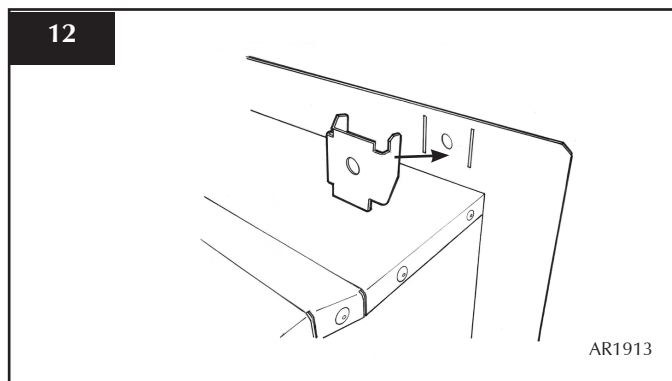

- Fix foam seal to the outer flange of the fire, Diagram 13

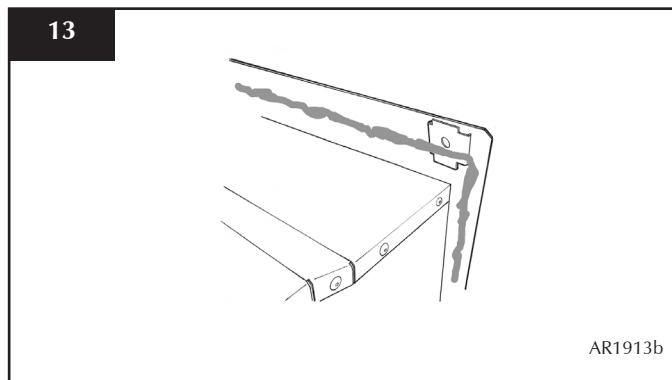

- Position the fire
- Fit non-combustible board to the studwork around the fire. This should extend a minimum of 400mm above the appliance and at least 50mm to the sides of the appliance (from the outer box, not the flanges).
- Apply plasterboard to the remainder of the studwork
- Secure the fire back to the studwork using four screws through flange, bracket, support bar
- Apply a plaster finish to the front of the chimney breast

INSTALLATION INSTRUCTIONS

INSTALLATION

Slips

Because of the high temperatures this fire achieves, it is advisable to use marble slips or similar material between the appliance and the plasterboard.

Never use a one-piece slip because expansion (even cracking) can occur.

Note: If a slip is used, longer screws are needed to secure the appliance.

To finish the installation:

- Connect the wall box and batteries following instruction in *Section 7* below
- Connect:
 - the flue system (see *Installation, Flue Assembly*)
 - and gas services (see *Installation Section 9*) using the opening in the side of the chimney breast for access.

After commissioning:

- Finish the sides of the chimney breast, Diagram 14

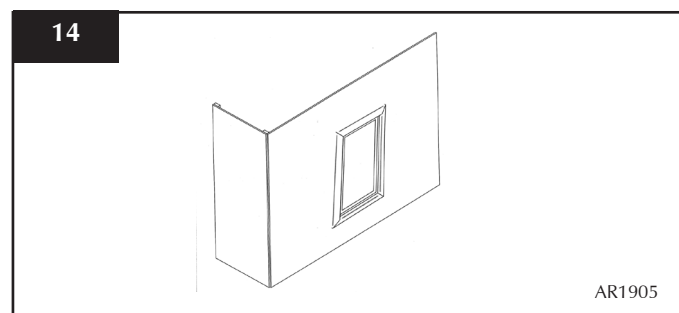

5. STUDWORK FOR STUDIO EDGE INSTALLATION KIT

There is an optional Studio 22 Edge Installation Kit available for installing the fire without a frame: Studio 22 BF Code No. 8727BFEK22. This consists of four metal brackets so that you can create a flush finish to the "edge" of the appliance.

Using the installation kit:

- Fit the four metal brackets of the kit to the fire:
- Fit the sides to the appliance and secure using nuts and washers provided
- Attach the top and bottom metal brackets to the top and bottom flanges of the appliance using nuts and washers provided, see Diagram 15

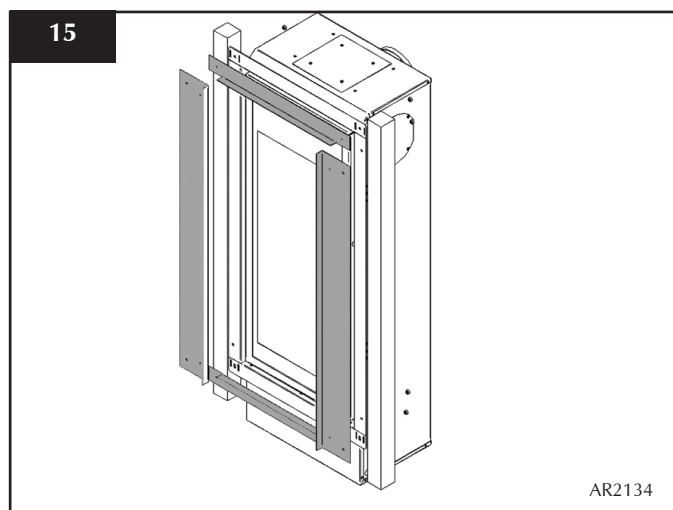

- Put vertical studwork at minimum clearance to the side of the fire (50mm)
 - Secure to the vertical studwork through the holes in the metal brackets fitted to the fire, Diagram 16
- The kit has been designed so that non-combustible board can be taken right up to the edge of the four brackets, Diagram 17

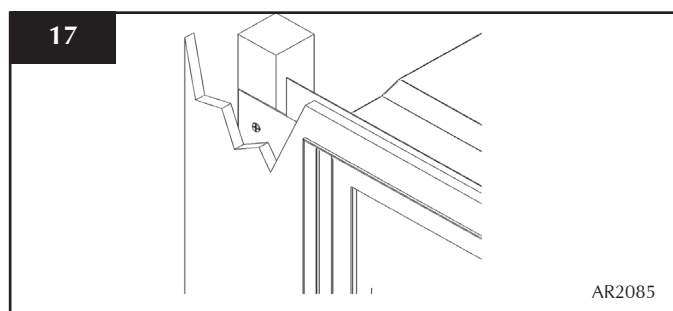
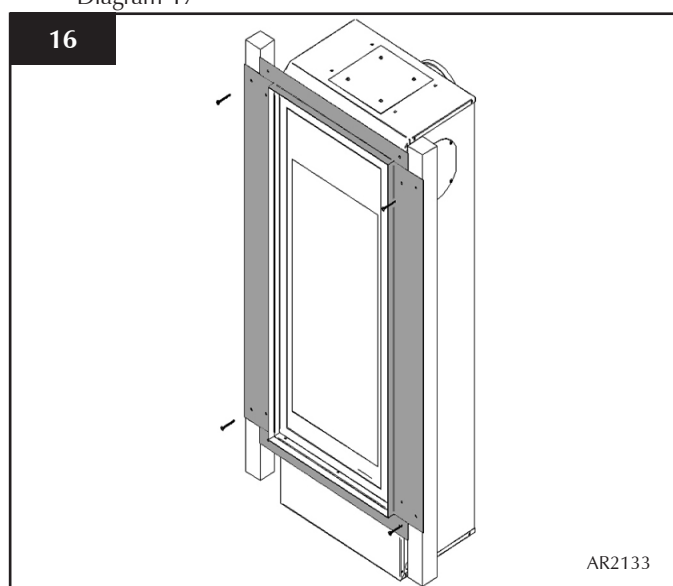

INSTALLATION INSTRUCTIONS

INSTALLATION

Build the studwork chimney breast to the desired size:

- Ensure all clearances to combustible material are maintained, *Section 3, 3.1* above
- Decide on flue requirements
- Cut a hole for the flue exit - see **Installation Instructions, Flue Assembly**

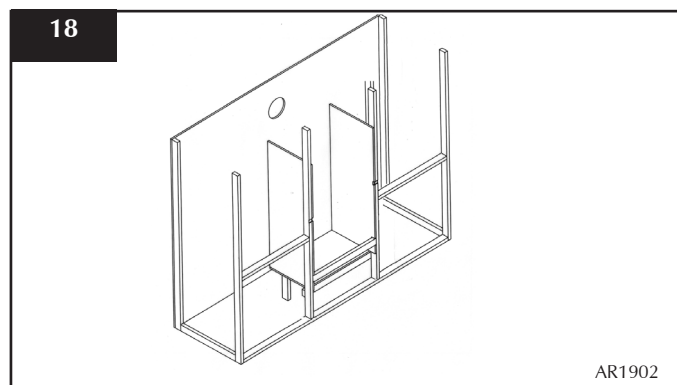

- Fit non-combustible board to the studwork above and to the sides of the fire. This should extend a minimum of 400mm above the appliance and a minimum of 50 mm to each side
 - Fit plasterboard to the remaining chimney breast front
 - Connect the flue system and gas services using the opening in the side of the chimney breast for access
- After commissioning, finish the sides of the chimney breast, Diagram 19

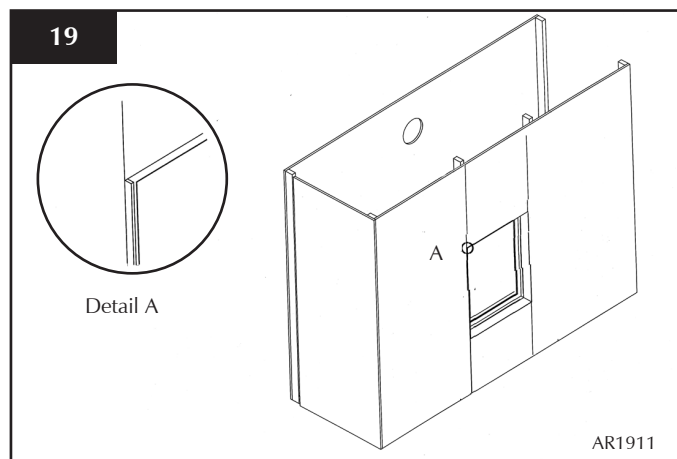

- Apply a plaster finish to the chimney breast

6. STUDWORK FOR COOL WALL INSTALLATION KIT

There is an optional Studio 22 Cool Wall Installation Kit available for installing the fire without a frame: Studio 22 BF Code No. 8727BFCW22. This consists of four metal brackets so that you can create a flush finish to the "edge" of the appliance.

For this cool-wall installation, the convected heat of the fire is channelled into the studwork enclosure and vented at the top.

The cool wall installation kit is provided unfinished. This allows the kit to be finished to match the fireplace decor.

Using the fixing kit:

- Fit the four metal brackets of the kit to the fire
- Line up the side brackets with the holes in the front flange of the appliance
- Secure to the flange using the nuts, washers and bolts provided, Diagram 20

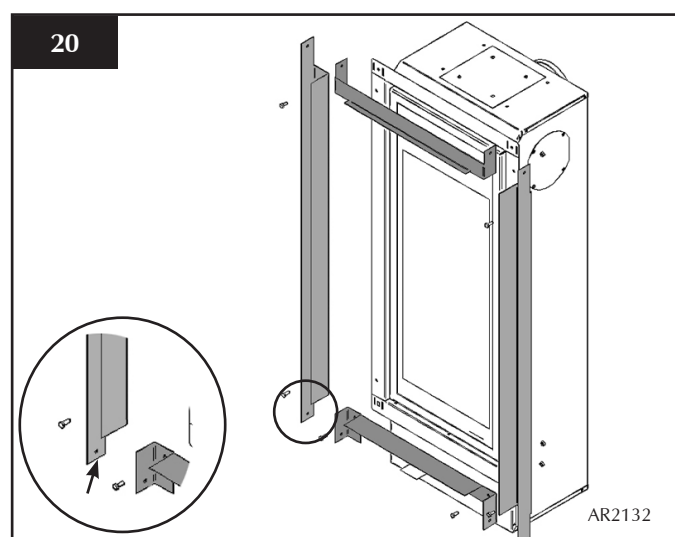

Note: Make sure the long side of the bracket is nearest the inside.

This now determines the width of your two vertical studwork supports. The kit has been designed so that non-combustible board can be taken right up to the edge of the four brackets, Diagram 21 & 22

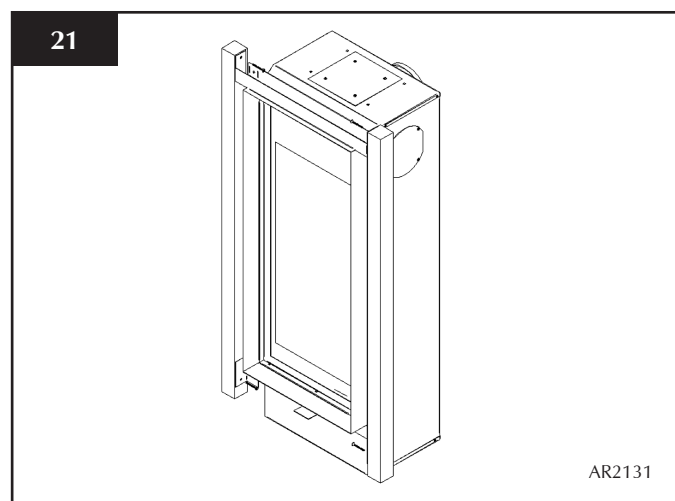

INSTALLATION INSTRUCTIONS

INSTALLATION

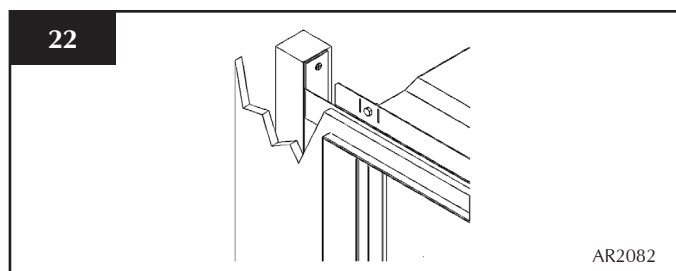

- Ensure all clearances to combustible materials are maintained, *Section 3, 3.1*
- Decide on flue requirements
- Cut a hole for the flue exit - see **Installation Instructions, Flue Assembly**, Diagram 21

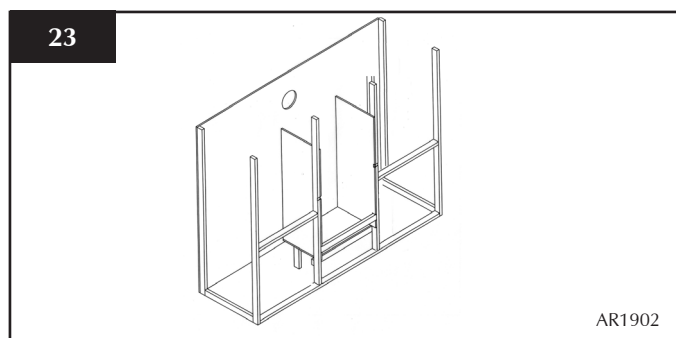

- Secure the top bracket at each side into the studwork using the screws provided
- Secure the bottom bracket to the flange using the nuts, washers and bolts provided

Finally:

- Secure the outer part of the metal brackets into the studwork, see Diagram 20 inset
There is a deliberate gap at the top for convected heat.
- Fit non-combustible board to the studwork above the fire. This should extend a minimum of 400mm above the appliance and a minimum of 50mm to each side
- Fit plasterboard to the remaining chimney breast front
- Connect the flue system and gas services using the opening in the side of the chimney breast for access. After commissioning, finish the sides of the chimney breast, Diagram 24

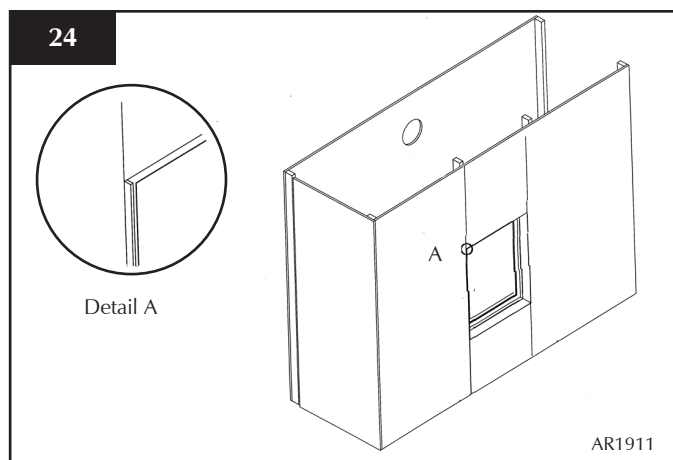

The top of the chimney breast must have a minimum 200cm² vent.

- Apply a plaster finish to the chimney breast

7. ALL TYPES OF INSTALLATION INTO STUD WORK - WALL BOX & BATTERIES

- 7.1 Decide on the position for the wall box containing the batteries and wall switch
- Connect the wire from the fire to the battery pack, Diagram 25

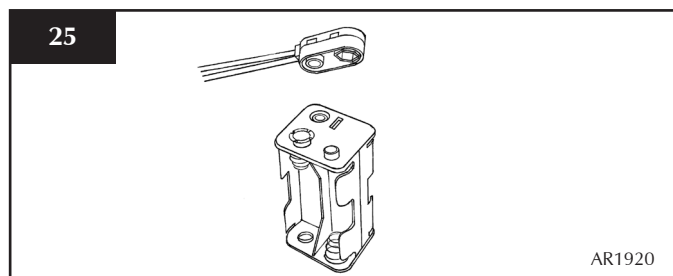

- Connect the wire from the fire to the touch pad/connector, Diagram 26

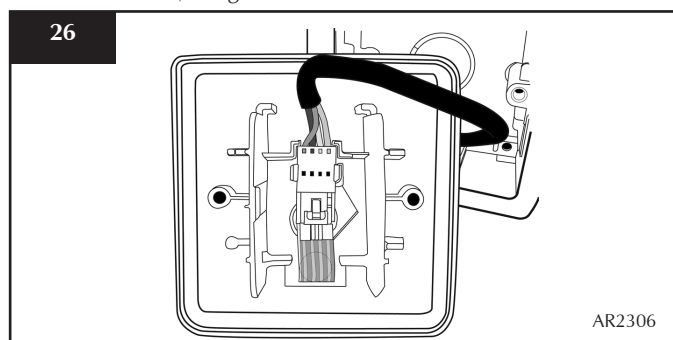

- Correctly position the four new AA size batteries
- Re-assemble the battery holder as shown in Diagram 27
- Ensure the touch pad cable is tucked to the left on fitting the wall plate back onto the wall

INSTALLATION INSTRUCTIONS

INSTALLATION

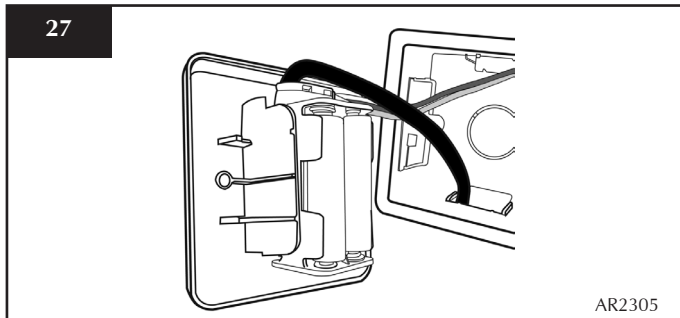

- Secure the wall plate with the touch pad attached to the wall box, Diagram 28

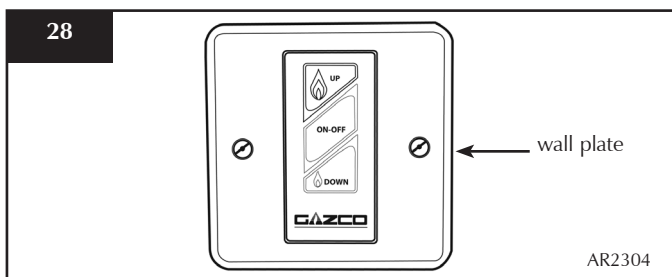

- 7.3 **PLEASE ENSURE NO WIRES ARE TRAPPED BEFORE REPLACING THE WALL PLATE. THE TOUCH PAD LEAD IS EASILY DAMAGED.**
- 7.4 **IMPORTANT**
THE WALL SWITCH MUST BE INSTALLED USING A NON-METALLIC MOUNTING BOX, PLEASE ENSURE THAT THE PLASTIC DRY LINING BOX IS USED WHEREVER POSSIBLE. IF IT IS INTENDED TO INSTALL THE WALL SWITCH ON A MASONRY IT IS POSSIBLE TO DRILL THROUGH THE REAR OF THIS BOX AND SECURE IN POSITION USING WALL PLUGS AND SCREWS ALTHOUGH A SMALL AMOUNT OF FINISHING WORK WILL BE REQUIRED TO COVER THE PLASTIC SIDE SECURING TAGS. ALTERNATIVELY A STANDARD 47MM DEEP PATRESS BOX CAN BE USED TO SURFACE MOUNT THE WALL SWITCH.

8. FLUE ASSEMBLY

Three types of flue terminal are available: rear flue, horizontal and vertical.

NOTE: When switching from top to rear exit it is important that you use the spigot supplied with the Rear Flue Kit.

8.1 REAR EXIT FLUE

WALL THICKNESS	MIN	200mm	MAX	600mm
----------------	-----	-------	-----	-------

- 8.1.3 Remove the flue assembly and terminal guard from the box. Take care not to lose the fixings.

- 8.1.4 Having decided on the final appliance position and ensuring that all external flue terminal clearances are complied with, (See *Section 1, Site Requirements*):

- Mark the centre of the final flue position on the wall

TAKE CARE WHEN MARKING OUT FOR THE FLUE. IT IS DIFFICULT TO MOVE AFTER INSTALLATION.

A 152mm (6") diameter hole is required to install the flue. This can be achieved by either:

- Core Drill.
- Hammer & Chisel.

It is advisable to drill small holes around the circumference when using method b). Make good at both ends of the hole.

- 8.1.5 The appliance is factory set for top exit, but can be changed to a rear exit.

For a rear exit flue:

- Discard the outer spigot from the top exit set up and use the replacement spigot supplied in the rear terminal kit**

- 8.1.6 To set the flue length, measure the total wall thickness, then add 65mm. This total flue length will give the minimum clearance of 50mm between the rear of the appliance and the wall. To cut the flue to length using a hacksaw, first insert the square cardboard fitment into the flue. This will support the inner flue. Cut through the flue and fitment. See Diagram 29. **ENSURE THE REMAINING FITMENT IS REMOVED FROM THE FLUE.** File the cut edges of the flue smooth.

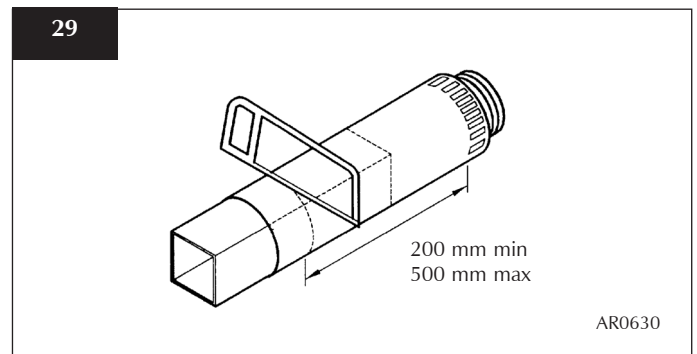

- Fit the flue to the appliance and secure with the aluminium tape supplied
- Any terminal which is less than 2 meters above any access (level ground, balcony or above a flat roof to which people have access), is to be fitted with the guard supplied.

8.2 TOP EXIT FLUE

- 8.2.1 There are two types of top exit flues available, one with a vertical terminal, the other with a horizontal terminal. Minimum and maximum flue lengths are shown in the *Site Requirements*, 2.5.

IMPORTANT: WHEN INSTALLING A TOP EXIT FLUE REFER TO THE TECHNICAL SPECIFICATIONS ON THIS PAGE FOR THE APPROPRIATE SIZE RESTRICTOR. IF A RESTRICTOR IS REQUIRED, FIT THIS BETWEEN THE SMALL OUTLET SPIGOT AND THE AIRDUCT, SEE Diagram 30.

INSTALLATION INSTRUCTIONS

INSTALLATION

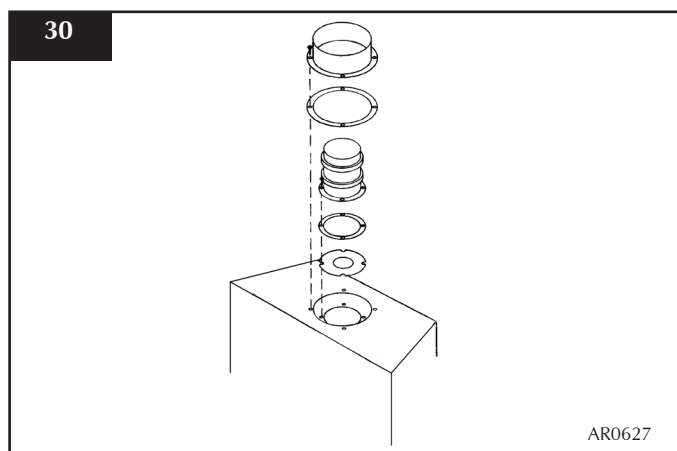

TOP EXIT - VERTICAL & HORIZONTAL FLUE		
Vertical Flue Height from Top of Appliance	Horizontal Length	Restrictor Size
200 mm	500 mm	No restrictor
500 mm	1000 mm	No restrictor
1000 mm to 1500 mm	250 mm to 5000 mm	Ø 70 mm
1510 mm to 3000	250 mm to 5000 mm	Ø 60 mm

TOP EXIT - VERTICAL INCLUDING OFFSET	
Vertical Flue Height from Top of Appliance	Restrictor Size
3000 mm up to 4990 mm	Ø 52 mm
5000 mm up to 10,000 mm	Ø 47 mm

8.2.2 The appliance is factory set for top exit.

8.3 A 152mm (6") diameter hole in the wall or ceiling is required to install the flue. This can be achieved by either:

- Core drill
 - Hammer and chisel
- Drill small holes around the circumference when using method b. Make good both ends of the hole.

8.4

- Allow enough room either above or to the side of the appliance to assemble the flue on top
- Assemble a horizontal flue in the following order:
 - Vertical section
 - 90° elbow
 - Horizontal plus terminal
- Support the opening of a masonry installation with a lintel

8.5 Only the horizontal terminal section can be reduced in size. To find the length:

- Measure from the outside of the wall to the stop on the 90°
- Add 10 mm to the outlet end

- Measure from the edge of the slots closest to the wall
- Mark around the flue, Diagram 31

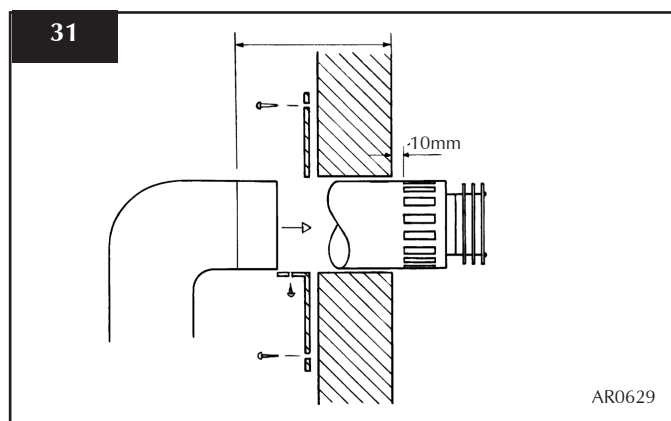

A wall plate is supplied to fix the flue to the wall:

- Bend the tab to 90°
- Assemble the plate onto the flue but wait to secure to wall and flue after the flue is fully assembled, Diagram 31

8.6 The cardboard fitment in the terminal is used to support the flue whilst it is cut to length. **ONCE CUT TO SIZE, REMOVE THE CARDBOARD REMNANT**, Diagram 32.

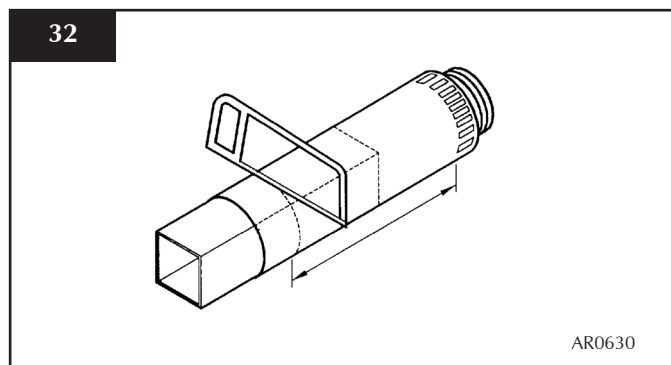

9. ASSEMBLING THE APPLIANCE

There are two possible points of entry for your gas pipe depending on the location of your appliance, one located on the underside and the other located on the left-hand side:

- Choose the most suitable for your installation
- Slit with a sharp knife before bringing through the supply pipe, Diagram 33

9.1

- Remove the compression elbow from the appliance and connect it to the gas supply pipe

As the appliance is fitted into the enclosure:

- Pass the elbow and supply pipe through the silicone panel
- PURGE THE SUPPLY PIPE.** This is essential to expel any debris that may block the gas controls.

INSTALLATION INSTRUCTIONS

INSTALLATION

- Connect the elbow to the appliance inlet pipe, Diagram 33

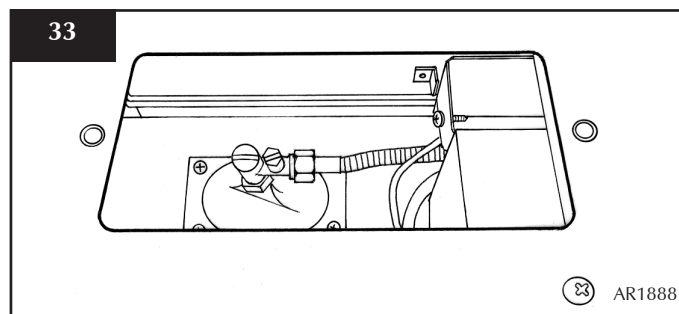

- 9.2 To reassemble the control unit:
- Put the left-hand side of the control unit into the left corner of the interior, before lowering down and sliding to the right
 - Refix with the 13 screws
 - Connect the elbow to the appliance inlet pipe, Diagram 33
- 9.3 Remove the screw from the pressure test point
- Connect a suitable pressure gauge to the test point located on the inlet fitting
 - Refit the burner
 - Turn on the gas
 - Light the appliance to check for leaks
 - Turn off the gas
 - Remove the burner
 - Disconnect the pressure test point
 - Replace the test point screw
- 9.4
- Replace the access panel in the base of the appliance with the two screws, Diagram 34, Arrow B
 - Replace the rear air baffle, securing each side with the two screws, Diagram 34 Arrow A

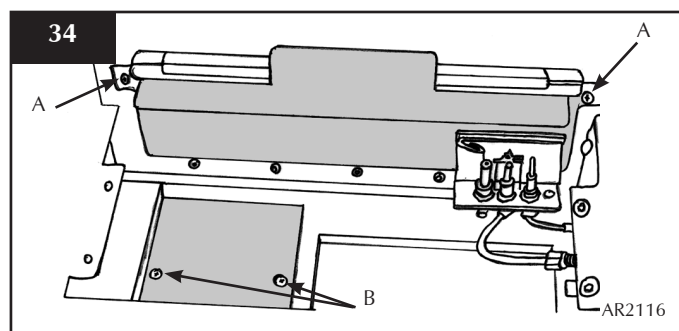

- Put the burner tray in place and tighten the four screws
- Replace the vermiculite back panel
- Refit the two side panels
- Refit the clips to the upper inside to hold the side panels in place, Diagram 35
- Refit the front vermiculite panel in front of the burner

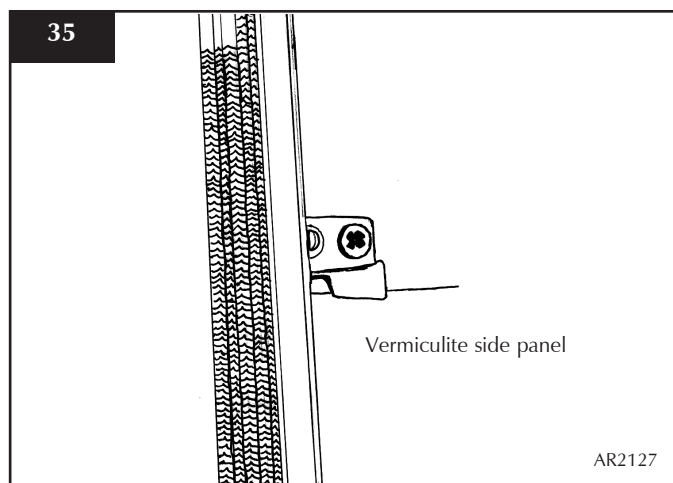

10. ARRANGEMENT OF FUEL BED

ADVICE ON HANDLING AND DISPOSAL OF FIRE CERAMICS

The fuel effect and side panels in this appliance are made from Refractory Ceramic Fibre (RCF), a material which is commonly used for this application. Protective clothing is not required when handling these articles, but we recommend you follow normal hygiene rules of not smoking, eating or drinking in the work area and always wash your hands before eating or drinking. To ensure that the release of RCF fibres are kept to a minimum, during installation and servicing a HEPA filtered vacuum is recommended to remove any dust accumulated in and around the appliance before and after working on it. When servicing the appliance it is recommended that the replaced items are not broken up, but are sealed within heavy duty polythene bags and labelled as RCF waste. RCF waste is classed as stable, non-reactive hazardous waste and may be disposed of at a licensed landfill site. Excessive exposure to these materials may cause temporary irritation to eyes, skin and respiratory tract; wash hands thoroughly after handling the material.

After cleaning the fire or replacing parts, carefully re-assemble the ceramic components. **WHEN THE EMBERS ARE PLACED ON THE BURNER IT IS IMPORTANT THEY DO NOT COVER ANY PORTS!**

The fuel bed is made up of embers and 6 logs, identifiable by moulded letters:

- 10.1 Place the embers around the burner holes as shown in Diagram 36. **Do not cover any of the holes.**

INSTALLATION INSTRUCTIONS

INSTALLATION

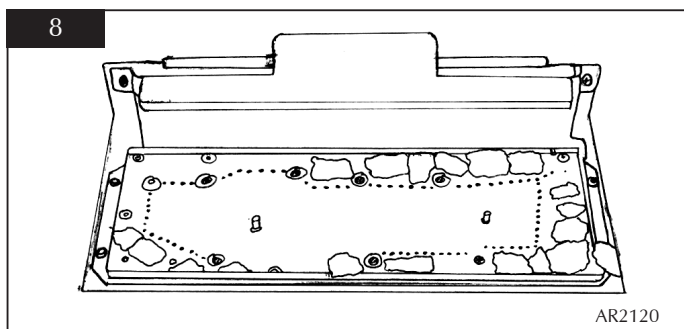

- 5.2 Place Log C onto the two studs on the burner skin, Diagram 9, with charred effect of the log facing forward.

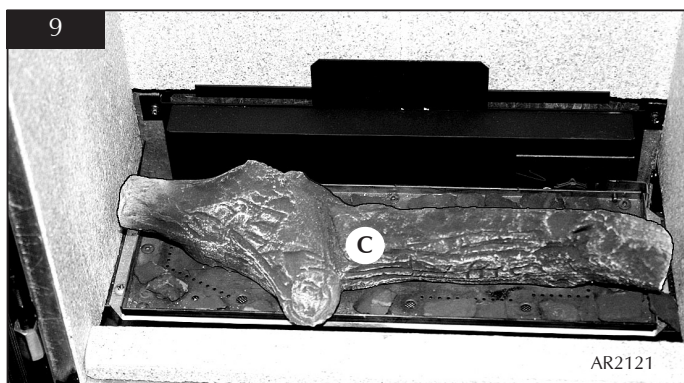

- 5.3 Place Log A on the ledge at the rear of the fire, Diagram 10.

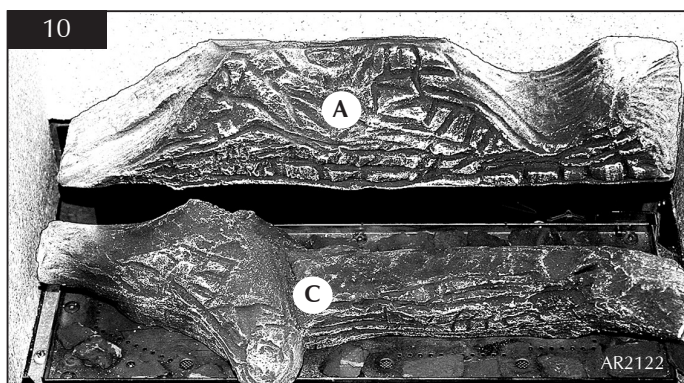

- 5.4 Place Log D so that the back end sits in the groove in the rear of Log A and the front left rests in the cut-out groove in Log C, Diagram 11.

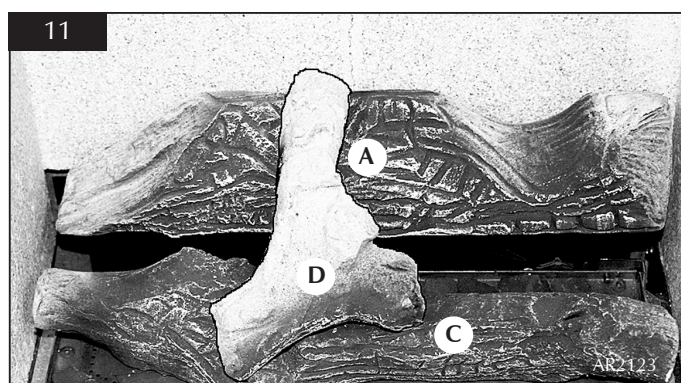

- 5.5 Position Log B so that the underneath rests in the groove of Log C, and the triangular groove in the base of Log C fits into the corner of the burner, Diagram 12.

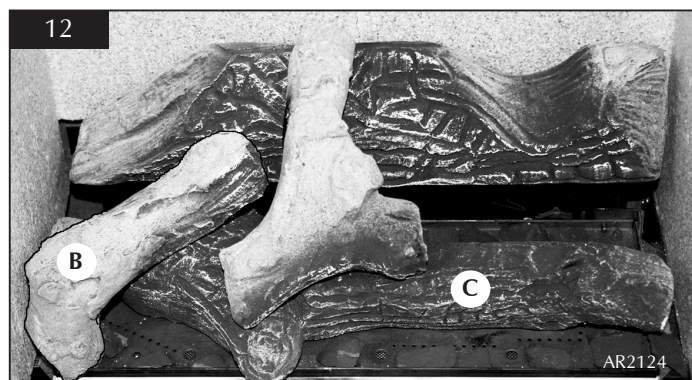

- 5.6 Put the groove in the base of Log E into the indent on the right of Log C. The left branch rests on the upper end of Log A, Diagram 13.

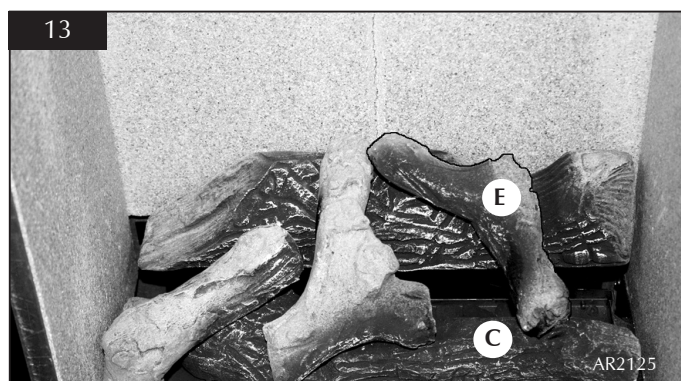

- 5.7 Log F rests against Log C at its far right end, between Log A and the side panel. The front end of Log F sits on the front panel, see Diagram 14

INSTALLATION INSTRUCTIONS

INSTALLATION/ COMMISSIONING



When closing the door ensure the door catches are fully engaged.

- Slide the allen key into the gap between the door and frame and locate the catch of the lower lock
- Push the allen key DOWN
- Slide the allen key into the gap and locate the upper lock
- Push the allen key UP

UNDER NO CIRCUMSTANCES SHOULD THE APPLIANCE BE USED WITHOUT THE CATCHES HOLDING THE DOOR IN PLACE.

11. LIGHTING THE APPLIANCE

Note: The Emergency Shut Off switch must be in the ON position, refer to Section 2, User Instructions. There are two ways of lighting the Studio:

- by thermostatic remote control
- using the fire's touch pad

THERMOSTATIC REMOTE CONTROL

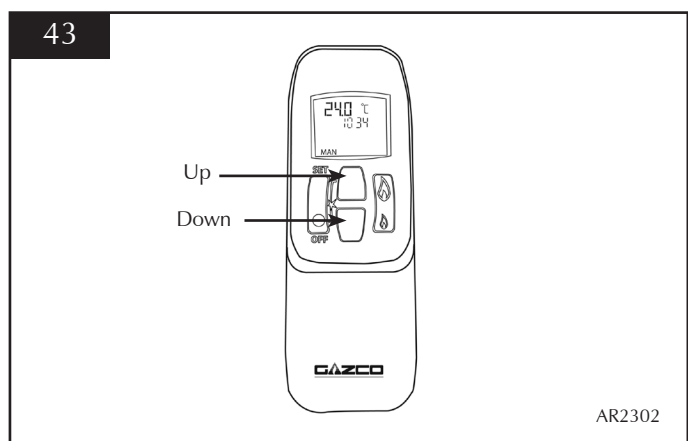

To light the appliance using the handset:

- Press OFF and UP buttons simultaneously
- You hear a beep as the ignition process begins.

IMPORTANT: YELLOW FLAMES TYPICALLY APPEAR WHEN THE APPLIANCE HAS REACHED NORMAL OPERATING TEMPERATURE. THIS CAN TAKE UP TO 30 MINUTES.

WARNING: IF THE APPLIANCE FAILS TO LIGHT OR BECOMES EXTINGUISHED IN USE, WAIT 3 MINUTES BEFORE ATTEMPTING TO RELIGHT.

TOUCH PAD CONTROL

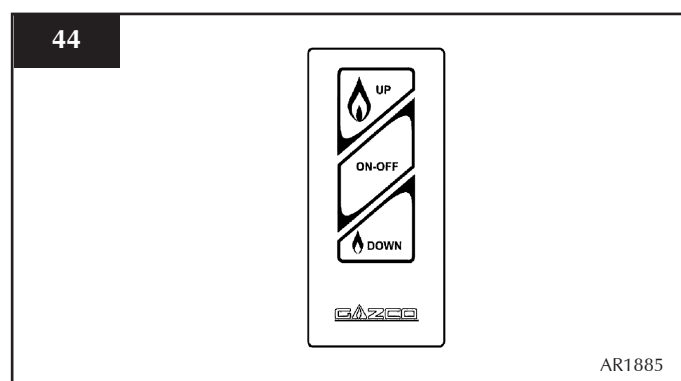

- Press the ON-OFF button to light the appliance, (up to 30 seconds)
- Press the UP button to increase the flame height.
- Press the DOWN button to decrease the flame height. At the lowest point it goes to 'standby mode', (only pilot lit)
- Press the ON-OFF button to turn the appliance off.

IMPORTANT: YELLOW FLAMES TYPICALLY APPEAR WHEN THE APPLIANCE HAS REACHED NORMAL OPERATING TEMPERATURE. THIS CAN TAKE UP TO 30 MINUTES.

WARNING: IF THE APPLIANCE FAILS TO LIGHT OR BECOMES EXTINGUISHED IN USE, WAIT 3 MINUTES BEFORE ATTEMPTING TO RELIGHT.

COMMISSIONING

COMMISSIONING

- 1.1 Complete the Commissioning Checklist at the front of this manual covering:

- Flue checks
- Gas checks

For working pressure test, use the access panel at the gas connection ensuring the burner is in position, see

Installation, Section 9, 9.1

- 1.2 **In the unlikely event that the appliance is receiving interference from other electronic devices, re-programme the handset/Control box**

Reprogramming handset/Control box

To access the control box, see ***Servicing Instructions, Section 7 - Main Control Assembly.***

- Press and hold the reset button on the control box until you hear two signals. After the second longer signal:
 - Release the reset button and within 20 seconds:
 - Press the DOWN button on the handset until you hear an additional long signal confirming the new code

SERVICING INSTRUCTIONS

SERVICING / FAULT FINDING CHARTS

1. SERVICING REQUIREMENTS

IMPORTANT – The glass panel on this appliance should be checked for any signs of damage on the front face of the glass panel (scratches, scores, cracks or other surface defects). If damage is observed, the glass panel must be replaced and the appliance must not be used until a replacement is installed. Under no circumstances should the appliance be used if any damage is observed. Please isolate the appliance until a replacement glass panel has been obtained and installed. Replacement glass panels can be purchased from Gazco via the dealer from which the appliance was purchased or any other Gazco distributor.

This appliance must be serviced at least once a year by a competent person.

All tests must be carried out in accordance with the current National recommendations.

- 1.1 Before any tests are undertaken on the appliance:
- Conduct a gas soundness test for the property to ensure there are no gas leaks prior to starting work
- 1.2 Fully check the operation of the appliance

Special checks

1.2.1 Clean any lint or fluff from the pilot - pay particular attention to the aeration holes of the pilot

1.2.2 Clean away any fluff or lint from under the burner

1.2.3 Check the spark gap on the pilot is correct

- Correct any faults found during the initial tests
- Recommission the appliance conducting the usual safety checks

- 1.3 Advise the customer of any remedial action taken.

REPLACE BATTERIES BEFORE ATTEMPTING TO RECTIFY ANY FAULTS.

IF THE FIRE DOES NOT WORK, BUT HAS WORKED IN THE PAST:

- **CHECK THE EMERGENCY SHUT OFF SWITCH IN THE BOTTOM RIGHT CORNER BY THE DOOR IS SWITCHED ON, SEE USER SECTION, PAGE 6**

Electronic Control Valve Fault Analysis

Symptom	Cause	Remedy
3 Short beeps from control	Batteries low in appliance	Replace appliance batteries
No ignition, 5 second continuous tone (there may be several short beeps before)	1. On/Off switch is in OFF position 2. Loose/damaged wire	1. Move switch to ON position 2. Check interrupter block and wires
No ignition, no tone, motor turns slightly when operated	Receiver board damaged	Replace receiver
No pilot flame and control continues to spark	Thermocouple circuit wired incorrectly	Correct wiring
Pilot lights, control continues to spark, valve shuts down after 10 - 30 seconds	1. No spark at pilot burner 2. Loose/damaged wire	1. Rectify spark at pilot burner 2. Check interrupter and wires

IGNITION FUNCTIONAL CHECK 1

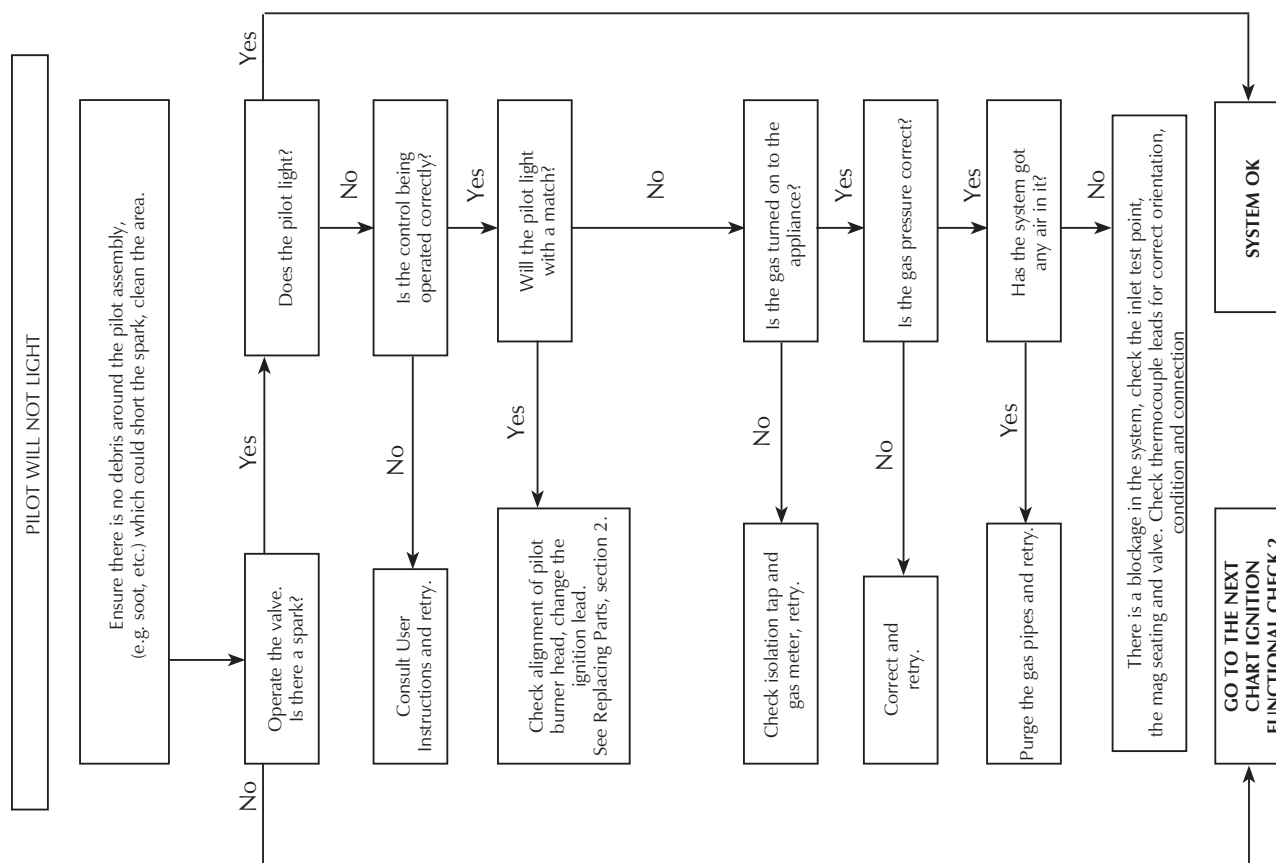

SERVICING INSTRUCTIONS

FAULT FINDING CHARTS

FLAME FAILURE FUNCTIONAL CHECK 3

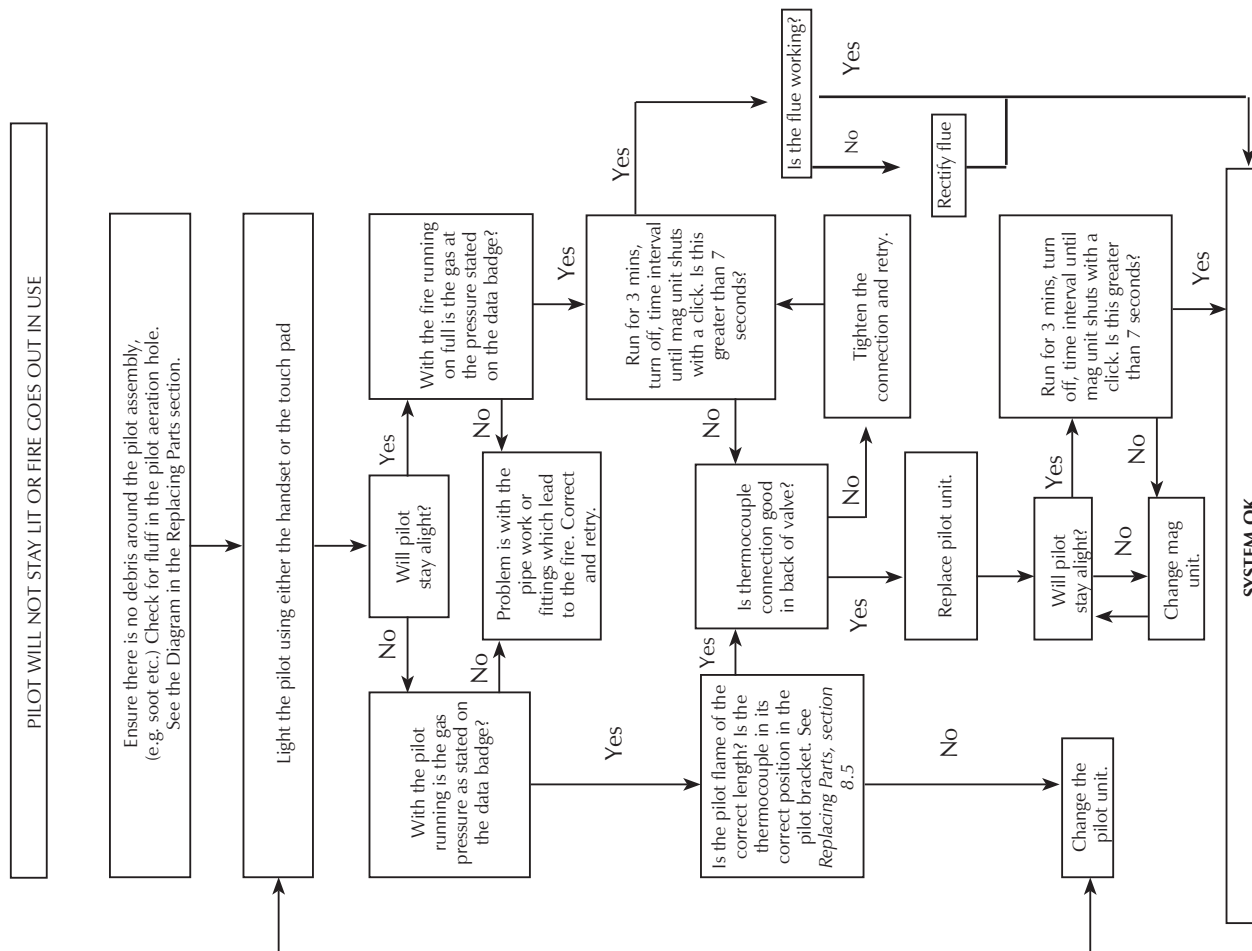

IGNITION FUNCTIONAL CHECK 2

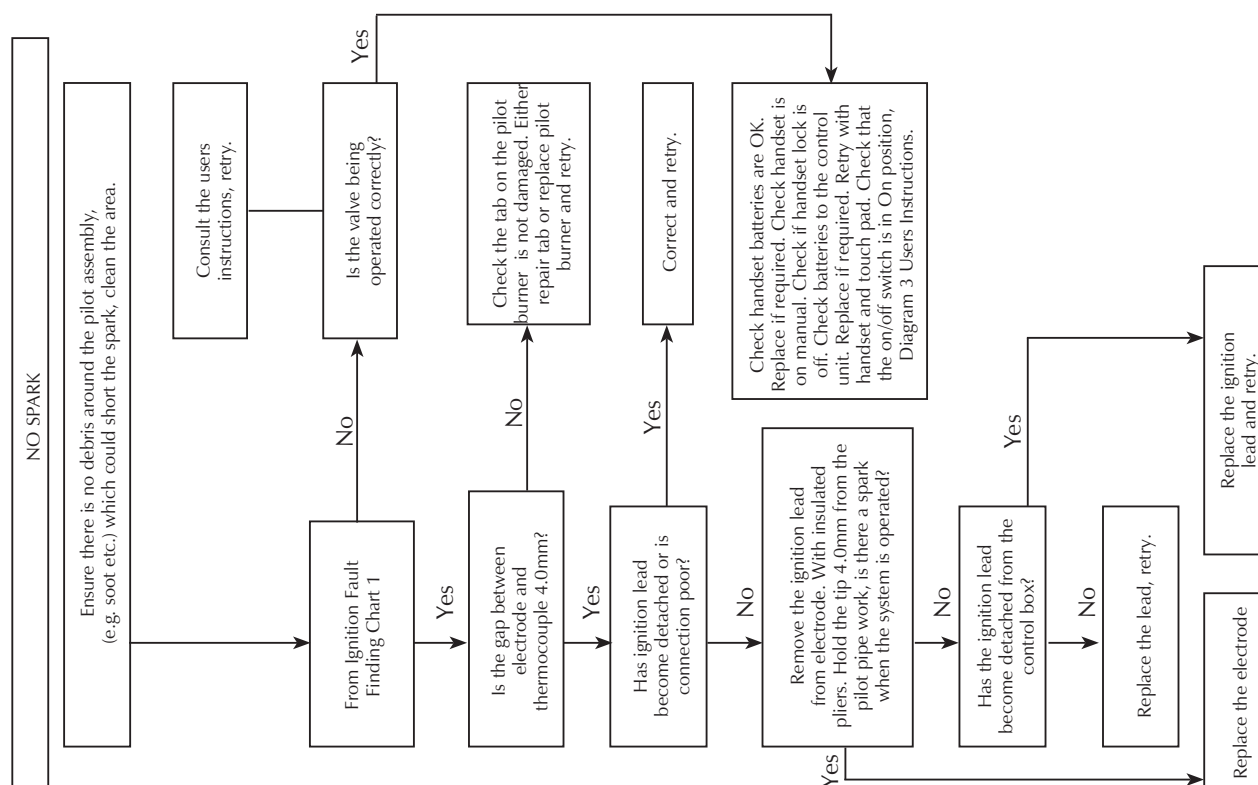

SERVICING INSTRUCTIONS

REPLACING PARTS

1. GENERAL

- 1.1 All main components can be replaced without removing the appliance from its installation. It is essential that the gas supply to the appliance is turned off at the isolation device before proceeding further.
- 1.2 **DISCONNECT BATTERIES BEFORE SERVICING THE APPLIANCE**
- 1.3 **Removal of Flue**
If, for any reason, the flue has to be removed from the appliance, the seal must be replaced in the inner spigot.
- 1.4 Access to the controls is restricted and the whole of the control assembly is to be removed as one unit. Refer to *Section 7* below

2. DECORATIVE FRAME

- 2.1 The same method is used to remove each frame.
 - Lift the frame upwards off the four support brackets, Diagram 1

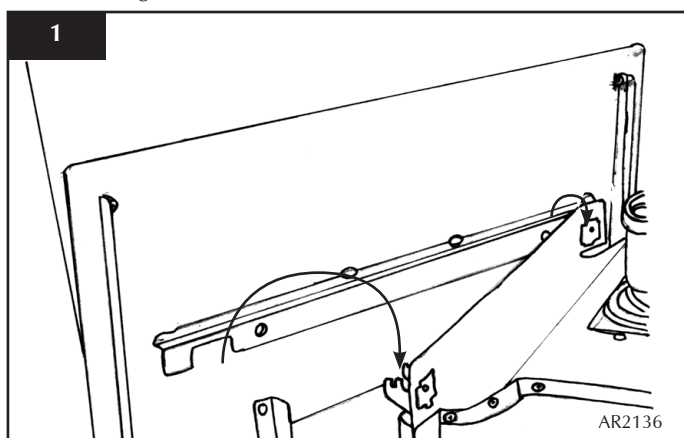

NOTE: THE STEEL FRAME IS HEAVY. TAKE CARE WHEN LIFTING

3. WINDOW FRAME ASSEMBLY

- 3.1 Using the allen key provided to release the upper and lower catches on the right side of the door:
 - Slide the allen key into the gap between the door and frame and locate the catch of the upper lock
 - Push the allen key DOWN
 - Slide the allen key into the gap and locate the lower lock
 - Push the allen key UP
 - Open the door outwards

When closing the door ensure the door catches are fully engaged.

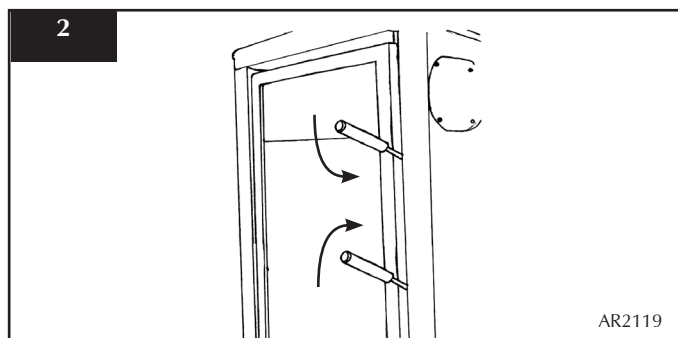

- 3.2 To completely remove the glass front:
 - Open the door at a right angle to the fire
 - Lift the door vertically off its hinges and place to one side, Diagram 3

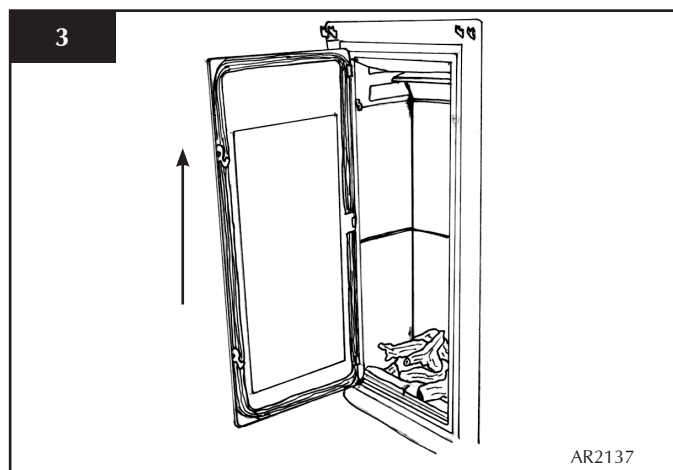

- Refit in reverse order

UNDER NO CIRCUMSTANCES SHOULD THE APPLIANCE BE USED WITHOUT THE CATCHES HOLDING THE DOOR IN PLACE.

4. GLASS WINDOW

- 4.1 Remove the two clips and brackets from either side of the frame, Diagram 4

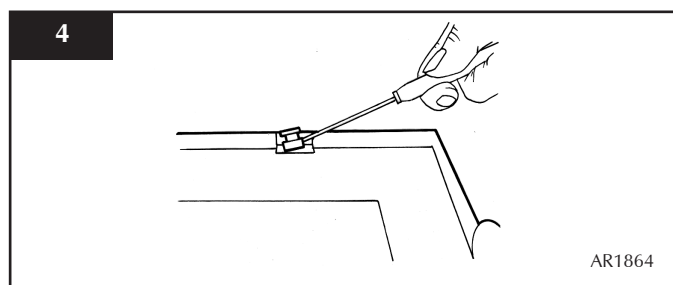

- Lift the glass clear from the lock bracket at the top of the frame and slide out

SERVICING INSTRUCTIONS

REPLACING PARTS

5. VERMICULITE PANELS

5.1 TAKE CARE WHEN HANDLING THE VERMICULITE PANELS, THEY ARE FRAGILE.

Note: Make sure you support the back panel before removing the second side panel in case the back falls forward

- Undo the clips at the top of the side panels
- While supporting the rear panel:
- Remove each side panel and place to one side
- Remove the back panel

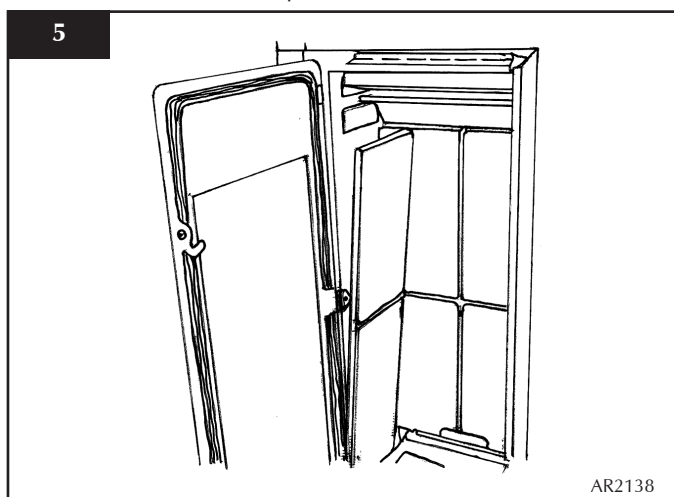

- Remove the front lower panels

5.2 Reassemble in reverse order, ensuring the bottom edge of the back panel is behind the Air Baffle, Diagram 6

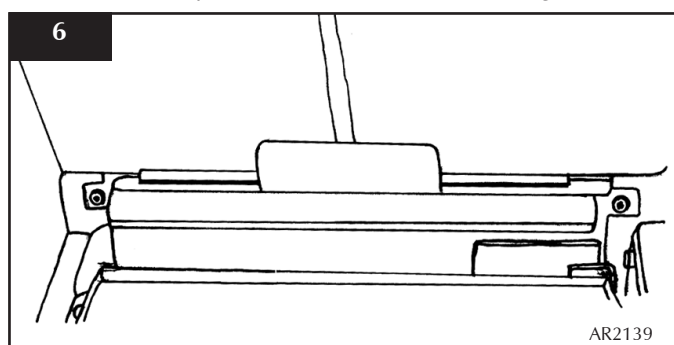

6. MAIN BURNER

6.1 To replace the main burner:

- Remove the logs and embers from the burner
- Undo the four screws holding the burner tray in place
- Lift the left side of the burner up and out first, Diagram 7

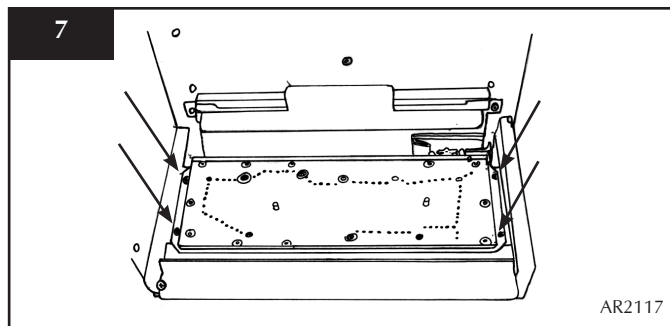

6.2 To replace the burner:

- Lower the right-hand side over the injector
- Lower the left side down
- Insert the four fixing screws and tighten

NOTE: Before replacing the burner, make sure the silicone seal around the injector is intact.

7. MAIN CONTROL ASSEMBLY

7.1 To access the main control assembly, first remove:

- the decorative frame if applicable
- the door
- vermiculite panels
- main burner
- air baffle

7.2 To remove the access panel:

- Undo the two screws, Diagram 8

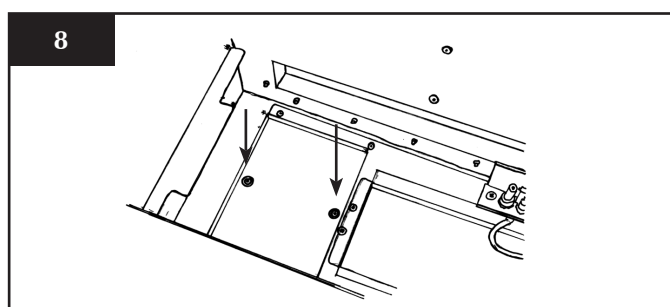

7.3 Isolate the gas supply at the isolation device and disconnect the gas inlet, Diagram 9.

- Undo the 13 screws fixing the control unit in place

SERVICING INSTRUCTIONS

REPLACING PARTS

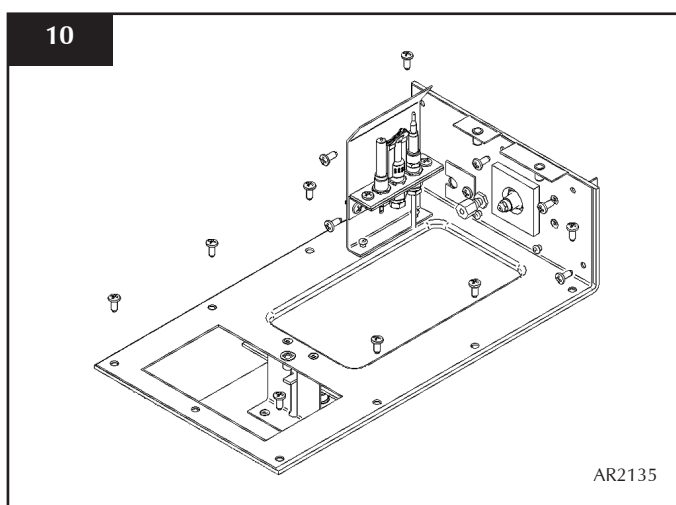
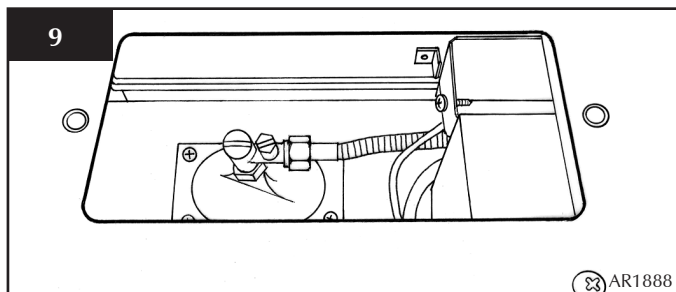

With all screws removed:

- Slide the control unit to the left
- Lift the right-hand side up and out

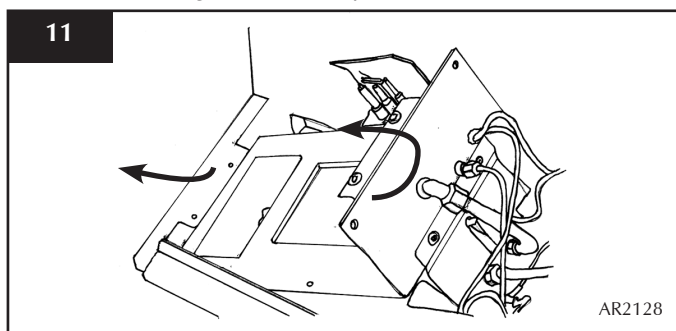

- 7.4 • Disconnect the two cables marked 'A' in Diagram 12

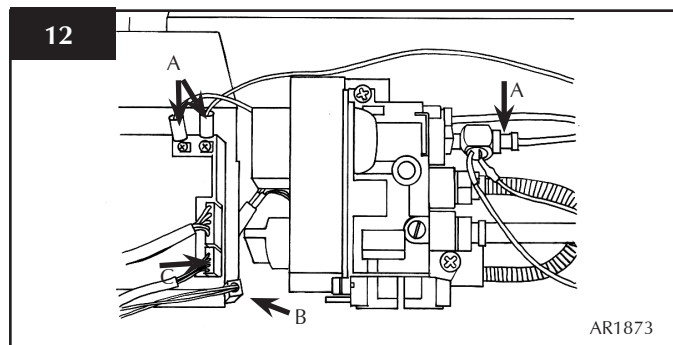

- Disconnect the battery extension lead, Diagram 12, B
 - Disconnect the touch pad extension lead, Diagram 12, C
- The control assembly can now be lifted up and removed.
- Reassemble in reverse order

8. PILOT UNIT ASSEMBLY

- 8.1 The pilot assembly consists of four components which can be individually changed:

1. Pilot burner bracket
2. Pilot injector
3. Electrode
4. Thermocouple

Before commencing work on the pilot the Main Control Assembly must be removed, see *Section 7* above.

- 8.2 **Pilot Burner Bracket**

- Remove the electrode, see paragraph 8.3
- Remove the thermocouple, see paragraph 8.5
- Remove the pilot pipe
- Remove the two screws securing the bracket

The pilot burner bracket can now be removed.

- Replace in reverse order
- Check the pilot gasket and if damaged, replace with a new one

- 8.3 **Electrode**

- Pull the ignition lead off the electrode and undo the retaining nut, Diagram 13

SERVICING INSTRUCTIONS

REPLACING PARTS

13

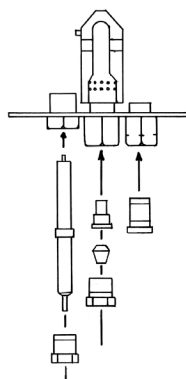

- Replace with a new electrode. Do not over-tighten the nut; this could break the component
- Replace the ignition lead by pushing the spade connector onto the terminal (electrode)

14

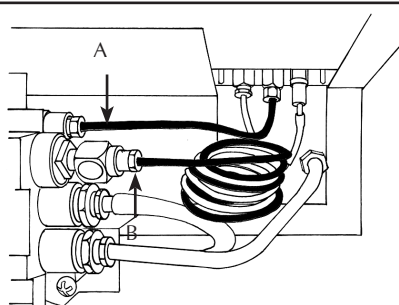

AR1874

8.4 Pilot Injector

- Undo the pilot pipe from the gas valve and from the underside of the pilot burner, Diagram 14, arrow A
- Remove the pipe and the injector drops out from the burner

8.5 Thermocouple

- Disconnect the thermocouple from the gas valve/interrupter, Diagram 14, Arrow B
- Undo the thermocouple nut in the back of the pilot bracket half a turn. This releases the thermocouple.

When replacing with a new thermocouple, take care to bend the new component to the same shape as the thermocouple just removed.

To refit the thermocouple into the pilot bracket, ensure it is pushed fully into the hole. There is a stop on the thermocouple to set the height.

- Lock the retaining nut just enough to grip the thermocouple
- Connect the thermocouple to the valve/interrupter and **take care not to over-tighten**

9. IGNITION LEAD

15

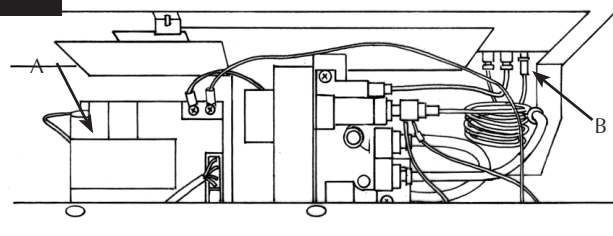

AR1872

9.1 To replace the ignition lead:

- Release the Main Control Assembly and tilt backwards, see *Section 7* above
- Remove the ignition lead from the control box, Diagram 15, Arrow A
- Remove the ignition lead from the electrode, Diagram 15, Arrow B

Note the direction of the lead. The new lead must follow exactly the same route.

NOTE: THE IGNITION LEAD MUST NOT PASS IN FRONT OF THE CONTROL BOX AS THIS CAN DAMAGE THE SENSITIVE ELECTRONICS.

10. GAS VALVE

10.1 To change the gas valve:

- Remove the control assembly, *Section 7*
 - Release the gas inlet pipe, Diagram 16, Arrow A
 - Remove the thermocouple from the interrupter block and release the second thermo current cables
 - Release the pilot pipe, Diagram 16, B
 - Release the injector feed pipe, Diagram 16, C
 - Remove the wire cable, Diagram 16, D
 - Remove the two screws
- The valve can now be freed.

16

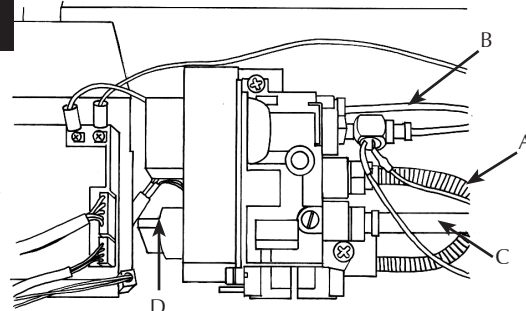

AR1873

SERVICING INSTRUCTIONS

REPLACING PARTS

11. MAGNETIC SAFETY VALVE

11.1 To replace the magnetic safety valve:

- Undo the thermocouple from the interrupter block and remove the two thermo current cables
- Unscrew the interrupter block from the back of the valve
- Undo the silver magnetic valve retaining nut on the back of the valve.
- Gently tap out the mag valve
- Replace with a new unit
- Reassemble in reverse order

12. CONTROL BOX

- Remove the two thermo current cables by removing the two screws, Diagram 17
- Remove the ignition lead, Diagram 17
- Remove the eight loom wire from the control box, Diagram 17

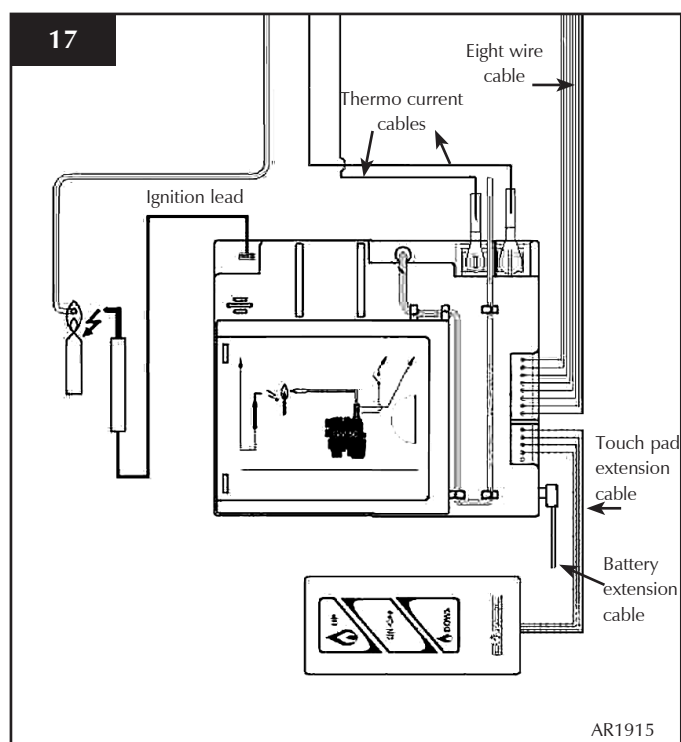

- Remove the battery extension cable, Diagram 17
 - Remove the touch pad extension cable
- The control box can now be replaced.
After replacing the control box you may need to reprogram the handset:
- Press and hold the reset button on the control box until you hear two signals. After the second longer signal:
 - Release the reset button and within 20 seconds

- Press the DOWN button on the handset until you hear an additional long signal confirming the new code

13. MAIN INJECTOR

- 13.1 To change the main injector:
- Undo the injector feed pipe
 - Undo the lock nut from the injector
 - Replace with the correct size injector

14. PRIMARY AERATION PLATE

NOT ALL MODELS HAVE AERATION PLATES. REFER TO NOTE AT BEGINNING OF INSTALLATION INSTRUCTIONS.

- 14.1 Remove the burner module as described in Servicing Section 2.
- 14.2 Remove the fixing screw and slide the plate off the venturi.
- 14.3 Replace with the correct size plate and secure with the screw. Ensure the lower edge of the plate is located over the venturi flange. See Diagram 18.

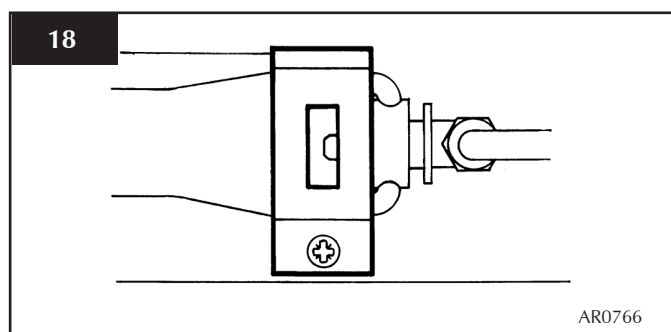

15. CHANGING BETWEEN GAS TYPES

In order to change between gas types, it will be necessary to change the following items:

Burner Unit

Pilot Injector

Control Valve

Injector

Aeration Plate (if required)

Data badge

A kit of parts is available for this, always quote the Model number and Serial number when ordering any spare parts.

NOTE: THE CONTROL VALVE IS FACTORY PRESET FOR THE CORRECT GAS TYPE AND MODEL, A NEW UNIT WILL NEED TO BE ORDERED WHEN CHANGING BETWEEN GAS TYPES.

SERVICING INSTRUCTIONS

REPLACING PARTS

16. PRESSURE AND LEAK TESTING THE APPLIANCE

16.1 Follow **Section 7, Main Control Assembly:**

- Access to the pressure test point can now be reached, Diagram 19

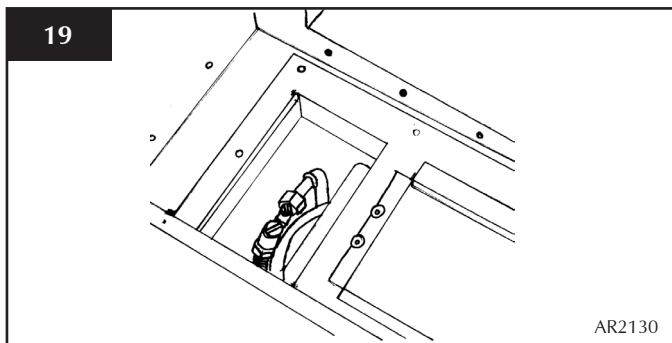

16.2 To leak test any gas joints on the appliance, the control assembly must first be undone and tilted backwards, see **Section 7, 7.3 Diagram 11**

16.3 Because there is now no burner fitted to perform a leak test, place a manometer tube over the injector tip.

- Light the appliance and spray any joints with leak detector fluid
- Tighten joints or replace as required

SERVICING INSTRUCTIONS

REPLACING PARTS

15. SHORT SPARES LIST

	STUDIO 22	
COMPONENT	NG	LPG
PILOT INJECTOR	PI0069	PI0086
MAIN INJECTOR	IN0050	IN0051
BURNER ASSEMBLY	GZ5501	GZ5510
AERATION PLATE	G20 - GZ3269	G30 - N/A
		G31 - N/A
ELECTRODE	PI0075	
THERMOCOUPLE	PI0074	
MAG UNIT	GC0166	
IGNITION LEAD	GC0125	
GAS VALVE	GC0123	
CONTROL BOX	GC0150	
REMOTE CONTROL	GC0149	
INTERRUPTER BLOCK	GC0124	
THERMOCURRENT CABLE	GC0128	
TOUCH PAD	GC0164	
TOUCH PAD LEAD	GC0144	
BATTERY HOLDER	EL0410	
BATTERY HOLDER CABLE	GC0127	
REAR VERMICULITE PANE	CE0694	
SIDE VERMICULITE PANEL	CE0693	
BASE VERMICULITE PANEL	CE0695	
LOG SET	CE0720	

SERVICE RECORDS

1ST SERVICE

Date of Service:.....

Next Service Due:.....

Signed:.....

Dealer's Stamp/Gas Safe Registration Number

2ND SERVICE

Date of Service:.....

Next Service Due:.....

Signed:.....

Dealer's Stamp/Gas Safe Registration Number

3RD SERVICE

Date of Service:.....

Next Service Due:.....

Signed:.....

Dealer's Stamp/Gas Safe Registration Number

4TH SERVICE

Date of Service:.....

Next Service Due:.....

Signed:.....

Dealer's Stamp/Gas Safe Registration Number

5TH SERVICE

Date of Service:.....

Next Service Due:.....

Signed:.....

Dealer's Stamp/Gas Safe Registration Number

6TH SERVICE

Date of Service:.....

Next Service Due:.....

Signed:.....

Dealer's Stamp/Gas Safe Registration Number

7TH SERVICE

Date of Service:.....

Next Service Due:.....

Signed:.....

Dealer's Stamp/Gas Safe Registration Number

8TH SERVICE

Date of Service:.....

Next Due:.....

Signed:.....

Dealer's Stamp/Gas Safe Registration Number

9TH SERVICE

Date of Service:.....

Next Service Due:.....

Signed:.....

Dealer's Stamp/Gas Safe Registration Number

10TH SERVICE

Date of Service:.....

Next Service Due:.....

Signed:.....

Dealer's Stamp/Gas Safe Registration Number

Distributed by



The Fireplace
0800 843 347 | 0800 The Fire
www.thefireplace.co.nz

Manufactured by

Gazco Limited, Osprey Road, Sowton Industrial Estate, Exeter, Devon, England EX2 7JG
Technical Customer Services (01392) 261950 Fax: (01392) 261951
E-mail: technicalservices@gazco.com

A member of the Stovax Group
Adapted from English Issue 5



PR1014NZ